

NO. OF COPIES RECEIVED	
DISTRIBUTION	
SANTA FE	
FILE	
U.S.G.S.	
LAND OFFICE	
OPERATOR	

# NEW MEXICO OIL CONSERVATION COMMISSION

Form C-101  
Revised 1-1-65

5A. Indicate Type of Lease	
STATE <input checked="" type="checkbox"/>	FEE <input type="checkbox"/>
5. State Oil & Gas Lease No.	
L 2948	
7. Unit Agreement Name	
8. Farm or Lease Name	
State KNN	
9. Well No.	
1	
10. Field and Pool, or Wildcat	
Arkansas Junction Dev.	
12. County	
Lea	
19. Proposed Depth	19A. Formation
12,500'	Devonian
20. Rotary or C.T.	
Rotary	
21. Elevations (Show whether DF, RT, etc.)	21A. Kind & Status Plug. Bond
GL 3829'	Statewide on file
21B. Drilling Contractor	22. Approx. Date Work will start
McVay Drilling Co.	7-14-75

## APPLICATION FOR PERMIT TO DRILL, DEEPEN, OR PLUG BACK

1a. Type of Work	
DRILL <input checked="" type="checkbox"/>	DEEPEN <input type="checkbox"/> PLUG BACK <input type="checkbox"/>
b. Type of Well	
OIL WELL <input checked="" type="checkbox"/>	GAS WELL <input type="checkbox"/> OTHER <input type="checkbox"/>
2. Name of Operator	
Coquina Oil Corporation	
3. Address of Operator	
P. O. Drawer 2960, Midland, Texas 79701	
4. Location of Well	
UNIT LETTER J	LOCATED 1980 FEET FROM THE S LINE
AND 1980 FEET FROM THE E LINE OF SEC. 20	TWP. 18-S RGE. 36-E NMPM
21. Elevations (Show whether DF, RT, etc.)	
GL 3829'	
21A. Kind & Status Plug. Bond	
Statewide on file	
21B. Drilling Contractor	
McVay Drilling Co.	
22. Approx. Date Work will start	
7-14-75	

23.

## PROPOSED CASING AND CEMENT PROGRAM

SIZE OF HOLE	SIZE OF CASING	WEIGHT PER FOOT	SETTING DEPTH	SACKS OF CEMENT	EST. TOP
17 1/2"	12 3/4"	38#	325'	500	Surface
11"	8 5/8"	24 & 32#	5000'	500	4200'
7 5/8"	4 1/2" or 5 1/2"	Various	12500	500	10000'

DRILLING PROGRAM: Drill a 17 1/2" hole to 325' and cement 12 3/4" casing to surface. Drill a 11" hole to approximately 5000'. Run and cement 8 5/8" casing. WOC. NU BOP and test. Drill a 7 7/8" hole to total depth.

BLOWOUT PREVENTERS: Will be installed on 12 3/4" casing to 5000'. Type 12" 900 series 2 - QRC with drill pipe 4 1/2" rams and blind rams. On the 8 5/8" intermediate casing 2 - QRC 10" 900 series, drill pipe and blind rams will be installed plus a 10" 900 series Hydril will be installed and maintained in good working order until total depth is reached.

APPROVAL VALID  
FOR 90 DAYS UNLESS  
DRILLING COMMENCED,

EXPIRES Oct 16, 1975

IN ABOVE SPACE DESCRIBE PROPOSED PROGRAM: IF PROPOSAL IS TO DEEPEN OR PLUG BACK, GIVE DATA ON PRESENT PRODUCTIVE ZONE AND PROPOSED NEW PRODUCTIVE ZONE. GIVE BLOWOUT PREVENTER PROGRAM, IF ANY.

I hereby certify that the information above is true and complete to the best of my knowledge and belief.

Signed (J. T. Berry) Title Superintendent Date July 14, 1975

(This space for State Use)

APPROVED BY John W. Runyan TITLE Geologist DATE \_\_\_\_\_

CONDITIONS OF APPROVAL, IF ANY:

**NEW MEXICO OIL CONSERVATION COMMISSION**  
**WELL LOCATION AND ACREAGE DEDICATION**

Form C-102  
 Supersedes C-128  
 Effective 1-1-65

All distances must be from the outer boundaries of the Section.

Operator <b>COQUINA OIL CORP.</b>			Lease <del>KNN</del> STATE - <i>KNN</i>		Well No. <b>1</b>
Unit Letter <b>"J"</b>	Section <b>20</b>	Township <b>18-S</b>	Range <b>36-E</b>	County <b>LEA</b>	
Actual Footage Location of Well: <div style="display: flex; justify-content: space-between;"> <span><b>1980</b> feet from the <b>SOUTH</b> line and</span> <span><b>1980</b> feet from the <b>EAST</b> line</span> </div>					
Ground Level Elev. <b>3829</b>	Producing Formation <b>DEVONIAN</b>	Pool <b>WILDCAT</b>		Dedicated Acreage: <del>80</del> <b>4</b> Acres	

1. Outline the acreage dedicated to the subject well by colored pencil or hatchure marks on the plat below.
2. If more than one lease is dedicated to the well, outline each and identify the ownership thereof (both as to working interest and royalty).
3. If more than one lease of different ownership is dedicated to the well, have the interests of all owners been consolidated by communitization, unitization, force-pooling, etc?

☐ Yes    ☐ No    If answer is "yes," type of consolidation \_\_\_\_\_

If answer is "no," list the owners and tract descriptions which have actually been consolidated. (Use reverse side of this form if necessary.) \_\_\_\_\_

No allowable will be assigned to the well until all interests have been consolidated (by communitization, unitization, forced-pooling, or otherwise) or until a non-standard unit, eliminating such interests, has been approved by the Commission.

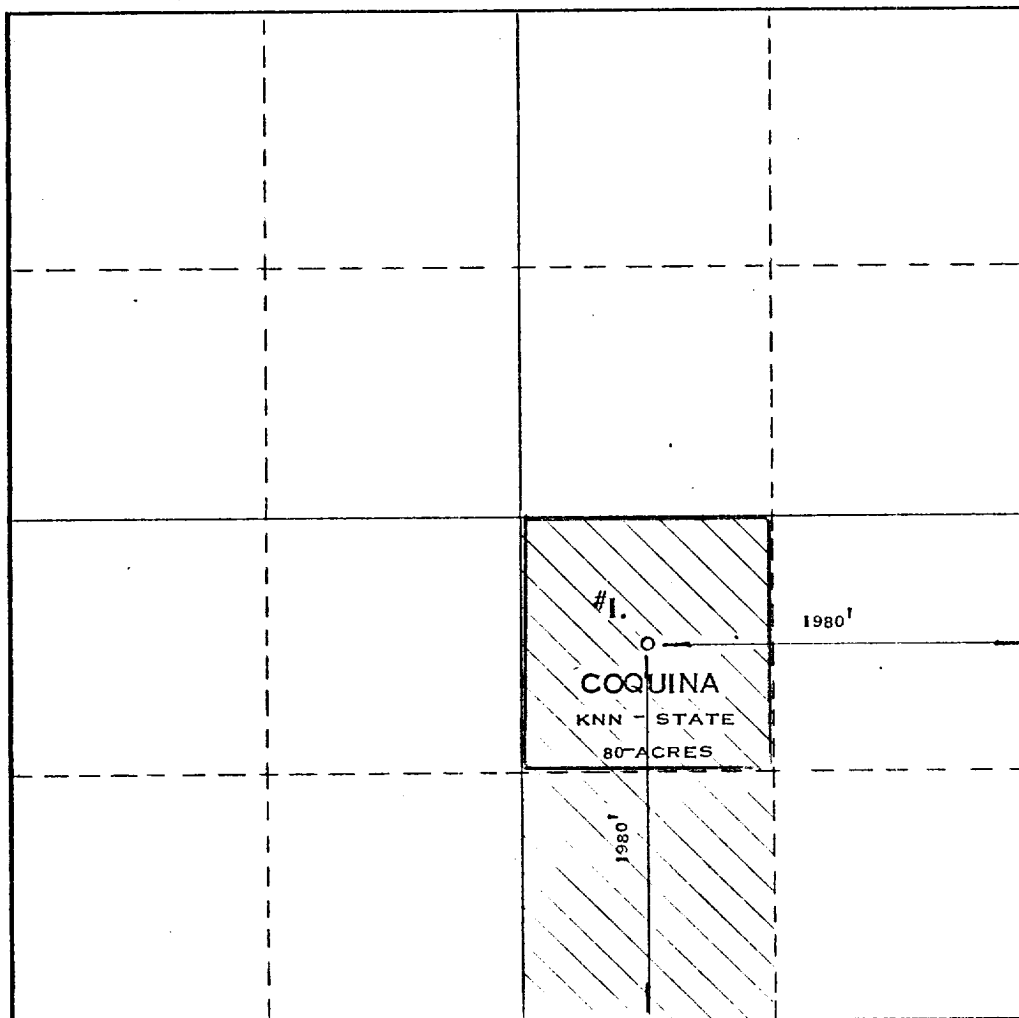

**CERTIFICATION**

*I hereby certify that the information contained herein is true and complete to the best of my knowledge and belief.*

Name  
**J. T. Berry**

Position  
**Superintendent**

Company  
**Coquina Oil Corporation**

Date  
**July 9, 1975**

*I hereby certify that the well location shown on this plat was plotted from field notes of actual surveys made by me or under my supervision, and that the same is true and correct to the best of my knowledge and belief.*

Date Surveyed  
**JULY 8, 1975**

Registered Professional Engineer and/or Land Surveyor  
*Max A. Schumann Jr.*  
**MAX A. SCHUMANN JR**

Certificate No. **1510**

