

NEW 1 COO OIL CONSERVATION COMMISSION
WELL LOCATION AND ACREAGE DEDICATION PLAT

Form CO-150
Supersedes CO-148
Effective 1-1-67

All distances must be from the outer boundaries of the Section.

Operator Mobil Oil Corp.			County Bridges-State			Well No. 183
Section B	Section 12	Township 17S	Range 34E	County Lea		
Actual Distance from Center of Well 910 feet from North 2055 feet from East						
Geologic Formation 4017'		Geologic Formation Middle Pennsylvanian		Geologic Formation Undesignated		Estimated Depth 40 feet

1. Outline the acreage dedicated to the subject well by colored pencil or hatchure marks on the plat below.
2. If more than one lease is dedicated to the well, outline each and identify the ownership thereof (both as to working interest and royalty).
3. If more than one lease of different ownership is dedicated to the well, have the interests of all owners been consolidated by communitization, unitization, force-pooling, etc?

☐ Yes ☐ No If answer is "yes," type of consolidation _____

If answer is "no," list the owners and tract descriptions which have actually been consolidated. (Use reverse side of this form if necessary.) _____

No allowable will be assigned to the well until all interests have been consolidated (by communitization, unitization, forced-pooling, or otherwise) or until a non-standard unit, eliminating such interests, has been approved by the Commission.

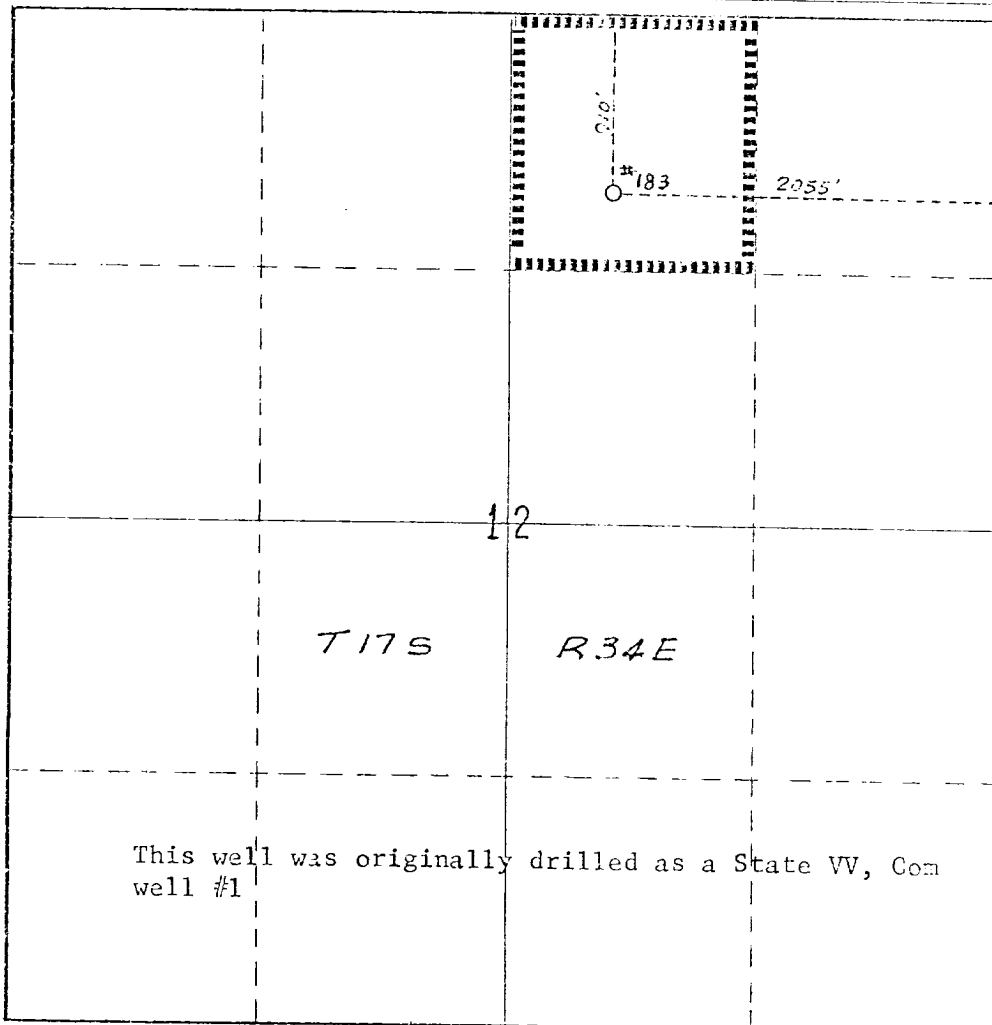

This well was originally drilled as a State VV, Com well #1

CERTIFICATION

I hereby certify that the information contained herein is true and complete to the best of my knowledge and belief.

A. D. Bond

Name
A. D. Bond

Position
Regulatory Engineering Coor

Company
Mobil

Date
July 29, 1977

I hereby certify that the well location shown on this plat was plotted from field notes of actual surveys made by me or under my supervision, and that the same is true and correct to the best of my knowledge and belief.

Date Surveyed

Registered Professional Engineer and/or Land Surveyor

Certification No.

