

UNITED STATES
DEPARTMENT OF THE INTERIOR
GEOLOGICAL SURVEY

APPLICATION FOR PERMIT TO DRILL, DEEPEN, OR PLUG BACK

1a. TYPE OF WORK

☒ DRILL ☒ RE-ENTER ☐ DEEPEN ☐ PLUG BACK

b. TYPE OF WELL

OIL WELL ☒ GAS WELL ☐ OTHER ☐ SINGLE ZONE ☒ MULTIPLE ZONE ☐

2. NAME OF OPERATOR

E. B. Clark

3. ADDRESS OF OPERATOR

700 City National Bldg., Wichita Falls, TX 76301

4. LOCATION OF WELL (Report location clearly and in accordance with any State requirements.)

At surface

1650' FSL & 1980' FWL SEC 31, T-18-S, R-32-E

At proposed prod. zone

Same

14. DISTANCE IN MILES AND DIRECTION FROM NEAREST TOWN OR POST OFFICE*

11 Miles South-Southwest of Maljamar, New Mexico

15. DISTANCE FROM PROPOSED*

LOCATION TO NEAREST
PROPERTY OR LEASE LINE, FT.
(Also to nearest drlg. unit line, if any)

660'

16. NO. OF ACRES IN LEASE

160

17. NO. OF ACRES ASSIGNED
TO THIS WELL

40

18. DISTANCE FROM PROPOSED LOCATION*

TO NEAREST WELL, DRILLING, COMPLETED,
OR APPLIED FOR, ON THIS LEASE, FT.

990'

19. PROPOSED DEPTH

4300'

20. ROTARY OR CABLE TOOLS

Reverse Circulator Unit

21. ELEVATIONS (Show whether DF, RT, GR, etc.)

3668 gl

22. APPROX. DATE WORK WILL START*

March 16, 1979

23. PROPOSED CASING AND CEMENTING PROGRAM

SIZE OF HOLE	SIZE OF CASING	WEIGHT PER FOOT	SETTING DEPTH	QUANTITY OF CEMENT

This well was plugged and abandoned 3-18-76 at T.D. of 4300'.
We propose to re-enter, wash out hole to bottom, Run 4-1/2" casing
to bottom, Test the Grayburg formation.

SEE ATTACHED FOR
CONDITIONS OF APPROVALNote: ~~Attached copies of original completion reports.~~RECEIVED
MAR 12 1979
U. S. GEOLOGICAL SURVEY
HOBBS, NEW MEXICO

IN ABOVE SPACE DESCRIBE PROPOSED PROGRAM: If proposal is to deepen or plug back, give data on present productive zone and proposed new productive zone. If proposal is to drill or deepen directionally, give pertinent data on subsurface locations and measured and true vertical depths. Give blowout preventer program, if any.

24.

SIGNED

TITLE

Owner

DATE

3/9/79

(This space for Federal or State office use)

PERMIT NO.

APPROVAL DATE

APPROVED BY

TITLE

CONDITIONS OF APPROVAL, IF ANY:

APPROVED
AS AMENDED
MAR 15 1979
CRS
DISTRICT ENGINEER

RECEIVED

MAR 20 1979

CEL CONSERVATION COMMISSION
BOSTON, MA

NEW MEXICO OIL CONSERVATION COMMISSION —
WELL LOCATION AND ACREAGE DEDICATION PLAT

Form 17-1
Supersedes 6-1-26
10-1-1965

All distances must be from the outer boundaries of the Section.

Owner E. B. Clark		Lease Federal		Section 3	
Tract K	Section 31	Range 18 South	Meridian 32 East	Lea	
Actual Well Location (Well)					
1650		South		1980	
Ground Level Elev. 3668		Producing Formation Grayburg		West	
		Watkins		NE 1/4 SW 1/4 40	

1. Outline the acreage dedicated to the subject well by colored pencil or by hand marks on the plat.
2. If more than one lease is dedicated to the well, outline each and identify the ownership thereof (as to ownership interest and royalty).
3. If more than one lease of different ownership is dedicated to the well, have the interests of all owners been consolidated by communitization, unitization, force-pooling, etc?

☐ Yes ☒ No If answer is "yes," type of consolidation _____

If answer is "no," list the owners and tract descriptions which have actually been consolidated (attach separate sheet to this form if necessary.) _____

No allowable will be assigned to the well until all interests have been consolidated by communitization, unitization, forced-pooling, or otherwise or until a non-standard unit, eliminating such interests, has been approved by the Commission.

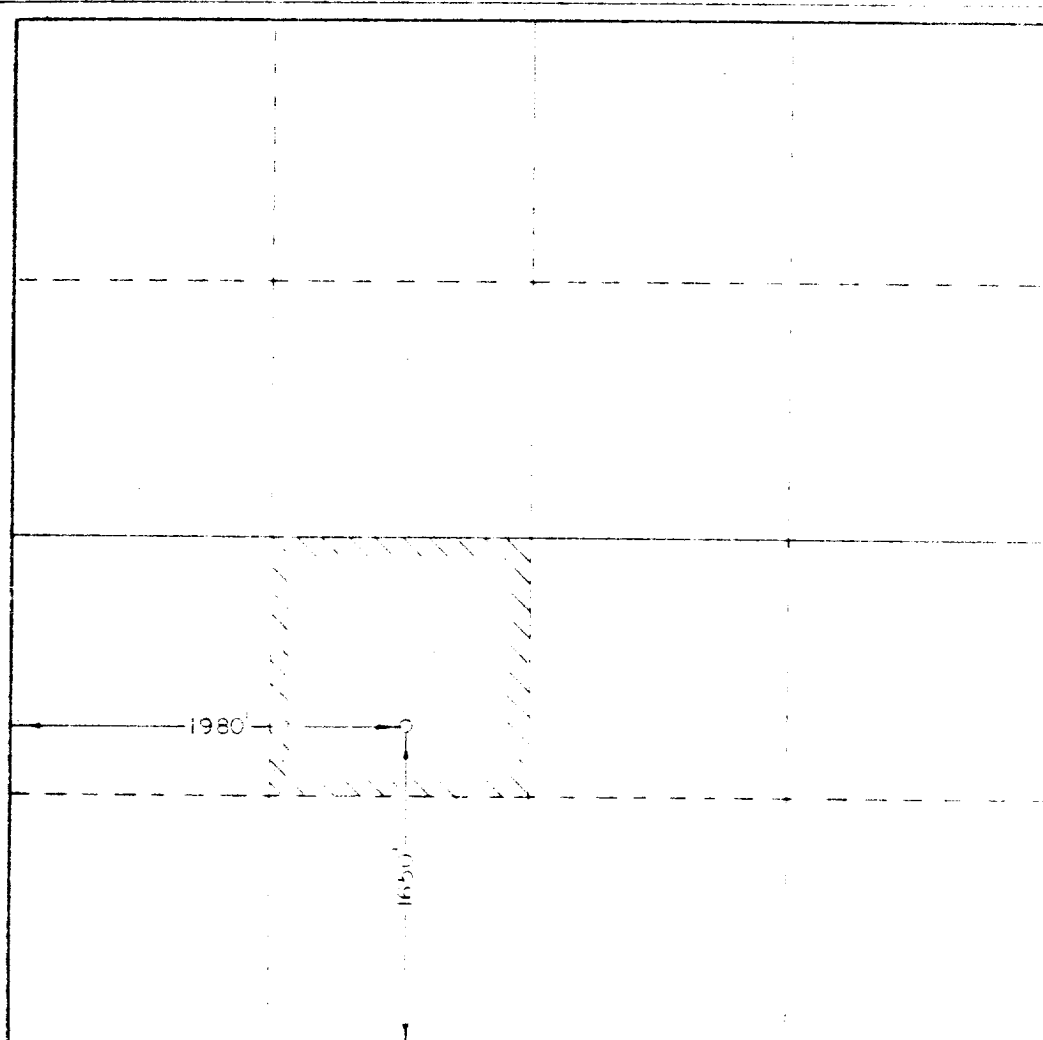

I hereby certify that the foregoing is a true and correct copy of the original as same appears on file.

Dalton Kitchel

Agent

E. B. Clark

March 5, 1976

I hereby certify that the well location shown on this plat was plotted from field notes of actual surveys made by me or under my supervision and that the same is true and correct in the best of my knowledge and belief.

March 5, 1976

Edwin W. West

RECEIVED

MAR 20 1979

OIL CONSERVATION COMMISSION
BUREAU OF OIL

U. S. Geological Survey
P. O. Box 1157
Hobbs, New Mexico 88240

E. B. Clark
Well No. 3 Hightower
Lease Las Cruces 062903

HOBBS DISTRICT

CONDITIONS OF APPROVAL:

1. The Hobbs office (telephone (505) 393-3612) is to be notified when workover operations are to be commenced.
2. Blowout prevention equipment is required.
3. Since surface casing is not into the Rustler anhydrite formation, 4-1/2 inch casing must be cemented from the casing shoe to the surface or cemented to the surface through a stage tool set at least 50 feet below the top of the Rustler after cementing around the shoe with sufficient cement to fill to the base of the salt section.
4. Above ground permanent structures and equipment shall be painted in accordance with the attached Painting Guidelines. The paint color is to simulate Sandstone Brown, Fed. Std. 595-20318 or 30318.

RECEIVED

MAR 20 1979

OIL CONSERVATION BOARD
LOS ANGELES