

**NEW MEXICO OIL CONSERVATION COMMISSION
WELL LOCATION AND ACREAGE DEDICATION PLAT**

Form C-10,
Supersedes C-128
Effective 1-1-65

All distances must be from the outer boundaries of the Section

Operator HONEYSUCKLE EXPLORATION CORP.			Lease State "22"		Well No. 1
Plot Letter P	Section 22	Township 18 South	Range 35 East	County Lea	
Actual Well Location of Wells:					
330 feet from the south line and		330 feet from the east line			
Ground Elev. Elev. 3866.3	Producing Formation Queen-Penrose	Pool Wildcat		Dedicated Acreage 40	

1. Outline the acreage dedicated to the subject well by colored pencil or hatchure marks on the plat below.
2. If more than one lease is dedicated to the well, outline each and identify the ownership thereof (both as to working interest and royalty).
3. If more than one lease of different ownership is dedicated to the well, have the interests of all owners been consolidated by communitization, unitization, force-pooling, etc?

☐ Yes ☐ No If answer is "yes," type of consolidation _____

If answer is "no," list the owners and tract descriptions which have actually been consolidated. (Use reverse side of this form if necessary.) _____

No allowable will be assigned to the well until all interests have been consolidated (by communitization, unitization, forced-pooling, or otherwise) or until a non-standard unit, eliminating such interests, has been approved by the Commission.

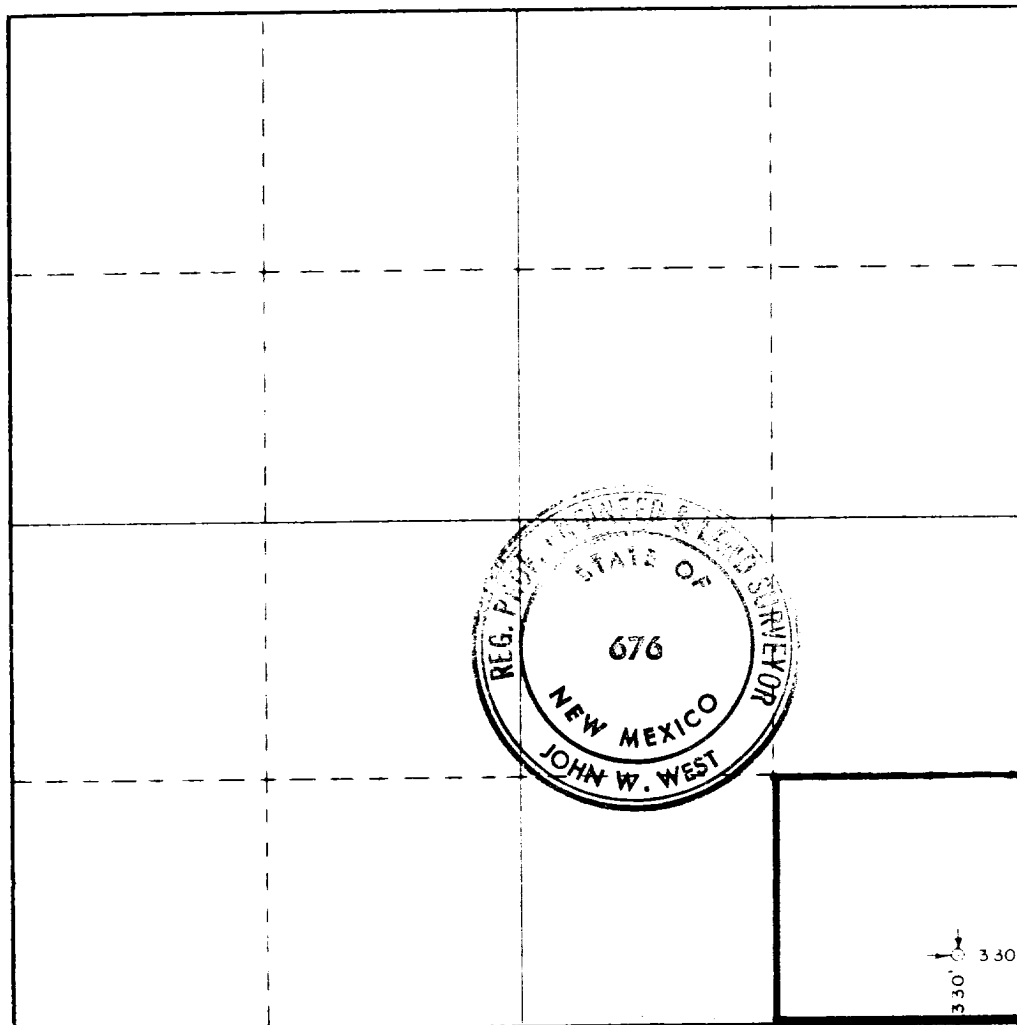

CERTIFICATION

I hereby certify that the information contained herein is true and complete to the best of my knowledge and belief.

Neal A Taylor
Agent

Honeysuckle Exploration Corp.

Date
12/17/76

I hereby certify that the well location shown on this plat was plotted from field notes of actual surveys made by me or under my supervision, and that the same is true and correct to the best of my knowledge and belief.

Date Surveyed

Dec. 9, 1976

Registered Professional Engineer and Land Surveyor

John W. West
Certificate No. **676**

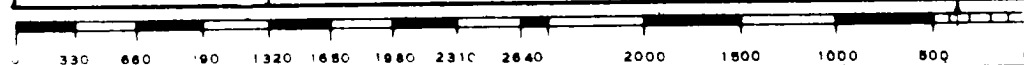

RECEIVED

FEB 2 1976

171 OLD CONSERVATION COMM.
HOBBS, N. M.