

UNITED STATES
DEPARTMENT OF THE INTERIOR
BUREAU OF LAND MANAGEMENT

CONTACT RECEIVING
OFFICE FOR NUMBER
OF COPIES REQUIRED
(Other instructions on
reverse side)

BLM R. well Dr. 1990
Mod. 1990, 1991
NM060-3160-3

30-025-25423

APPLICATION FOR PERMIT TO DRILL, DEEPEN, OR PLUG BACK

1a. TYPE OF WORK

DRILL ☐

DEEPEN ☐

PLUG BACK ☐

b. TYPE OF WELL

OIL
WELL ☐

GAS
WELL ☐

OTHER ☐

Disposal Well

SINGLE
ZONE ☒

MULTIPLE
ZONE ☐

2. NAME OF OPERATOR

SOUTHLAND ROYALTY COMPANY

3a. AREA CODE & PHONE NO.

915/686-5600

3. ADDRESS OF OPERATOR

21 Desta Dr., Midland, TX 79705

4. LOCATION OF WELL (Report location clearly and in accordance with any State requirements.)*

At surface

660' FEL and 660' FNL

At proposed prod. zone

660' FEL and 660' FNL

14. DISTANCE IN MILES AND DIRECTION FROM NEAREST TOWN OR POST OFFICE*

10 miles southeast of Maljamar, New Mexico

15. DISTANCE FROM PROPOSED*

LOCATION TO NEAREST
PROPERTY OR LEASE LINE, FT.
(Also to nearest drig. unit line, if any)

660'

16. NO. OF ACRES IN LEASE

640 acres

17. NO. OF ACRES ASSIGNED
TO THIS WELL

n.a.--disposal well

18. DISTANCE FROM PROPOSED LOCATION*
TO NEAREST WELL, DRILLING, COMPLETED,
OR APPLIED FOR, ON THIS LEASE, FT.

1350'

19. PROPOSED DEPTH

5270'

20. ROTARY OR CABLE TOOLS

Rotary

21. ELEVATIONS (Show Whether DF, RT, GR, ETC.)

3840.4' GR.

22. APPROX. DATE WORK WILL START

15 January 1990

23. PROPOSED CASING AND CEMENTING PROGRAM

HOLE SIZE	CASING SIZE	WEIGHT/FOOT	GRADE	THREAD TYPE	SETTING DEPTH	QUANTITY OF CEMENT
* 12 1/4"	8 5/8"	24	K-55	STC	332'	275 sx
7 7/8"	5 1/2"	15.5	K-55	STC	5270'	1300 sx

This well was plugged and abandoned in 1977. The well will be re-entered by drilling out the plugs (see attached schematics). The proposed re-entry procedure is attached.

MUD PROGRAM: See attached SWD conversion procedures.

BOP PROGRAM: 11" - 3M BOP stack to be installed on 8 5/8". The stack is to consist of annular BOP, blind ram BOP, and one pipe ram BOP. Test the BOP's using an independent tester.

*csg. in hole

IN ABOVE SPACE DESCRIBE PROPOSED PROGRAM: If proposal is to deepen or plug back, give data on present productive zone and proposed new productive zone. If proposal is to drill or deepen directionally, give pertinent data on subsurface locations and measured and true vertical depths. Give blowout prevention procedures if any.

24. SIGNED Robert L. Bradshaw TITLE Sr. Staff Env./Reg. Spec. DATE 27 December 1990

(This space for Federal or State office use)

PERMIT NO. _____ APPROVAL DATE _____

Orig. Signed by Richard L. Manus

AREA MANAGER
CARLSBAD RESOURCE AREA

APPROVED BY _____ TITLE _____ DATE 1-19-90

CONDITIONS OF APPROVAL, IF ANY:

*See Instructions On Reverse Side

TITLE 18 U.S.C. SECTION 1001, makes it a crime for any person knowingly and willfully to make to any department or agency of the United States any false, fictitious or fraudulent statements or representations as to any matter within its jurisdiction.

NEW MEXICO OIL CONSERVATION COMMISSION
WELL LOCATION AND ACREAGE DEDICATION PLAT

Form O-12
Supersedes O-12A
Effective 1-1-65

All distances must be from the outer boundaries of the Section

Operator SOUTHLAND ROYALTY COMPANY			Lease West Corbin		Well No. 3
Unit Letter A	Section 18	Township 18 South	Range 33 East	County Lea	
Actual Footage Location of Well: 660 feet from the north line and 660 feet from the east line					
Ground Level Elev. 3855.8	Producing Formation		Pool	Dedicated Acreage: Acres	

1. Outline the acreage dedicated to the subject well by colored pencil or hachure marks on the plat below.
2. If more than one lease is dedicated to the well, outline each and identify the ownership thereof (both as to working interest and royalty).
3. If more than one lease of different ownership is dedicated to the well, have the interests of all owners been consolidated by communitization, unitization, force-pooling, etc?

☐ Yes ☐ No If answer is "yes," type of consolidation _____

If answer is "no," list the owners and tract descriptions which have actually been consolidated. (Use reverse side of this form if necessary.) _____

No allowable will be assigned to the well until all interests have been consolidated (by communitization, unitization, forced-pooling, or otherwise) or until a non-standard unit, eliminating such interests, has been approved by the Commission.

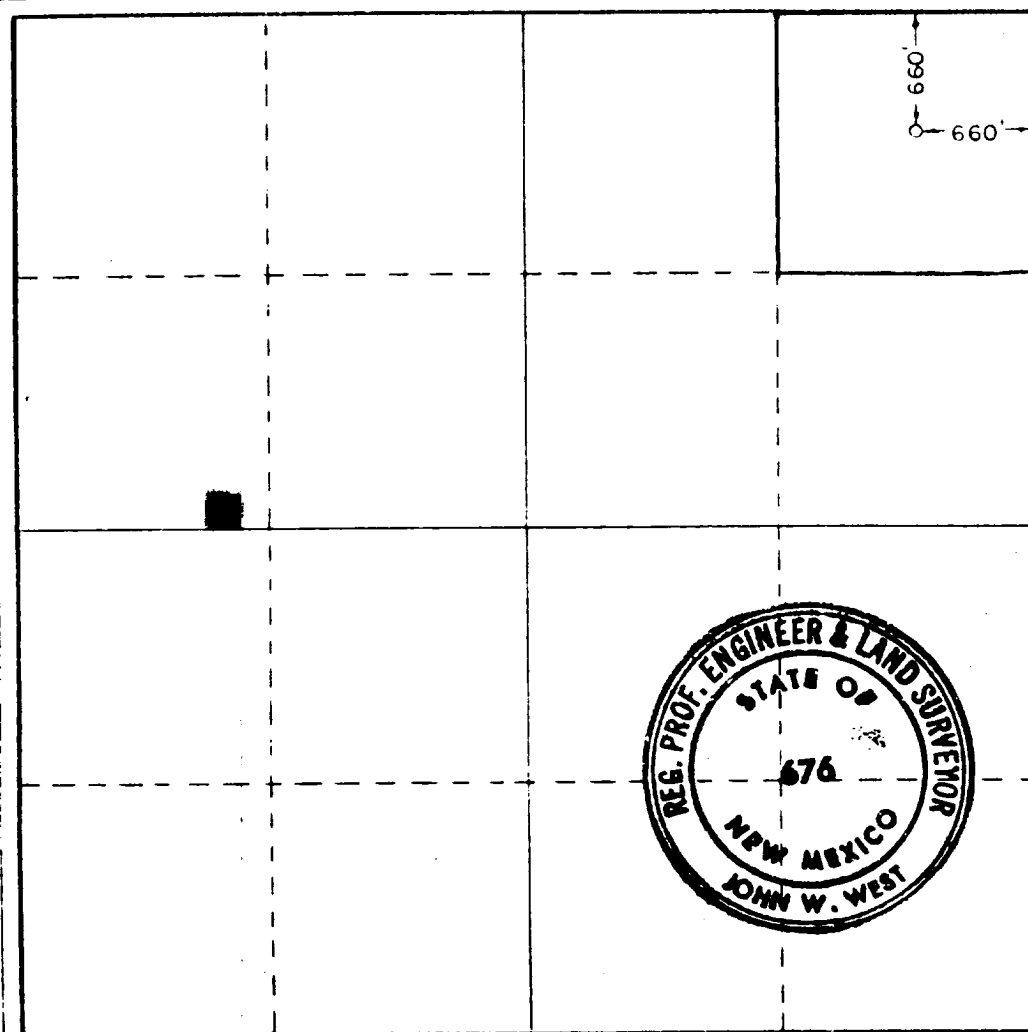

CERTIFICATION

I hereby certify that the information contained herein is true and complete to the best of my knowledge and belief

Robert L. Bradshaw

Name

Robert L. Bradshaw

Position

Sr. Staff Env./Reg. Spec.

Company

Meridian Oil Inc.

Date

22 December 1989

I hereby certify that the well location shown on this plat was plotted from field notes of actual surveys made by me or under my supervision, and that the same is true and correct to the best of my knowledge and belief.

Date Surveyed

December 4, 1976

Registered Professional Engineer and/or Land Surveyor

John W. West

Certificate No.

676



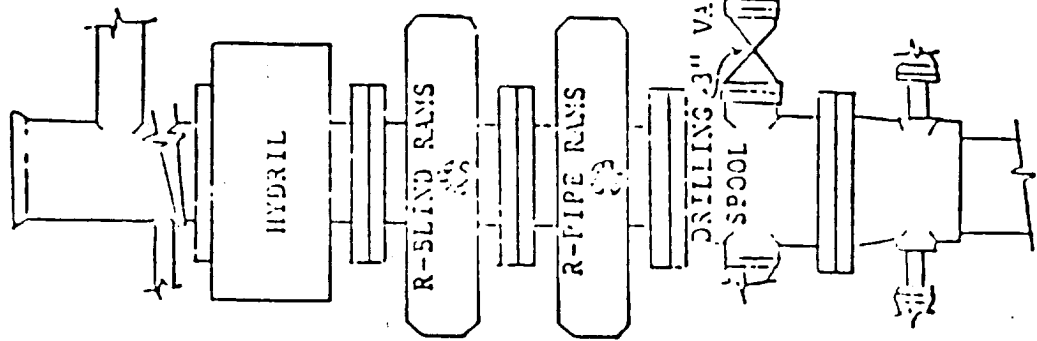

BLOW OUT PREVENTION EQUIPMENT
 10" 900s ALL FLANGED CONNECTIONS
 3,000# WORKING PRESSURE - 6,000# TEST

UNITED STATES
DEPARTMENT OF THE INTERIOR
GEOLOGICAL SURVEY

SUBMIT IN TRIPPLICATE
COPY TO

Form approved.
Budget Bureau No. 42-1-1
3. LEASE DESIGNATION AND NUMBER

NM 93

6. IF INDIAN, ALLOTTEE OR TRIBAL

SUNDRY NOTICES AND REPORTS ON WELLS

(Do not use this form for proposals to drill or to deepen or plug back to a different reservoir.
Use "APPLICATION FOR PERMIT—" for such proposals.)

1. OIL WELL ☐ GAS WELL ☐ OTHER ☒ Dry
2. NAME OF OPERATOR
Aztec Oil & Gas Company
3. ADDRESS OF OPERATOR
c/o Southland Royalty Co., 1100 Wall Towers West, Midland, TX
4. LOCATION OF WELL (Report location clearly and in accordance with any State requirements.* 79701
See also space 17 below.)
At surface
660' FNL & 660' FEL, Sec. 18-18S-33E, Lea County, New Mexico.

7. UNIT AGREEMENT NAME

8. FARM OR LEASE NAME

West Corbin

9. WELL NO.

3

10. FIELD AND POOL, OR WILDCAT

West Corbin/Delaware

11. SEC., T., R., M., OR BLK. AND SURVEY OR AREA

Sec. 18-18S-33E

14. PERMIT NO.

15. ELEVATIONS (Show whether DF, RT, CR, etc.)

3855.8 GR; 3866' KE

12. COUNTY OR PARISH

Lea

13. STATE

NM

16. Check Appropriate Box To Indicate Nature of Notice, Report, or Other Data

NOTICE OF INTENTION TO:

TEST WATER SHUT-OFF

FRAC TURE TREAT

SHOOT OR ACIDIZE

REPAIR WELL

(Other)

PULL OR ALTER CASING

MULTIPLE COMPLETS

ABANDON*

CHANGE PLANS

SUBSEQUENT REPORT OF:

WATER SHUT-OFF

FRAC TURE TREATMENT

SHOOTING OR ACIDIZING

Other

REPAIRING WELL

ALTERING CASING

ABANDONMENT*

Location Cleanup

(NOTE: Report results of multiple completion on Well Completion or Recompletion Report and Log form.)

17. DEEPENING, DECOMPLETION OR COMPLETED OPERATIONS (Clearly state all pertinent details, and give pertinent dates, including estimated date of starting proposed work. If well is directionally drilled, give subsurface locations and measured and true vertical depths for all markers and angles pertinent to this work.)*

Total Depth 5177'.

Plug and abandon well as follows:

50 sx cement 4623-4800' (San Andres)
50 sx cement 3913-4090' (Queen)
50 sx cement 3118-3295' (Yates)
50 sx cement 2523-2700' (Base Salt)
50 sx cement 1203-1380' (Top salt)
50 sx cement 155- 332' (Across 8 5/8" casing shoe)
10 sx cement @ surface.

Well plugged and abandoned February 14, 1977.
Location cleaned w/pits backfilled and leveled.
Location ready for inspection.

*Plugged and
6-15-76*

18. I hereby certify that the foregoing is true and correct

SIGNED

C. Harvey Can

TITLE

District Engineer

DATE

6-16-77

(This space for Federal or State office use)

APPROVED BY

CONDITIONS OF APPROVAL, IF ANY:

TITLE

*See Instructions on Reverse Side

APPROVED
APR 5 1978
A. A. I.
ACTING DISTRICT ENGINEER

RECEIVED

APR 11 1978

OIL CONSERVATION COMM.
HOBBS, N. M.

4/11/78