

NO. OF COPIES RECEIVED		
DISTRIBUTION		
SANTA FE		
FILE		
U.S.G.S.		
LAND OFFICE		
OPERATOR		

# NEW MEXICO OIL CONSERVATION COMMISSION

Form C-101  
Revised 1-1-65

5A. Indicate Type of Lease	
STATE <input checked="" type="checkbox"/>	FEE <input type="checkbox"/>
5. State Oil & Gas Lease No.	
E-1816	

## APPLICATION FOR PERMIT TO DRILL, DEEPEN, OR PLUG BACK

1a. Type of Work		7. Unit Agreement Name	
b. Type of Well DRILL <input checked="" type="checkbox"/> DEEPEN <input type="checkbox"/> PLUG BACK <input type="checkbox"/> OIL WELL <input type="checkbox"/> GAS WELL <input checked="" type="checkbox"/> OTHER <input type="checkbox"/> SINGLE ZONE <input checked="" type="checkbox"/> MULTIPLE ZONE <input type="checkbox"/>		Gallagher State Com	
2. Name of Operator		8. Farm or Lease Name	
Mobil Oil Corporation			
3. Address of Operator		9. Well No.	
Three Greenway Plaza East, Suite 800, Houston, Texas 77046		1	
4. Location of Well UNIT LETTER <u>H</u> LOCATED <u>660</u> FEET FROM THE <u>East</u> LINE AND <u>1980'</u> FEET FROM THE <u>North</u> LINE OF SEC. <u>3</u> TWP. <u>17S</u> RGE. <u>34E</u> NMMP		10. Unit and Pool, or Wildcat North Vacuum-Morrow Gas	
		12. County Lea	
		19. Proposed Depth 13000	
		19A. Formation Morrow	
		20. Rotary or C.T. Rotary	
21. Elevations (Show whether DF, RT, etc.) 4050' Ground		22. Approx. Date Work will start as soon as possible	
21A. Kind & Status Plug. Bond on file		21B. Drilling Contractor unknown	

23.

## PROPOSED CASING AND CEMENT PROGRAM

SIZE OF HOLE	SIZE OF CASING	WEIGHT PER FOOT	SETTING DEPTH	SACKS OF CEMENT	EST. TOP
17-1/2"	12-3/4"	34#	0-350	Circulate	Surface
11"	8-5/8"	32# K-55	0-4850	"	"
7-7/8"	5-1/2" Liner	17# N-80	4600-9000.	"	4850
		17# S-95	9000-13000		

## Blowout Preventer Program

Casing String	Eqpt. Size & API Series	No. & Type	Test Pressure psi
Surface	10" 600	1 Annular	1000
Producing	8" 1500	1 Annular, 1 Blank 1 pipe	5000

IN ABOVE SPACE DESCRIBE PROPOSED PROGRAM: IF PROPOSAL IS TO DEEPEN OR PLUG BACK, GIVE DATA ON PRESENT PRODUCTIVE ZONE AND PROPOSED NEW PRODUCTIVE ZONE. GIVE BLOWOUT PREVENTER PROGRAM, IF ANY.

I hereby certify that the information above is true and complete to the best of my knowledge and belief.

Signed A. D. Bond Title Regulatory Engineering Coordinator 2/24/77

(This space for State Use)

APPROVED BY [Signature] TITLE SUPERVISOR DATE 2/24/77

CONDITIONS OF APPROVAL, IF ANY:

RECEIVED

SEP 2 1947

OIL CONSERVATION COMM.  
HOBBES, N. M.

NEW MEXICO OIL CONSERVATION COMMISSION  
WELL LOCATION AND ACREAGE DEDICATION PLAT

Form C-102  
Supersedes C-128  
Effective 1-1-65

All distances must be from the outer boundaries of the Section.

Operator <b>Mobil Oil Corporation</b>			Lease <b>Gallagher State Com</b>		Well No. <b>1</b>
Unit Letter <b>H</b>	Section <b>3</b>	Township <b>17S</b>	Range <b>34E</b>	County <b>Lea</b>	
Actual Footage Location of Well: <b>660</b> feet from the <b>East</b> line and <b>1980</b> feet from the <b>South</b> line					
Ground Level Elev. <b>4050'</b>	Producing Formation <b>Morrow</b>		Pool <b>North Vacuum-Morrow Gas</b>		Dedicated Acreage: <b>320</b> Acres

1. Outline the acreage dedicated to the subject well by colored pencil or hachure marks on the plat below.
2. If more than one lease is dedicated to the well, outline each and identify the ownership thereof (both as to working interest and royalty).
3. If more than one lease of different ownership is dedicated to the well, have the interests of all owners been consolidated by communitization, unitization, force-pooling, etc?

☒ Yes ☐ No If answer is "yes," type of consolidation Communitization

If answer is "no," list the owners and tract descriptions which have actually been consolidated. (Use reverse side of this form if necessary.)

No allowable will be assigned to the well until all interests have been consolidated (by communitization, unitization, forced-pooling, or otherwise) or until a non-standard unit, eliminating such interests, has been approved by the Commission.

N 89° 14'E 2639.0

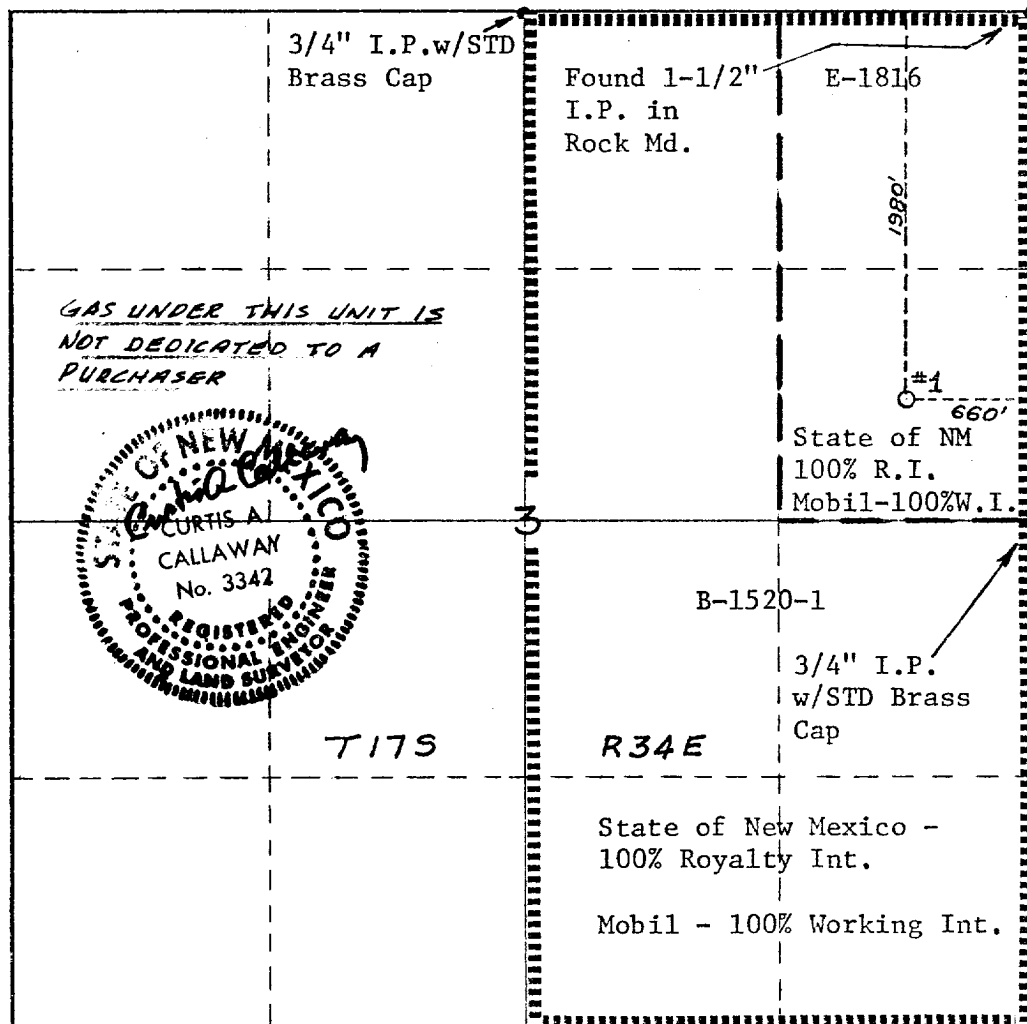

CERTIFICATION

I hereby certify that the information contained herein is true and complete to the best of my knowledge and belief.

*A. D. Bond*

Name  
**A. D. Bond**  
Position **Regulatory Engineering Coordinator**

Company  
**Mobil Oil Corporation**

Date  
**February 24, 1977**

I hereby certify that the well location shown on this plat was plotted from field notes of actual surveys made by me or under my supervision, and that the same is true and correct to the best of my knowledge and belief.

Date Surveyed  
**February 22, 1977**

Registered Professional Engineer and/or Land Surveyor

*Curtis A. Callaway*  
**Curtis A. Callaway**

Certificate No.  
**3342**

RECEIVED

MAY 2 1977

U.S. DEPARTMENT OF JUSTICE  
FEDERAL BUREAU OF INVESTIGATION

173