

NO. OF COPIES RECEIVED	
DISTRIBUTION	
SANTA FE	
FILE	
U.S.G.S.	
LAND OFFICE	
OPERATOR	

NEW MEXICO OIL CONSERVATION COMMISSION

Form C-101
Revised 11-65

5A. Indicate Type of Lease
STATE <input checked="" type="checkbox"/> FEE <input type="checkbox"/>
5. State Oil & Gas Lease No.
E-1085

APPLICATION FOR PERMIT TO DRILL, DEEPEN, OR PLUG BACK

1a. Type of Work		7. Unit Agreement Name	
b. Type of Well OIL WELL <input checked="" type="checkbox"/> GAS WELL <input type="checkbox"/> OTHER <input type="checkbox"/>		8. Farm or Lease Name	
DRILL <input checked="" type="checkbox"/> DEEPEN <input type="checkbox"/> PLUG BACK <input type="checkbox"/>		Lea "A" State	
2. Name of Operator Southern Union Supply Company		9. Well No. 6	
3. Address of Operator Suite 1800 First International Bldg., Dallas, Texas 75270		10. Field and Pool, or Wildcat Vacuum (G-SA)	
4. Location of Well UNIT LETTER N LOCATED 660 FEET FROM THE South LINE AND 1980 FEET FROM THE West LINE OF SEC. 8 TWP. 17-S RGE. 34-E NMPM		12. County Lea	
19. Proposed Depth 4900		19A. Formation San Andres	
20. Rotary or C.T. Rotary		21. Elevations (Show whether DF, RT, etc.)	
21A. Kind & Status Plug. Bond Blanket		21B. Drilling Contractor	
22. Approx. Date Work will start			

23.

PROPOSED CASING AND CEMENT PROGRAM

SIZE OF HOLE	SIZE OF CASING	WEIGHT PER FOOT	SETTING DEPTH	SACKS OF CEMENT	EST. TOP
11	8-5/8	24#	500'	300	Surface
7-7/8"	5-1/2	14#	4800'	1300	Surface

It is proposed to drill a San Andres oil well at the above location. Approximately 500' of 8-5/8" casing will be set and cemented to the surface. A 7-7/8" hole will be drilled through the San Andres and 5-1/2" casing will be run to TD and cemented to the surface. No pressure problems are anticipated at this depth.

APPROVAL VALID
FOR 90 DAYS UNLESS
DRILLING COMMENCED
EXPIRES 6-10-77

IN ABOVE SPACE DESCRIBE PROPOSED PROGRAM: IF PROPOSAL IS TO DEEPEN OR PLUG BACK, GIVE DATA ON PRESENT PRODUCTIVE ZONE AND PROPOSED NEW PRODUCTIVE ZONE. GIVE BLOWOUT PREVENTER PROGRAM, IF ANY.

I hereby certify that the information above is true and complete to the best of my knowledge and belief.

Signed David J. Ahalt Title Drilling Engineer Date 3/4/77
(This space for State Use)

APPROVED BY [Signature] TITLE DATE
CONDITIONS OF APPROVAL, IF ANY:

NEW MEXICO OIL CONSERVATION COMMISSION
WELL LOCATION AND ACREAGE DEDICATION, LAT

Form C-102
 Supersedes C-128
 Effective 1-1-65

All distances must be from the outer boundaries of the Section.

Operator SOUTHERN UNION SUPPLY			Lease Lea A State		Well No. 6
Unit Letter "N"	Section 8	Township 17 South	Range 34 East	County Lea	
Actual Footage Location of Well: 660 feet from the South line and 1980 feet from the West line					
Ground Level Elev. 4090.7	Producing Formation San Andres	Pool Vacuum (G⁻SA)		Dedicated Acreage: 40 Acres	

- Outline the acreage dedicated to the subject well by colored pencil or hachure marks on the plat below.
- If more than one lease is dedicated to the well, outline each and identify the ownership thereof (both as to working interest and royalty).
- If more than one lease of different ownership is dedicated to the well, have the interests of all owners been consolidated by communitization, unitization, force-pooling, etc?

☐ Yes ☐ No If answer is "yes," type of consolidation _____

If answer is "no," list the owners and tract descriptions which have actually been consolidated. (Use reverse side of this form if necessary.) _____

No allowable will be assigned to the well until all interests have been consolidated (by communitization, unitization, forced-pooling, or otherwise) or until a non-standard unit, eliminating such interests, has been approved by the Commission.

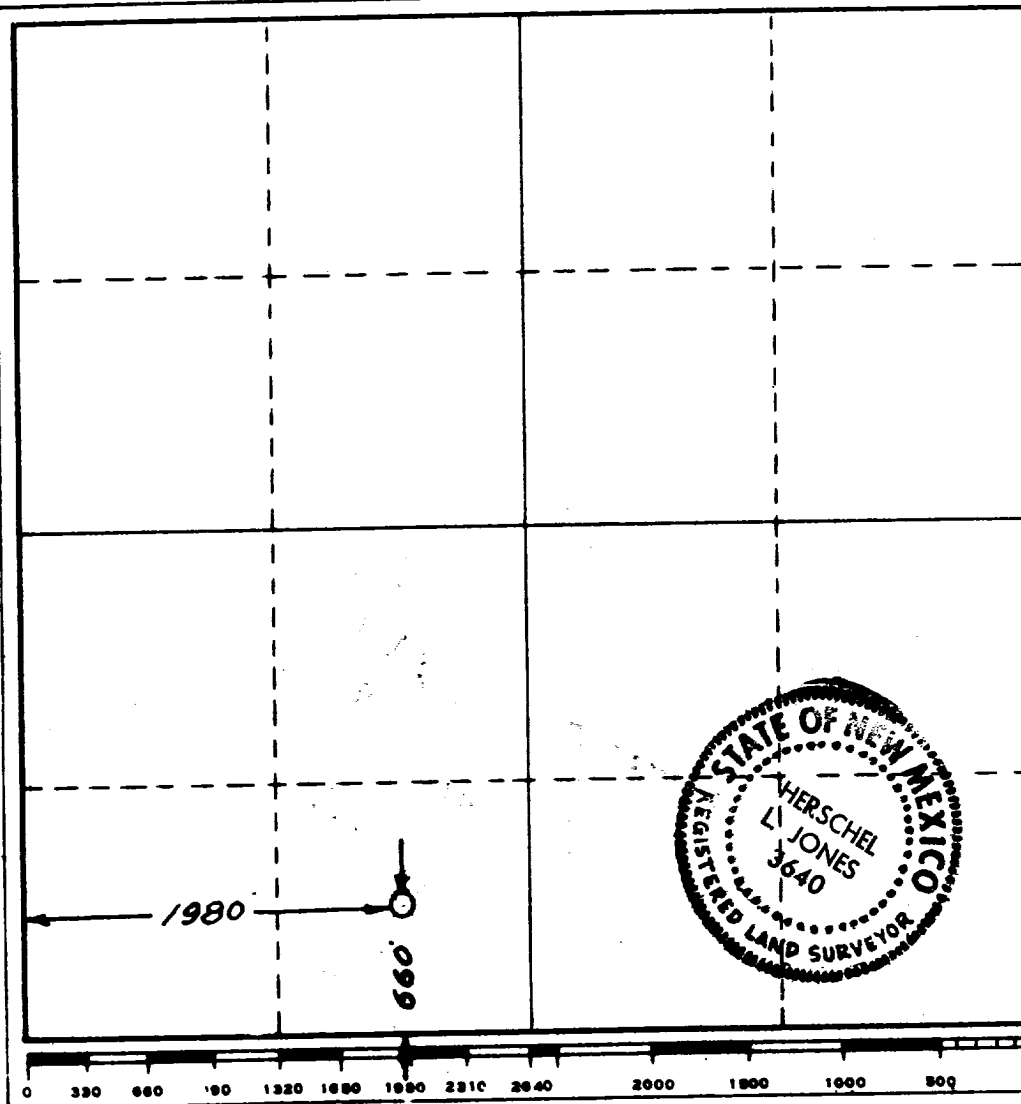

CERTIFICATION

I hereby certify that the information contained herein is true and complete to the best of my knowledge and belief.

M. D. Boggs

Name

M. D. Boggs

Position

Field Agent

Company

Southern Union Supply Co.

Date

3/9/77

I hereby certify that the well location shown on this plat was plotted from field notes of actual surveys made by me or under my supervision, and that the same is true and correct to the best of my knowledge and belief.

Date Surveyed

March 4, 1977

Registered Professional Engineer and/or Land Surveyor

Certificate No.

3640

RECEIVED

1977

111