

**NEW MEXICO OIL CONSERVATION COMMISSION
WELL LOCATION AND ACREAGE DEDICATION PLAT**

Form C-102
Supersedes C-128
Effective 1-1-65

All distances must be from the outer boundaries of the Section.

Operator Devon Energy Corporation			Lease State		Well No. 3
Unit Letter J	Section 22	Township 17 South	Range 22 East	County Lea	
Actual Footage Location of Well: 1710 feet from the South line and 2300 feet from the East line					
Ground Level Elev. 4142.10	Producing Formation Paddock	Pool Leamex, Paddock		Dedicated Acreage: 40 Acres	

1. Outline the acreage dedicated to the subject well by colored pencil or hachure marks on the plat below.
2. If more than one lease is dedicated to the well, outline each and identify the ownership thereof (both as to working interest and royalty).
3. If more than one lease of different ownership is dedicated to the well, have the interests of all owners been consolidated by communitization, unitization, force-pooling, etc?

☐ Yes ☐ No If answer is "yes," type of consolidation One Owner

If answer is "no," list the owners and tract descriptions which have actually been consolidated. (Use reverse side of this form if necessary.)

No allowable will be assigned to the well until all interests have been consolidated (by communitization, unitization, forced-pooling, or otherwise) or until a non-standard unit, eliminating such interests, has been approved by the Commission.

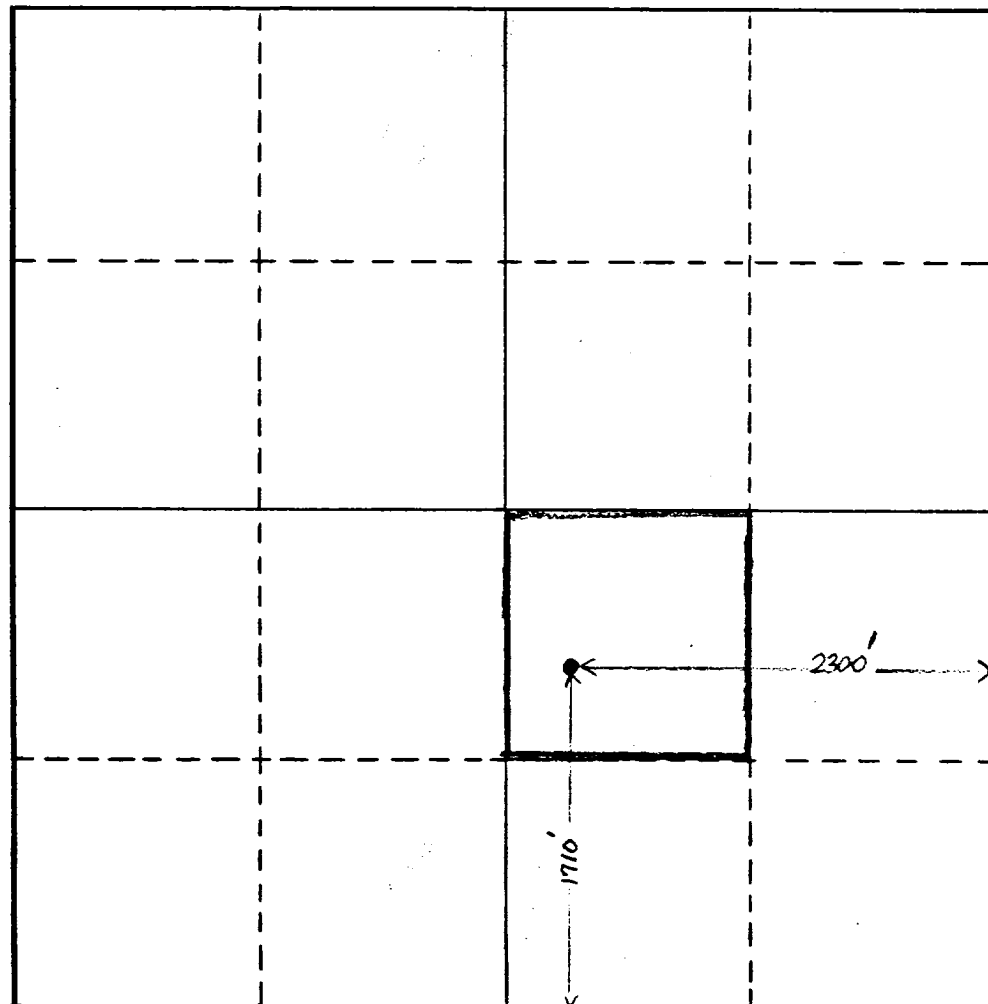

CERTIFICATION

I hereby certify that the information contained herein is true and complete to the best of my knowledge and belief.

M. G. Mooney
Name

M. G. Mooney
Position

District Engineer

Company
Devon Energy Corporation

Date
February 29, 1984

I hereby certify that the well location shown on this plat was plotted from field notes of actual surveys made by me or under my supervision, and that the same is true and correct to the best of my knowledge and belief.

Date Surveyed
March 26, 1977

Registered Professional Engineer
and/or Land Surveyor

Original signed by
John W. West

Certificate No.
676

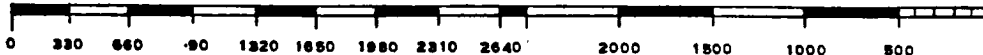

RECEIVED
MAR 5 1984
C.C.D.
ACCESS OFFICE