

NEW MEXICO OIL CONSERVATION COMMISSION
WELL LOCATION AND ACREAGE DEDICATION PLAT

Form C-102
Supersedes C-120
Effective 1-1-65

All distances must be from the outer boundaries of the Section.

Operator MEWBOURNE OIL COMPANY			Lease Querecho Plains Queen Fed "H"		Well No. #2
Oil Letter WJ	Section 27	Township 18	Range 32	County Lea	
Actual Poolage Location of Well: - 8310 feet from the North line and 1980 feet from the West line					
Ground Level Elev. 3737	Producing Formation Queen		Pool UNDESIGNATED Querecho Plains		Dedicated Acreage: 40 Acres

1. Outline the acreage dedicated to the subject well by colored pencil or hatchure marks on the plat below.
2. If more than one lease is dedicated to the well, outline each and identify the ownership thereof (both as to working interest and royalty).
3. If more than one lease of different ownership is dedicated to the well, have the interests of all owners been consolidated by communitization, unitization, force-pooling, etc?

☐ Yes ☐ No If answer is "yes," type of consolidation _____

If answer is "no," list the owners and tract descriptions which have actually been consolidated. (Use reverse side of this form if necessary.) _____

No allowable will be assigned to the well until all interests have been consolidated (by communitization, unitization, forced-pooling, or otherwise) or until a non-standard unit, eliminating such interests, has been approved by the Commission.

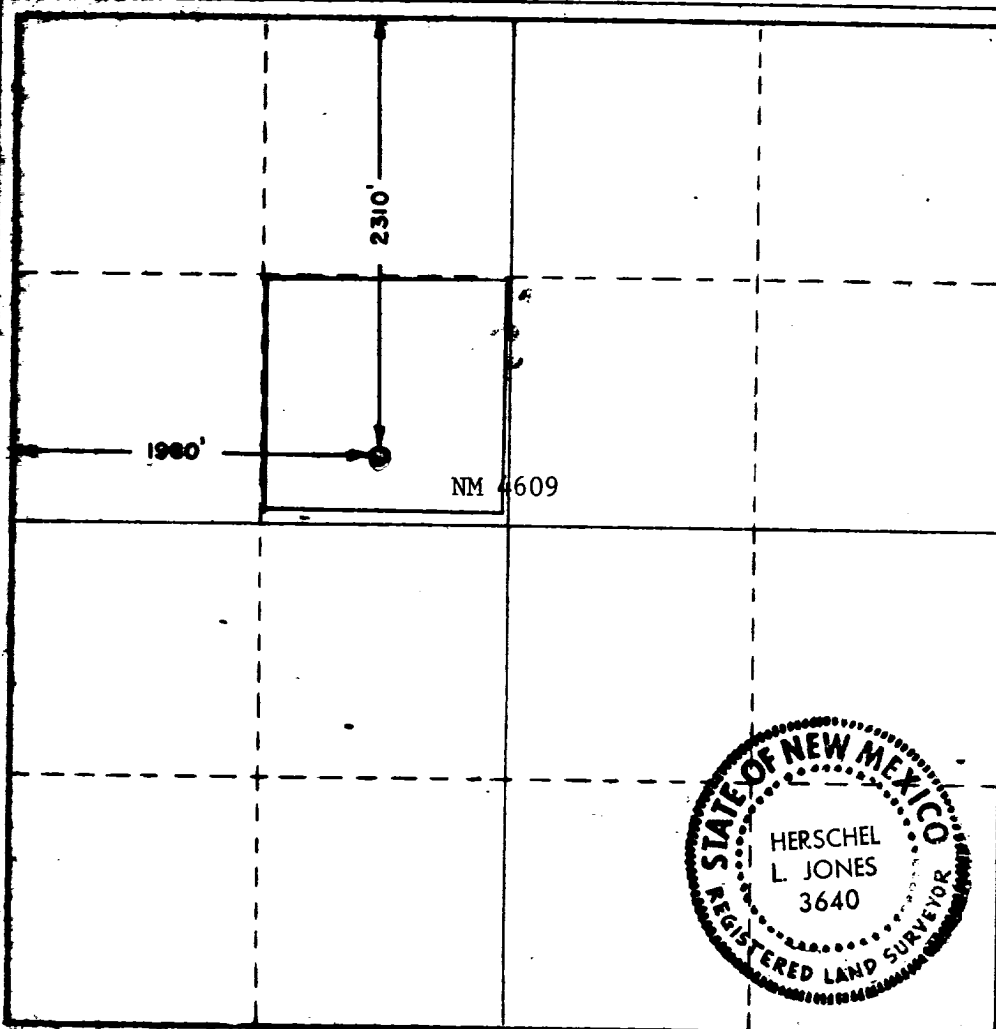

CERTIFICATION

I hereby certify that the information contained herein is true and complete to the best of my knowledge and belief.

Marjorie Lotz
Name

Marjorie Lotz

Position

Production Clerk

Company

Mewbourne Oil Company

Date

July 6, 1977

I hereby certify that the well location shown on this plat was plotted from field notes of actual surveys made by me or under my supervision, and that the same is true and correct to the best of my knowledge and belief.

Date Surveyed

June 27, 1977

Registered Professional Engineer and/or Land Surveyor

Herschel L. Jones
Certificate No.

0 200 400 600 800 1000 1200 1400 1600 1800 2000 2200 2400 2600 2800 3000 3200 3400 3600 3800 4000

RECEIVED

1002 177

OIL CONSERVATION COMM.
HOBBS, D. M.