

NO. OF COPIES RECEIVED	
DISTRIBUTION	
SANTA FE	
FILE	
U.S.G.S.	
LAND OFFICE	
OPERATOR	

NEW MEXICO OIL CONSERVATION COMMISSION

Form C-101
Revised 1-1-65

RE-ENTRY

5A. Indicate Type of Lease
STATE <input checked="" type="checkbox"/> FEE <input type="checkbox"/>
5. State Oil & Gas Lease No.
LG-6412

APPLICATION FOR PERMIT TO DRILL, DEEPEN, OR PLUG BACK

1a. Type of Work		7. Unit Agreement Name	
b. Type of Well OIL WELL <input checked="" type="checkbox"/> GAS WELL <input type="checkbox"/> OTHER <input type="checkbox"/>		8. Farm or Lease Name	
2. Name of Operator		9. Well No.	
3. Address of Operator		10. Field and Pool, or Wildcat	
4. Location of Well		12. County	
UNIT LETTER <u>E</u> LOCATED <u>1980</u> FEET FROM THE <u>North</u> LINE		Lea	
AND <u>660</u> FEET FROM THE <u>West</u> LINE OF SEC. <u>32</u> TWP. <u>18S</u> RGE. <u>35E</u> NMPM			
19. Proposed Depth		19A. Formation	
Present Depth <u>13,044'</u>		Bone Springs	
21. Elevations (Show whether DF, RT, etc.)		22. Approx. Date Work will start	
3928' GR		June 10, 1979	
21A. Kind & Status Plug. Bond		21B. Drilling Contractor	
Blanket		Moranco	

PROPOSED CASING AND CEMENT PROGRAM

SIZE OF HOLE	SIZE OF CASING	WEIGHT PER FOOT	SETTING DEPTH	SACKS OF CEMENT	EST. TOP
Existing	13 3/8"		391'	450	
Existing	9 5/8"		5013'	2150	
	5 1/2"	17#	9250'	750	600' above productive zone

This well was formerly the Mesa Pet. Co. #1 North Scharb State Com. We plan to re-enter with a rotary rig and drill out the surface plug. Drill out plug from 1840' - 1960'. Drill out CIBP at 3350'. Drill out plug at 3612'. Pressure test casing. If necessary, squeeze off perfs in intermediate string 3389' - 3688'. Drill out plug from 4750' - 5000'. Clean out to depth of 9250'. Test Bone Springs. If productive, we will run 9250' of 5 1/2"OD 17#, J-55 casing and cement with 750 Sx of cement.

IN ABOVE SPACE DESCRIBE PROPOSED PROGRAM: IF PROPOSAL IS TO DEEPEN OR PLUG BACK, GIVE DATA ON PRESENT PRODUCTIVE ZONE AND PROPOSED NEW PRODUCTIVE ZONE. GIVE BLOWOUT PREVENTER PROGRAM, IF ANY.

I hereby certify that the information above is true and complete to the best of my knowledge and belief.

Signed Indigo Yates Title Vice President Date 5-29-79

(This space for State Use)

APPROVED BY [Signature] TITLE SUPERVISOR DISTRICT 1 DATE JUN 1 1979

CONDITIONS OF APPROVAL, IF ANY:

NEW MEXICO OIL CONSERVATION COMMISSION
WELL LOCATION AND ACREAGE DEDICATION PLAT

Form C-102
Supersedes C-128
Effective 1-1-65

All distances must be from the outer boundaries of the Section

Owner Harvey E. Yates Company			Lessee HEYCO North Scharb		Well No. 1
Tract Letter E	Section 32	Range 18S	Meridian 35E	County Lea	
Actual Well Location of Well:					
1980 feet from the		North	Line and	660	feet from the West
Round level elev. 3928'	Nearest location Bone Springs		Field	Nearest location Wildcat	
					Acres 40

1. Outline the acreage dedicated to the subject well by colored pencil or hatchure marks on the plat below.
2. If more than one lease is dedicated to the well, outline each and identify the ownership thereof (both as to working interest and royalty).
3. If more than one lease of different ownership is dedicated to the well, have the interests of all owners been consolidated by communitization, unitization, force-pooling, etc?

☐ Yes ☐ No If answer is "yes," type of consolidation _____

If answer is "no," list the owners and tract descriptions which have actually been consolidated. (Use reverse side of this form if necessary.) _____

No allowable will be assigned to the well until all interests have been consolidated (by communitization, unitization, forced-pooling, or otherwise) or until a non-standard unit, eliminating such interests, has been approved by the Commission.

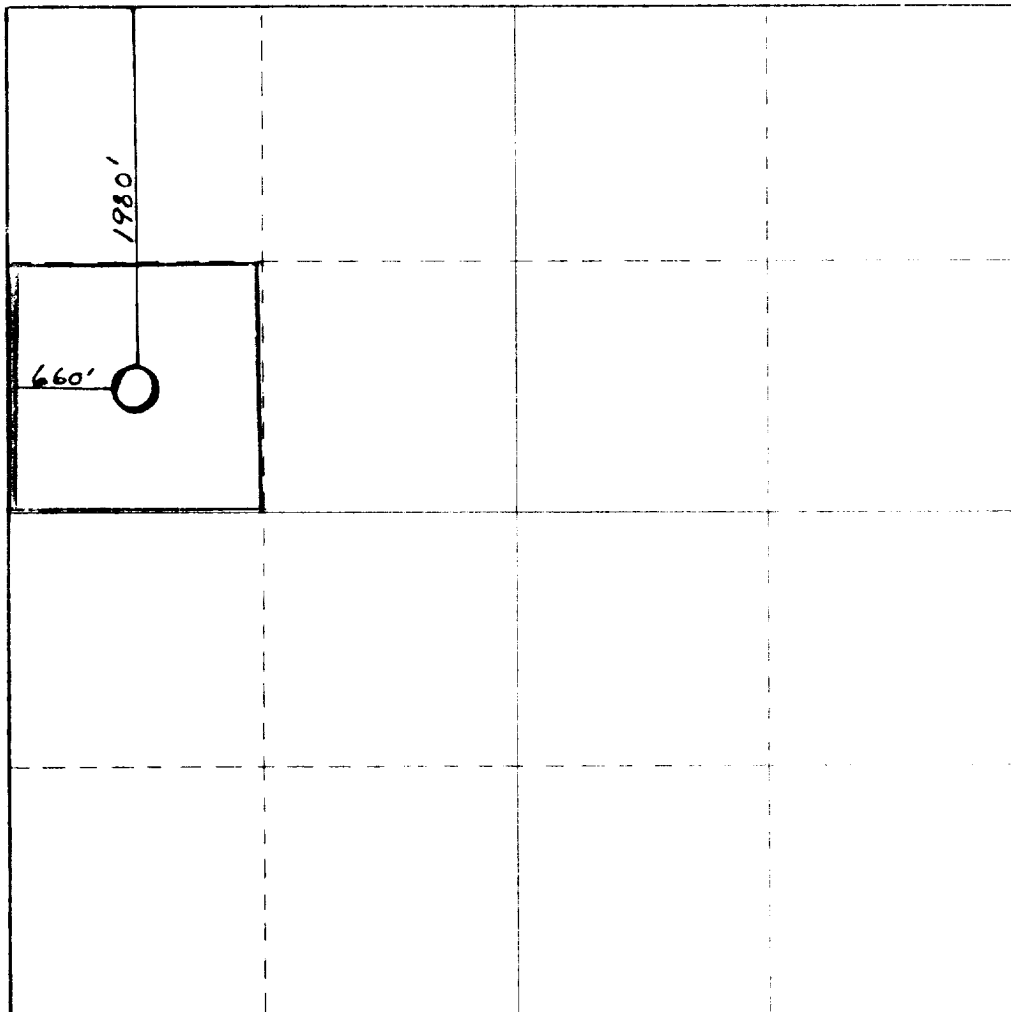

CERTIFICATION

I hereby certify that the information contained herein is true and complete to the best of my knowledge and belief.

Thudolgo

Vice President

Harvey E. Yates Company

May 29, 1979

I hereby certify that the well location shown on this plat was plotted from field notes of actual surveys made by me or under my supervision, and that the same is true and correct to the best of my knowledge and belief.

Please see original

survey

I hereby certify that the information contained herein is true and complete to the best of my knowledge and belief.

Notary Public

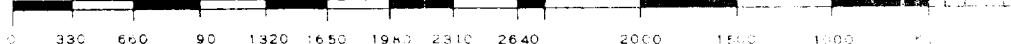

RECEIVED

MAY 3 1979

U.S. DEPARTMENT OF COMMERCE
WASHINGTON, D.C.

DRAWWORKS

Brewster N-75

Drum: 1¼" Lebus grooved

Compound: 2-engine oil bath chain drive

Brake: Hydromatic Parkersburg 40"

ENGINES

Two 610-H.P. D379TA Caterpillar Diesel.

DERRICK

Lee C. Moore, 131', 550,000 lb. nominal capacity.

SUBSTRUCTURE

Lee C. Moore, 14½' high, 550,000 lb. nominal capacity.

MUD PUMPS

Pump No. 1: Emsco DB700. 700 H.P. with steel fluid end. 4¾" - 7¾" liners, 16" stroke. Compound-driven.

Pump No. 2: NAT C-250, 350 H.P. Powered by D353 Caterpillar Diesel.

DRILL STRING

3000' 4½" Grade E, 20 lb.

Tool Joints: 4½" H-90, 6¼" OD,

11000' 4½" Grade E, 16.60 lb.

Tool Joints: 4" H-90, 6" OD

Thirty Drilco spiral-grooved 6½" OD, 2¼" ID. With 4" H-90 joints.

Other sized drillpipe & drillcollars available.

BLOWOUT PREVENTERS

One Shaffer LWS hydraulic double 10" x 1500 series. One Hydril 10" x 1500 series.

Choke manifold 4" x 1500 series flanged connections. Payne 4 valve accumulator closing unit.

MUD SYSTEM

3 - 30 x 7½ x 6 steel pits, with 700 Bbl. capacity. Complete low pressure circulating system, consisting of four submerged mud guns and two counter sunk jets in each pit. System utilizes a 6 x 8 centrifugal pump, powered by diesel.

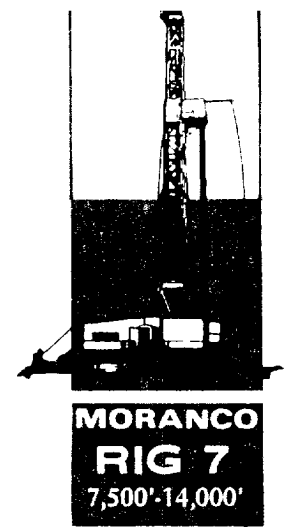

MUD HOUSE

One 8' x 30' Steel Storage House

COMMUNICATIONS

24-Hour direct telephone interconnection through Hobbs (A.C. 505-397-3291) or Midland - Odessa (A.C. 915-563-0562).

OTHER EQUIPMENT

BLOCKS Oilwell 350 Ton

HOOK BJ4300 350 Ton

SWIVEL - NAT N69 350 Ton

LIGHT PLANTS - One 40 KW and one 20 KW AC generators, powered by diesel engines.

LIGHTS - AC fluorescent or mercury - All vapor proof.

SHALE SHAKER - Lnk belt, single screen.

FRESH WATER STORAGE - two 500 Bbl., horizontal tanks.

HOUSING - 1 - 8' x 36' airconditioned trailer house, with sleeping and cooking facilities.

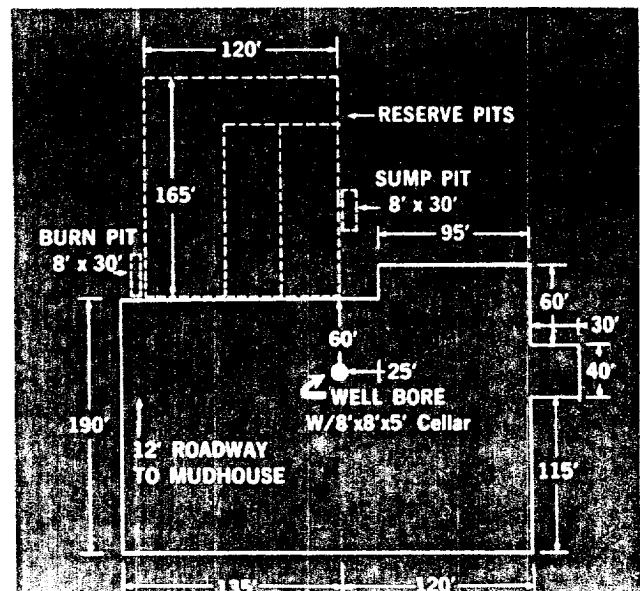
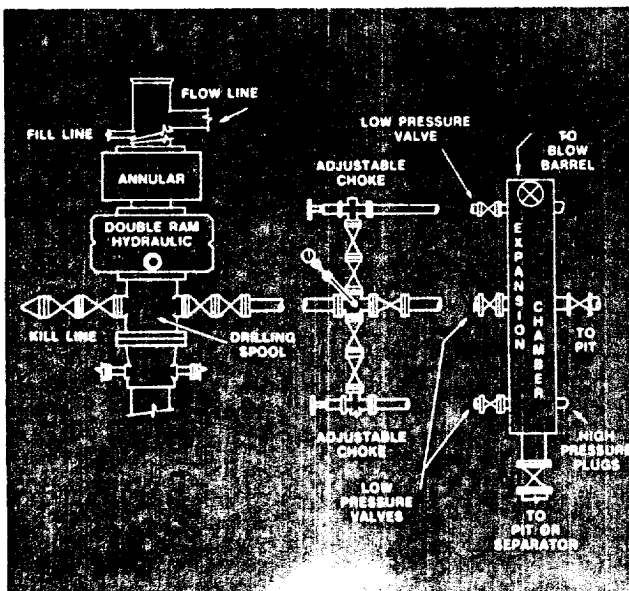

RECEIVED

MAY 3 1979

OIL CONSERVATION COMMISSION,
DENVER, CO.