

N. OF COPIES RECEIVED	
DISTRIBUTION	
SANTA FE	
FILE	
U.S.G.S.	
LAND OFFICE	
OPERATOR	

ME
NEW MEXICO OIL CONSERVATION COMMISSION

Form C-101
Revised 1-1-65

5A. Indicate Type of Lease	
STATE <input checked="" type="checkbox"/>	FEE <input type="checkbox"/>
5. State Oil & Gas Lease No.	
L-638	

APPLICATION FOR PERMIT TO DRILL, DEEPEN, OR PLUG BACK

1a. Type of Work		7. Unit Agreement Name	
b. Type of Well DRILL <input type="checkbox"/> DEEPEN <input type="checkbox"/> PLUG BACK <input checked="" type="checkbox"/>		8. Farm or Lease Name	
OIL WELL <input checked="" type="checkbox"/> GAS WELL <input type="checkbox"/> OTHER <input type="checkbox"/>		North Scharb State Unit	
2. Name of Operator		9. Well No.	
Mesa Petroleum Co		1	
3. Address of Operator		10. Field and Pool, or Wildcat	
1000 Vaughn Building/Midland, Texas 79701		Wildcat	
4. Location of Well		12. County	
UNIT LETTER E LOCATED 1980 FEET FROM THE North LINE		Lea	
AND 660 FEET FROM THE West LINE OF SEC. 32 TWP. 18S RGE. 35E NMPM			
19. Proposed Depth		19A. Formation	20. Rotary or C.T.
*		Yates	*
21. Elevations (Show whether DF, RT, etc.)	21A. Kind & Status Plug. Bond	21B. Drilling Contractor	22. Approx. Date Work will start
3928 GR	Blanket	*	6-7-78

23.

PROPOSED CASING AND CEMENT PROGRAM

SIZE OF HOLE	SIZE OF CASING	WEIGHT PER FOOT	SETTING DEPTH	SACKS OF CEMENT	EST. TOP

* See attached C-103 for details. Propose to set 250' cement plug in bottom of 9-5/8" casing and move out rotary tools. Will move in completion unit and attempt completion at perfs (in Yates) from 3389'---3688'.

IN ABOVE SPACE DESCRIBE PROPOSED PROGRAM: IF PROPOSAL IS TO DEEPEN OR PLUG BACK, GIVE DATA ON PRESENT PRODUCTIVE ZONE AND PROPOSED NEW PRODUCTIVE ZONE. GIVE BLOWOUT PREVENTER PROGRAM, IF ANY.

I hereby certify that the information above is true and complete to the best of my knowledge and belief.

Signed Michael P. Houston Title Division Engineer Date 6-2-78
(This space for State Use)

APPROVED BY Jerry Sexton TITLE DATE JUN 05 1978
CONDITIONS OF APPROVAL, IF ANY:

XC: JLF, JWH, MEC, FILE, N MOCD, W.I. OWNERS

NEW MEXICO OIL CONSERVATION COMMISSION
WELL LOCATION AND ACREAGE DEDICATION AT

Form C-102
Supersedes C-128
Effective 1-1-65

All distances must be from the outer boundaries of the Section

Operator Mesa Petroleum Co		Lease North Scharb State Unit		Well No. 1
Unit Letter E	Section 32	Township 18S	Range 35E	County Lea
Actual Footage Location of Well:				
1980 feet from the North line and		660 feet from the West line		
Ground Level Elev. 3928	Producing Formation Yates	Pool Wildcat	Dedicated Acreage: 40 Acres	

1. Outline the acreage dedicated to the subject well by colored pencil or hachure marks on the plat below.
2. If more than one lease is dedicated to the well, outline each and identify the ownership thereof (both as to working interest and royalty).
3. If more than one lease of different ownership is dedicated to the well, have the interests of all owners been consolidated by communitization, unitization, force-pooling, etc?

☐ Yes ☐ No If answer is "yes," type of consolidation _____

If answer is "no," list the owners and tract descriptions which have actually been consolidated. (Use reverse side of this form if necessary.) _____

No allowable will be assigned to the well until all interests have been consolidated (by communitization, unitization, forced-pooling, or otherwise) or until a non-standard unit, eliminating such interests, has been approved by the Commission.

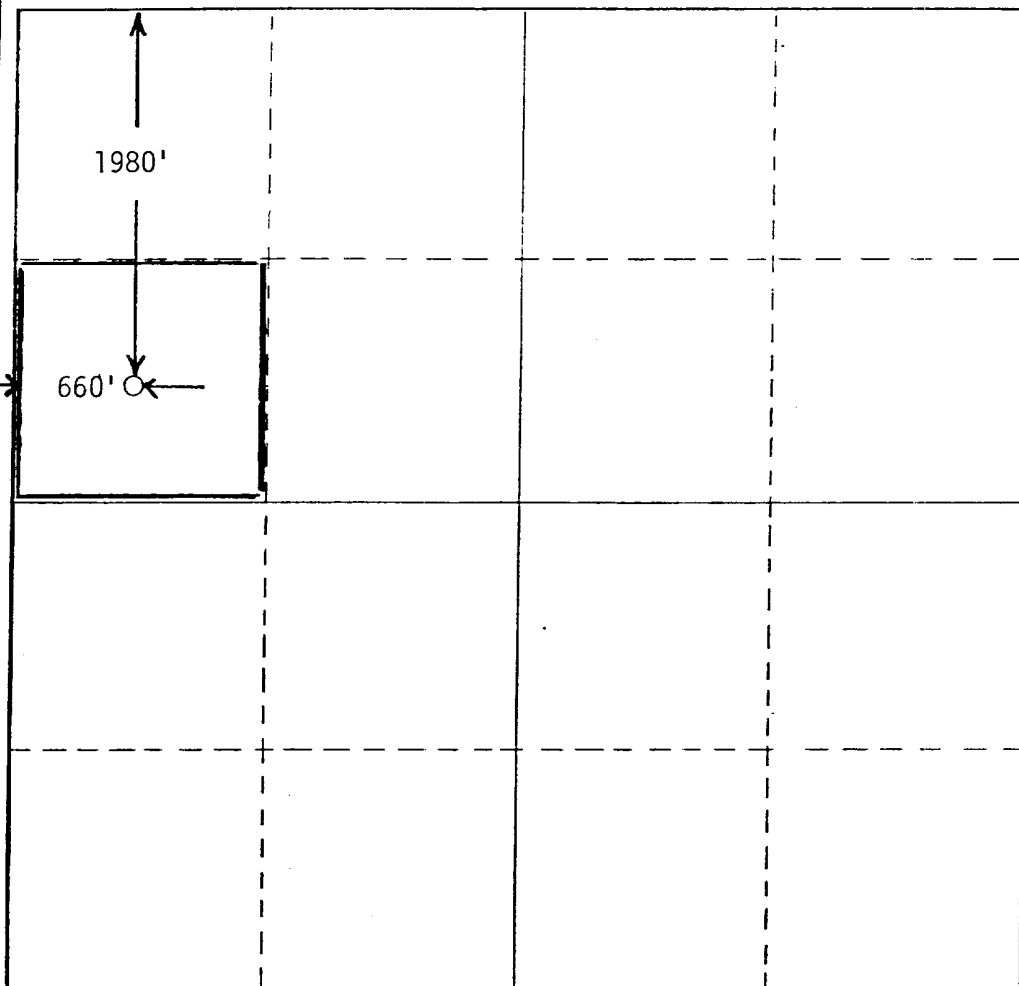

CERTIFICATION

I hereby certify that the information contained herein is true and complete to the best of my knowledge and belief.

Michael P. Houston

Name
Michael P. Houston

Position
Division Engineer

Company
Mesa Petroleum Co

Date
June 2, 1978

I hereby certify that the well location shown on this plat was plotted from field notes of actual surveys made by me or under my supervision, and that the same is true and correct to the best of my knowledge and belief.

Date Surveyed

Registered Professional Engineer and/or Land Surveyor

Certificate No.

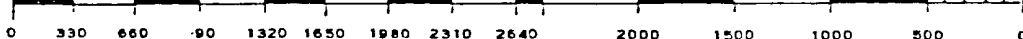

COPIES RECEIVED	
TRIBUTION	
FE	
FILE	
U.S.G.S.	
LAND OFFICE	
OPERATOR	

NEW MEXICO OIL CONSERVATION COMMISSION

Form C-103
Supersedes Old
C-102 and C-103
Effective 1-1-65

5a. Indicate Type of Lease	
State <input checked="" type="checkbox"/>	Fee <input type="checkbox"/>
5. State Oil & Gas Lease No. L-638	

SUNDRY NOTICES AND REPORTS ON WELLS

(DO NOT USE THIS FORM FOR PROPOSALS TO DRILL OR TO DEEPEN OR PLUG BACK TO A DIFFERENT RESERVOIR.
USE "APPLICATION FOR PERMIT -" (FORM C-101) FOR SUCH PROPOSALS.)

1. OIL WELL <input checked="" type="checkbox"/> GAS WELL <input type="checkbox"/> OTHER <input type="checkbox"/>		7. Unit Agreement Name
2. Name of Operator Mesa Petroleum Co		8. Farm or Lease Name North Scharb State Unit
3. Address of Operator 1000 Vaughn Building/Midland, Texas 79701		9. Well No. 1
4. Location of Well UNIT LETTER E 1980 FEET FROM THE North LINE AND 660 FEET FROM THE West LINE, SECTION 32 TOWNSHIP 18S RANGE 35E NMPM.		10. Field and Pool, or Wildcat Wildcat
15. Elevation (Show whether DF, RT, GR, etc.) 3928 GR		12. County Lea

Check Appropriate Box To Indicate Nature of Notice, Report or Other Data

NOTICE OF INTENTION TO:

PERFORM REMEDIAL WORK	<input type="checkbox"/>
TEMPORARILY ABANDON	<input type="checkbox"/>
PULL OR ALTER CASING	<input type="checkbox"/>

PLUG AND ABANDON	<input type="checkbox"/>
CHANGE PLANS	<input type="checkbox"/>

REMEDIAL WORK	<input type="checkbox"/>
COMMENCE DRILLING OPNS.	<input type="checkbox"/>
CASING TEST AND CEMENT JOB	<input type="checkbox"/>
OTHER	<input type="checkbox"/>

ALTERING CASING	<input type="checkbox"/>
PLUG AND ABANDONMENT	<input type="checkbox"/>

OTHER Plug & abandon lower portion of hole ☒

SUBSEQUENT REPORT OF:

17. Describe Proposed or Completed Operations (Clearly state all pertinent details, and give pertinent dates, including estimated date of starting any proposed work) SEE RULE 1103.

Drilled 8-3/4" hole to 13,044' on 5-31-78 (7:30 AM). Ran electric logs - no commercial zones of interest below 9-5/8" casing shoe at 5013' RKB. Contacted Oil Conservation Division (John Runyon) on 6-2-78 to obtain verbal approval to plug and abandon all open hole interval. Will set cement plugs as follows:

- 45 sx at 12,800'-12,900' (across Chester at 12,846')
- 45 sx at 11,950'-12,050' (across Atoka at 12,029')
- 45 sx at 10,950'-11,050' (across Wolfcamp at 11,020')
- 45 sx at 9,150'- 9,250' (across 1st Bone Spring at 9238')
- 45 sx at 5,250'- 5,350' (across San Andres at 5345')
- 100 sx at 4,750'- 5,000' (inside 9-5/8" casing shoe at 5013')

18. I hereby certify that the information above is true and complete to the best of my knowledge and belief.

SIGNED <u>Michael P. Houston</u>	TITLE <u>Division Engineer</u>	DATE <u>6-2-78</u>
APPROVED BY <u>Jerry Sexton</u> Dist. 1, Supv.	TITLE _____	DATE <u>JUN 05 1978</u>
CONDITIONS OF APPROVAL, IF ANY:		