

NE EXICO OIL CONSERVATION COMMISSIC  
WELL LOCATION AND ACREAGE DEDICATION FLAT

Form C-102  
Supersedes C-128  
Effective 1-1-65

All distances must be from the outer boundaries of the Section.

Operator Petroleum Development Corporation		Lease Sun McKay Federal		Well No. 2
Unit Letter G	Section 10	Township 19 South	Range 32 East	County Lea
Actual Footage Location of Well: 1980 feet from the north line and 1980 feet from the east line				
Ground Level Elev. 3660.6	Producing Formation Bone Springs	Pool East Lusk Bone Springs	Dedicated Acreage: 160 Acres	

1. Outline the acreage dedicated to the subject well by colored pencil or hachure marks on the plat below.
2. If more than one lease is dedicated to the well, outline each and identify the ownership thereof (both as to working interest and royalty).
3. If more than one lease of different ownership is dedicated to the well, have the interests of all owners been consolidated by communitization, unitization, force-pooling, etc?

☐ Yes ☐ No If answer is "yes," type of consolidation \_\_\_\_\_

If answer is "no," list the owners and tract descriptions which have actually been consolidated. (Use reverse side of this form if necessary.) \_\_\_\_\_

No allowable will be assigned to the well until all interests have been consolidated (by communitization, unitization, forced-pooling, or otherwise) or until a non-standard unit, eliminating such interests, has been approved by the Commission.

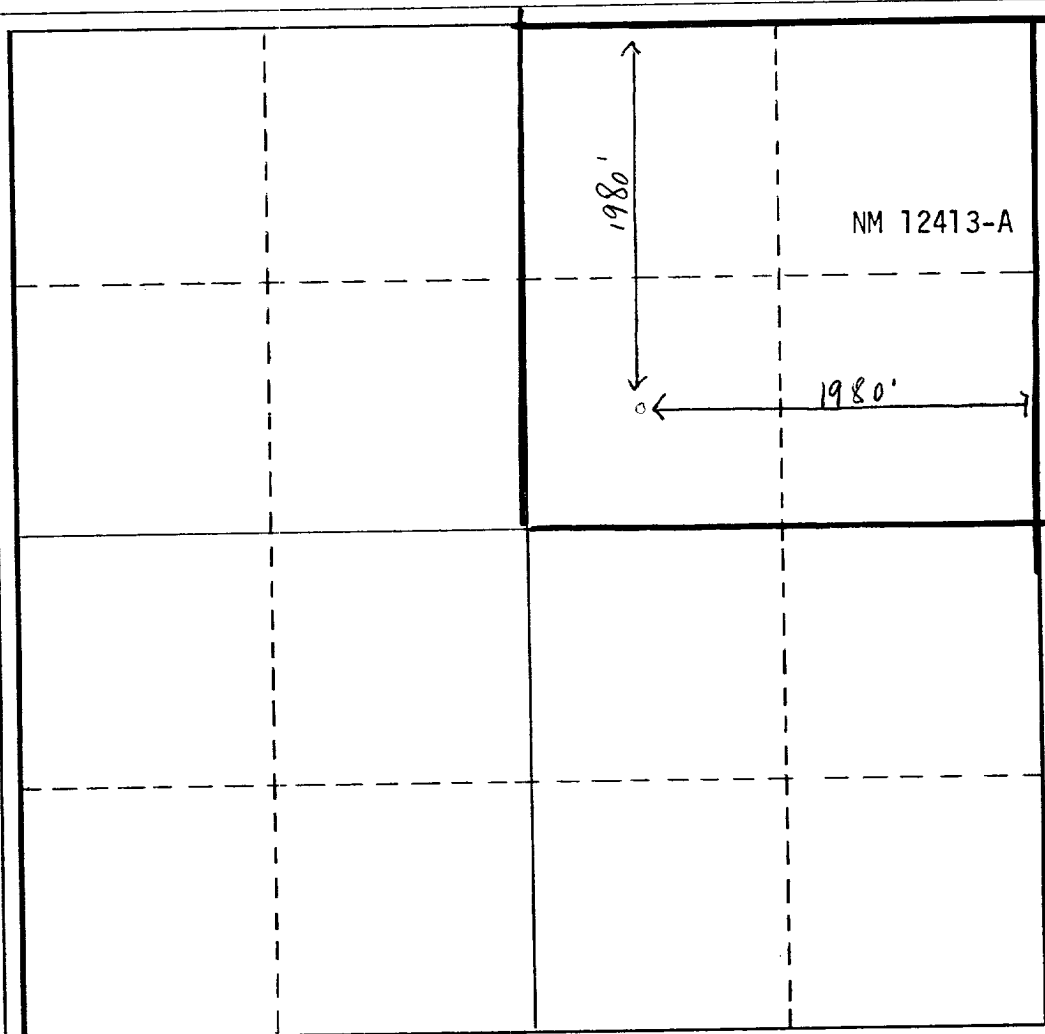

CERTIFICATION

I hereby certify that the information contained herein is true and complete to the best of my knowledge and belief.

*Charles W. Sanders*  
Name Charles W. Sanders

Vice President

Position

Petroleum Development Corp.

Company

3/8/79

Date

I hereby certify that the well location shown on this plat was plotted from field notes of actual surveys made by me or under my supervision, and that the same is true and correct to the best of my knowledge and belief.

ORIGINAL PLAT DATED  
1/16/78

Date Surveyed

Registered Professional Engineer  
and/or Land Surveyor

Certificate No.

