

NEW MEXICO OIL CONSERVATION COMMISSION
WELL LOCATION AND ACREAGE DEDICATION PLAT

Form C-112
Supersedes C-128
Effective 1-1-65

All distances must be from the outer boundaries of the Section

Owner Morris R. Antweil		Lease Teapot		Acres 1
Section J	Section 34	Range 18 South	Range 34 East	County Lea
Actual Section Location of Well 1650		feet from the South	feet from the East	
Ground Level Elev. 4000.5	Producing Formation Morrow	Section La Rica	Estimated Acreage 640	

- 1 Outline the acreage dedicated to the subject well by colored pencil or hatchure marks on the plat below.
- 2 If more than one lease is dedicated to the well, outline each and identify the ownership thereof (both as to working interest and royalty).
See Reverse Side.
- 3 If more than one lease of different ownership is dedicated to the well, have the interests of all owners been consolidated by communitization, unitization, force-pooling, etc?

☐ Yes ☒ No If answer is "yes," type of consolidation to be communitized

If answer is "no," list the owners and tract descriptions which have actually been consolidated (use reverse side of this form if necessary): _____

No allowable will be assigned to the well until all interests have been consolidated (by communitization, unitization, forced-pooling, or otherwise) or until a non-standard unit, eliminating such interests, has been approved by the Commission.

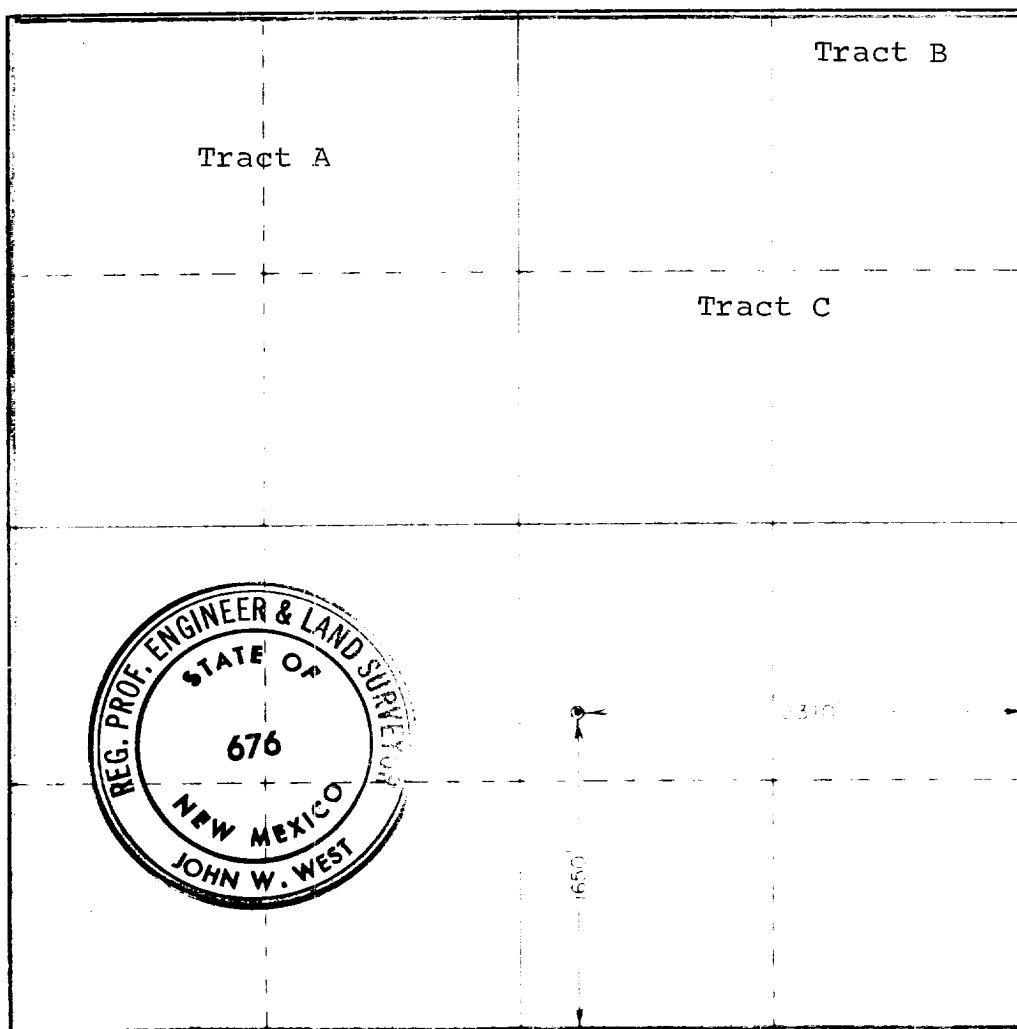

CERTIFICATION

I hereby certify that the information contained herein is true and complete to the best of my knowledge and belief

R. M. Williams

R. M. Williams

Agent

Morris R. Antweil

22 May, 1978

I hereby certify that the well location shown on this plat was plotted from field notes of actual surveys made by me or under my supervision, and that the same is true and correct to the best of my knowledge and belief

Date: **5/11/78**

Registered Professional Engineer
and Land Surveyor

John W. West

Certificate No. **John W. West 676**

Ronald J. Eidson 3239

Tract A - W/2 - State Lease No. E-5014

Lessee of Record: Bass Enterprises Production Company
& Perry R. Bass

Working Interest: Alan J. Antweil & NAPECO, Inc.

Tract B - NE/4 NE/4 - State Lease No. L-2375

Lessee of Record: David J. Sorenson

Working Interest: Alan J. Antweil

Tract C- NW/4 NE/4, S/2 NE/4 & SE/4 - State Lease No. LG-0188

Lessee of Record: Allied Chemical Corporation

Working Interest: Alan J. Antweil

All owners are prepared to communitized the 640 acres for the gas spacing
and preration unit for the proposed well.

157-20378
OIL FIELD NO. 0-188
LEASE, N. M.