

30-025-26422

NO. OF COPIES RECEIVED	
DISTRIBUTION	
SANTA FE	
FILE	
U.S.G.S.	
LAND OFFICE	
OPERATOR	

NEW MEXICO OIL CONSERVATION COMMISSION

Form C-101
Revised 1-1-66

5A. Indicate Type of Lease	
STATE <input checked="" type="checkbox"/>	FEE <input type="checkbox"/>
5. State Oil & Gas Lease No.	
B-2148	

APPLICATION FOR PERMIT TO DRILL, DEEPEN, OR PLUG BACK

1a. Type of Work		7. Unit Agreement Name	

b. Type of Well		8. Firm or Lease Name	
DRILL <input checked="" type="checkbox"/>	DEEPEN <input type="checkbox"/>	Leamex	
OIL WELL <input checked="" type="checkbox"/>	GAS WELL <input type="checkbox"/>		
SINGLE ZONE <input checked="" type="checkbox"/>		9. Well No.	
MULTIPLE ZONE <input type="checkbox"/>		22	
10. Name of Operator		10. UNDISCOVERED	
Phillips Petroleum Company		Maljamar Gb/San Andres	
3. Address of Operator			
Room 401, 4001 Penbrook St., Odessa, Texas 79762			
4. Location of Well			
UNIT LETTER H	LOCATED 660	FEET FROM THE East LINE	
AND 2310	FEET FROM THE North	LINE OF SEC. 23 TWP. 17-S RGE. 33-E N. 34-1/4	
		11. County	
		Lea	
		12. Proposed Depth	
		4700	
		13A. Formation	
		Gb/San Andres	
		13B. Rotary or C.T.	
		Rotary	
14. Elevation (State whether D.P., R.T., etc.)		21B. Drilling Contractor	
4115.6 GR (Unprepared)		Advise later	
21A. Kind & Status Plug. Bond		22. Approx. Date Work will start	
Blanket		Upon approval	

PROPOSED CASING AND CEMENT PROGRAM

SIZE OF HOLE	SIZE OF CASING	WEIGHT PER FOOT	SETTING DEPTH	SACKS OF CEMENT	EST. TOP
12-1/4"	8-5/8"	24# K-55	400'	(400 sx Class H w/2% CaCl ₂)	Circ at Surf.
				(and 1/4# Flocele/sx in 1st 150 sx)	
7-7/8"	4-1/2"	11.6#, N-80	4700'	(Sufficient TRLW w/)	Circ at Surf.
				(12# salt/sx, 10% DD, 1/4#)	
				(Flocele/sx, 3# Gilsomite/sx)	
				(followed by 150 sx Class H w/8#)	
				(salt/sx)	

Use mud additives as required for control.

BOP Equipment: Series 900, 3000# WP (Figure 7 Schematic attached)

IN ABOVE SPACE DESCRIBE PROPOSED PROGRAM: IF PROPOSAL IS TO DEEPEN OR PLUG BACK, GIVE DATA ON PRESENT PRODUCTIVE ZONE AND PROPOSED NEW PRODUCTIVE ZONE. GIVE BLOWOUT PREVENTER PROGRAM, IF ANY.

I hereby certify that the information above is true and complete to the best of my knowledge and belief.

Signed Roger J. Roper R. J. Roper Title Senior Reservoir Engineer Date July 27, 1979

(This space for State Use)

APPROVED BY [Signature] TITLE SUPERVISOR DISTRICT 1 DATE AUG 1 1979

CONDITIONS OF APPROVAL, IF ANY:

**NEW MEXICO OIL CONSERVATION COMMISSION
WELL LOCATION AND ACREAGE DEDICATION PLAT**

Form C-102
Supersedes C-128
Effective 1-1-65

All distances must be from the outer boundaries of the Section.

Operator PHILLIPS PETROLEUM COMPANY		Lease LEAMEX		Well No. 22
Unit Letter H	Section 23	Township 17 SOUTH	Range 33 EAST	County LEA
Actual Footage Location of Well: 2310 feet from the NORTH line and 660 feet from the EAST line				
Ground Level Elev. 4115.6 (Unprepared)	Producing Formation Grayburg/San Andres	Pool Maljamar Grayburg/San Andres	Dedicated Acreage: 40 Acres	

1. Outline the acreage dedicated to the subject well by colored pencil or hachure marks on the plat below.
2. If more than one lease is dedicated to the well, outline each and identify the ownership thereof (both as to working interest and royalty).
3. If more than one lease of different ownership is dedicated to the well, have the interests of all owners been consolidated by communitization, unitization, force-pooling, etc?

☐ Yes ☐ No If answer is "yes," type of consolidation _____

If answer is "no," list the owners and tract descriptions which have actually been consolidated. (Use reverse side of this form if necessary.) _____

No allowable will be assigned to the well until all interests have been consolidated (by communitization, unitization, forced-pooling, or otherwise) or until a non-standard unit, eliminating such interests, has been approved by the Commission.

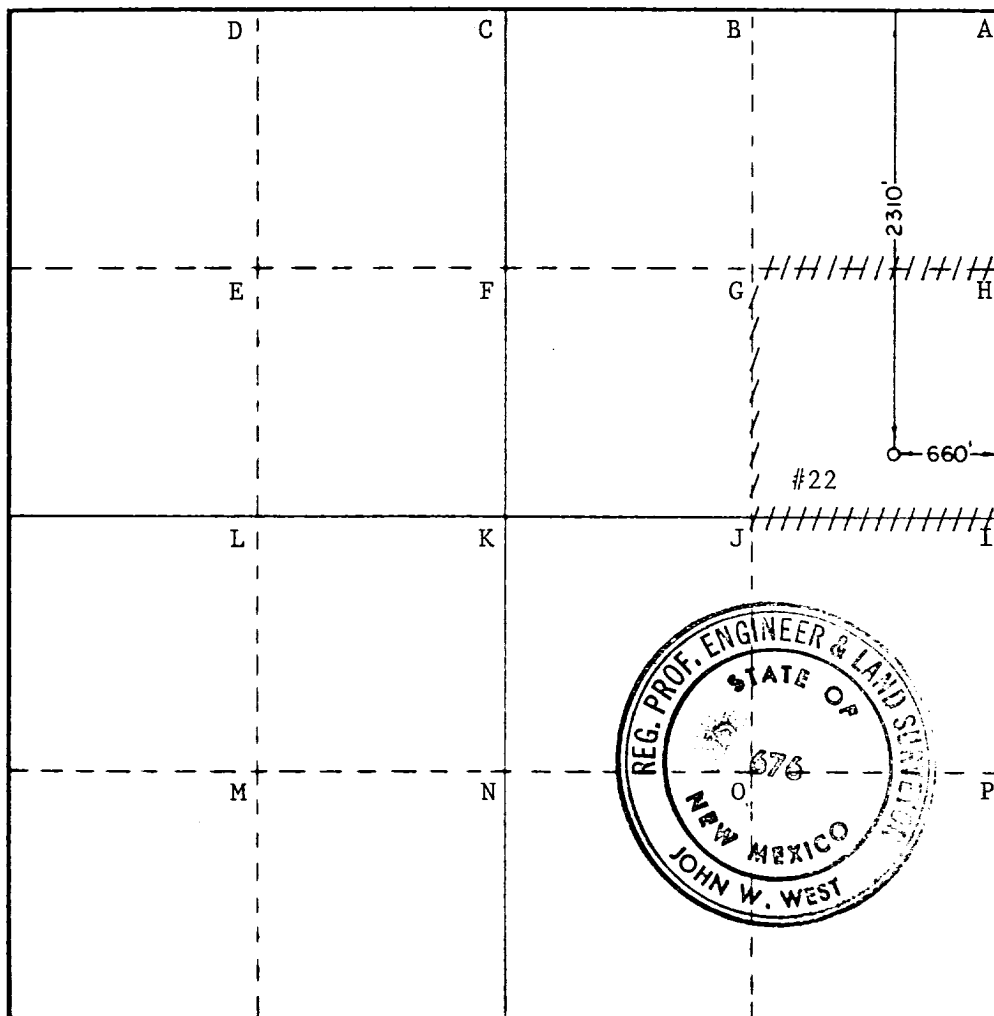

CERTIFICATION

I hereby certify that the information contained herein is true and complete to the best of my knowledge and belief.

Name
R. J. Roper *R. J. Roper*
Position
Senior Reservoir Engineer
Company
Phillips Petroleum Company
Date
July 27, 1979

I hereby certify that the well location shown on this plat was plotted from field notes of actual surveys made by me or under my supervision, and that the same is true and correct to the best of my knowledge and belief.

Date Surveyed
JULY 24TH, 1979

Registered Professional Engineer and/or Land Surveyor

John W. West
Certificate No. **John W. West**

676

DOUBLE PREVENTER OPTION

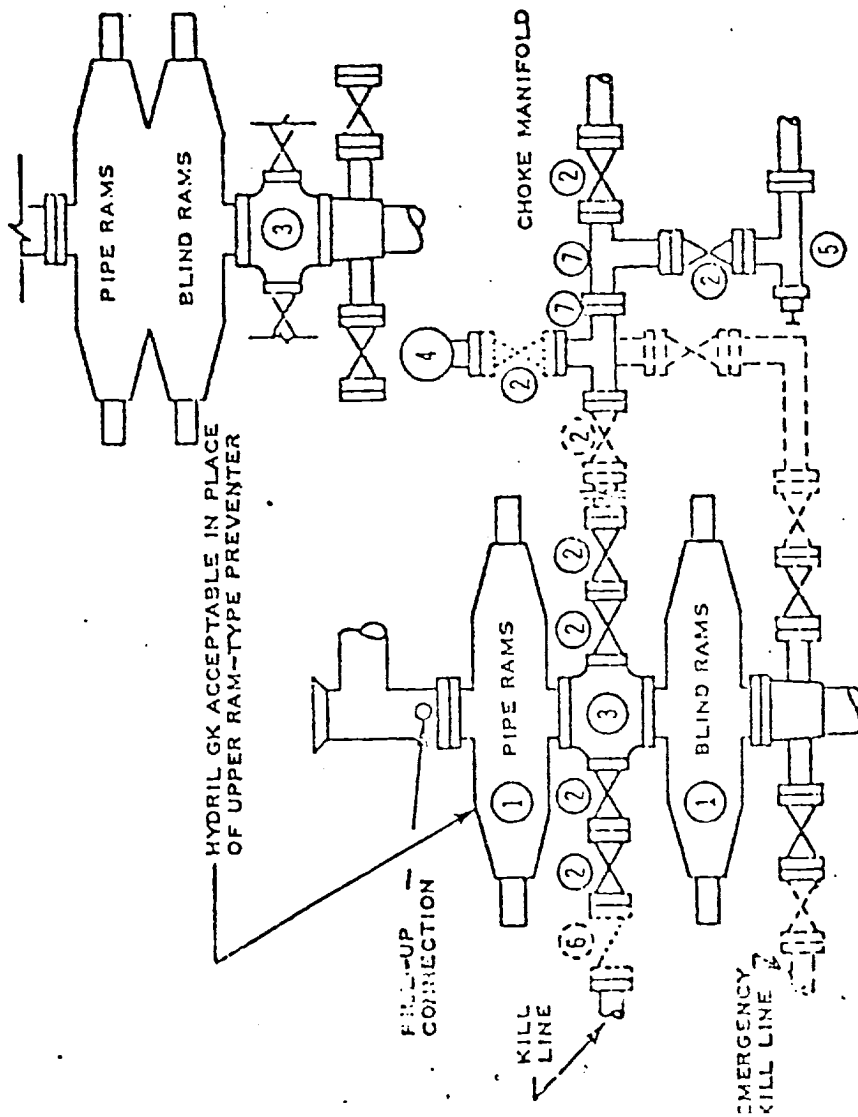

- ① SERIES 900 RAM-TYPE BOP
- ② 2" SERIES 900 VALVE
- ③ SERIES 900 DRILLING SPOOL
- ④ 2" MUD PRESSURE GAUGE
- ⑤ 2" SERIES 900 CHOKE
- ⑥ 2" SERIES 900 CHECK VALVE
- ⑦ 2" SERIES 900 STEEL TEE

NOTES:

1. 3000 PSI WP CLAMP HUGS MAY BE SUBSTITUTED FOR FLANGES
2. VALVES MAY BE EITHER HAND OR POWER OPERATED BUT, IF POWER OPERATED, THE VALVES FLANGED TO THE BOP RUN MUST BE CAPABLE OF BEING OPENED AND CLOSED MANUALLY OR CLOSE ON POWER FAILURE AND BE CAPABLE OF BEING OPENED MANUALLY

.....OPTIONAL EQUIPMENT

PHILLIPS PETROLEUM COMPANY

3000 PSI WORKING PRESSURE
BLOWOUT PREVENTER HOOK-UP
(SERIES 900 FLANGES OR BETTER)

RECEIVED
JUL 31 1973
Q.C.D. HOBBS. OFFICE

