

NO. OF COPIES RECEIVED	
DISTRIBUTION	
SANTA FE	
FILE	
U.S.G.S.	
LAND OFFICE	
OPERATOR	

NEW MEXICO OIL CONSERVATION COMMISSION

30-025-26443

Form C-101
Revised 1-1-65

5A. Indicate Type of Lease
STATE FEE

5. State Oil & Gas Lease No.

E- 7723

APPLICATION FOR PERMIT TO DRILL, DEEPEN, OR PLUG BACK

1a. Type of Work
b. Type of Well DRILL DEEPEN PLUG BACK
OIL WELL GAS WELL OTHER SINGLE ZONE MULTIPLE ZONE

2. Name of Operator
Energy Reserves Group, Inc.

3. Address of Operator
Box 2437, Midland, Tex. 79702

4. Location of Well UNIT LETTER I LOCATED 1980 FEET FROM THE South LINE AND 660 FEET FROM THE East LINE OF SEC. 8 TWP. 18 S RGE. 35 E NMPM

7. Unit Agreement Name
8. Farm or Lease Name TP- State
9. Well No. 1
10. Field and Pool, or Wildcat Buckeye Abo Surf
12. County Lea

19. Proposed Depth 9300 19A. Formation Abo 20. Rotary or C.T. Rotary

21. (Show whether DF, RI, etc.) 3946 3496 GL 21A. Kind & Status Plug. Bond Blanket on File 21B. Drilling Contractor MGF Drlg. Corp. 22. Approx. Date Work will start Aug. 27 1979

23.

PROPOSED CASING AND CEMENT PROGRAM

SIZE OF HOLE	SIZE OF CASING	WEIGHT PER FOOT	SETTING DEPTH	SACKS OF CEMENT	EST. TOP
17"	13 3/8"	48	350	280	CIRC
11"	8 5/8	32	3600	*	Base of Surf. casing
7 7/8"	4 1/2	10.5 & 11.6	9300	260	7800

* Intermediate casing DV tool at 1800; First Stage 550 sacks of cement, Second Stage 450 sacks of cement.

Use Shaffer Type 39E 10" Series 900 BOP (or equivalent) with Koomey Model E 26080-5 closing unit w/ remote control station

IN ABOVE SPACE DESCRIBE PROPOSED PROGRAM; IF PROPOSAL IS TO DEEPEN OR PLUG BACK, GIVE DATA ON PRESENT PRODUCTIVE ZONE AND PROPOSED NEW PRODUCTIVE ZONE. GIVE BLOWOUT PREVENTER PROGRAM, IF ANY.

I hereby certify that the information above is true and complete to the best of my knowledge and belief.

Signed *M. J. Sandidge* Title District Prod. Engineer Date 8-20-79

(This space for State Use)

SUPERVISOR DISTRICT 1

AUG 22 1979

APPROVED BY *Jerry Smith* TITLE DATE

CONDITIONS OF APPROVAL, IF ANY:

NEW MEXICO OIL CONSERVATION COMMISSION
WELL LOCATION AND ACREAGE DEDICATION PLAT

Form O-1
Supersedes O-124
Effective 1-1-65

All distances must be from the outer boundaries of the Section.

ENERGY RESERVES GROUP			Lease T.P. STATE		1
1	8	18 SOUTH	35 EAST	LEA	
1980	(feet from the)	SOUTH	(feet from the)	EAST	
3946		<i>abo</i>	<i>660</i>	<i>40</i>	

- Outline the acreage dedicated to the subject well by colored pencil or hatchure marks on the plat below.
- If more than one lease is dedicated to the well, outline each and identify the ownership thereof (both as to working interest and royalty).
- If more than one lease of different ownership is dedicated to the well, have the interests of all owners been consolidated by communitization, unitization, force-pooling, etc?

Yes No If answer is "yes" type of consolidation _____

If answer is "no" list the owners and tract descriptions which have actually been consolidated (Use reverse side of this form if necessary.) _____

No allowable will be assigned to the well until all interests have been consolidated (by communitization, unitization, forced-pooling, or otherwise) or until a non-standard unit, eliminating such interests, has been approved by the Commission.

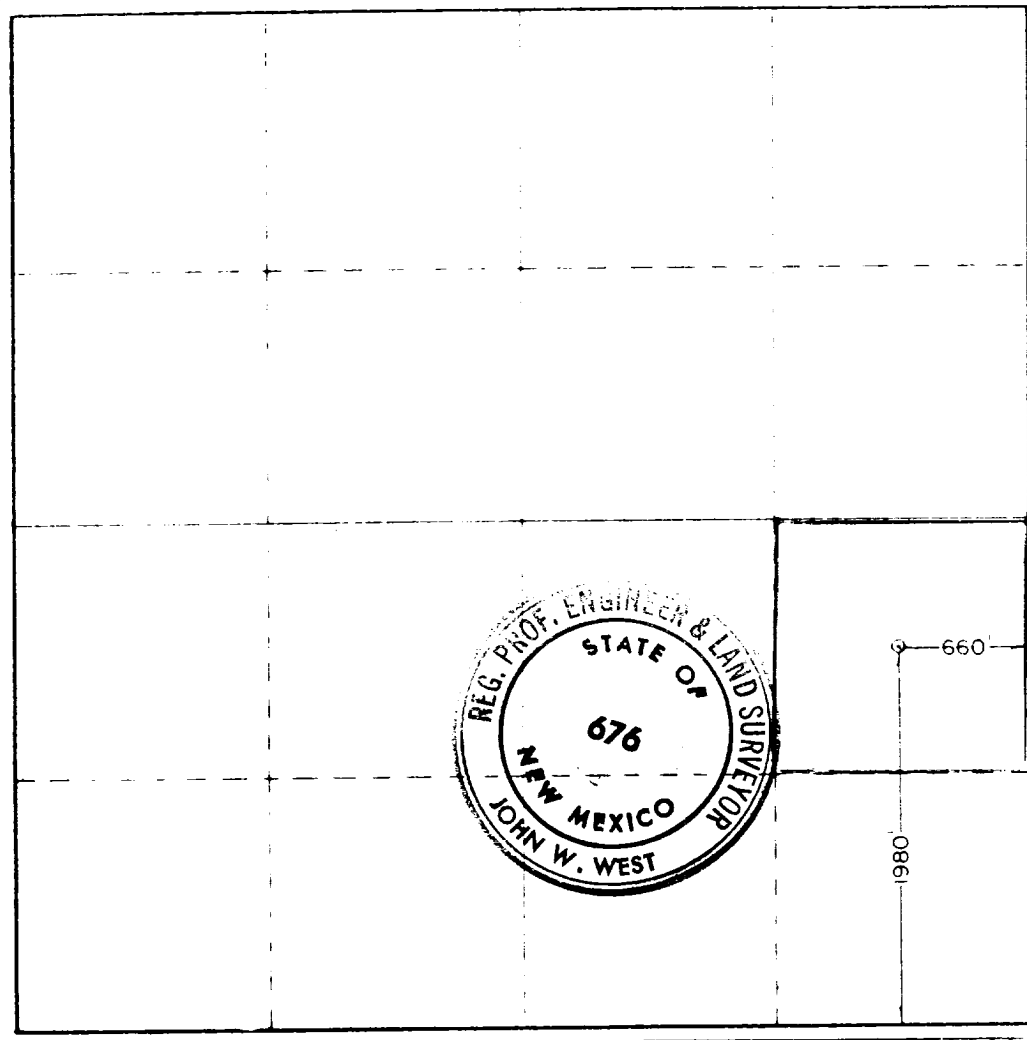

CERTIFICATION

I hereby certify that the information contained herein is true and complete to the best of my knowledge and belief.

W. J. Sandidge
W. J. Sandidge
Dist. Prod. Engineer

Energy Reserves Group, Inc.

8-20-79

I hereby certify that the well location shown on this plat was plotted from field notes of actual surveys made by me or under my supervision and that the same is true and correct to the best of my knowledge and belief.

AUGUST 18TH, 1979

Registered Professional Engineer
No. 676

John W. West
John W. West

Certificate No. John W. West 676
Ronald J. Eidson 3239

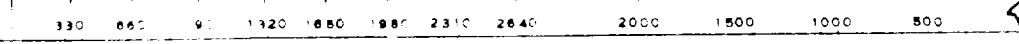

RECEIVED

21

AUG 14 1973
HOBBS, OFFICE

RECEIVED

AUG 14 1973

HOBBS, OFFICE

COUNTY LEA FIELD Vacuum STATE NM
 OPR ENERGY RESERVES GROUP, INC. API 30-025-26443
 NO 1 LEASE TP State MAP
Sec 8, T18S, R35E CO-ORD
1980' FSL, 660' FEL of Sec 12-3-12 NM
3 mi SE/Buckeye SPD 8-30-79 CMP 11-6-79

LOG	WELL CLASS: INIT <u>D</u> FIN <u>DO</u> ELEV L & S			
	FORMATION	DATUM	FORMATION	DATUM
13 3/8" at 369' w/275 sx				
8 5/8" at 3601' w/360 sx				
4 1/2" at 9165' w/685 sx				
	ID 9200' (ABRF)	PBD	9103'	

(Abo) Perf 8940-58' F 232 BOPD + 1 BW. Pot based on 24
 thru 20/64" chk. GOR (NR); gty (NR); CP Pkr; TP 130#

CONTR MGE #1 OPRSELEV 3946' GL PD 9300' RT

F.R. 8-27-79
 (Abo)
 9-11-79 Drlg 4825'
 9-25-79 Drlg 7553'
 10-2-79 Drlg 8186'
 10-10-79 Drlg 8866'
 10-17-79 TD 9200'; "Tight"
 10-23-79 TD 9200'; "Tight"
 12-10-79 TD 9200'; PBD 9103'; Complete
 Perf (Abo) 8940-58'
 Natural
 This Well Drilled "Tight",
 Will Re-Issue if "Tight" Information is Released
 12-15-79 COMPLETION ISSUED
 12-3-12 NM
 IC 30-025-70330-79