

NO. OF COPIES RECEIVED		
DISTRIBUTION		
SANTA FE		
FILE		
U.S.G.S.		
LAND OFFICE		
OPERATOR		

NEW MEXICO OIL CONSERVATION COMMISSION

30-025-26488

Form C-101
Revised 1-1-65

5A. Indicate Type of Lease	
STATE <input checked="" type="checkbox"/>	FEE <input type="checkbox"/>
5. State Oil & Gas Lease No.	
E-2520	

APPLICATION FOR PERMIT TO DRILL, DEEPEN, OR PLUG BACK

1a. Type of Work		7. Unit Agreement Name	
b. Type of Well OIL WELL <input checked="" type="checkbox"/> GAS WELL <input type="checkbox"/> OTHER <input type="checkbox"/>		8. Farm or Lease Name	
DRILL <input checked="" type="checkbox"/> DEEPEN <input type="checkbox"/> PLUG BACK <input type="checkbox"/>		State HQ	
2. Name of Operator		9. Well No.	
Amoco Production Company		1	
3. Address of Operator		10. Field and Pool, or Well Unit	
P. O. Box 68, Hobbs, NM 88240		Und. Airstrip Wolfcamp	
4. Location of Well		11. County	
UNIT LETTER <u>P</u> LOCATED <u>960</u> FEET FROM THE <u>South</u> LINE		Lea	
AND <u>330</u> FEET FROM THE <u>East</u> LINE OF SEC. <u>26</u> TWP. <u>18-S</u> RGE. <u>34-E</u> NMPM			
19. Proposed Depth		19A. Formation	20. Rotary or C.T.
10800'		Wolfcamp	Rotary
21. Elevations (show whether DT, RT, etc.)	21A. Kind & Status Plug. Bond	21B. Drilling Contractor	22. Approx. Date Work will start
3974.8	Blanket-on-File	Moranco #6	10-10-79

PROPOSED CASING AND CEMENT PROGRAM

SIZE OF HOLE	SIZE OF CASING	WEIGHT PER FOOT	SETTING DEPTH	SACKS OF CEMENT	EST. TOP
17-1/2"	13-3/8"	48#	300'	Circ	Surf
12-1/4"	9-5/8"	40#	4000'	Circ	Surf
8-3/4"	5-1/2" to *7"	17,20, & 23# 20,23, & 26#	10,800'	Tie back to 9-5/8"	Btm of 9-5/8"

*7" casing will be run if logs and DST data indicate possible dual completion in Bone Springs and Wolfcamp.

Propose to drill and equip well in the Wolfcamp zone. After reaching TD logs will be run and evaluated; perforate and/or stimulate as necessary in attempting commercial production.

Mud Program: 0-300' Native mud and fresh water.
300'-4000' Commercial mud and brine water.
4000'-TD Commercial mud and cut brine with minimum properties for safe hole conditions.

BOP Program Attached

IN ABOVE SPACE DESCRIBE PROPOSED PROGRAM: IF PROPOSAL IS TO DEEPEN OR PLUG BACK, GIVE DATA ON PRESENT PRODUCTIVE ZONE AND PROPOSED NEW PRODUCTIVE ZONE. GIVE BLOWOUT PREVENTER PROGRAM, IF ANY.

I hereby certify that the information above is true and complete to the best of my knowledge and belief.

Signed Ray G. [Signature] Title Administrative Supervisor Date 9-26-79
(This space for State Use)

APPROVED BY [Signature] TITLE SUPERVISOR DISTRICT I DATE SEP 27 1979

CONDITIONS OF APPROVAL, IF ANY:

0+5 NMOCD-H, 1-Houston, 1-Susp, 1-BD

NEW MEXICO OIL CONSERVATION COMMISSION
WELL LOCATION AND ACREAGE DEDICATION AT

Form O-102
Supersedes O-128
Effective 1-1-65

All distances must be from the outer boundaries of the Section

Operator AMOCO Production Co.			Lease State HQ			Well No. 1		
Grid Letter P	Section 26	Township 13 South	Range 34 East	County Lea				
Actual Well Location of Well:								
960		feet from the South		line and 330		feet from the East		line
Ground Surface Elev. 3974.3	Producing Formation Wolfcamp		Pool Und. Airstrip Wolfcamp			Dedicated Acreage 40		Acre

1. Outline the acreage dedicated to the subject well by colored pencil or hatchure marks on the plat below.
2. If more than one lease is dedicated to the well, outline each and identify the ownership thereof (both as to working interest and royalty).
3. If more than one lease of different ownership is dedicated to the well, have the interests of all owners been consolidated by communitization, unitization, force-pooling, etc?

☐ Yes ☐ No If answer is "yes," type of consolidation _____

If answer is "no," list the owners and tract descriptions which have actually been consolidated. (Use reverse side of this form if necessary.) _____

No allowable will be assigned to the well until all interests have been consolidated (by communitization, unitization, forced-pooling, or otherwise) or until a non-standard unit, eliminating such interests, has been approved by the Commission.

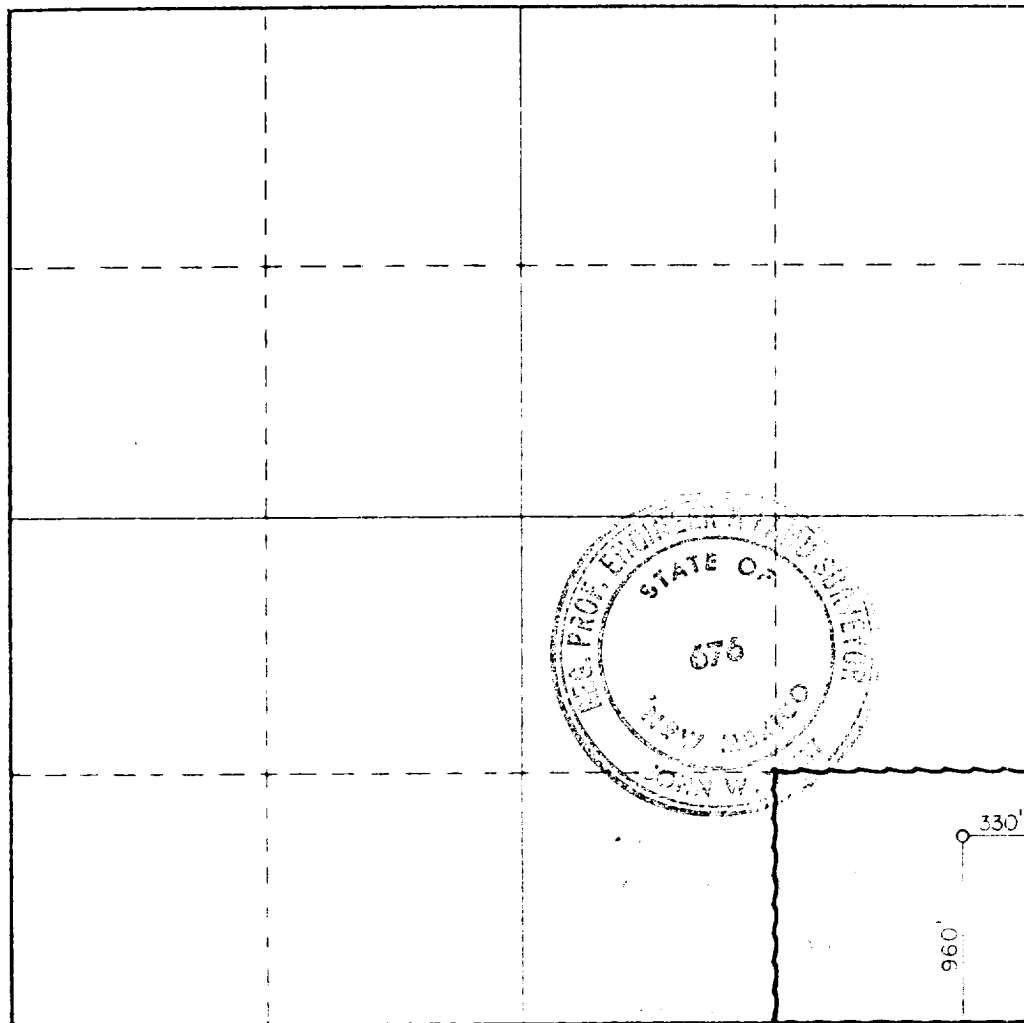

CERTIFICATION

I hereby certify that the information contained herein is true and complete to the best of my knowledge and belief.

Ray Cox
Name
Administrative Supervisor
Position
Amoco Production Company
Company

9-26-79

Date

I hereby certify that the well location shown on this plat was plotted from field notes of actual surveys made by me or under my supervision, and that the same is true and correct to the best of my knowledge and belief.

September 24, 1979
Registered Professional Engineer
in the State of New Mexico

John W. West
Certificate No. **John W. West** **676**
Ronald J. Eidson **3239**

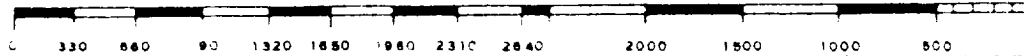

NOTES

1. Blow-out preventers and master valve to be fluid operated and oil fittings must be in good condition, 3,000# W.P. (6,000 p.s.i. test), minimum.
2. Equipment through which bit must pass shall be as large as the inside diameter of the casing that is being drilled through.
3. Nipple above blow-out preventer shall be same size as casing being drilled through.
4. Kelly cock required, 3,000# W.P. (6,000 p.s.i. test) minimum.
5. OMSCO or comparable safety valve must be available on rig floor at all times with proper connection or sub, 3,000# W.P. (6,000 p.s.i. test), minimum.
6. Blow-out preventers and master valve while drilling intermediate hole to 6000' may be 2,000# W.P. (4,000 p.s.i. test), minimum.
7. Choke assembly, beyond second valve from cross, may be positioned (Optional) outside of derrick foundation.
8. Spool or cross may be eliminated if connections are available in the lower part of the blow-out preventer body.
9. Plug valves - gate valves are optional. Valves shown as 2" are minimum size.
10. Casing head and casing head spool, including attached valves, to be furnished by Amoco.
11. Rams in preventers will be installed as follows:

When drilling, use:	When running casing, use:
Top Preventer - Drill pipe rams	Top Preventer - Casing rams
Bottom Preventer - Blind rams or master valve	Bottom Preventer - Blind rams or master valve

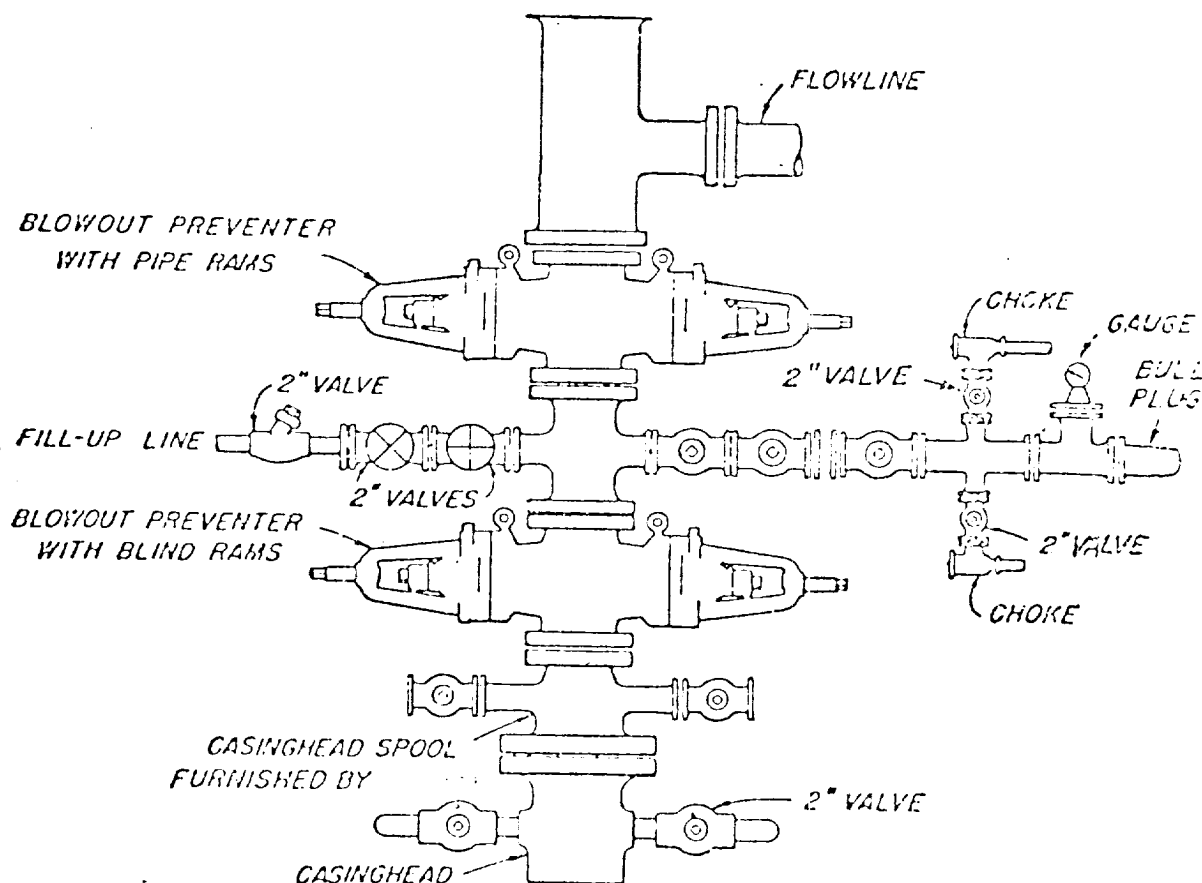

BLOWOUT PREVENTER HOOK-UP

AMOCO PRODUCTION COMPANY

EXHIBIT D-1 MODIFIED

JUNE 1, 1962

RECEIVED
SEP 30 1961
O.C.D. HOBBS, OFFICE

113