

NO. OF COPIES RECEIVED	
DISTRIBUTION	
SANTA FE	
FILE	
U.S.G.S.	
LAND OFFICE	
OPERATOR	

NEW MEXICO OIL CONSERVATION COMMISSION

Form C-101
Revised 1-1-65

5A. Indicate Type of Lease
STATE ☒ FEE ☐

5. State Oil & Gas Lease No.
L-4883

APPLICATION FOR PERMIT TO DRILL, DEEPEN, OR PLUG BACK

1a. Type of Work DRILL <input checked="" type="checkbox"/> DEEPEN <input type="checkbox"/> PLUG BACK <input type="checkbox"/>		7. Unit Agreement Name
b. Type of Well OIL WELL <input checked="" type="checkbox"/> GAS WELL <input type="checkbox"/> OTHER <input type="checkbox"/> SINGLE ZONE <input checked="" type="checkbox"/> MULTIPLE ZONE <input type="checkbox"/>		8. Farm or Lease Name State HR
2. Name of Operator Amoco Production Company		9. Well No. 1
3. Address of Operator P. O. Box 68, Hobbs, NM 88240		10. Field and Pool, or Wildcat Und. Airstrip Wolfcamp
4. Location of Well UNIT LETTER C LOCATED 330 FEET FROM THE North LINE AND 1980 FEET FROM THE West LINE OF SEC. 36 TWP. 18-S RGE. 34-E NMPM		12. County Lea
19. Proposed Depth 10,800'		19A. Formation Wolfcamp
20. Rotary or C.T. Rotary		
21. Elevations (show whether DT, RL, etc.) 3965.6 GL	21A. Kind & Status Plug, Bond Blanket-On-File	22. Approx. Date Work will start 11-5-79

PROPOSED CASING AND CEMENT PROGRAM

SIZE OF HOLE	SIZE OF CASING	WEIGHT PER FOOT	SETTING DEPTH	SACKS OF CEMENT	EST. TOP
17-1/2"	13-3/8"	48#	300'	Circ	Surf
12-1/4"	9-5/8"	40#	4000'	Circ	Surf
8-3/4"	*5-1/2" or 7"	17#, 20# & 23#	10800'	Tie back to 9-5/8"	Btm 9-5/8"

*7" 20#, 23#, 26# casing will be run to TD if evaluation of logs indicate dual Bone Springs and Wolfcamp commercial potential.

Propose to drill and equip well in the Wolfcamp Zone. After reaching TD, logs will be run and evaluated; perforate and/or stimulate as necessary in attempting commercial production.

Mud Program: 0 - 300' Native mud and fresh water.
300' - 4000' Native mud and brine water.
4000' - TD Commercial mud and cut brine with minimum properties for safe hole conditions.

BOP Program Attached

APPROVAL VALID
FOR 90 DAYS UNLESS
DRILLING COMMENCED,

DATE 12-30-1980

IN ABOVE SPACE DESCRIBE PROPOSED PROGRAM: IF PROPOSAL IS TO DEEPEN OR PLUG BACK, GIVE DATA ON PRESENT PRODUCTIVE ZONE AND PROPOSED NEW PRODUCTIVE ZONE. GIVE BLOWOUT PREVENTER PROGRAM, IF ANY.

I hereby certify that the information above is true and complete to the best of my knowledge and belief.

Signed Bob Davis Title Asst. Admin. Analyst Date 10-31-79

(This space for State Use)

APPROVED BY John A. Pumphrey TITLE Geologist DATE NOV - 1 1979

CONDITIONS OF APPROVAL, IF ANY:

0+4-NMOCD,H 1-Hou 1-Susp 1-BD 1-Mesa 1-Pacific Lighting Gas 1-Bass

RECEIVED
OCT 31 1977
O.C.D. HOBBS. OFFICE

NEW MEXICO OIL CONSERVATION COMMISSION
WELL LOCATION AND ACREAGE DEDICATION PLAT

Form O-128
Supersedes O-128
Effective 1-1-65

All distances must be from the outer boundaries of the Section

Operator AMOCO PRODUCTION Co.			Lease STATE H. R.		Well No. 1
Tract Letter C	Section 36	Township 12 South	Range 34 East	County Lee	
Actual Footage Location of Well: 330 feet from the North line and 1980 feet from the West line					
Ground Level Elev. 3965.6	Producing Formation Wolfcamp	Pool Und. Airstrip Wolfcamp		Dedicated Acreage 40	

1. Outline the acreage dedicated to the subject well by colored pencil or hatchure marks on the plat below.
2. If more than one lease is dedicated to the well, outline each and identify the ownership thereof (both as to working interest and royalty).
3. If more than one lease of different ownership is dedicated to the well, have the interests of all owners been consolidated by communitization, unitization, force-pooling, etc?

☐ Yes ☐ No If answer is "yes," type of consolidation _____

If answer is "no," list the owners and tract descriptions which have actually been consolidated (Use reverse side of this form if necessary.) _____

No allowable will be assigned to the well until all interests have been consolidated (by communitization, unitization, forced-pooling, or otherwise) or until a non-standard unit, eliminating such interests, has been approved by the Commission.

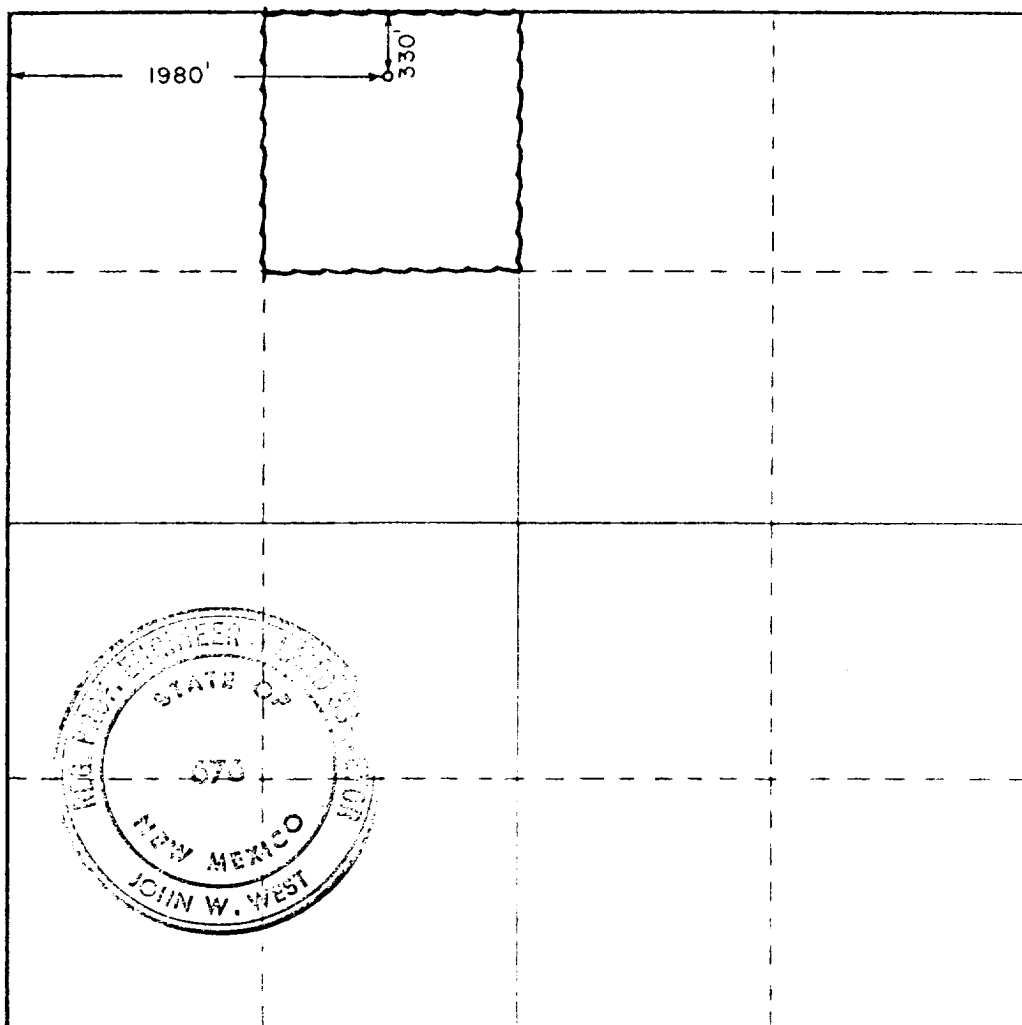

CERTIFICATION

I hereby certify that the information contained herein is true and complete to the best of my knowledge and belief.

Signature: **Bob Davis**

Position: **Asst. Admin. Analyst**

Company: **Amoco Production Company**

Date: **10-31-79**

I hereby certify that the well location shown on this plat was plotted from field notes of actual surveys made by me or under my supervision, and that the same is true and correct to the best of my knowledge and belief.

Date: **October 16, 1979**

Signature: **John W. West**

Certificate No. **John W. West 676**
Ronald J. Eidson 3239

0 330 660 990 1320 1650 1980 2310 2640 2970 3300 3630 3960 4290 4620 4950 5280 5610 5940 6270 6600

ATTACHMENT "B"
NOTES

1. Blow-out preventers and master valve to be fluid operated and oil fittings must be in good condition, 3,000# W.P. (6,000 p.s.i. test), minimum.
2. Equipment through which bit must pass shall be as large as the inside diameter of the casing that is being drilled through.
3. Nipple above blow-out preventer shall be same size as casing being drilled through.
4. Kelly cock required, 3,000# W.P. (6,000 p.s.i. test) minimum.
5. OMSCO or comparable safety valve must be available on rig floor at all times with proper connection or sub, 3,000# W.P. (6,000 p.s.i. test), minimum.
6. Blow-out preventers and master valve while drilling intermediate hole to 6000' may be 2,000# W.P. (4,000 p.s.i. test), minimum.
7. Choke assembly, beyond second valve from cross, may be positioned (Optional) outside of derrick foundation.
8. Spool or cross may be eliminated if connections are available in the lower part of the blow-out preventer body.
9. Plug valves - gate valves are optional. Valves shown as 2" are minimum size.
10. Casing head and casing head spool, including attached valves, to be furnished by Amoco.
11. Rams in preventers will be installed as follows:

When drilling, use: Top Preventer - Drill pipe rams Bottom Preventer - Blind rams or master valve	When running casing, use: Top Preventer - Casing rams Bottom Preventer - Blind rams or master valve
---	---

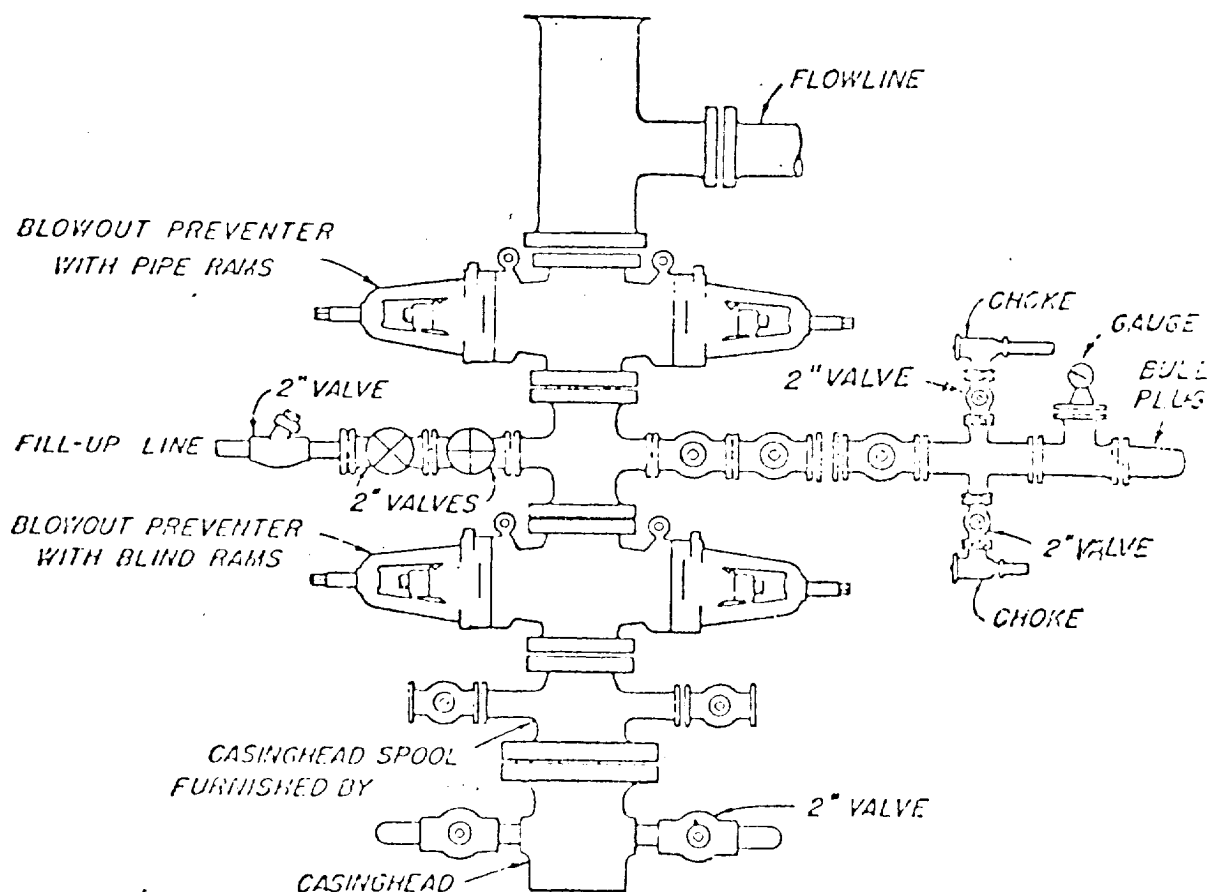

BLOWOUT PREVENTER HOOK-UP

AMOCO PRODUCTION COMPANY

EXHIBIT D-1 MODIFIED

JUNE 1, 1962



RECEIVED
OCT 31 1977
O.C.D. HOBBS, OFFICE