

30 025-26604

NO. OF COPIES RECEIVED	
DISTRIBUTION	
SANTA FE	
FILE	
U.S.G.S.	
LAND OFFICE	
OPERATOR	

NEW MEXICO OIL CONSERVATION COMMISSION

5-NMOCC-HOBBS
 1-R. J. STARRAK-TULSA
 1-A. B. CARY-MIDLAND
 1-PJB, ENGR.
 1-FILE

Form C-101
 Revised 1-1-65

5A. Indicate Type of Lease
 STATE ☒ FEE ☐

5. State Oil & Gas Lease No.

APPLICATION FOR PERMIT TO DRILL, DEEPEN, OR PLUG BACK

1a. Type of Work			7. Unit Agreement Name		
b. Type of Well DRILL <input checked="" type="checkbox"/> DEEPEN <input type="checkbox"/> PLUG BACK <input type="checkbox"/> OIL WELL <input checked="" type="checkbox"/> GAS WELL <input type="checkbox"/> OTHER <input type="checkbox"/> SINGLE ZONE <input type="checkbox"/> MULTIPLE ZONE <input type="checkbox"/>			8. Farm or Lease Name Hobbs "N"		
2. Name of Operator Getty Oil Company			9. Well No. 5		
3. Address of Operator P. O. Box 730, Hobbs, New Mexico			10. Field and Pool, or Wildcat Vac. Abo Reef		
4. Location of Well UNIT LETTER <u>H</u> LOCATED <u>1980</u> FEET FROM THE <u>North</u> LINE AND <u>330</u> FEET FROM THE <u>East</u> LINE OF SEC. <u>8</u> TWP. <u>18S</u> RGE. <u>35E</u> N.M.P.M.			12. County Lea		
21. Elevations (Show whether DE, RT, etc.) 3946.6 G.L.			21A. Kind & Status Plug. Bond Blanket		21B. Drilling Contractor Pending
19. Proposed Depth 9200			19A. Formation Vac. Abo Reef		20. Rotary or C.T. Rotary
22. Approx. Date Work will start Pending					

23.

PROPOSED CASING AND CEMENT PROGRAM

SIZE OF HOLE	SIZE OF CASING	WEIGHT PER FOOT	SETTING DEPTH	SACKS OF CEMENT	EST. TOP
15	11 3/4	42	300	215	Surface
10 5/8	8 5/8	24 & 32	3300	515	Surface
7 7/8	5 1/2	15.5 & 17	9200	1450	Surface

It is proposed to drill the subject well from the surface to a total depth of approximately 9200' with rotary tools to test the Vac. Abo Reef formation for oil. The pump and plug process will be used for cementing all strings of casing, and cement will be circulated to the surface on the 11 3/4", 8 5/8", and 5 1/2" casing. The 5 1/2" casing will be perforated as indicated by electric logs opposite the Vac. Abo Reef formation.

The drilling fluid will be brine water and mud of sufficient weight to condition hole for logging and running casing to 9200'. Blowout preventors will be installed and tested to 5000 psi.

NOTE: A DV tool will be set at 4000' in the 5 1/2" casing.

IN ABOVE SPACE DESCRIBE PROPOSED PROGRAM: IF PROPOSAL IS TO DEEPEN OR PLUG BACK, GIVE DATA ON PRESENT PRODUCTIVE ZONE AND PROPOSED NEW PRODUCTIVE ZONE. GIVE BLOWOUT PREVENTER PROGRAM, IF ANY.

I hereby certify that the information above is true and complete to the best of my knowledge and belief.

Signed Dale R. Crockett Title Area Superintendent Date 12-17-79

(This space for State Use)

APPROVED BY [Signature] TITLE SUPERVISOR DISTRICT 1 DATE DEC 21 1979

CONDITIONS OF APPROVAL, IF ANY:

OBBS "N" NO. 5

5000 PSI WORKING PRESSURE
DRILLING CONTROL HOOK-UP

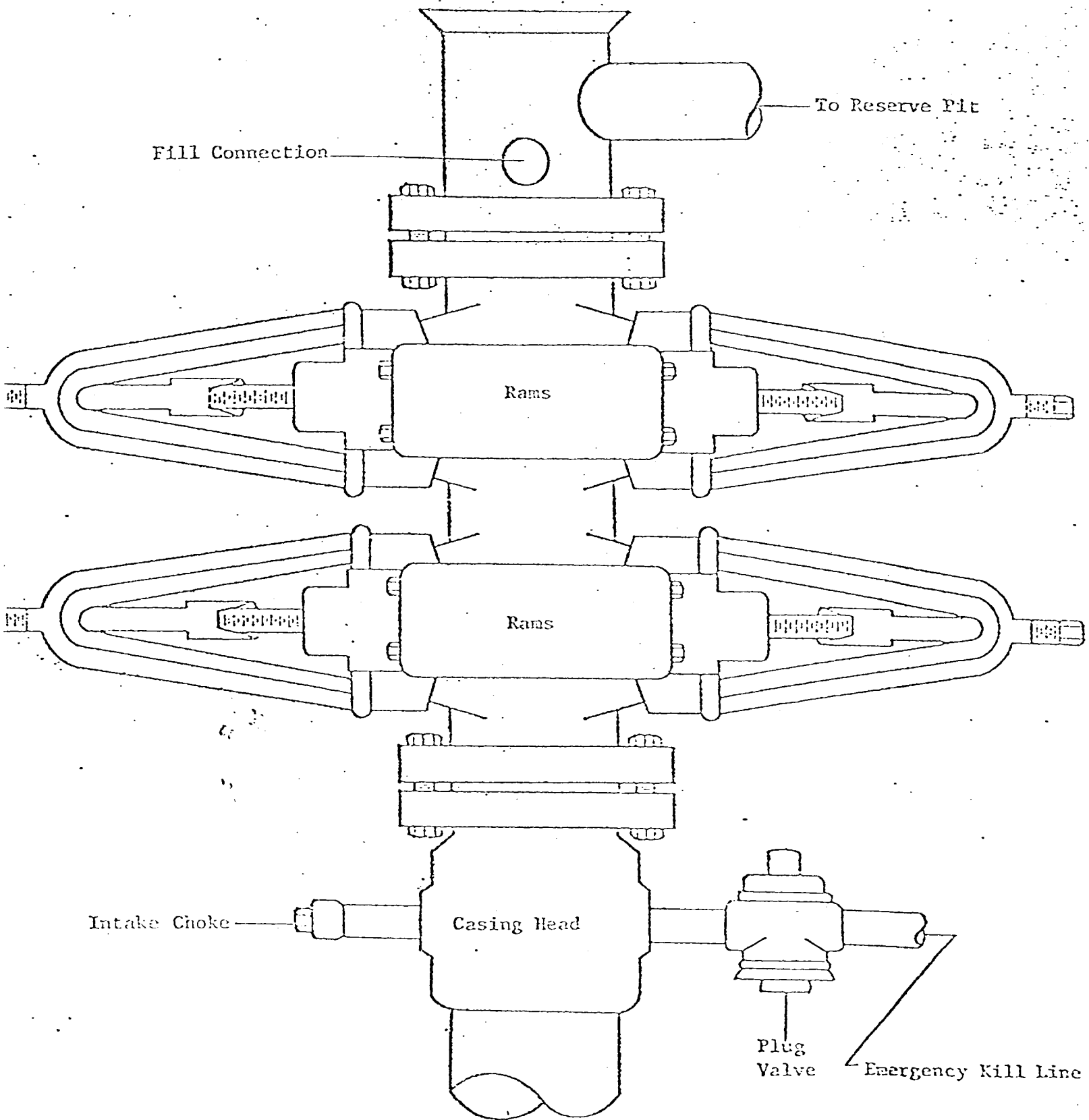

NEW MEXICO OIL CONSERVATION COMMISSION
WELL LOCATION AND ACREAGE DEDICATION PLAT

Form O-128
Supersedes O-128
Effective 1-1-55

All distances must be from the outer boundaries of the Section

Lease		Hobbs "N"		Well No. 5	
Section	Township	Range	County		
5	18 South	35 East	Lea		
1280 feet from the North line and 330 feet from the East line Producing Formation: Vac. Abo Reef Pool: Vac. Abo Reef Dedicated Acreage: 40 Acres					

1. Outline the acreage dedicated to the subject well by colored pencil or hatchure marks on the plat below.
2. If more than one lease is dedicated to the well, outline each and identify the ownership thereof (both as to working interest and royalty).
3. If more than one lease of different ownership is dedicated to the well, have the interests of all owners been consolidated by communization, unitization, force-pooling, etc?

☐ Yes ☐ No If answer is "yes," type of consolidation _____

If answer is "no," list the owners and tract descriptions which have actually been consolidated. (Use reverse side of this form if necessary.) _____

No allowable will be assigned to the well until all interests have been consolidated (by communization, unitization, forced-pooling, or otherwise) or until a non-standard unit, eliminating such interests, has been approved by the Commission.

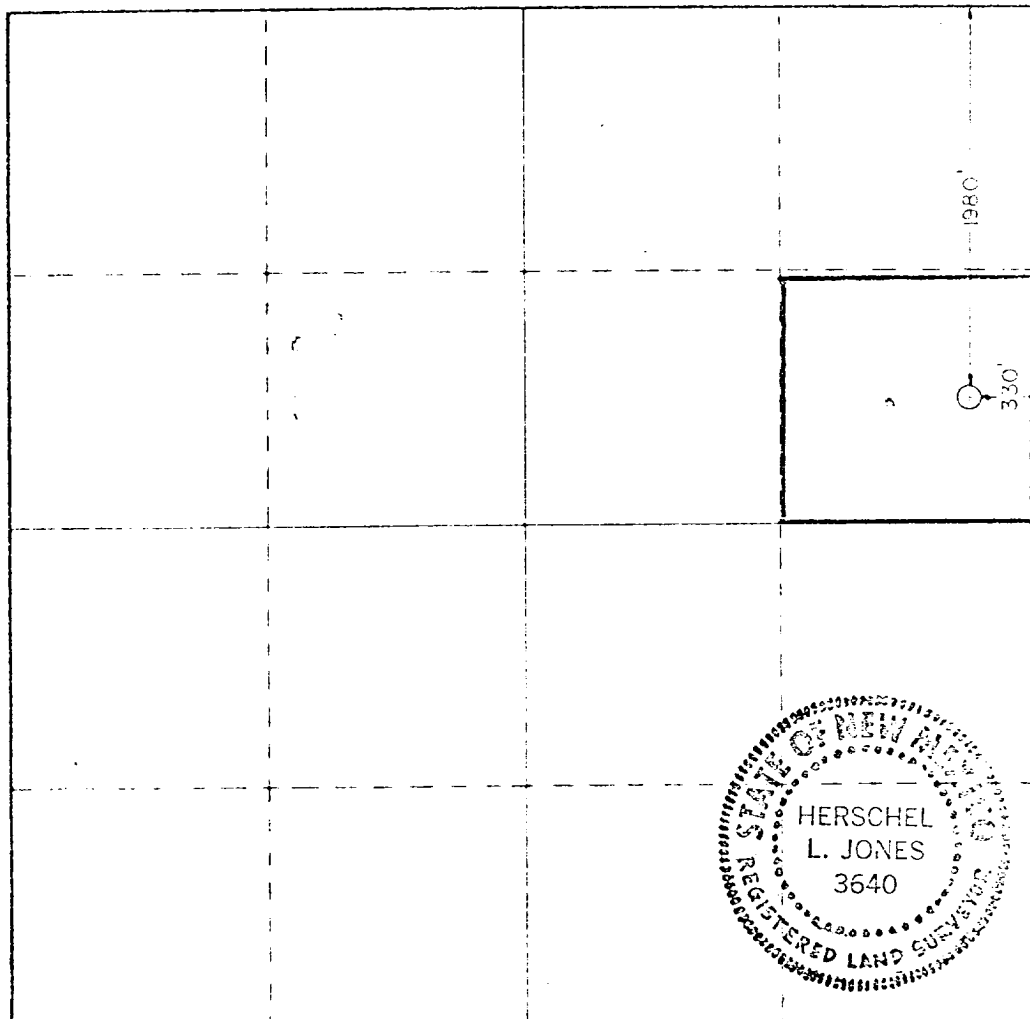

CERTIFICATION

I hereby certify that the information contained herein is true and complete to the best of my knowledge and belief.

Dale R. Crockett

Dale R. Crockett

Position

Area Superintendent

Company

Getty Oil Company

Date

December 17, 1979

I hereby certify that the well location shown on this plat was plotted from field notes of actual surveys made by me or under my supervision, and that the same is true and correct to the best of my knowledge and belief.

Date Surveyed

December 12, 1979

Registered Professional Engineer
and Professional Surveyor

