

NO. OF COPIES RECEIVED		
DISTRIBUTION		
SANTA FE		
FILE		
U.S.G.S.		
LAND OFFICE		
TRANSPORTER	OIL	
	GAS	
OPERATOR		
PRORATION OFFICE		

NEW MEXICO OIL CONSERVATION COMMISSION
REQUEST FOR ALLOWABLE
AND
AUTHORIZATION TO TRANSPORT OIL AND NATURAL GAS

Form C-104
Supersedes Old C-104 and C-110
Effective 1-1-65

API No. 30-025-26668

I. Operator
Phillips Petroleum Company
Address
Room 401, 4001 Penbrook, Odessa, Texas 79762
Reason(s) for filing (Check proper box)
New Well ☒ Change in Transporter of:
Recompletion ☐ Oil ☐ Dry Gas ☐
Change in Ownership ☐ Casinghead Gas ☐ Condensate ☐
Other (Please explain)

If change of ownership give name
and address of previous owner

II. DESCRIPTION OF WELL AND LEASE

Lease Name U. S. Minerals	Well No. 5	Pool Name, Including Formation Maljamar Gb/SA	Kind of Lease State, Federal or Fee Federal	Lease No. NM-801
Location Unit Letter 'O' ; 990 Feet From The South Line and 1650 Feet From The East Line of Section 30 Township 17-S Range 33-E , NMPM, Lea County				

III. DESIGNATION OF TRANSPORTER OF OIL AND NATURAL GAS

Name of Authorized Transporter of Oil <input checked="" type="checkbox"/> or Condensate <input type="checkbox"/> Texas-New Mexico Pipeline	Address (Give address to which approved copy of this form is to be sent) P. O. Box 2528, Hobbs, New Mexico 88240					
Name of Authorized Transporter of Casinghead Gas <input checked="" type="checkbox"/> or Dry Gas <input type="checkbox"/> Phillips Petroleum Company	Address (Give address to which approved copy of this form is to be sent) 4001 Penbrook, Odessa, Texas 79762					
If well produces oil or liquids, give location of tanks.	Unit 0	Sec. 30	Twp. 17-S	Rge. 33-E	Is gas actually connected? Yes	When April 28, 1980

If this production is commingled with that from any other lease or pool, give commingling order number:

IV. COMPLETION DATA

Designate Type of Completion - (X)	Oil Well <input checked="" type="checkbox"/>	Gas Well <input type="checkbox"/>	New Well <input checked="" type="checkbox"/>	Workover <input type="checkbox"/>	Deepen <input type="checkbox"/>	Plug Back <input type="checkbox"/>	Same Rest'v. <input type="checkbox"/>	Diff. Rest'v. <input type="checkbox"/>
Date Spudded March 16, 1980	Date Compl. Ready to Prod. April 14, 1980		Total Depth 4500'		P.B.T.D. 4430'			
Elevations (DF, RKB, RT, GR, etc.) 4041' RKB 4033' GR	Name of Producing Formation Grayburg/San Andres		Top Oil/Gas Pay 3908'		Tubing Depth 4362'			
Perforations 4226'-4425'					Depth Casing Shoe 4449'			
TUBING, CASING, AND CEMENTING RECORD								
HOLE SIZE	CASING & TUBING SIZE		DEPTH SET		SACKS CEMENT			
11"	8-5/8"		1265' (w/570 sxs Cl "H" w/2% CaCl and 1/4# Cele-		(ophane flakes. Circ 75 sxs to surface.)			
7-7/8"	5-1/2"		4449' (w/800 sxs TLW w/12# salt, 10% DD, 1/4#		(Celoflakes, Kolite and 150 sxs Cl "H" w/5# salt. Circ to surface.)			

V. TEST DATA AND REQUEST FOR ALLOWABLE OIL WELL (Test must be after recovery of total volume of load oil and must be equal to or exceed top allowable for this depth or be for full 24 hours)

Date First New Oil Run To Tanks April 28, 1980	Date of Test April 28, 1980	Producing Method (Flow, pump, gas lift, etc.) Pump	
Length of Test 24 hours	Tubing Pressure ---	Casing Pressure ---	Choke Size ---
Actual Prod. During Test	Oil-Bbls. 70	Water-Bbls. 288	Gas-MCF 92

GAS WELL

Actual Prod. Test-MCF/D	Length of Test	Bbls. Condensate/MMCF	Gravity of Condensate
Testing Method (pitot, back pr.,	Tubing Pressure (Shut-in)	Casing Pressure (Shut-in)	Choke Size

VI. CERTIFICATE OF COMPLIANCE

I hereby certify that the rules and regulations of the Oil Conservation Commission have been complied with and that the information given above is true and complete to the best of my knowledge and belief.

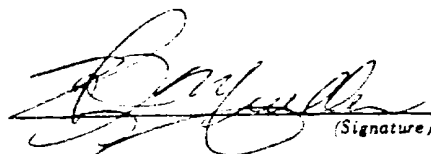
W. J. Mueller
Senior Engineering Specialist
(Title)

June 11, 1980
(Date)

jj

OIL CONSERVATION COMMISSION

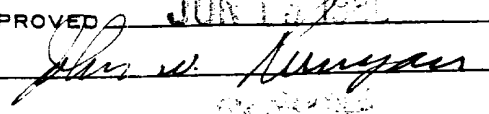
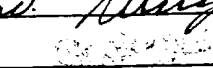
APPROVED JUN 13 1980, 19
BY 
TITLE 

This form is to be filed in compliance with RULE 1104.

If this is a request for allowable for a newly drilled or deepened well, this form must be accompanied by a tabulation of the deviation tests taken on the well in accordance with RULE 111.

All sections of this form must be filled out completely for allowable on new and recompleted wells.

Fill out only Sections I, II, III, and VI for changes of owner, well name or number, or transporter, or other such change of condition.

Separate Forms C-104 must be filed for each pool in multiply completed wells.

NEW MEXICO OIL CONSERVATION COMMISSION
WELL LOCATION AND ACREAGE DEDICATION PLAT

Form O-102
Supersedes O-128
Effective 1-1-75

All distances must be from the outer boundaries of the Section.

Owner Phillips Petroleum Co.		Lease U.S. Minerals		Section 5
North 0	West 30	South 17 South	East 33 East	Lea
Actual well location (feet) 990 South 1650 East				
Section 4029.2 (unprepared)	Tract Grayburg-San Andres		Block Maljamar Gb/SA	Acres 40

- Outline the acreage dedicated to the subject well by colored pencil or hatchure marks on the plat below.
- If more than one lease is dedicated to the well, outline each and identify the ownership thereof (both as to working interest and royalty).
- If more than one lease of different ownership is dedicated to the well, have the interests of all owners been consolidated by communitization, unitization, forced-pooling, etc?

Yes ☐ No ☐ If answer is "yes" type of consolidation _____

If answer is "no" list the owners and tract descriptions which have actually been consolidated. (Use reverse side of this form if necessary.) _____

No allowable will be assigned to the well until all interests have been consolidated (by communitization, unitization, forced-pooling, or otherwise) or until a non-standard unit, eliminating such interests, has been approved by the Commission. *This well will share the proration allowable with Well No. 4

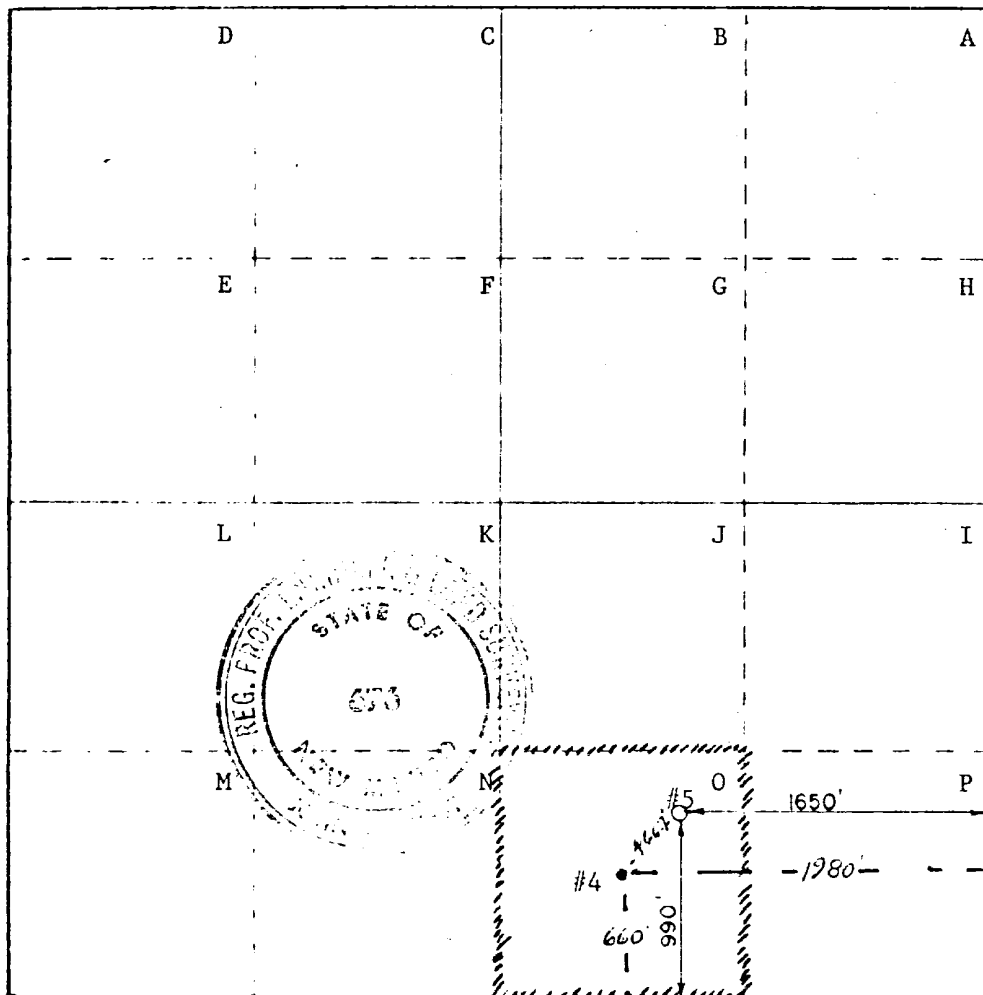

CERTIFICATION

I hereby certify that the information contained herein is true and complete to the best of my knowledge and belief.

W. J. Mueller

W. J. Mueller

Sr. Engineering Specialist

Phillips Petroleum Company

January 29, 1980

I hereby certify that the well location shown on this plat was plotted from field notes of actual surveys made by me or under my supervision, and that the same is true and correct to the best of my knowledge and belief.

December 19, 1979

Registered Professional Engineer
in the State of New Mexico

John W. West

Certificate No. **John W. West** 676
Ronald L. Eide 8230

INCLINATION REPORT

API # 30-025-26668

RECORD OF INCLINATION

I hereby certify that I have personal knowledge of the data and facts placed on this form and that such information given above is true and complete.

19 80

My Commission Expires

jj