

NO. OF COPIES RECEIVED		
DISTRIBUTION		
SANTA FE		
FILE		
U.S.G.S.		
LAND OFFICE		
OPERATOR		

NEW MEXICO OIL CONSERVATION COMMISSION

Form C-101
Revised 1-4-65

5A. Indicate Type of Lease
STATE ☒ FEE ☐

5. State Oil & Gas Lease No.
L-3674

APPLICATION FOR PERMIT TO DRILL, DEEPEN, OR PLUG BACK

1a. Type of Work DRILL <input checked="" type="checkbox"/> DEEPEN <input type="checkbox"/> PLUG BACK <input type="checkbox"/>		7. Unit Agreement Name
b. Type of Well OIL WELL <input checked="" type="checkbox"/> GAS WELL <input type="checkbox"/> OTHER <input type="checkbox"/> SINGLE ZONE <input checked="" type="checkbox"/> MULTIPLE ZONE <input type="checkbox"/>		8. Farm or Lease Name State HQ
2. Name of Operator Amoco Production Company		9. Well No. 2
3. Address of Operator P. O. Box 68 Hobbs, NM 88240		10. Field Name UNDESIGNATED Airstrip Wolfcamp
4. Location of Well UNIT LETTER I LOCATED 1780 FEET FROM THE South LINE AND 480 FEET FROM THE East LINE OF SEC. 26 TWP. 18-S RGE. 34-E NMPM		11. County Lea
19. Proposed Depth 10800'		19A. Formation Wolfcamp
20. Rotary or C.T. Rotary		
21. Elevations (Show whether DE, KI, etc.) 3975 GR	21A. Kind & Status Plug. Bend Blanket-on-file	21B. Drilling Contractor NA
22. Approx. Date Work will start 2-25-80		

23.

PROPOSED CASING AND CEMENT PROGRAM

SIZE OF HOLE	SIZE OF CASING	WEIGHT PER FOOT	SETTING DEPTH	SACKS OF CEMENT	EST. TOP
17 1/2"	13 3/8"	48#	300'	Circ	Surf
12 1/4"	9 5/8"	40#	4000'	Circ	Surf
8 3/4"	*5 1/2" or 7"	17#, 20#, 23# or 20#, 23#, 26#	10800'	Tieback to 9 5/8"	BTM 9 5/8"

*7" casing will be run to TD if evaluation of logs indicates dual Bone Springs-Wolfcamp commercial potential exists, otherwise 5 1/2" will be run to lowest potentially productive zone.

Propose to drill and equip well in the Wolfcamp zone. After reaching TD logs will be run and evaluated; perforate and/or stimulate as necessary in attempting commercial production.

Mud Program: 0-300' Native mud and fresh water.
300'-4000' Native mud and brine water.
4000'-TD Commercial mud and brine with minimum properties for safe hole conditions.

BOP Program attached.

IN ABOVE SPACE DESCRIBE PROPOSED PROGRAM; IF PROPOSAL IS TO DEEPEN OR PLUG BACK, GIVE DATA ON PRESENT PRODUCTIVE ZONE AND PROPOSED NEW PRODUCTIVE ZONE. GIVE BLOWOUT PREVENTER PROGRAM, IF ANY.

I hereby certify that the information above is true and complete to the best of my knowledge and belief.

Signed Bob Davis Title Assist. Admin. Analyst Date 2-13-80

(This space for State Use)

APPROVED BY [Signature] TITLE SUPERVISOR DISTRICT I DATE FEB 18 1980

CONDITIONS OF APPROVAL, IF ANY:

0+4 NMOC-D-H 1-Hou 1-Susp 1-BD 1-Mesa

NEW MEXICO OIL CONSERVATION COMMISSION
WELL LOCATION AND ACREAGE DEDICATION PLAT

Form O-12H
Supersedes O-12H
Effective 1-1-85

All distances must be from the outer boundaries of the Section

Operator Amoco Production Co.			Lease State HQ		Well No. 2
Tract Letter I	Section 26	Township 18 South	Range 34 East	County Lea	
Actual Wellbore Location of Well: 1780 feet from the South line and 480 feet from the East line					
Ground Level Elev. 3975.0	Producing Formation Wolfcamp	Pool Airstrip Wolfcamp		Dedicated Acreage: 40 Acres	

1. Outline the acreage dedicated to the subject well by colored pencil or hatchure marks on the plat below.
2. If more than one lease is dedicated to the well, outline each and identify the ownership thereof (both as to working interest and royalty).
3. If more than one lease of different ownership is dedicated to the well, have the interests of all owners been consolidated by communitization, unitization, force-pooling, etc?

☐ Yes ☐ No If answer is "yes," type of consolidation _____

If answer is "no," list the owners and tract descriptions which have actually been consolidated. (Use reverse side of this form if necessary.) _____

No allowable will be assigned to the well until all interests have been consolidated (by communitization, unitization, forced-pooling, or otherwise) or until a non-standard unit, eliminating such interests, has been approved by the Commission.

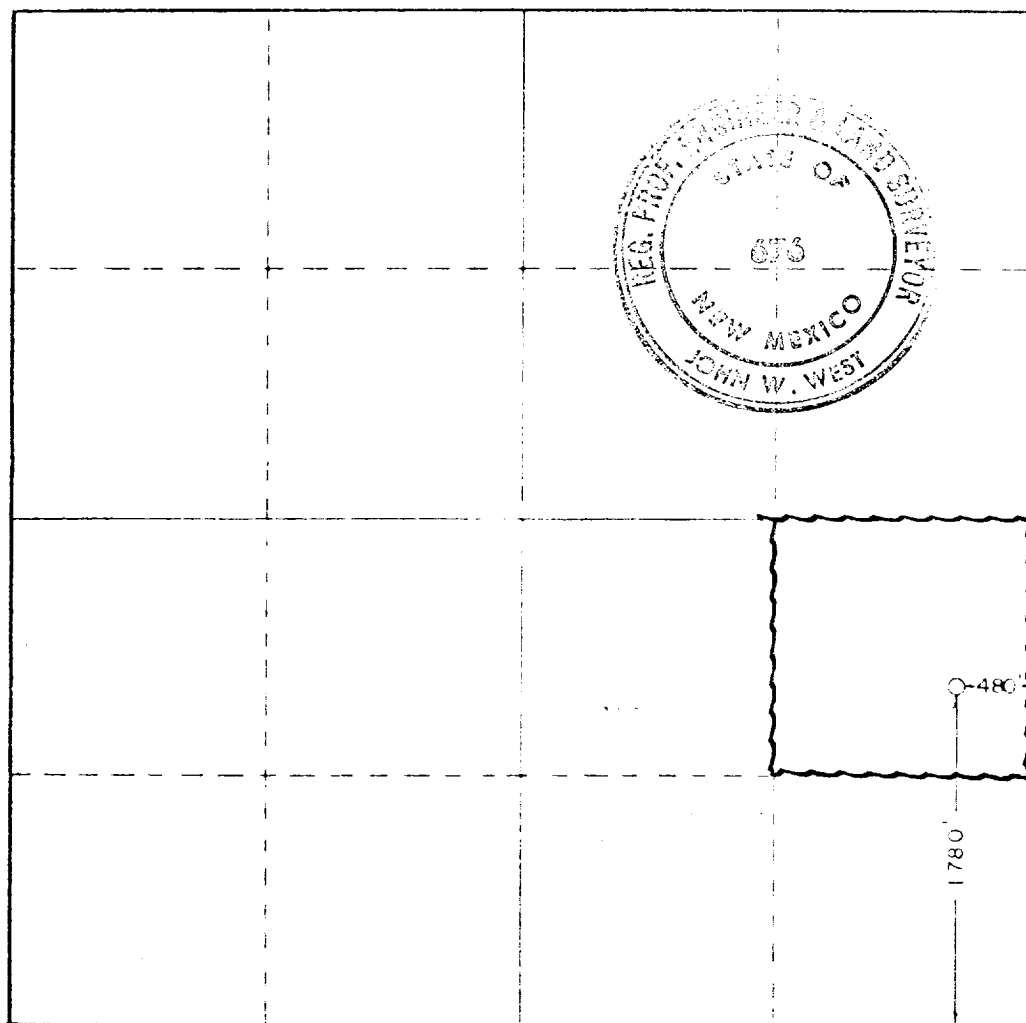

CERTIFICATION

I hereby certify that the information contained herein is true and complete to the best of my knowledge and belief.

Bob Davis

Assist. Admin. Analyst

Amoco Production Company

2-13-80

I hereby certify that the well location shown on this plat was plotted from field notes of actual surveys made by me or under my supervision, and that the same is true and correct to the best of my knowledge and belief.

Date surveyed:
Jan. 24, 1980

Registered Professional Engineer and Professional Surveyor

John W. West

Certificate No. **JOHN W. WEST 678**
PATRICK A. ROMERO 6663
Ronald J. Eidson 3239

0 330 660 990 1320 1650 1980 2310 2640 2970 3300 3630 3960 4290 4620 4950 5280 5610 5940 6270 6600 6930 7260 7590 7920 8250 8580 8910 9240 9570 9900

NOTES

1. Blow-out preventers and master valve to be fluid operated and oil fittings must be in good condition, 3,000# W.P. (6,000 p.s.i. test), minimum.
2. Equipment through which bit must pass shall be as large as the inside diameter of the casing that is being drilled through.
3. Nipple above blow-out preventer shall be same size as casing being drilled through.
4. Kelly cock required, 3,000# W.P. (6,000 p.s.i. test) minimum.
5. OMSCO or comparable safety valve must be available on rig floor at all times with proper connection or sub, 3,000# W.P. (6,000 p.s.i. test), minimum.
6. Blow-out preventers and master valve while drilling intermediate hole to 6000' may be 2,000# W.P. (4,000 p.s.i. test), minimum.
7. Choke assembly, beyond second valve from cross, may be positioned (Optional) outside of derrick foundation.
8. Spool or cross may be eliminated if connections are available in the lower part of the blow-out preventer body.
9. Plug valves - gate valves are optional. Valves shown as 2" are minimum size.
10. Casing head and casing head spool, including attached valves, to be furnished by Amoco.
11. Rams in preventers will be installed as follows:
 When drilling, use:
 Top Preventer - Drill pipe rams
 Bottom Preventer - Blind rams or master valve
 When running casing, use:
 Top Preventer - Casing rams
 Bottom Preventer - Blind rams or master valve

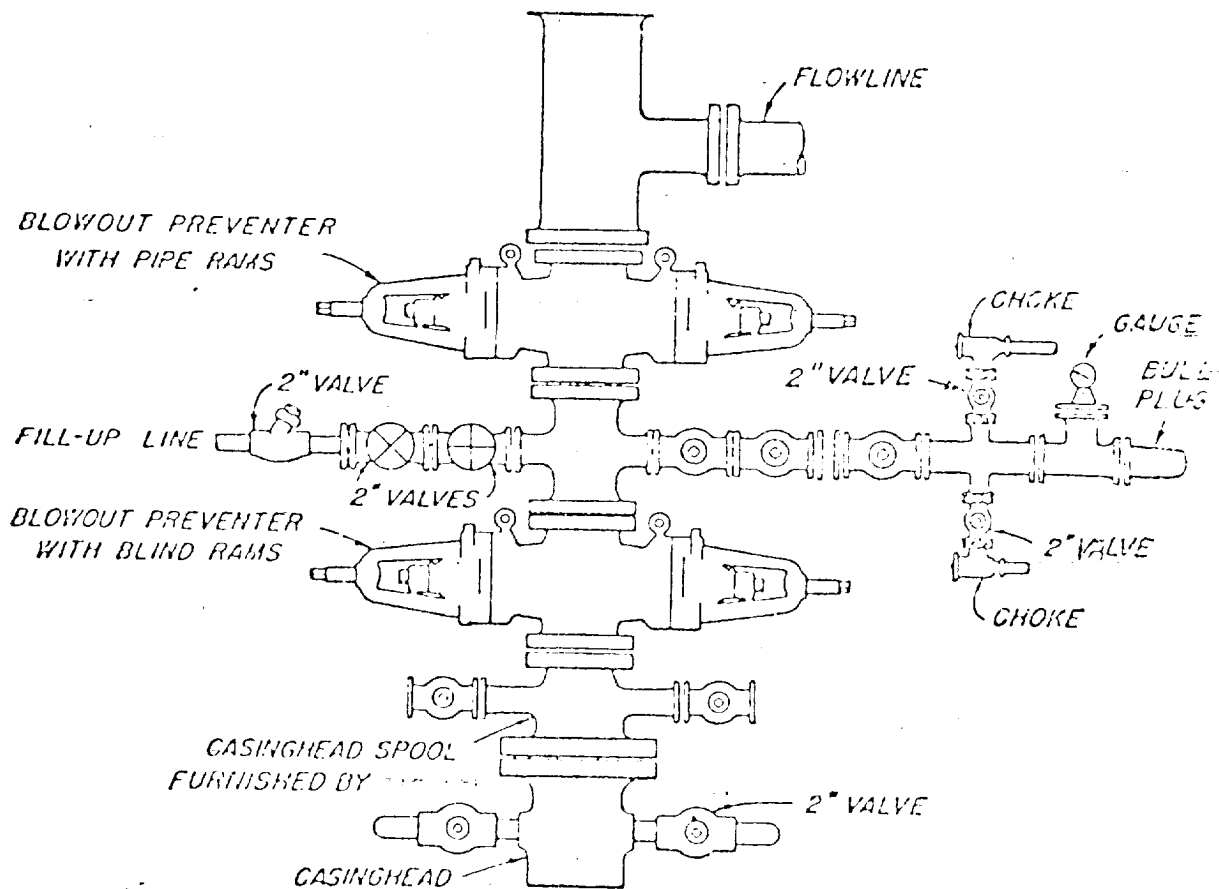

BLOWOUT PREVENTER HOOK-UP

AMOCO PROD. DIVISION COMPANY

EXHIBIT D-1 MODIFIED

JUNE 1, 1962

OIL CONSERVATION DIV.

08. 51 83F

RECEIVED