

30-025-26856

NO. OF COPIES RECEIVED	
DISTRIBUTION	
SANTA FE	
FILE	
U.S.G.S.	
LAND OFFICE	
OPERATOR	

NEW MEXICO OIL CONSERVATION COMMISSION

Form C-101
Revised 1-1-65

5A. Indicate Type of Lease	
STATE <input checked="" type="checkbox"/>	FEE <input type="checkbox"/>
5. State Oil & Gas Lease No.	
B-1502	

APPLICATION FOR PERMIT TO DRILL, DEEPEN, OR PLUG BACK

1a. Type of Work		7. Unit Agreement Name	
b. Type of Well OIL WELL <input type="checkbox"/> GAS WELL <input type="checkbox"/> OTHER <input type="checkbox"/> DRILL <input checked="" type="checkbox"/> DEEPEN <input type="checkbox"/> PLUG BACK <input type="checkbox"/>		East Vacuum Gb/SA Unit	
c. Name of Operator		8. Farm or Lease Name East Vacuum	
Phillips Petroleum Company		Gb/SA Unit, Tract 0524	
3. Address of Operator		9. Well No.	
Room 401, 4001 Penbrook, Odessa, Texas 79762		005	
4. Location of Well		10. Field and Pool, or Wildcat	
UNIT LETTER <u>E</u> LOCATED <u>2540</u> FEET FROM THE <u>North</u> LINE		Vacuum Gb/SA	
AND <u>10</u> FEET FROM THE <u>West</u> LINE OF SEC. <u>5</u> TWP. <u>18-S</u> RGE. <u>35-E</u> NMPM		12. County	
		Lea	
		19. Proposed Depth	
		4800'	
		19A. Formation	
		Gb/SA	
		20. Rotary or C.T.	
		Rotary	
21. Elevations (Show whether DE, RI, etc.)		21B. Drilling Contractor	
3970.2' Ground (unprepared)		Advise later	
21A. Kind & Status Plug. Bond		22. Approx. Date Work will start	
Blanket		Upon approval	

PROPOSED CASING AND CEMENT PROGRAM

SIZE OF HOLE	SIZE OF CASING	WEIGHT PER FOOT	SETTING DEPTH	SACKS OF CEMENT	EST. TOP
17-1/2"	13-3/8"	48#, H-40	350'(sufficient qty Cl H w/2% CaCl ₂ , 1/4#/sx Flocele.) Circ to surface.		
12-1/4"	10-3/4"	40.5#, K-55	1560'(sufficient qty Cl H w/2% CaCl ₂ , 1/4#/sx Flocele.) Circ to surface.		
(Second intermediate string to run if salt water flow is encountered.)					
9-3/4"	7-5/8"	26.4#, N-80	2985'(IF) LWFR-Single stage(sufficient Cl C (10% salt, 1/4#/sx Flocele, 3#/sx Gilsonite) Circ to surface.		
			(OR) HWFR-Second stage & block squeeze (sufficient Cl C, 10% salt, 1/4#/sx Flocele, 3#/sx Gilsonite.) Circ to surface.		
6-1/4"	5-1/2"	15.5#, K-55	4800'(sufficient qty TLW w/12#/sx salt, 10% (DD, 3#/sx Gilsonite, 1/4#/sx Flocele followed (w/Cl H w/5#/sx salt) Circ to surface.		

Subject to NSL application filed June 3, 1980.
Use mud additives as required for control.

BOP: Series 900, 300# WP, double w/one set pipe rams and one set blind rams.

APPROVAL
FOR 90 DAYS UNLESS
DRILLING COMMENCED

EXPIRES

IN ABOVE SPACE DESCRIBE PROPOSED PROGRAM: IF PROPOSAL IS TO DEEPEN OR PLUG BACK, GIVE DATA ON PRESENT PRODUCTIVE ZONE AND PROPOSED NEW PRODUCTION ZONE. GIVE BLOWOUT PREVENTER PROGRAM, IF ANY.

I hereby certify that the information above is true and complete to the best of my knowledge and belief.

By W. J. Mueller Title Senior Engineering Specialist Date June 5, 1980
(This space for State Use)
APPROVED BY [Signature] TITLE SUPERVISOR DISTRICT DATE JUN 17 1980
CONDITIONS OF APPROVAL, IF ANY:
jj

**NE MEXICO OIL CONSERVATION COMMISSION
WELL LOCATION AND ACREAGE DEDICATION PLAT**

Form C-101
Supersedes C-128
Effective 1-1-65

All distances must be from the outer boundaries of the Section.

Operator Phillips Petroleum Co.			Lease EVGSAU Tract 0524		Well No. 005
Tract Letter E	Section 5	Township 18 South	Range 35 East	County Lea	
Actual Footage Location of Well: 2540 feet from the North line and 10 feet from the West line					
Ground Level Elev. 3970.2	Producing Formation Grayburg/San Andres		Pool Vacuum Grayburg/ San Andres		Dedicated Acreage: None - line injection well

(Unprepared)

1. Outline the acreage dedicated to the subject well by colored pencil or hachure marks on the plat below.

2. If more than one lease is dedicated to the well, outline each and identify the ownership thereof (both as to working interest and royalty).

3. If more than one lease of different ownership is dedicated to the well, have the interests of all owners been consolidated by communitization, unitization, force-pooling, etc?

☐ Yes ☐ No If answer is "yes," type of consolidation _____

If answer is "no," list the owners and tract descriptions which have actually been consolidated. (Use reverse side of this form if necessary.) _____

No allowable will be assigned to the well until all interests have been consolidated (by communitization, unitization, forced-pooling, or otherwise) or until a non-standard unit, eliminating such interests, has been approved by the Commission.

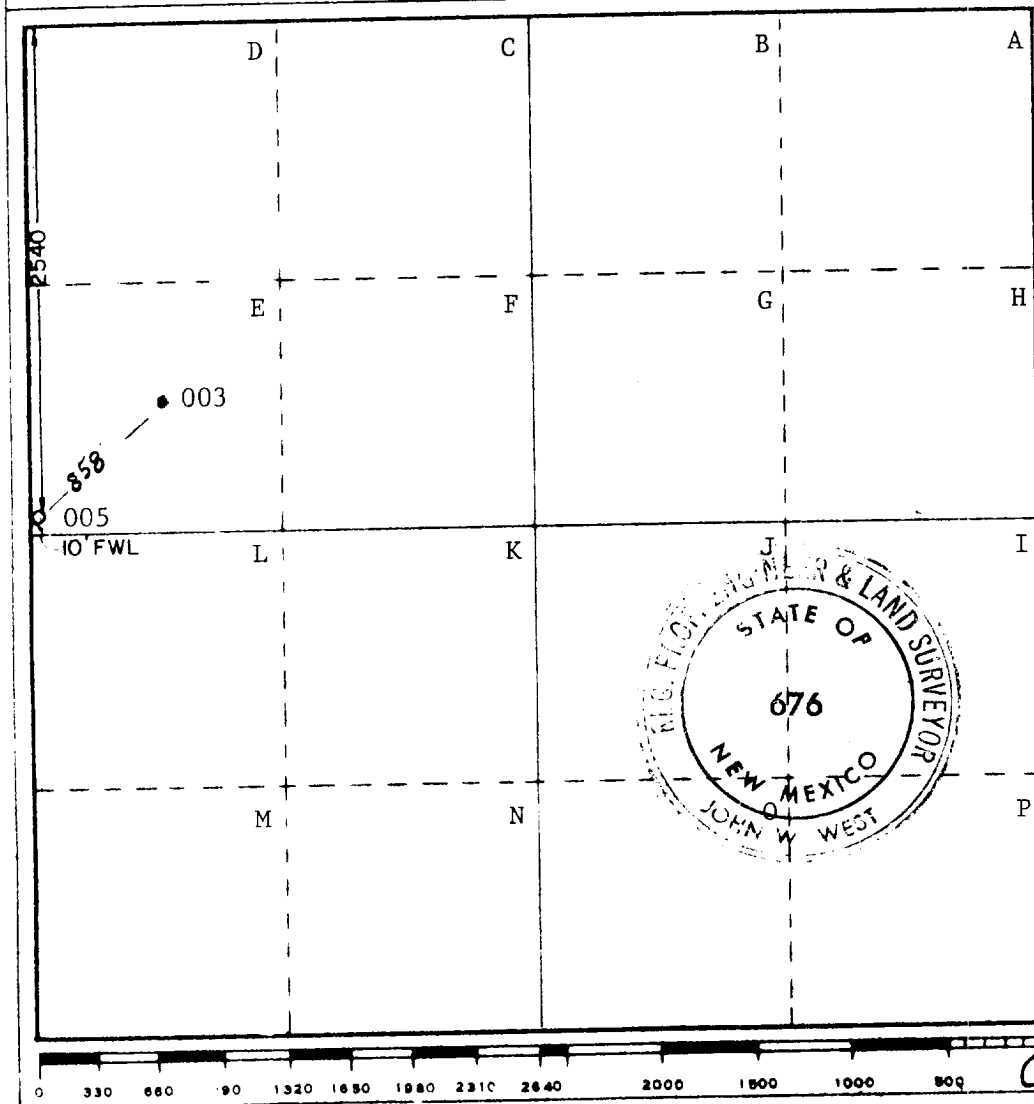

CERTIFICATION

I hereby certify that the information contained herein is true and complete to the best of my knowledge and belief.

Ralph J. Roper

Name

Ralph J. Roper

Position

Senior Engineering Specialist

Company

Phillips Petroleum Company

Date

June 2, 1980

I hereby certify that the well location shown on this plat was plotted from field notes of actual surveys made by me or under my supervision, and that the same is true and correct to the best of my knowledge and belief.

Date Surveyed

May 22, 1980

Registered Professional Engineer and/or Land Surveyor

John W. West

Certificate No. **JOHN W. WEST 676**
PATRICK A. ROMERO 6868
Ronald J. Eidson 3239

DOUBLE PREVENTER OPTION

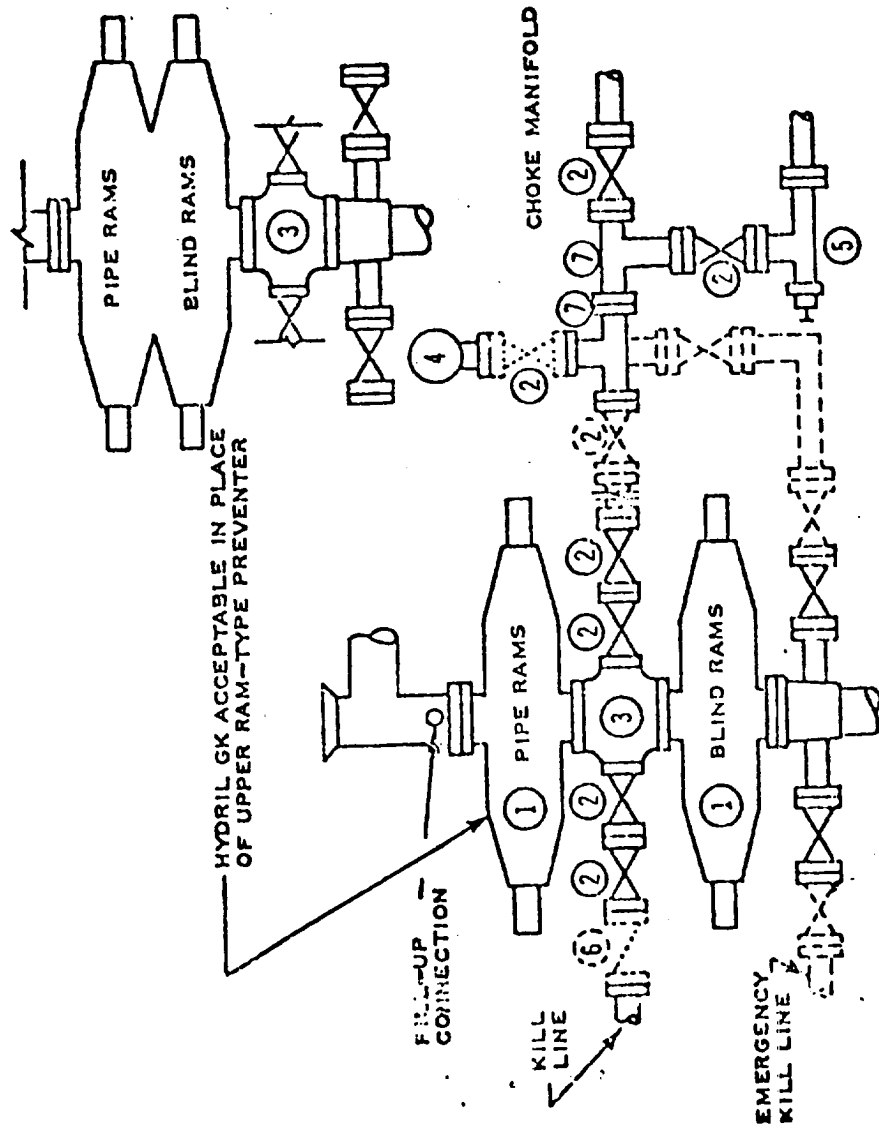

- ① SERIES 900 RAM-TYPE BOP
- ② 2" SERIES 900 VALVE
- ③ SERIES 900 DRILLING SPOOL
- ④ 2" MUD PRESSURE GAUGE
- ⑤ 2" SERIES 900 CHOKE
- ⑥ 2" SERIES 900 CHECK VALVE
- ⑦ 2" SERIES 900 STEEL TEE

NOTES:

1. 3000 PSI WP CLAMP HUBS MAY BE SUBSTITUTED FOR FLANGES
2. VALVES MAY BE EITHER HAND OR POWER OPERATED BUT, IF POWER OPERATED, THE VALVES FLANGED TO THE BOP RUN MUST BE CAPABLE OF BEING OPENED AND CLOSED MANUALLY OR CLOSE ON POWER FAILURE AND BE CAPABLE OF BEING OPENED MANUALLY

.....OPTIONAL EQUIPMENT

PHILLIPS PETROLEUM COMPANY

3000 PSI WORKING PRESSURE
BLOWOUT PREVENTER HOOK-UP
(SERIES 900 FLANGES OR BETTER)

RECEIVED

JUN 9 1980

DE CONSERVATION DIV.

173