

OIL CONSERVATION DIVISION

P. O. BOX 2088

SANTA FE, NEW MEXICO 87501

Form C-103
Revised 10-1-78

NO. OF COPIES RECEIVED	
DISTRIBUTION	
SANTA FE	
FILE	
U.S.G.S.	
LAND OFFICE	
OPERATOR	

API No. 30-025-26931

5a. Indicate Type of Lease	
State <input checked="" type="checkbox"/>	Fee <input type="checkbox"/>
5. State Oil & Gas Lease No.	
B-1562	

SUNDRY NOTICES AND REPORTS ON WELLS

(DO NOT USE THIS FORM FOR PROPOSALS TO DRILL OR TO DEEPEN OR PLUG BACK TO A DIFFERENT RESERVOIR. USE "APPLICATION FOR PERMIT -" (FORM C-101) FOR SUCH PROPOSALS.)

1. OIL WELL <input type="checkbox"/> GAS WELL <input type="checkbox"/> OTHER- Input	7. Unit Agreement Name East Vacuum Gb/SA Unit
2. Name of Operator Phillips Petroleum Company	8. Farm or Lease Name East Vacuum Gb/SA Unit, Tr 0524
3. Address of Operator Room 401, 4001 Penbrook St., Odessa, Texas 79762	9. Well No. 004
4. Location of Well UNIT LETTER F, 2286 FEET FROM THE north LINE AND 2080 FEET FROM THE west LINE, SECTION 5 TOWNSHIP 18-S RANGE 35-E NMPM.	10. Field and Pool, or Wildcat Vacuum Gb/SA
15. Elevation (Show whether DF, RT, GR, etc.) 3960' Gr.	12. County Lea

Check Appropriate Box To Indicate Nature of Notice, Report or Other Data

NOTICE OF INTENTION TO:

SUBSEQUENT REPORT OF:

PERFORM REMEDIAL WORK <input type="checkbox"/>	PLUG AND ABANDON <input type="checkbox"/>	REMEDIAL WORK <input type="checkbox"/>	ALTERING CASING <input type="checkbox"/>
TEMPORARILY ABANDON <input type="checkbox"/>	CHANGE PLANS <input type="checkbox"/>	COMMENCE DRILLING OPNS. <input type="checkbox"/>	PLUG AND ABANDONMENT <input type="checkbox"/>
PULL OR ALTER CASING <input type="checkbox"/>	OTHER <input type="checkbox"/>	CASING TEST AND CEMENT JOBS <input type="checkbox"/>	OTHER Change in well location <input checked="" type="checkbox"/>

17. Describe Proposed or Completed Operations (Clearly state all pertinent details, and give pertinent dates, including estimated date of starting any proposed work) SEE RULE 1103.

Well permitted July 15, 1980, Administrative Approval NSL-1235, at a location of 2300' from the north line and 2100' from the west line of Section 5, T-18-S, R-35-E, Lea County, New Mexico. Well location is actually at 2286' from the north line and 2080' from the west line of Section 5, T-18-S, R-35-E, Lea County, New Mexico. (See attached form C-102) Well shares proration unit with wells no. 045 and 118. Well location change discovered during surveys being conducted for flow line changes due to possible change to CO₂ injection.

18. I hereby certify that the information above is true and complete to the best of my knowledge and belief.

SIGNED Eddie W. Seay W. J. Mueller TITLE Agent DATE May 15, 1985
APPROVED BY Oil & Gas Inspector TITLE _____ DATE MAY 22 1985

CONDITIONS OF APPROVAL, IF ANY:

**NEW MEXICO OIL CONSERVATION COMMISSION
WELL LOCATION AND ACREAGE DEDICATION PLAT**

Form C-121
Supersedes C-128
Effective 1-1-65

All distances must be from the outer boundaries of the Section

Lessor PHILLIPS PETROLEUM CO.		Lease EAST VACUUM GRAYBURG SAN ANDRES UNIT TRACT 0524		Well No. 004
Section 5	Township 18 SOUTH	Range 35 EAST	County LEA	
Annual Production Location of Well: 2286 feet from the NORTH line and 2080 feet from the WEST line				
Ground Level Elev. 3961.0	Producing Formation Grayburg-San Andres	Pool Vacuum Grayburg-San Andres	Dedicated Acreage: 40 Acres	

1. Outline the acreage dedicated to the subject well by colored pencil or hachure marks on the plat below.
2. If more than one lease is dedicated to the well, outline each and identify the ownership thereof (both as to working interest and royalty).
3. If more than one lease of different ownership is dedicated to the well, have the interests of all owners been consolidated by communitization, unitization, force-pooling, etc?

☐ Yes ☐ No If answer is "yes," type of consolidation _____

If answer is "no," list the owners and tract descriptions which have actually been consolidated. (Use reverse side of this form if necessary.) _____

No allowable will be assigned to the well until all interests have been consolidated (by communitization, unitization, forced-pooling, or otherwise) or until a non-standard unit, eliminating such interests, has been approved by the Commission.

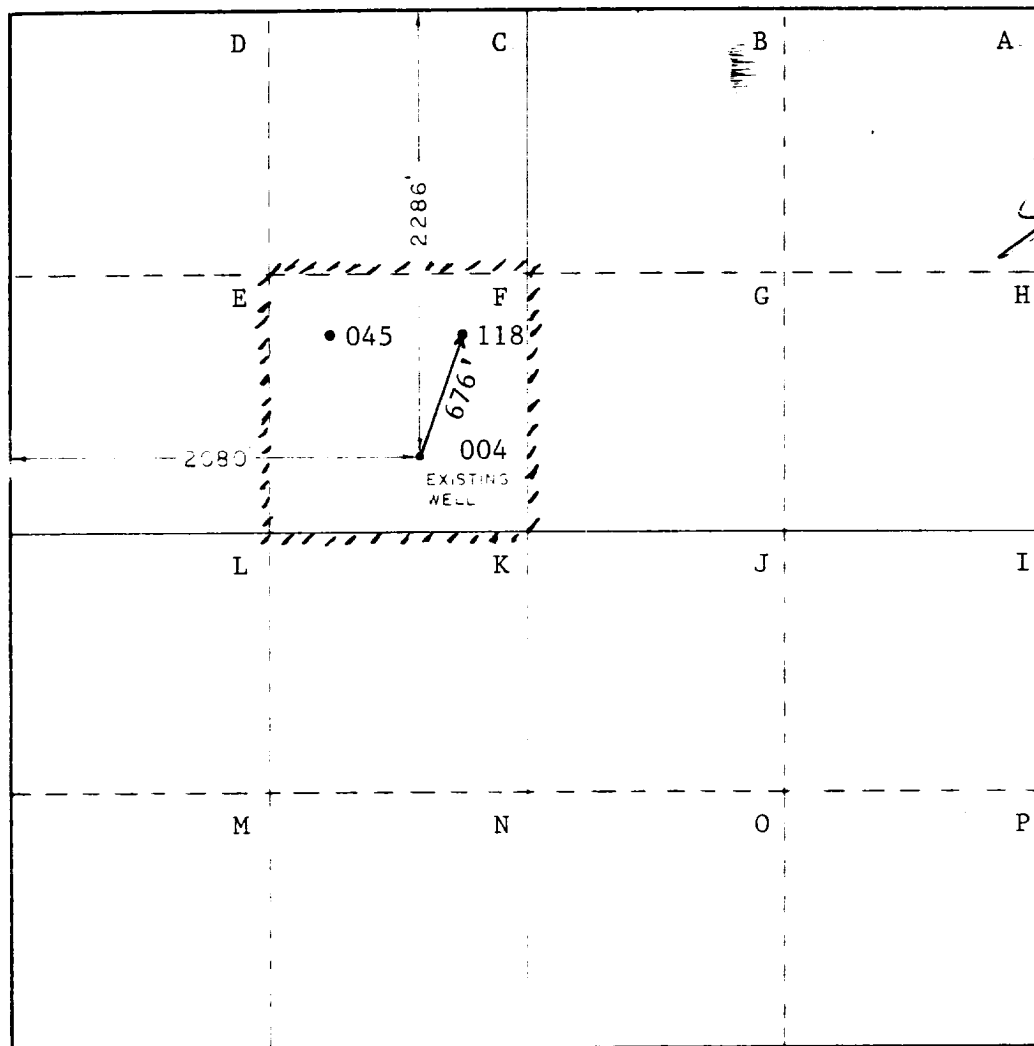

CERTIFICATION

I hereby certify that the information contained herein is true and complete to the best of my knowledge and belief.

[Signature]
W. J. Mueller
Agent

Position
Phillips Petroleum Company

Date
May 15, 1985

I hereby certify that the well location shown on this plat was plotted from field notes of actual surveys made by me or under my supervision, and that the same is true and correct to the best of my knowledge and belief.

Date Surveyed
May 15, 1985
Registered Professional Engineer
and Licensed Surveyor

[Signature]
Certificate No. **JOHN W. WEST, 676**
RONALD J. EIDSON, 3239

