

NO. OF COPIES RECEIVED	
DISTRIBUTION	
SANTA FE	
FILE	
U.S.G.S.	
LAND OFFICE	
OPERATOR	

NEW MEXICO OIL CONSERVATION COMMISSION

Form C-101
Revised 1-1-65

API No. 30-025-26932

APPLICATION FOR PERMIT TO DRILL, DEEPEN, OR PLUG BACK

1a. Type of Work DRILL <input checked="" type="checkbox"/> DEEPEN <input type="checkbox"/> PLUG BACK <input type="checkbox"/>		5A. Indicate Type of Lease STATE <input checked="" type="checkbox"/> FEE <input type="checkbox"/>
1b. Type of Well OIL WELL <input checked="" type="checkbox"/> GAS WELL <input type="checkbox"/> OTHER <input type="checkbox"/> SINGLE ZONE <input checked="" type="checkbox"/> MULTIPLE ZONE <input type="checkbox"/>		5. State Oil & Gas Lease No. <u>B-2073</u>
2. Name of Operator <u>Phillips Petroleum Company</u>		7. Unit Agreement Name <u>East Vacuum Gb/SA Unit</u>
3. Address of Operator <u>Room 401, 4001 Penbrook St., Odessa, Texas 79762</u>		8. Form of Lease Name <u>East Vacuum Gb/SA Unit, Tract 0546</u>
4. Location of Well UNIT LETTER <u>G</u> LOCATED <u>2300</u> FEET FROM THE <u>North</u> LINE AND <u>1600</u> FEET FROM THE <u>East</u> LINE OF SEC. <u>5</u> TWP. <u>18-S</u> RGE. <u>35-E</u> NMPM		9. Well No. <u>002</u>
		10. Field and Pool, or Wildcat <u>Vacuum Gb/SA</u>
		12. County <u>Lea</u>
		19. Proposed Depth <u>4800'</u>
		19A. Formation <u>Gb/SA</u>
		20. Rotary or C.T. <u>Rotary</u>
21. Elevations (Show whether D.F., R.T., etc.) <u>3951' Ground (unprepared)</u>	21A. Kind & Status Plug. Bond <u>blanket</u>	21B. Drilling Contractor <u>Advise later</u>
22. Approx. Date Work will start <u>Upon approval</u>		

PROPOSED CASING AND CEMENT PROGRAM

SIZE OF HOLE	SIZE OF CASING	WEIGHT PER FOOT	SETTING DEPTH	SACKS OF CEMENT	EST. TOP
11"	8-5/8"	24#, J-55	350'	(Sufficient quantity of Cl H w/2% CaCl (1/4# Flocele/sx in 1st 150 sxs)	Circ to surf
7-7/8"	5-1/2"	14#, K-55	4800'	(Sufficient TRLW w/12# salt/sx w/10% (DD and 1/4#/sx Flocele plus 3# (Gilsonite/sx followed by 260 sxs (Cl H cmt w/8# salt/sx to circ to surf)	

(This well is in the same proration unit as Well No. 093.)

Reference NSL. (Requested by letter dated 7-10-80.)

Use mud additives as required for control.

BOP: Series 900, 3000# WP, double w/one set pipe rams and one set blind rams.

THE COMMISSION MUST BE NOTIFIED
24 HOURS PRIOR TO COMMENCING WORK

NSL-1235

IN ABOVE SPACE DESCRIBE PROPOSED PROGRAM: IF PROPOSAL IS TO DEEPEN OR PLUG BACK, GIVE DATA ON PRESENT PRODUCTIVE ZONE AND PROPOSED NEW PRODUCTIVE ZONE. GIVE BLOWOUT PREVENTER PROGRAM, IF ANY.

I hereby certify that the information above is true and complete to the best of my knowledge and belief.

Signed W. J. Mueller Title Sr. Engineering Specialist Date July 10, 1980

APPROVED BY John W. Remyan TITLE Geologist DATE JUL 22 1980

CONDITIONS OF APPROVAL, IF ANY:

NEW MEXICO OIL CONSERVATION COMMISSION
WELL LOCATION AND ACREAGE DEDICATION PLAT

Form C-102
Supersedes C-128
Effective 1-1-65

All distances must be from the outer boundaries of the Section

Operator Phillips Petroleum Company			Lease E.V.G.S.A.U. # 0546		UNIT TRACT 002
Unit Letter G	Section 5	Township T-18 South	Range R-35 East	County Lea	
Actual Footage Location of Well: 2300 feet from the North line and 1600 feet from the East line					
Ground Level Elev. 3951.0	Producing Formation Gb/SA		Pool Vacuum Gb/SA		Dedicated Acreage: 40 Acres

1. Outline the acreage dedicated to the subject well by colored pencil or hatchure marks on the plat below.
2. If more than one lease is dedicated to the well, outline each and identify the ownership thereof (both as to working interest and royalty).
3. If more than one lease of different ownership is dedicated to the well, have the interests of all owners been consolidated by communitization, unitization, force-pooling, etc?

☐ Yes ☐ No If answer is "yes," type of consolidation _____

If answer is "no," list the owners and tract descriptions which have actually been consolidated. (Use reverse side of this form if necessary.) _____

No allowable will be assigned to the well until all interests have been consolidated (by communitization, unitization, forced-pooling, or otherwise) or until a non-standard unit, eliminating such interests, has been approved by the Commission.

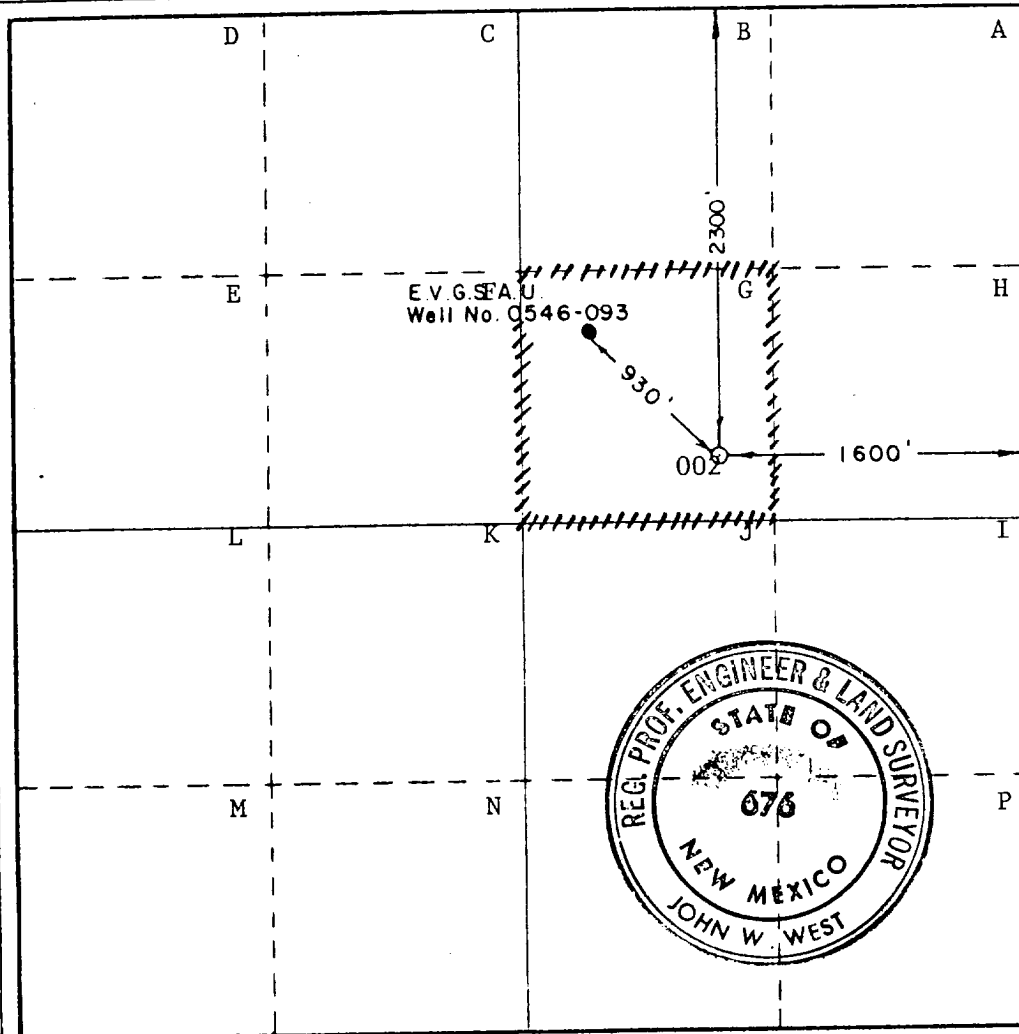

CERTIFICATION

I hereby certify that the information contained herein is true and complete to the best of my knowledge and belief.

W. J. Mueller
Position
Sr. Engineering Specialist

Company
Phillips Petroleum Company

Date
7-10-80

I hereby certify that the well location shown on this plat was plotted from field notes of actual surveys made by me or under my supervision, and that the same is true and correct to the best of my knowledge and belief.

Date Surveyed
June 18, 1980

Registered Professional Engineer and/or Land Surveyor

JOHN W. WEST 076
PATRICK A. ROMERO 0003
Ronald J. Eidson 3239

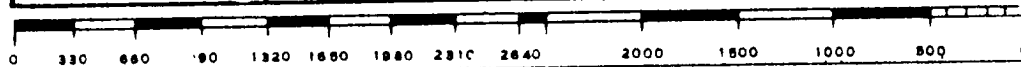

DOUBLE PREVENTER OPTION

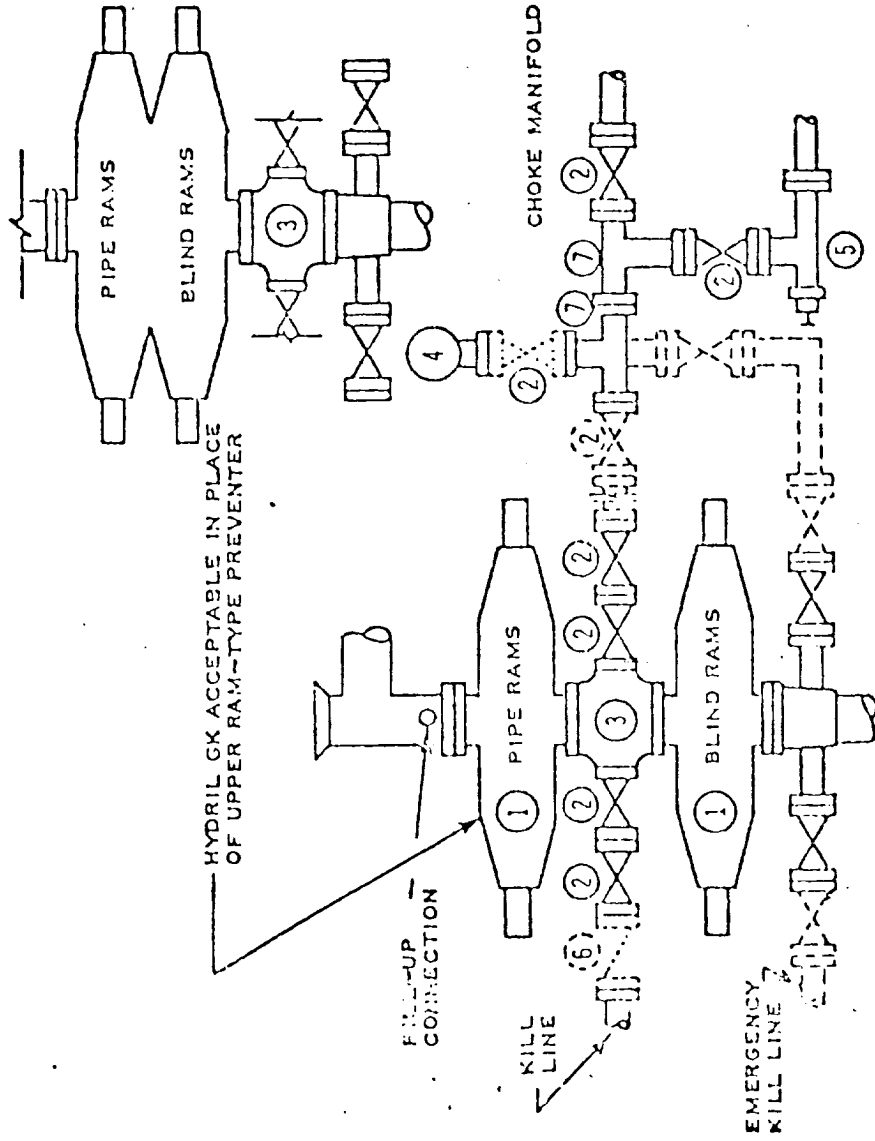

- ① SERIES 900 RAM-TYPE BOP
- ② 2" SERIES 900 VALVE
- ③ SERIES 900 DRILLING SPOOL
- ④ 2" MUD PRESSURE GAUGE
- ⑤ 2" SERIES 900 CHOKE
- ⑥ 2" SERIES 900 CHECK VALVE
- ⑦ 2" SERIES 900 STEEL TEE

NOTES:

1. 3000 PSI WP CLAMP HUBS MAY BE SUBSTITUTED FOR FLANGES
2. VALVES MAY BE EITHER HAND OR POWER OPERATED BUT, IF POWER OPERATED, THE VALVES FLANGED TO THE BOP RUN MUST BE CAPABLE OF BEING OPENED AND CLOSED MANUALLY OR CLOSE ON POWER FAILURE AND BE CAPABLE OF BEING OPENED MANUALLY

..... OPTIONAL EQUIPMENT

PHILLIPS PETROLEUM COMPANY

3000 PSI WORKING PRESSURE
BLOWOUT PREVENTER HOOK-UP
(SERIES 900 FLANGES OR BETTER)