

NEW MEXICO DEPARTMENT OF CONSERVATION COMMISSION  
WELL LOCATION AND ACREAGE DEDICATION PLAT

Section 33  
T22N R32E

Shell Oil Co.

Lease # Hobbs Unit Sec. 33

T22

F

33

15 South

38 East

Leo

1620

feet from the North

1470

feet from the West

Acres Dedication

Formulating Formation

Feet

Feet from the

3646.1

(G/SA)

Hobbs (G/SA)

1. Outline the acreage dedicated to the subject well by colored pencil or hashure marks on the plat below.
2. If more than one lease is dedicated to the well, outline each and identify the ownership thereof (both as to working interest and royalty).
3. If more than one lease of different ownership is dedicated to the well, have the interests of all owners been consolidated by communitization, unitization, force-pooling, etc?

☒ Yes ☐ No If answer is "yes" type of consolidation Unitization

If answer is "no" list the owners and tract descriptions which have actually been consolidated (Use reverse side of this form if necessary.)

No allowable will be assigned to the well until all interests have been consolidated (by communitization, unitization, forced-pooling, or otherwise) or until a non-standard unit, eliminating such interests, has been approved by the Commission.

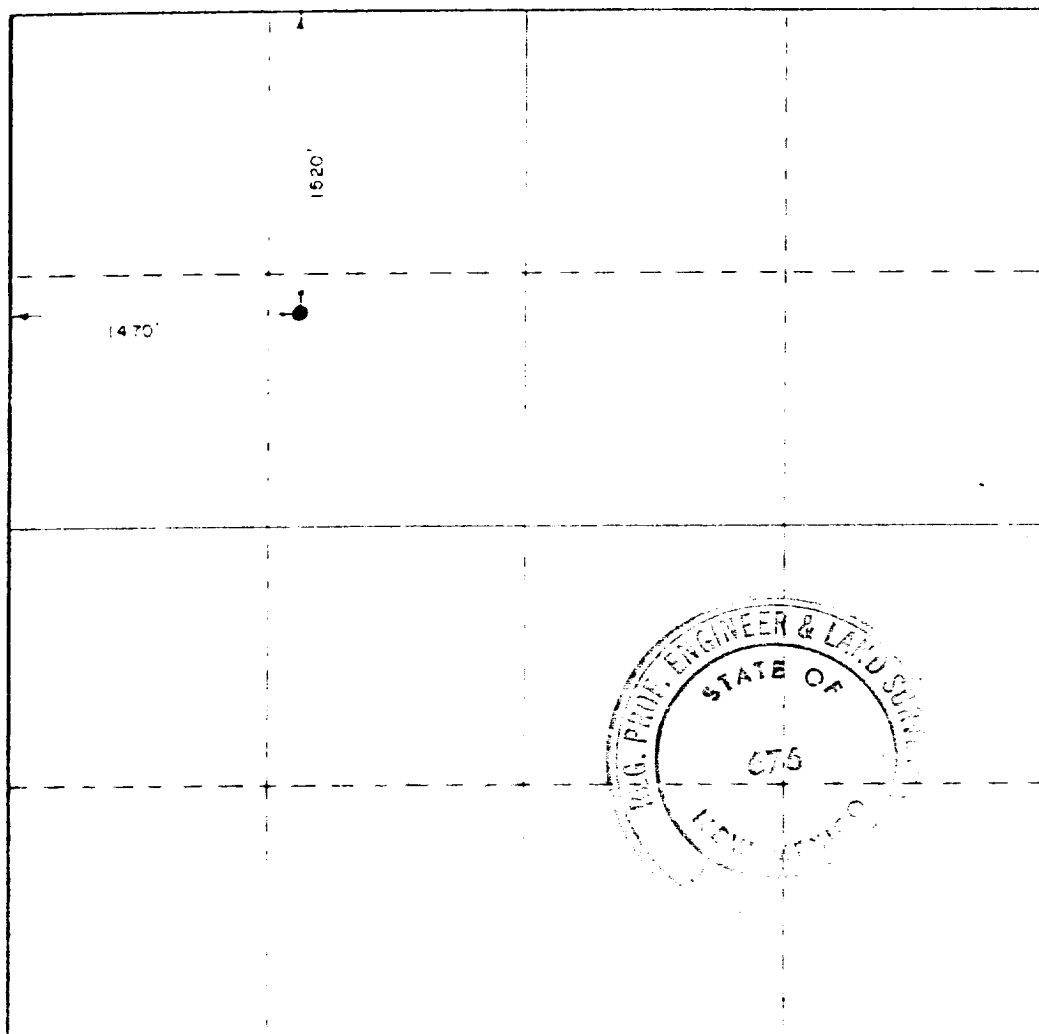

CERTIFICATION

I hereby certify that the information contained herein is true and complete to the best of my knowledge and belief.

*A. J. Fore* A. J. Fore

Senior Engr. Technician

Shell Oil Company

5-7-80

I hereby certify that the well location shown on this plat was plotted from field notes of actual surveys made by me or under my supervision and that the same is true and correct to the best of my knowledge and belief.

DATE

1-1-1980

W. G. Prue, Engineer & Land Surveyor

*John W. West*

John W. West

676

Rongic S. E. 33 3239