

UNITED STATES  
DEPARTMENT OF THE INTERIOR  
GEOLOGICAL SURVEY

30-025-27189

APPLICATION FOR PERMIT TO DRILL, DEEPEN, OR PLUG BACK

1a. TYPE OF WORK

DRILL ☒

DEEPEN ☐

PLUG BACK ☐

b. TYPE OF WELL

OIL  
WELL ☒

GAS  
WELL ☐

OTHER

SINGLE  
ZONE ☐

MULTIPLE  
ZONE ☐

2. NAME OF OPERATOR

Sun Oil Company

3. ADDRESS OF OPERATOR

P. O. Box 1861 - Midland, TX 79702

4. LOCATION OF WELL (Report location clearly and in accordance with any State requirements.)

At surface

1880' FNL & 1980' FWL - Unit Ltr. "F"

At proposed prod. zone

14. DISTANCE IN MILES AND DIRECTION FROM NEAREST TOWN OR POST OFFICE\*

14 miles South from Maljamar, NM

15. DISTANCE FROM PROPOSED\*

LOCATION TO NEAREST  
PROPERTY OR LEASE LINE, FT.  
(Also to nearest drlg. unit line, if any)

1880'

18. DISTANCE FROM PROPOSED LOCATION\*  
TO NEAREST WELL, DRILLING, COMPLETED,  
OR APPLIED FOR, ON THIS LEASE, FT.

100'

16. NO. OF ACRES IN LEASE

480

19. PROPOSED DEPTH

3100'

17. NO. OF ACRES ASSIGNED  
TO THIS WELL

40

20. ROTARY OR CABLE TOOLS

Rotary

21. ELEVATIONS (Show whether DF, RT, GR, etc.)

3633' GR

22. APPROX. DATE WORK WILL START\*

ASAP

23.

PROPOSED CASING AND CEMENTING PROGRAM

SIZE OF HOLE	SIZE OF CASING	WEIGHT PER FOOT	SETTING DEPTH	QUANTITY OF CEMENT
11"	8 5/8"	24#	400±	175 Sx
7 7/8"	5 1/2"	14#	2700±	560 Sx (Circulate)
			3100' TD	

IN ABOVE SPACE DESCRIBE PROPOSED PROGRAM: If proposal is to deepen or plug back, give data on present productive zone and proposed new productive zone. If proposal is to drill or deepen directionally, give pertinent data on subsurface locations and measured and true vertical depths. Give blowout preventer program, if any.

24.

SIGNER

*David Williams*

TITLE

Sr. Accounting Assistant

DATE

November 13, 1980

(This space for Federal or State office use)

PERMIT NO.

APPROVAL DATE

(Orig. Sgd.) GEORGE H. STEWART

APPROVED BY

TITLE

DATE

DEC 08 1980

CONDITIONS OF APPROVAL, IF ANY:

## Instructions

**General:** This form is designed for submitting proposals to perform certain well operations, as indicated, on all types of lands and leases for appropriate action by either a Federal or a State agency, or both, pursuant to applicable Federal and/or State laws and regulations. Any necessary special instructions concerning the use of this form and the number of copies to be submitted, particularly with regard to local, area, or regional procedures and practices, either are shown below or will be issued by, or may be obtained from, the local Federal and/or State office.

**Item 1:** If the proposal is to redrill to the same reservoir at a different subsurface location or to a new reservoir, use this form with appropriate notations. Consult applicable State or Federal regulations concerning subsequent work proposals or reports on the well.

**Item 4:** If there are no applicable State requirements, locations on Federal or Indian land should be described in accordance with Federal requirements. Consult local State or Federal office for specific instructions.

**Item 14:** Needed only when location of well cannot readily be found by road from the land or lease description. A plat, or plats, separate or on this reverse side, showing the roads to, and the surveyed location of, the well, and any other required information, should be furnished when required by Federal or State agency offices.

**Items 15 and 18:** If well is to be, or has been directionally drilled, give distances for subsurface location of hole in any present or objective production zone.

**Item 22:** Consult applicable Federal or State regulations, or appropriate officials, concerning approval of the proposal before operations are started.

DEC 16 1980

NEW MEXICO OIL CONSERVATION COMMISSION  
WELL LOCATION AND ACREAGE DEDICATION PLAT

Form C-102  
Supersedes C-128  
Effective 1-1-65

All distances must be from the outer boundaries of the Section

Operator <b>Sun Oil Co.</b>			Lease <b>Jennings B Fed.</b>			Well No. <b>3</b>
Init. Letter <b>F</b>	Section <b>15</b>	Township <b>19 South</b>	Range <b>32 East</b>	County <b>Lea</b>		
Actual Footage Location of Well: <b>1880</b> feet from the <b>north</b> line and <b>1980</b> feet from the <b>west</b> line						
Ground Level Elev. <b>3633</b>	Producing Formation <b>Yates</b>		Pool <b>Lusk Area Wildcat</b>		Dedicated Acreage: <b>40</b> Acres	

1. Outline the acreage dedicated to the subject well by colored pencil or hatchure marks on the plat below.
2. If more than one lease is dedicated to the well, outline each and identify the ownership thereof (both as to working interest and royalty).
3. If more than one lease of different ownership is dedicated to the well, have the interests of all owners been consolidated by communitization, unitization, force-pooling, etc?

☐ Yes ☐ No If answer is "yes," type of consolidation \_\_\_\_\_

If answer is "no," list the owners and tract descriptions which have actually been consolidated. (Use reverse side of this form if necessary.) \_\_\_\_\_

No allowable will be assigned to the well until all interests have been consolidated (by communitization, unitization, forced-pooling, or otherwise) or until a non-standard unit, eliminating such interests, has been approved by the Commission.

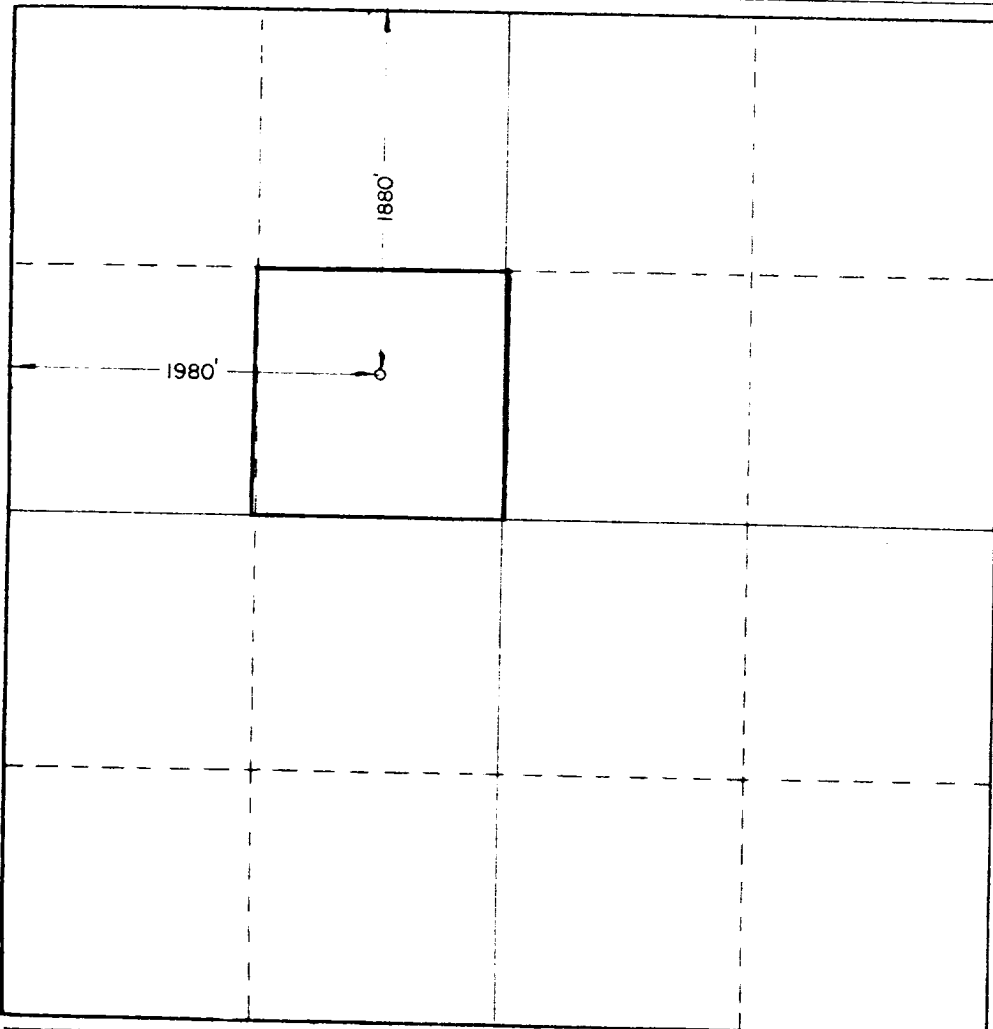

CERTIFICATION

I hereby certify that the information contained herein is true and complete to the best of my knowledge and belief.

*Doris Williams*  
Name

**DORIS WILLIAMS**

Position  
*Sr Accounting Assistant*

Company  
**SUN OIL COMPANY**

Date  
**11-13-80**

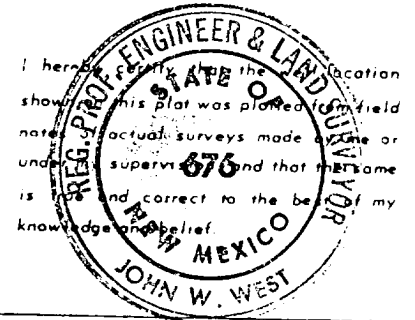

Date Surveyed  
**Oct. 28, 1980**

Registered Professional Engineer and/or Land Surveyor

*John W. West*  
Certificate No. **JOHN W. WEST 676**  
**PATRICK A. ROMERO 6663**

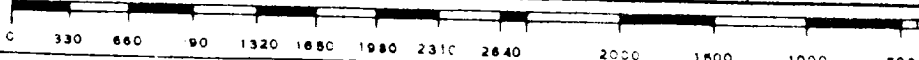

SUN OIL COMPANY (DELAWARE)  
JENNINGS "B" FEDERAL NO. 3  
1880' FNL & 1980' FWL, SEC. 15, T19S-R32E  
NEW MEXICO LEASE #025497  
LEA COUNTY, N.M.

1. GEOLOGIC NAME OF SURFACE FORMATION: "QUATERNARY"

2. ESTIMATED TOPS OF IMPORTANT GEOLOGIC MARKERS:

Rustler	1300 Feet
Yates	2792 Feet

3. ANTICIPATED HYDROCARBON BEARING ZONES:

Yates	2792 Feet
-------	-----------

4. CASING PROGRAM

<u>Size</u>	<u>Footage</u>	<u>Grade</u>	<u>WT/FT</u>
8-5/8"	400±	K-55	24 lb. New
5-1/2"	2700±	K-55	14 lb. New
	3100' TD		

5 & 7. OPERATORS MINIMUM SPECIFICATIONS FOR PRESSURE AND BLOW OUT EQUIPMENT TO BE USED:

After setting the 8-5/8" casing string and before drilling into the Yates formation, the blowout preventers and related control equipment shall be pressure tested to rated working pressures. Any equipment failing to test satisfactorily shall be repaired or replaced. This office should be notified in sufficient time for a representative to witness the tests and shall be furnished a copy of the pressure test report.

Pipe rams and the annular-type preventer shall be actuated at least once each 24 hours and the blind rams each time the drill pipe is out of the hole.

Accumulators shall maintain a pressure capacity reserve at all times to provide for repeated operation of hydraulic preventers.

A drill string safety valve in the open position shall be maintained on the rig floor at all times while drilling operations are being conducted.

Blowout prevention drills shall be conducted as necessary to insure that each drilling crew is properly trained to carry out emergency duties.

Good drilling practices will be implemented on the duration of this well. Visual monitoring of pit levels will be continual to allow for detection, before or during, of possible problems or well kicks. This will allow for quick action to deal with the successful handling of a well kick.

When coming out of the hole with drill pipe, the annulus shall be filled with mud before the mud level drops below 150 feet. The volume of mud required to fill the hole shall be watched, and any time there is an indication of swabbing, or influx of formation fluids, proper blowout prevention precautions must be taken. The mud shall not be circulated and conditioned except on or near bottom, unless well conditions prevent running the pipe to bottom.

A copy of these requirements shall be posted on the rig floor or in the dog house during the drilling of the well.

6. TYPE AND MUD SYSTEM CHARACTERISTICS:

From	To	Wt. Lbs/Gals	WL	Vis	Type Mud
0	400	8.6 - 8.9	NC	33-35	Gel-Lime
400	2500	9.8 - 10.0	NC	28-29	Sat Brine-Lime
2500	3100 (TD)	10.0 - 10.0	15	32-34	Salt Gel Caustic Soda

8. Anticipate no drill stem tests. Such tests, if later determined necessary, will be conducted under established prudent industry practice.

Schlumberger: DLL & CNL/FDC w/Caliper - Surf - 3100-TD

9. No abnormal pressures, temperatures or hydrogen sulfide gas is expected.

Sun has drilled four wells in the area: (1) Shearn Federal #1; (2) Jennings Federal #1; (3) Sloan Federal #1; (4) Jennings Federal "A" #1 and (5) Jennings Federal "B" #1.

10. Estimated starting date: As soon as possible - subject to approval of permit and data presented herein.



H. L. Bethancourt  
District Drilling Manager