

WELL LOCATION AND ACREAGE PLAT

Revised
Supersedes C-1
Effective 1-1-81

All distances must be from true corner to corner.

Owner COLLIER ENERGY, INC.			County MESA STATE		Well No. 1
Unit Letter F	Section 20	Township 18 South	Range 35 East	City Lea	
Actual Footage Location of Well:					
1980 feet from the North line and		1980 feet from the West line			
Ground Level Elev. 3938.8	Producing Formation QUEEN	Pool VACUUM SOUTH QUEEN	Estimated Acreage 160 Acres		

1. Outline the acreage dedicated to the subject well by colored pencil or headline marks on the plat below.
2. If more than one lease is dedicated to the well, outline each and identify the ownership thereof (both as to working interest and royalty).
3. If more than one lease of different ownership is dedicated to the well, have the interests of all owners been consolidated by communitization, unitization, force-pooling, etc?

☐ Yes ☐ No If answer is "yes," type of consolidation _____

If answer is "no," list the owners and tract descriptions which have actually been consolidated. (Use reverse side of this form if necessary.) _____

No allowable will be assigned to the well until all interests have been consolidated (by communitization, unitization, forced-pooling, or otherwise) or until a non-standard unit, eliminating such interests, has been approved by the Commission.

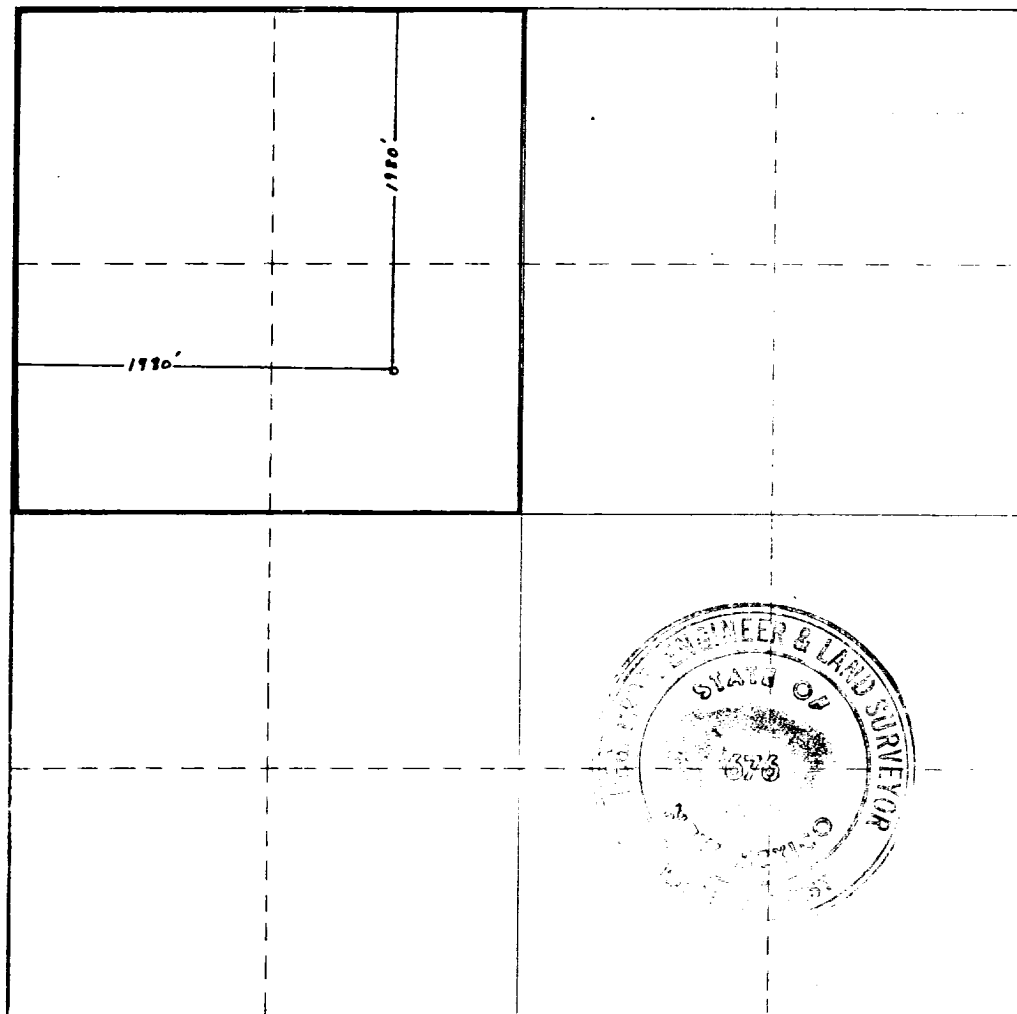

CERTIFICATION

I hereby certify that the information contained herein is true and complete to the best of my knowledge and belief.

Donald R. Craig
Donald R. Craig

President

COLLIER ENERGY, INC.

August 10, 1981

I hereby certify that the well location shown on this plat was plotted from field notes of actual surveys made by me or under my supervision, and that the same is true and correct to the best of my knowledge and belief.

Date Surveyed

April 28, 1981

Registered Professional Engineer
and Land Surveyor

John W. West

John W. West

676

COUNTY LEA FIELD Wildcat STATE NM
OPR COLLIER ENERGY, INC. API 30-025-27397
NO 1 LEASE Mesa State MAP
Sec 20, T18S, R35E CO-ORD
1980 FNL, 1980 FWL of Sec 8-2-34 NM
5 mi SE/Buckeye SPD 4-30-81 CMP 7-13-81

(SG)

8 5/8-1035-550 sx
4 1/2-4565-1316 sx
2 3/8-4390

WELL CLASS: INIT		WF FIN	WFD	SE. CODE
FORMATION	DATUM	FORMATION	DATUM	
ID 4762 (QUEN)		PBD	4552	

IP (Queen) Perfs 4436-43 CAOF 1054 MCFGPD. GOR Dry; gty (GAS)
.7926; SIWHP 1421; SIBHP 1646

CONTR Collier #10 OPRSELEV 3939 GL sub-e 7

F.R. 5-4-81
PD 5000 RT (Queen)
8-8-81 AMEND FIELD: Formerly reported as Wildcat
5-5-81 Drlg 1746; Salt & anhy
5-11-81 Drlg 4686
5-19-81 TD 4762; PBD 4565; WOCU
No Cores or DST's
6-2-81 TD 4762; PBD 4552; Prep Perf
6-9-81 TD 4762; PBD 4552; Prep Acid
Perf (Queen) 4436-43 w/2 SPF
6-16-81 TD 4762; PBD 4552; Tstg
Acid (4436-43) 2500 gals
6-22-81 TD 4762; PBD 4552; SI
6-29-81 TD 4762; PBD 4552; Prep Frac
7-6-81 TD 4762; PBD 4552; WOSP
Did not Frac

8-2-34 NM

LEA
COLLIER ENERGY, INC.

Wildcat
1 Mesa State
Sec 20, T18S, R35E

NM
Page #2

8-3-81

TD 4762; PBD 4552; Complete

(QUEEN) FOUR POINT GAUGES:

Flwd 364 MCFGPD, 7/64 chk, 60 mins, TP 1224

Flwd 750 MCFGPD, 10/64 chk, 60 mins, TP 845

Flwd 873 MCFGPD, 11.5/64 chk, 60 mins, TP 670

Flwd 968 MCFGPD, 14/64 chk, 60 mins, TP 572

Queen Discovery, New Field Designation-Reeves, W.

BHT 94 deg @ 3615

8-8-81

COMPLETION ISSUED

11-21-81

RE-ISSUE TO AMEND FIELD & FINAL CLASS: Formerly
reported as Vacuum, DG

8-2-34 NM

IC 30-025-70233-81