

**UNITED STATES
DEPARTMENT OF THE INTERIOR
GEOLOGICAL SURVEY**

APPLICATION FOR PERMIT TO DRILL, DEEPEN, OR PLUG BACK

30-025-22470

5. LEASE DENIGATION AND SERIAL NO.

NM 14000

6. IF INDIAN, ALLOTTEE OR TRIBE NAME

N/A

7. UNIT AGREEMENT NAME

8. FARM OR LEASE NAME

New Mexico Federal

9. WELL NO.

2

10. FIELD AND POOL, OR WILDCAT

Querecho

11. SEC., T., R., M., OR BLK.
AND SURVEY OR AREASec. 35, T-18-S,
R-32-E

12. COUNTY OR PARISH

Lea

13. STATE

New Mexico

17. NO. OF ACRES ASSIGNED
TO THIS WELL

40

20. ROTARY OR CABLE TOOLS

Total Rotary

22. APPROX. DATE WORK WILL START*

30 June 1981

1a. TYPE OF WORK

DRILL ☒DEEPEN ☐PLUG BACK ☐

b. TYPE OF WELL

OIL
WELL ☒GAS
WELL ☒

OTHER

SINGLE
ZONE ☐MULTIPLE
ZONE ☐

2. NAME OF OPERATOR

William E. Hendon, Jr.

3. ADDRESS OF OPERATOR

601 N. Loraine, Suite 111, Midland, Texas 79701

4. LOCATION OF WELL (Report location clearly and in accordance with any State requirements.)*

At surface

760 FNL & 1880 FEL

At proposed prod. zone

760 FNL & 1880 FEL

14. DISTANCE IN MILES AND DIRECTION FROM NEAREST TOWN OR POST OFFICE*

3-1/2 miles SE of Maljamar, New Mexico

15. DISTANCE FROM PROPOSED*

LOCATION TO NEAREST
PROPERTY OR LEASE LINE, FT.
(Also to nearest drlg. unit line, if any)

760' FNL

16. NO. OF ACRES IN LEASE

400

18. DISTANCE FROM PROPOSED LOCATION*
TO NEAREST WELL, DRILLING, COMPLETED,
OR APPLIED FOR, ON THIS LEASE, FT.

100' West

19. PROPOSED DEPTH

3,000

21. ELEVATIONS (Show whether DF, RT, GR, etc.)

3729 Ground Level

23.

PROPOSED CASING AND CEMENTING PROGRAM

SIZE OF HOLE	SIZE OF CASING	WEIGHT PER FOOT	SETTING DEPTH	QUANTITY OF CEMENT
7-7/8"	5-1/2"	14# H-40	3,000	520 cubic feet to circ.
12 1/4"	8 5/8"	24# J-55	300	120 ft ³ to circ.

Cementing Program

Filler slurry tailed in with
150 sx. Class C neat. Cement
will be circulated to surface.

Logging Program

- 1) Compensated-Neutron Density
- 2) BHC-Sonic
- 3) Dual-Induction Laterlog

Mud Program

Depth	Wt.	Visc.	Waterloss
0'-1000'	10 lb. (native gel)	40 - 50	10 or less
1000'-3000'	10.0 - 10.2	50	less than 8

Blowout Preventer Program

See Attachment

IN ABOVE SPACE DESCRIBE PROPOSED PROGRAM: If proposal is to deepen or plug back, give data on present productive zone and proposed new productive zone. If proposal is to drill or deepen directionally, give pertinent data on subsurface locations and measured and true vertical depths. Give blowout preventer program, if any.

24.

SIGNED

Timothy Hartsfield

TITLE

Operations Engineer

DATE

June 15, 1981

(This space for Federal or State office use)

PERMIT NO.

APPROVED

APPROVAL DATE

APPROVED BY

JAMES A. GILLHAM

TITLE

DATE

CONDITIONS OF APPROVAL IF ANY

FOR

JAMES A. GILLHAM
DISTRICT SUPERVISOR

*See Instructions On Reverse Side

NEW MEXICO OIL CONSERVATION COMMISSION
WELL LOCATION AND ACREAGE DEDICATION PLAT

Form C-102
Supersedes C-128
Effective 1-1-65

All distances must be from the outer boundaries of the Section.

Owner WILLIAM E. HENDON, JR.		Lease New Mexico Federal "35"		Well No. 2	
Letter B	Section 35	Township 18 - S	Range 32 - E	County LEA	
Well Footage Location of Well: 760 feet from the NORTH line and 1080 feet from the EAST line					
Well Level Elev: 3728	Producing Formation objective-Barnett		Pool Querecho		Dedicated Acreage: 40 Acres

Outline the acreage dedicated to the subject well by colored pencil or hatchure marks on the plat below.

If more than one lease is dedicated to the well, outline each and identify the ownership thereof (both as to working interest and royalty).

If more than one lease of different ownership is dedicated to the well, have the interests of all owners been consolidated by communitization, unitization, force-pooling, etc?

☐ Yes ☐ No If answer is "yes," type of consolidation _____

If answer is "no," list the owners and tract descriptions which have actually been consolidated. (Use reverse side of this form if necessary.) _____

No allowable will be assigned to the well until all interests have been consolidated (by communitization, unitization, forced-pooling, or otherwise) or until a non-standard unit, eliminating such interests, has been approved by the Commission.

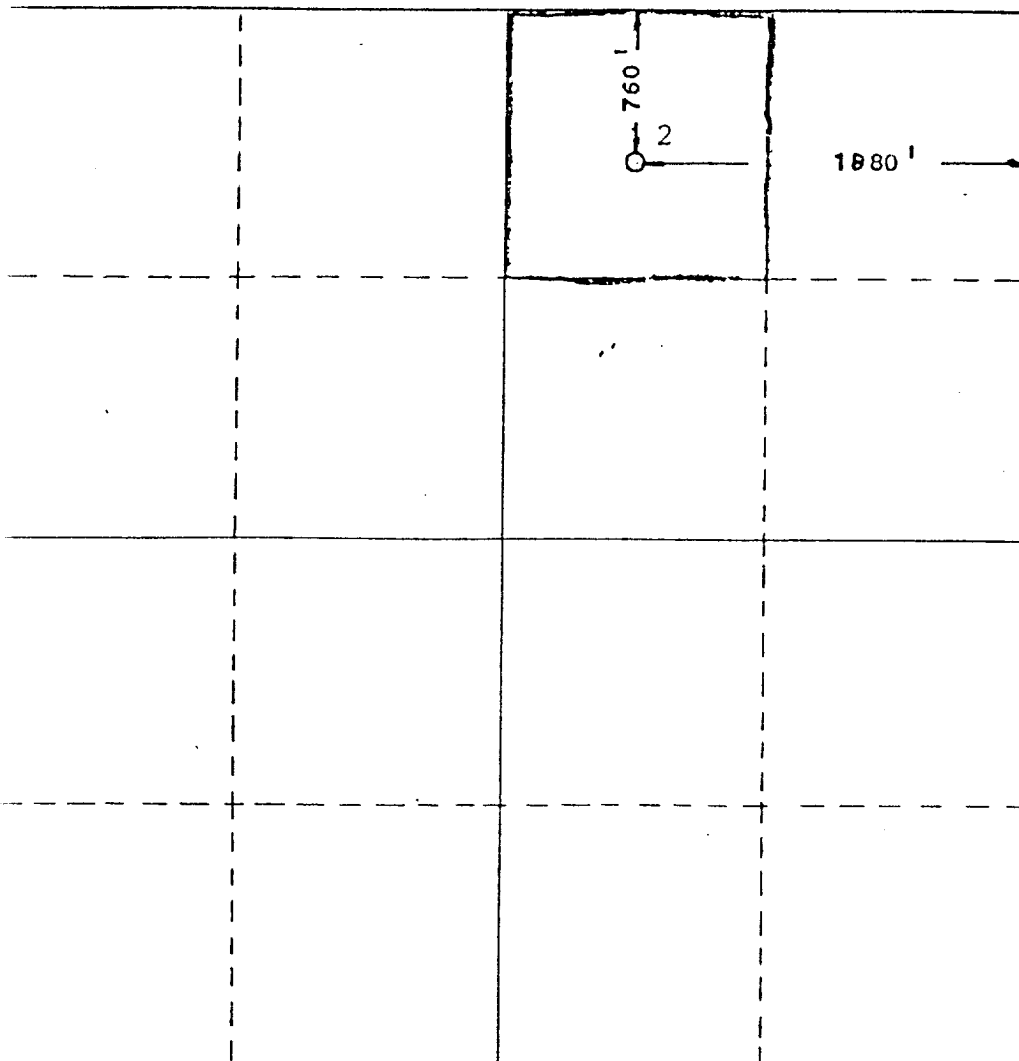

CERTIFICATION

I hereby certify that the information contained herein is true and complete to the best of my knowledge and belief.

Timothy Hartsfield

Name

Operations Engineer

Position

William E. Hendon, Jr.

Company

May 19, 1981

Date

I hereby certify that the well location shown on this plat was plotted from field notes of actual surveys made by me or under my supervision, and that the same is true and correct to the best of my knowledge and belief.

Date Surveyed

May 13, 1981

Registered Professional Engineer
and/or Land Surveyor

Merle E. Shows
Certificate No.

RECEIVED

JUN 24 1981

OIL CONSERVATION DIV

FILED