

30-025-27737

NO. OF COPIES RECEIVED		
DISTRIBUTION		
SANTA FE		
FILE		
U.S.G.S.		
LAND OFFICE		
OPERATOR		

NEW MEXICO OIL CONSERVATION COMMISSION

Form C-101
Revised 1-1-65

5A. Indicate Type of Lease	
STATE <input checked="" type="checkbox"/>	FEE <input type="checkbox"/>
5. State Oil & Gas Lease No.	
LG 1045	

APPLICATION FOR PERMIT TO DRILL, DEEPEN, OR PLUG BACK

1a. Type of Work		7. Unit Agreement Name	
b. Type of Well DRILL <input checked="" type="checkbox"/> DEEPEN <input type="checkbox"/> PLUG BACK <input type="checkbox"/> OIL WELL <input type="checkbox"/> GAS WELL <input checked="" type="checkbox"/> OTHER <input type="checkbox"/> SINGLE ZONE <input checked="" type="checkbox"/> MULTIPLE ZONE <input type="checkbox"/>		8. Farm or Lease Name Buffalo East Deep Unit	
2. Name of Operator Grace Petroleum Corporation		9. Well No. 1	
3. Address of Operator P.O. Drawer 2358, Midland, Texas 79702-2358		10. Field and Pool, or Wildcat Undesignated (2)	
4. Location of Well UNIT LETTER <u>B</u> LOCATED <u>660</u> FEET FROM THE <u>North</u> LINE AND <u>1980</u> FEET FROM THE <u>East</u> LINE OF SEC. <u>2</u> TWP. <u>19-S</u> RGE. <u>33-E</u> NMPM		12. County Lea	
19. Proposed Depth 14,500		19A. Formation Devonian	
20. Rotary or C.T. Rotary		21. Elevations (Show whether DE, RT, etc.) 3761 GR	
21A. Kind & Status Plug. Bond Blanket on file		21B. Drilling Contractor Unknown	
22. Approx. Date Work will start 2-26-82			

23.

PROPOSED CASING AND CEMENT PROGRAM

SIZE OF HOLE	SIZE OF CASING	WEIGHT PER FOOT	SETTING DEPTH	SACKS OF CEMENT	EST. TOP
17 1/2	13 3/8	54.5	500'	525	Circulate
12 1/4	9 5/8	36	5000'	2375	Calc. to circulate
8 3/4	7	23,26,29	13700'	710-1st stage 485-2nd stage 320-3rd stage	4500'
6	4 1/2 liner	11.6	14500'	200	

The well will be drilled to a depth of 14,500' or to a depth sufficient to test the Devonian. Dual 1500 Series ram type blowout preventers and one Hydril will be used for pressure control.

APPROVAL VALID FOR 180 DAYS
PERMIT EXPIRES 8/10/82
UNLESS DRILLING UNDERWAY

IN ABOVE SPACE DESCRIBE PROPOSED PROGRAM; IF PROPOSAL IS TO DEEPEN OR PLUG BACK, GIVE DATA ON PRESENT PRODUCTIVE ZONE AND PROPOSED NEW PRODUCTIVE ZONE. GIVE BLOWOUT PREVENTER PROGRAM, IF ANY.

I hereby certify that the information above is true and complete to the best of my knowledge and belief.

Signed Buddy J. Knight Title District Production Manager Date 2-8-82

(This space for State Use)

APPROVED BY Jerry Barton TITLE District Supervisor DATE FEB 11 1982

CONDITIONS OF APPROVAL, IF ANY:

NE EXICO OIL CONSERVATION COMMISSION
WELL LOCATION AND ACREAGE DEDICATION PLAT

Form C-102
Supersedes C-128
Effective 1-1-65

All distances must be from the outer boundaries of the Section

Operator Grace Petroleum Company			Lease Buffalo East Deep Unit			Well No. 1		
Unit Letter B	Section 2	Township 19 South	Range 33 East	County Lea				
Actual Well Location of well: 660 feet from the north line and 1980 feet from the east line								
Ground Level Elev. 3761.0'		Producing Formation Devonian		Pool Undesignated			Dedicated Acreage 320 Acres	

1. Outline the acreage dedicated to the subject well by colored pencil or hatchure marks on the plat below.
2. If more than one lease is dedicated to the well, outline each and identify the ownership thereof (both as to working interest and royalty).
3. If more than one lease of different ownership is dedicated to the well, have the interests of all owners been consolidated by communitization, unitization, force-pooling, etc?

☐ Yes ☐ No If answer is "yes," type of consolidation _____

If answer is "no," list the owners and tract descriptions which have actually been consolidated. (Use reverse side of this form if necessary.) _____

No allowable will be assigned to the well until all interests have been consolidated (by communitization, unitization, forced-pooling, or otherwise) or until a non-standard unit, eliminating such interests, has been approved by the Commission.

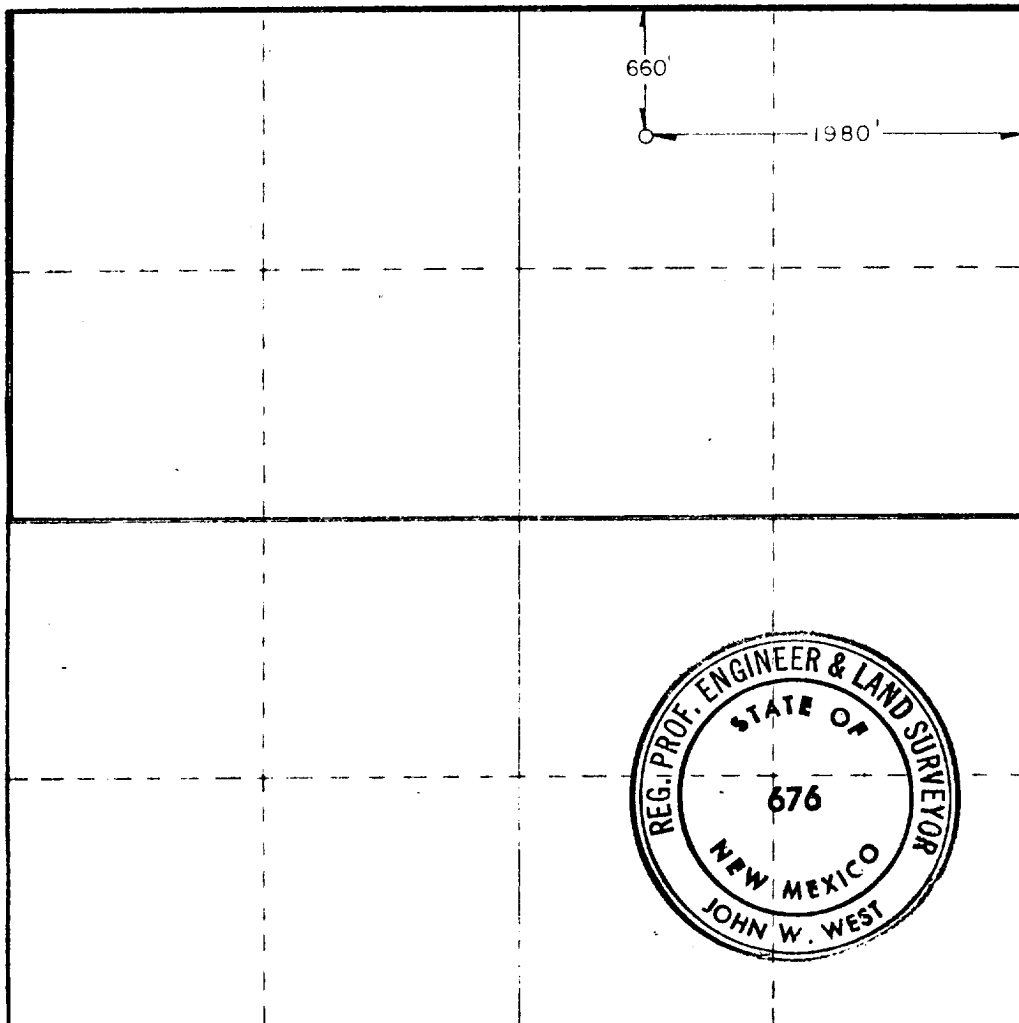

CERTIFICATION

I hereby certify that the information contained herein is true and complete to the best of my knowledge and belief.

Name

Buddy J. Knight

Position

District Production Manager

Company

Grace Petroleum Corporation

Date

2-8-82

I hereby certify that the well location shown on this plat was plotted from field notes of actual surveys made by me or under my supervision, and that the same is true and correct to the best of my knowledge and belief.

Date Surveyed

2-4-82

Registered Professional Engineer and/or Land Surveyor

Certificate No.

JOHN W. WEST

676

PATRICK A. ROMERO

6668

Ronald J. Eidson

3239

0 330 660 990 1320 1650 1980 2310 2640 2970 3300 3630 3960 4290 4620 4950 5280 5610 5940 6270 6600