

NEW MEXICO OIL CONSERVATION COMMISSION
WELL LOCATION AND ACREAGE DEDICATION PLAT

Form
Supersedes L-124
Effective 1-1-55

All distances must be from the outer boundaries of the Section.

Operator SHELL OIL CO.		Lease SHELL STATE VI		Well No. 1
Unit Letter P	Section 1	Township 17 SOUTH	Range 34 EAST	County LEA
Actual Location of Well: 990 feet from the SOUTH line 990 feet from the EAST line				
Ground Level Elev. 4041.2	Producing Formation MISSISSIPPIAN	Pool Wildcat NORTH VACUUM MORROW GAS	Acreage Dedicated 320	

1. Outline the acreage dedicated to the subject well by colored pencil or hatchure marks on the plat below.
2. If more than one lease is dedicated to the well, outline each and identify the ownership share of (both as to ownership interest and royalty).
3. If more than one lease of different ownership is dedicated to the well, have the interests of all owners been consolidated by communitization, unitization, force-pooling, etc?

☐ Yes ☐ No If answer is "yes," type of consolidation _____

If answer is "no," list the owners and tract descriptions which have actually been consolidated (Use reverse side of this form if necessary.) _____

No allowable will be assigned to the well until all interests have been consolidated (by communitization, unitization, force-pooling, or otherwise) or until a non-standard unit, eliminating such interests, has been approved by the Commission.

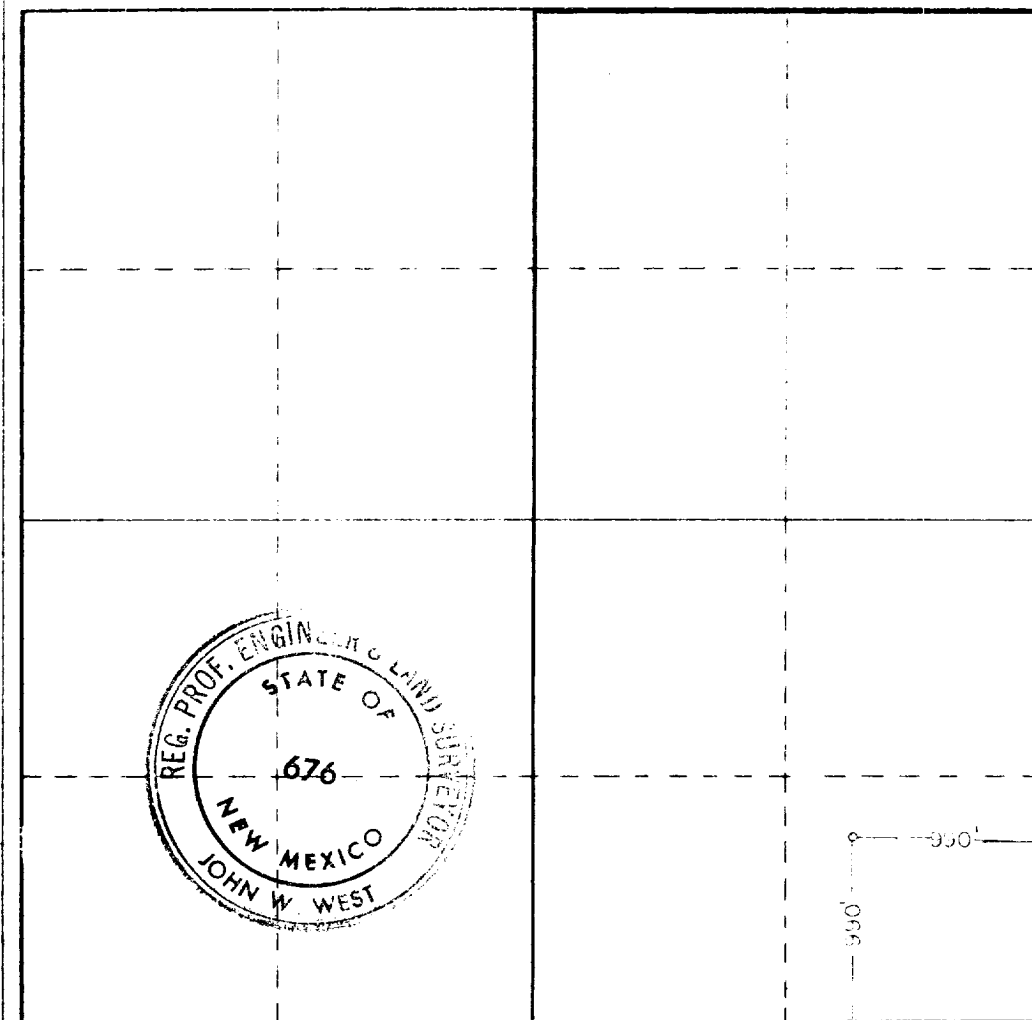

CERTIFICATION

I hereby certify that the information furnished herein is true and complete to the best of my knowledge and belief.

[Signature]

Supervisor

SUPERVISOR REG. & PERMITTING

Company

SHELL OIL COMPANY

Date

SEPTEMBER 29, 1982

I hereby certify that the well location shown on this plat was plotted from field notes of actual surveys made by me or under my supervision, and that the same is true and correct to the best of my knowledge and belief.

Date Surveyed

8-16-82

Registered Professional Engineer and/or Land Surveyor

[Signature]

Certificate No.

JOHN W. WEST 676
PATRICK A. ROMERO 6863
Ronald J. Eidson 3239

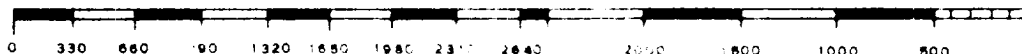

RECEIVED
GOVT 1982
MAIL ROOM
173