

OIL CONSERVATION DIVISION

P. O. BOX 2088
SANTA FE, NEW MEXICO 37501

NO. OF COPIES RECEIVED	
DISTRIBUTION	
SANTA FE	
FILE	
U.S.G.S.	
LAND OFFICE	
OPERATOR	

WELL COMPLETION OR RECOMPLETION REPORT AND LOG

API No. 30-025-27978

5a. Indicate Type of Lease	
State <input checked="" type="checkbox"/>	Fee <input type="checkbox"/>
5. State Oil & Gas Lease No.	
B-2148	

19. TYPE OF WELL	
OIL WELL <input checked="" type="checkbox"/>	GAS WELL <input type="checkbox"/> DRY <input type="checkbox"/> OTHER <input type="checkbox"/>
b. TYPE OF COMPLETION	
NEW WELL <input checked="" type="checkbox"/>	WORK OVER <input type="checkbox"/> DEEPEN <input type="checkbox"/> PLUG BACK <input type="checkbox"/> DIFF. RESVR. <input type="checkbox"/> OTHER <input type="checkbox"/>

2. Name of Operator	7. Unit Agreement Name
Phillips Petroleum Company	- -

3. Address of Operator	8. Farm or Lease Name
Room 401, 4001 Penbrook, Odessa, TX 79762	Leamex

4. Location of Well	9. Well No.
UNIT LETTER <u>L</u> LOCATED <u>1980</u> FEET FROM THE <u>south</u> LINE AND <u>990</u> FEET FROM <u>west</u> LINE OF SEC. <u>22</u> TWP. <u>17-S</u> RGE. <u>33-E</u> NMPM	34 8-1-83 4-7322

12. County	10. Field and Pool, or Wildcat
Lea	Maljamar/Grayburg San Andres

15. Date Spudded	16. Date T.D. Reached	17. Date Compl. (Ready to Prod.)	18. Elevations (DF, RKB, RT, GR, etc.)	19. Elev. Casinghead
1-19-83	2-2-83	4-25-83	4156 GR	- -

20. Total Depth	21. Plug Back T.D.	22. If Multiple Compl., How Many	23. Intervals Drilled By	Rotary Tools	Cable Tools
6400'	6362'	N/A	- - - - -	X	- -

24. Producing Interval(s), of this completion - Top, Bottom, Name	25. Was Directional Survey Made
Grayburg/San Andres Top: 4137' Btm 6400'	No

26. Type Electric and Other Logs Run	27. Was Well Cored
DLL/RXO/GR, LDT/CNL/GR/Cal	No

28. CASING RECORD (Report all strings set in well)					
CASING SIZE	WEIGHT LB./FT.	DEPTH SET	HOLE SIZE	CEMENTING RECORD	AMOUNT PULLED
8-5/8"	24# K-55	1546'	12-1/4"	350 sx Class "C" w/15% DD, 2% CaCl & 1/4# Flocele followed by 200 sx Class "C" w/2% CaCl. Circd 30 sx to surface.	
4-1/2"	11.6# N-80	6400'		900 sx TLW w/10% DD, 10% salt, 1/4#/sx cellophane flakes & 3#/sx Gilsonite followed by 600 sx Class C neat. Circd 75 sx to surface.	

29. PERFORATION RECORD				30. TUBING RECORD			
SIZE	TOP	BOTTOM	SACKS CEMENT	SCREEN	SIZE	DEPTH SET	PACKER SET
					2-3/8"	4517'	- -
N - O - N - E							

31. Perforation Record (Interval, size and number)		32. ACID, SHOT, FRACTURE, CEMENT SQUEEZE, ETC.	
Gearhart perf'd 4-1/2" csg w/2 JSPF as follows:			
4181' - 4184'	4424' - 4426'	DEPTH INTERVAL	
4320' - 4325'	4435' - 4440'	AMOUNT AND KIND MATERIAL USED	
4375' - 4379'	4442' - 4450'	4181-4511' 3000 gals NeFe HCl w/ball sealers. Frac'd w/32,000# 20/40 mesh sd & 1800# 10/20 mesh sand	
4404' - 4406'	4463' - 4469'		
4410' - 4414'	4509' - 4511'		
4416' - 4418'			

33. Total 43', 86 shots		PRODUCTION	
Date First Production	Production Method (Flowing, gas lift, pumping - Size and type pump)	Well Status (Prod. or Shut-in)	
4-27-83	Flowing	Producing	

Date of Test	Hours Tested	Choke Size	Prod'n. For Test Period	Oil - Bbl.	Gas - MCF	Water - Bbl.	Gas - Oil Ratio
5-4-83	24	18/64"	- - - - -	109	194	3	1782
Flow Tubing Press.	Casing Pressure	Calculated 24-Hour Rate	Oil - Bbl.	Gas - MCF	Water - Bbl.	Oil Gravity - API (Corr.)	
260#	- -	- - - - -	- -	- -	- -	37.4	

34. Disposition of Gas (Sold, used for fuel, vented, etc.)	Test Witnessed By
Sold	Don Thorp

35. List of Attachments
Logs furnished direct by Schlumberger.

36. I hereby certify that the information shown on both sides of this form is true and complete to the best of my knowledge and belief.		
SIGNED <u>W. J. Mueller</u>	TITLE <u>Sr. Engrg. Specialist</u>	DATE <u>May 11, 1983</u>

INSTRUCTIONS

This form is to be filed with the appropriate District Office of the Division not later than 20 days after the completion of any newly-drilled or deepened well. It shall be accompanied by one copy of all electrical and radio-activity logs run on the well and a summary of all special tests conducted, including drill stem tests. All depths reported shall be measured depths. In the case of directionally drilled wells, true vertical depths shall also be reported. For multiple completions, Items 30 through 34 shall be reported for each zone. The form is to be filed in quintuplicate except on state land, where six copies are required. See Rule 1105.

INDICATE FORMATION TOPS IN CONFORMANCE WITH GEOGRAPHICAL SECTION OF STATE

Southeastern New Mexico

Northwestern New Mexico

Rustler	1504'	T. Canyon	T. Ojo Alamo	T. Penn. "B"
xxxxxx		T. Strawn	T. Kirtland-Fruitland	T. Penn. "C"
T. Salt		T. Atoka	T. Pictured Cliffs	T. Penn. "D"
B. Salt		T. Miss	T. Cliff House	T. Leadville
T. Yates	2763'	T. Devonian	T. Menefee	T. Madison
T. 7 Rivers		T. Silurian	T. Point Lookout	T. Elbert
T. Queen	3752'	T. Montoya	T. Mancos	T. McCracken
T. Grayburg	4137'	T. Simpson	T. Gallup	T. Ignacio Qizte
T. San Andres	4520'	T. McKee	Base Greenhorn	T. Granite
T. Giorietz	5963'	T. Ellenburger	T. Dakota	T.
T. Paddock	6104'	T. Gr. Wash	T. Morrison	T.
T. Blinberry		T. Granite	T. Todilto	T.
T. Tubb		T. Delaware Sand	T. Entrada	T.
T. Drinkard		T. Bone Springs	T. Wingate	T.
T. Abo		T.	T. Chinle	T.
T. Wolfcamp		T.	T. Permian	T.
T. Penn.		T.	T. Penn. "A"	T.
T. Cisco (Bough C)		T.		

OIL OR GAS SANDS OR ZONES

No. 1, from.....to.....	No. 4, from.....to.....
No. 2, from.....to.....	No. 5, from.....to.....
No. 3, from.....to.....	No. 6, from.....to.....

IMPORTANT WATER SANDS

Include data on rate of water inflow and elevation to which water rose in hole.

No. 1, from.....to.....	feet.....
No. 2, from.....to.....	feet.....
No. 3, from.....to.....	feet.....
No. 4, from.....to.....	feet.....

FORMATION RECORD (Attach additional sheets if necessary)

From	To	Thickness in Feet	Formation	From	To	Thickness in Feet	Formation
0	1454'	1454'	Redbeds				
1454'	1526'	72'	Anhy				
1526'	2941'	1415'	Redbeds				
2941'	3175'	234'	Anhy & shale				
3175'	3702'	527'	Anhy				
3702'	4203'	501'	Shale & anhy				
4203'	5682'	1479'	Lime & shale				
5682'	5932'	250'	Dolo				
5932'	6089'	157'	Lime & shale.				
6089'	6400'	311'	Shale				

RECEIVED
MAY 13 1983
O.C.D.
HOGBS OFFICE

NEW MEXICO OIL CONSERVATION COMMISSION
WELL LOCATION AND ACREAGE DEDICATION PLAT

Form C-102
Supersedes C-128
Effective 1-1-63

All distances must be from the outer boundaries of the Section.

Operator PHILLIPS PETROLEUM COMPANY			Lease LEAMEX		Well No. 34
Unit Letter L	Section 22	Township 17 SOUTH	Range 33 EAST	County LEA	
Actual Footage Location of Well: 990 feet from the WEST line and 1980 feet from the SOUTH line					
Ground Level Elev. 4156 GR 4168 KB	Producing Formation Grayburg San Andres	Pool Maljamar	Dedicated Acreage: 40 Acres		

1. Outline the acreage dedicated to the subject well by colored pencil or hachure marks on the plat below.
2. If more than one lease is dedicated to the well, outline each and identify the ownership thereof (both as to working interest and royalty).
3. If more than one lease of different ownership is dedicated to the well, have the interests of all owners been consolidated by communitization, unitization, force-pooling, etc?

☐ Yes ☐ No If answer is "yes," type of consolidation _____

If answer is "no," list the owners and tract descriptions which have actually been consolidated. (Use reverse side of this form if necessary.) _____

No allowable will be assigned to the well until all interests have been consolidated (by communitization, unitization, forced-pooling, or otherwise) or until a non-standard unit, eliminating such interests, has been approved by the Commission.

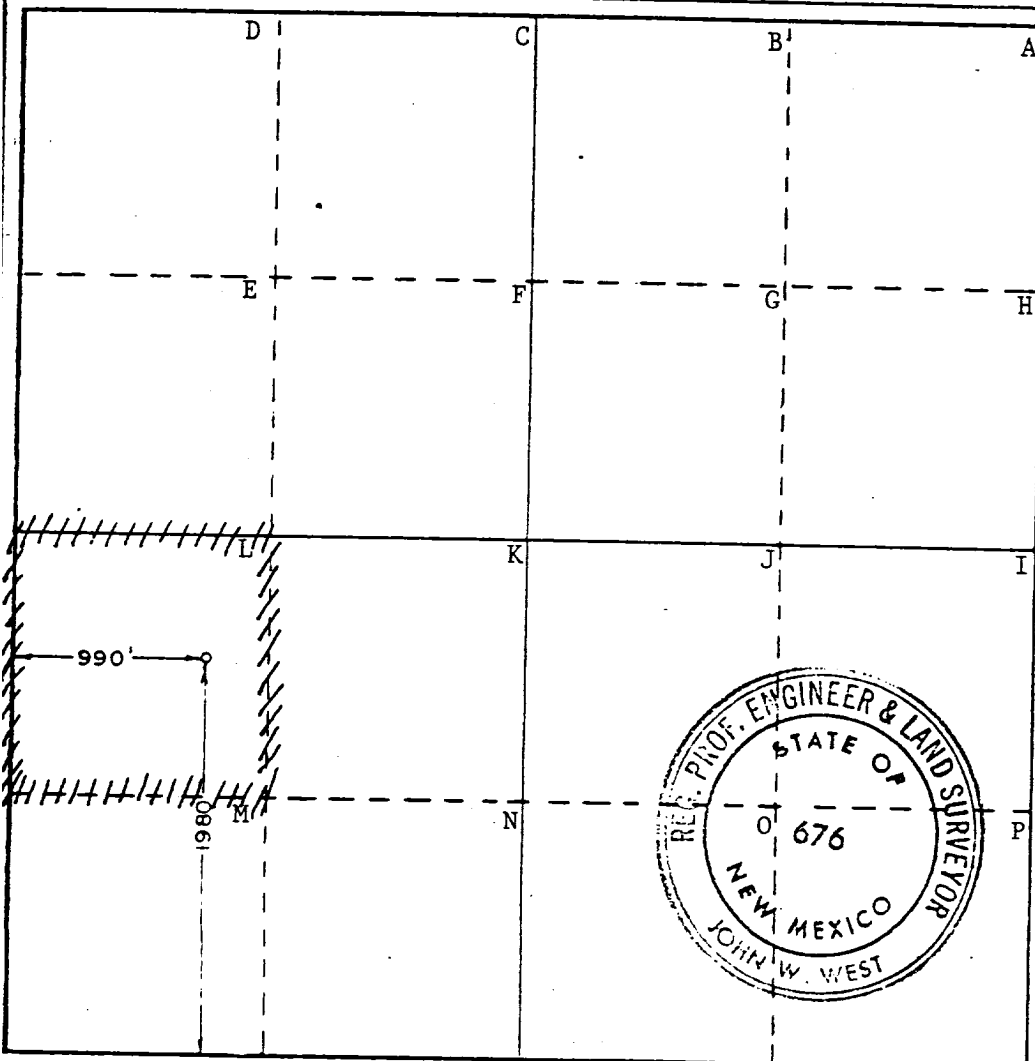

CERTIFICATION

I hereby certify that the information contained herein is true and complete to the best of my knowledge and belief.

W. J. Mueller
Name
Senior Engineering Specialist
Position
Phillips Petroleum Company
Company
May 11, 1983
Date

I hereby certify that the well location shown on this plat was plotted from field notes of actual surveys made by me or under my supervision, and that the same is true and correct to the best of my knowledge and belief.

Date Surveyed
10/05/82

Registered Professional Engineer
and/or Land Surveyor

John W. West