

STATE OF NEW MEXICO  
ENERGY AND MINERALS DEPARTMENT

OIL CONSERVATION DIVISION

P. O. BOX 2088

SANTA FE, NEW MEXICO 87501

30-025-27978

Form C-101  
Revised 10-1-78

NO. OF COPIES RECEIVED	
DISTRIBUTION	
SANTA FE	
FILE	
U.S.G.S.	
LAND OFFICE	
OPERATOR	

API No.

APPLICATION FOR PERMIT TO DRILL, DEEPEN, OR PLUG BACK

5A. Indicate Type of Lease

STATE ☒ FEE ☐

5. State Oil & Gas Lease No.

B-2148

7. Unit Agreement Name

8. Farm or Lease Name

Leamex

9. Well No.

34

10. Field and Pool, or Wildcat

Leamex Paddock

12. County

Lea

1A. Type of Work

DRILL ☒

DEEPEN ☐

PLUG BACK ☐

b. Type of Well

OIL WELL ☒

CAS WELL ☐

OTHER

SINGLE ZONE ☐

MULTIPLE ZONE ☐

2. Name of Operator

Phillips Petroleum Company

3. Address of Operator

Room 401, 4001 Penbrook St., Odessa, Texas 79762

4. Location of Well

UNIT LETTER: L LOCATED 1980 FEET FROM THE South LINE

AND 990

FEET FROM THE West LINE OF SEC. 22 TWP. 17-S RGE. 33-E NMPH

11. Elevations (Show whether DF, RT, etc.)

4158.2 Gr (Unprepared)

21A. Kind & Status Plug. Bond

blanket

19. Proposed Depth

6300'

19A. Formation

Paddock

20. Rotary or C.T.

Rotary

21B. Drilling Contractor

advise later

22. Approx. Date Work will start

upon approval

PROPOSED CASING AND CEMENT PROGRAM

SIZE OF HOLE	SIZE OF CASING	WEIGHT PER FOOT	SETTING DEPTH	SACKS OF CEMENT	EST. TOP
11"	8-5/8"	24#, K-55	1500'	350 sx Class C W/15% Diacel D.	
		2% CaCl	followed by	200sx Class C W/2% CaCl- Surface	
7-7/8"	4 1/2"	11.6#, N-80	6300'	(Sufficient quality, TLW W/2% Diacel D, 10% salt & 1/4#/sx cellophane followed by Class C neat to cover the interval from TD back to 4000' W/Class C Slurry (Circulate to Surface.)	

Use mud additives as required for control.

BOP EQUIPMENT: Series 900, 3000# WP (Figure 7 Attached)

ABOVE SPACE DESCRIBE PROPOSED PROGRAM: IF PROPOSAL IS TO DEEPEN OR PLUG BACK, GIVE DATA ON PRESENT PRODUCTIVE ZONE AND PROPOSED NEW PRODUCTIVE ZONE. GIVE BLOWOUT PREVENTER PROGRAM, IF ANY.

hereby certify that the information above is true and complete to the best of my knowledge and belief.

W. J. Mueller Title Senior Engineering Specialist Date October 15, 1982

(This space for State Use)

ORIGINAL SIGNED BY

JERRY SEXTON

APPROVED BY DISTRICT 1 SUPERVISOR TITLE

DATE

OCT 19 1982

CONDITIONS OF APPROVAL, IF ANY:

APPROVAL VALID FOR 180 DAYS

PERMIT EXPIRES 4/19/83

UNLESS DRILLING UNDERWAY

RECEIVED

OCT 18 1982

C.C.D.  
HOBBS OFFICE

NEW MICO OIL CONSERVATION COMMISSION  
WELL LOCATION AND ACREAGE DEDICATION PLAT

Form C-102  
Supersedes C-128  
Effective 1-1-65

All distances must be from the outer boundaries of the Section

Operator <b>PHILLIPS PETROLEUM COMPANY</b>			Lease <b>LEAMEX</b>		Well No. <b>34</b>
Grid Letter <b>L</b>	Section <b>22</b>	Township <b>17 SOUTH</b>	Range <b>33 EAST</b>	County <b>LEA</b>	
Actual Footage Location of Well: <b>990</b> feet from the <b>WEST</b> line and <b>1980</b> feet from the <b>SOUTH</b> line					
Ground Level Elev. <b>4158.2</b>	Producing Formation <b>Paddock</b>	Pool <b>Leamex Paddock</b>	Dedicated Acreage: <b>40</b> Acres		

1. Outline the acreage dedicated to the subject well by colored pencil or hachure marks on the plat below.
2. If more than one lease is dedicated to the well, outline each and identify the ownership thereof (both as to working interest and royalty).
3. If more than one lease of different ownership is dedicated to the well, have the interests of all owners been consolidated by communitization, unitization, force-pooling, etc?

☐ Yes ☐ No If answer is "yes," type of consolidation \_\_\_\_\_

If answer is "no," list the owners and tract descriptions which have actually been consolidated. (Use reverse side of this form if necessary.) \_\_\_\_\_

No allowable will be assigned to the well until all interests have been consolidated (by communitization, unitization, forced-pooling, or otherwise) or until a non-standard unit, eliminating such interests, has been approved by the Commission.

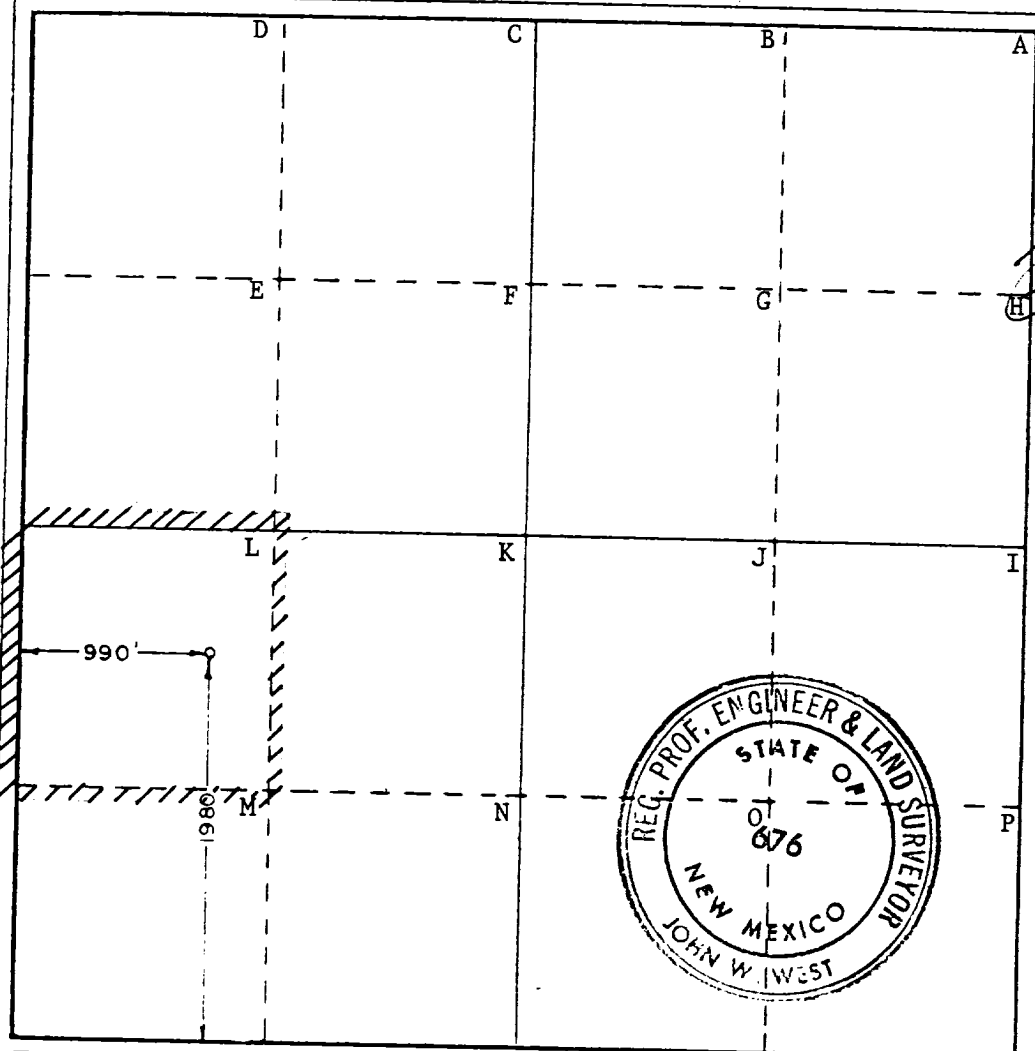

CERTIFICATION

I hereby certify that the information contained herein is true and complete to the best of my knowledge and belief.

*W. J. Mueller*  
W. J. Mueller  
Senior Engineering Specialist  
Position

Phillips Petroleum Company  
Company

October 15, 1982  
Date

I hereby certify that the well location shown on this plat was plotted from field notes of actual surveys made by me or under my supervision, and that the same is true and correct to the best of my knowledge and belief.

Date Surveyed  
10/05/82

Registered Professional Engineer and/or Land Surveyor

Certificate No. *John W. West* 676  
PATRICK A. ROMERO 6888

RECEIVED

OCT 18 1982

O.D.D.  
HOLDS OFFICE

# DOUBLE PREVENTER OPTION

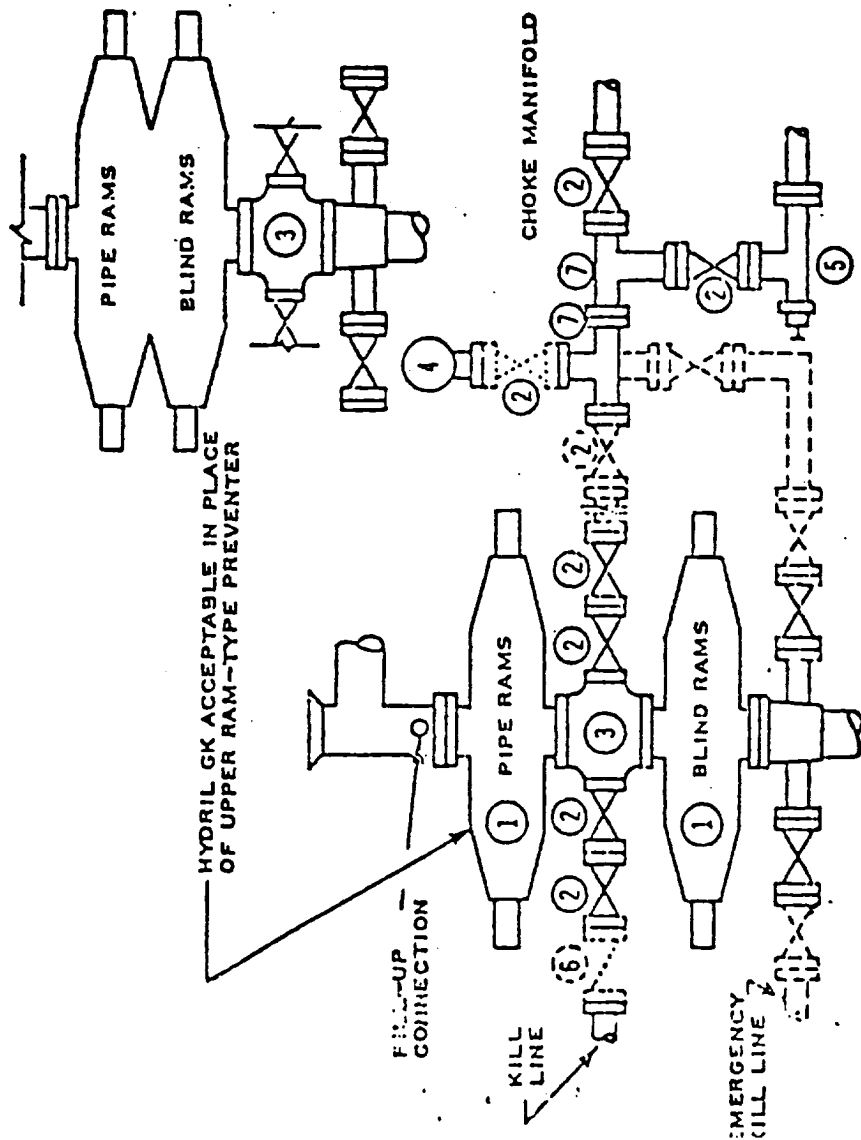

- ① SERIES 900 RAM-TYPE BOP
- ② 2" SERIES 900 VALVE
- ③ SERIES 900 DRILLING SPOOL
- ④ 2" MUD PRESSURE GAUGE
- ⑤ 2" SERIES 900 CHOKE
- ⑥ 2" SERIES 900 CHECK VALVE
- ⑦ 2" SERIES 900 STEEL TEE

## NOTES:

1. 3000 PSI WP CLAMP HUSSES MAY BE SUBSTITUTED FOR FLANGES
2. VALVES MAY BE EITHER HAND OR POWER OPERATED BUT, IF POWER OPERATED, THE VALVES FLANGED TO THE BOP RUN MUST BE CAPABLE OF BEING OPENED AND CLOSED MANUALLY OR CLOSE ON POWER FAILURE AND BE CAPABLE OF BEING OPENED MANUALLY

..... OPTIONAL EQUIPMENT

PHILLIPS PETROLEUM COMPANY

3000 PSI WORKING PRESSURE  
BLOWOUT PREVENTER HOOK-UP  
(SERIES 900 FLANGES OR BETTER)

RECEIVED  
OCT 18 1982  
O.C.D.  
HOUSE OFFICE

473