

NO. OF COPIES RECEIVED	
DISTRIBUTION	
SANTA FE	
FILE	
U.S.G.S.	
LAND OFFICE	
OPERATOR	

API NO.

APPLICATION FOR PERMIT TO DRILL, DEEPEN, OR PLUG BACK

1a. Type of Work

DRILL ☒

DEEPEN ☐

PLUG BACK ☐

b. Type of Well

OIL WELL ☒

GAS WELL ☐

OTHER

SINGLE ZONE ☒

MULTIPLE ZONE ☐

2. Name of Operator

Phillips Petroleum Company

3. Address of Operator

Room 401, 4001 Penbrook St., Odessa, Texas 79762

4. Location of Well

UNIT LETTER K LOCATED 2130 FEET FROM THE south LINE

AND 1980 FEET FROM THE west LINE OF SEC. 22

TWP. 17-S RGE. 33-E NMPM

5A. Indicate Type of Lease

STATE ☒

FILE ☐

5. State Oil & Gas Lease No.

B-2148

7. Unit Agreement Name

8. Farm or Lease Name

Leamex

9. Well No.

35

10. Field and Pool, or Wildcat

Leamex (Paddock)

12. County

Lea

19. Proposed Depth

6,300'

19A. Formation

Paddock

20. Rotary or C.T.

Rotary

21. Elevations (show whether DF, KT, etc.)

4152.4 GR (Unprepared)

21A. Kind & Status Plug. Bond

blanket

21B. Drilling Contractor

advise later

22. Approx. Date Work will start

upon approval

23.

PROPOSED CASING AND CEMENT PROGRAM

SIZE OF HOLE	SIZE OF CASING	WEIGHT PER FOOT	SETTING DEPTH	SACKS OF CEMENT	EST. TOP
11"	8-5/8"	24#, K-55	1500'	350 sx Class C W/15% Diacel D.	
	2% CaCl, 1/4#	sx cellophane follow	W/200sx Class C W/2% CaCl.	circ to surface.	
7-7/8"	4-1/2"	11.6#, N-80	6300'	(Tie back to surface casing W/ sufficient volume plus 30% excess TLW W/10% Diacel D, 10% Salt, and 1/4# /sx cellophane followed by Class C neat)	

Use mud additives as required for control.

BOP EQUIPMENT: Series 900, 3000 psi WP. (See Figure 7 Attached)

ABOVE SPACE DESCRIBE PROPOSED PROGRAM IF PROPOSAL IS TO DEEPEN OR PLUG BACK, GIVE DATA ON PRESENT PRODUCTIVE ZONE AND PROPOSED NEW PRODUCTIVE ZONE. GIVE BLOWOUT PREVENTER PROGRAM, IF ANY.

hereby certify that the information above is true and complete to the best of my knowledge and belief.

W. J. Mueller Title Senior Engineering Specialist Date October 20, 1982

(This space for State Use)

APPROVED BY

OIL & GAS INSPECTOR

DATE OCT 22 1982

CONDITIONS OF APPROVAL, IF ANY:

APPROVAL VALID FOR 180 DAYS
PERMIT EXPIRES 4/22/83
UNLESS DRILLING UNDERWAY

NEW MEXICO OIL CONSERVATION COMMISSION
WELL LOCATION AND ACREAGE DEDICATION PLAT

Form C-102
Supersedes C-128
Effective 1-4-85

All distances must be from the outer boundaries of the Section.

Operator PHILLIPS PETROLEUM COMPANY		Lease LEAMEX		Well No. 35
West Letter K	Section 22	Township 17 SOUTH	Range 33 EAST	County LEA
Actual Footage Location of Well: 2130 feet from the SOUTH line and 1980 feet from the WEST line				
Ground Level Elev. 4152.4	Producing Formation Paddock	Pool Leamex (Paddock)	Dedicated Acreage: 40 Acres	

- Outline the acreage dedicated to the subject well by colored pencil or hachure marks on the plat below.
- If more than one lease is dedicated to the well, outline each and identify the ownership thereof (both as to working interest and royalty).
- If more than one lease of different ownership is dedicated to the well, have the interests of all owners been consolidated by communitization, unitization, force-pooling, etc?

☐ Yes ☐ No If answer is "yes," type of consolidation _____

If answer is "no," list the owners and tract descriptions which have actually been consolidated. (Use reverse side of this form if necessary.) _____

No allowable will be assigned to the well until all interests have been consolidated (by communitization, unitization, forced-pooling, or otherwise) or until a non-standard unit, eliminating such interests, has been approved by the Commission.

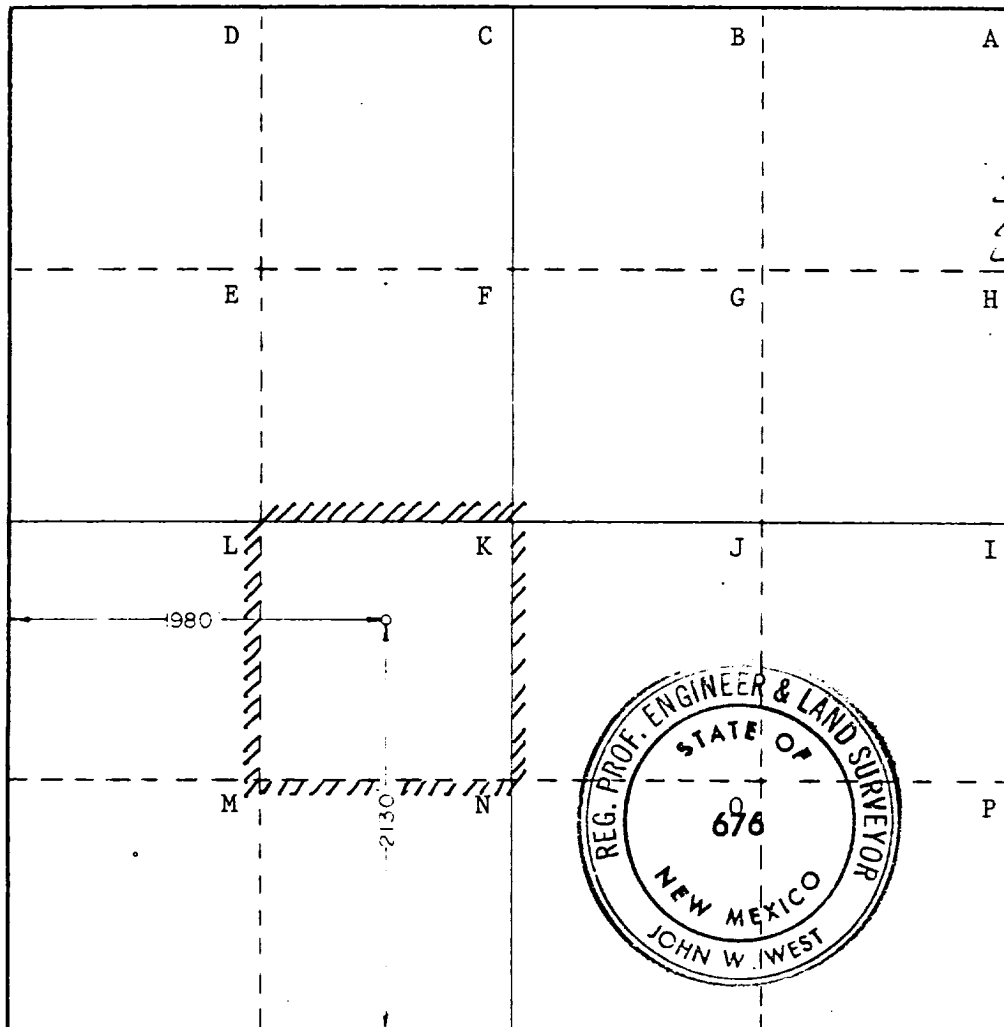

CERTIFICATION

I hereby certify that the information contained herein is true and complete to the best of my knowledge and belief.

W. J. Mueller
Name **W. J. Mueller**

Senior Engineering Specialist

Position

Phillips Petroleum Company

Company

October 20, 1982

Date

I hereby certify that the well location shown on this plat was plotted from field notes of actual surveys made by me or under my supervision, and that the same is true and correct to the best of my knowledge and belief.

Date Surveyed

10/05/82

Registered Professional Engineer and/or Land Surveyor

John W. West

Certificate No. **JOHN W. WEST 676**
PATRICK A. ROMERO 6863
Ronald J. Fiddens 3230



DOUBLE PREVENTER OPTION

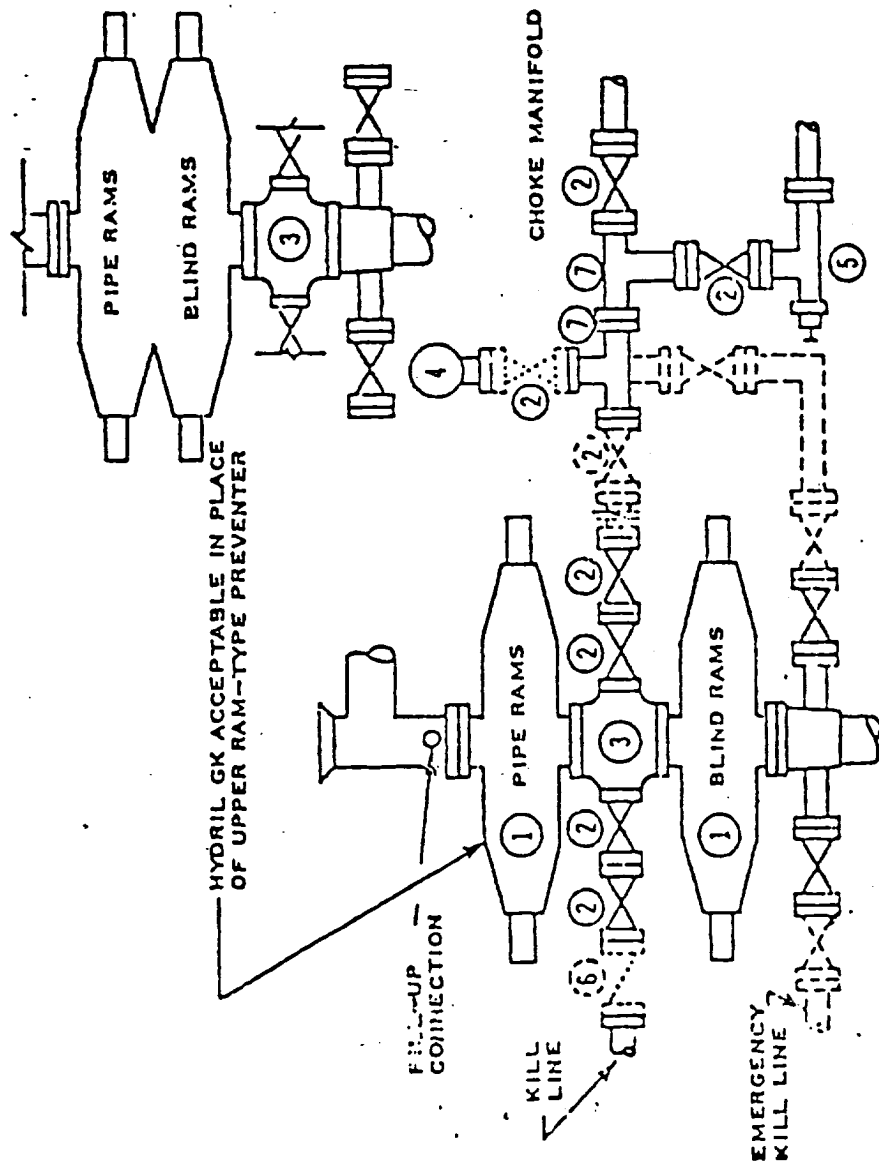

- ① SERIES 900 RAM-TYPE BOP
- ② 2" SERIES 900 VALVE
- ③ SERIES 900 DRILLING SPOOL
- ④ 2" MUD PRESSURE GAUGE
- ⑤ 2" SERIES 900 CHOKE
- ⑥ 2" SERIES 900 CHECK VALVE
- ⑦ 2" SERIES 900 STEEL TEE

NOTES:

1. 3000 PSI WP CLAMP HUBS MAY BE SUBSTITUTED FOR FLANGES
2. VALVES MAY BE EITHER HAND OR POWER OPERATED BUT, IF PCVIER OPERATED, THE VALVES FLANGED TO THE BOP RUN MUST BE CAPABLE OF BEING OPENED AND CLOSED MANUALLY OR CLOSE ON POWER FAILURE AND BE CAPABLE OF BEING OPENED MANUALLY

.....OPTIONAL EQUIPMENT

PHILLIPS PETROLEUM COMPANY

3000 PSI WORKING PRESSURE
BLOWOUT PREVENTER HOOK-UP
(SERIES 900 FLANGES OR BETTER)

REV 6/73

FIGURE NO.

RECEIVED

OCT 21 1982

O.C.D.
HOBBS OFFICE

173