

Form C-102
Supersedes C-128
Effective 4-1-65

Operator SANTA FE EXPLORATION COMPANY		Lease Ard State		Well No. 1
Unit Letter H	Section 36	Township 18 South	Range 33 East	County Lea
Actual Footage Location of Well:				
1980 feet from the North line and 330 feet from the East line				
Ground Level Elev. 3831.8'	Producing Formation San Andres	Pool Wildcat		Dedicate 1/2 Acreage: 40 Acres

- ☐ Yes ☐ No If answer is "yes," type of consolidation _____

No allowable will be assigned to the well until all interests have been consolidated (by communitization, unitization, forced-pooling, or otherwise) or until a non-standard unit, eliminating such interests, has been approved by the Commission.

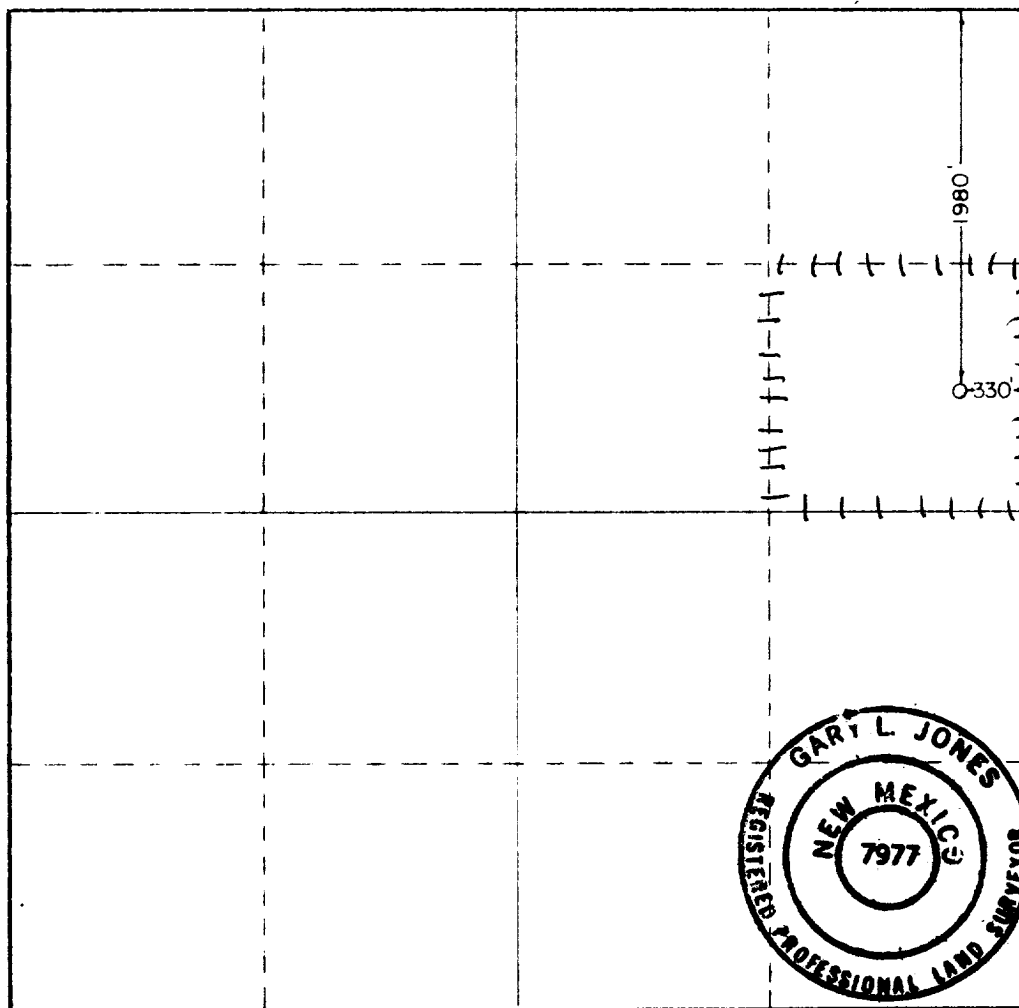

I hereby certify that the information contained herein is true and complete to the best of my knowledge and belief.

Name
Steve L. Simmons
Position
Agent
Company
Santa Fe Exploration Co
Date
11-18-82

I hereby certify that the well location shown on this plat was plotted from field notes of actual surveys made by me or under my supervision, and that the same is true and correct to the best of my knowledge and belief.

Date Surveyed
November 17, 1982
Registered Professional Engineer
and/or Land Surveyor

Certificate No. 7977

RECEIVED
NOV 18 1982
FBI
HOBBS OFFICE