

30 055-28071

Form C-101
Revised 10-1-78

NO. OF COPIES RECEIVED	
DISTRIBUTION	
SANTA FE	
FILE	
U.S.G.S.	
LAND OFFICE	
OPERATOR	

5A. Indicate Type of Lease
STATE ☒ REC ☐
5. State Oil & Gas Lease No.
LG-3862

APPLICATION FOR PERMIT TO DRILL, DEEPEN, OR PLUG BACK

1a. Type of Work DRILL <input checked="" type="checkbox"/> DEEPEN <input type="checkbox"/> PLUG BACK <input type="checkbox"/>		7. Unit Agreement Name Cresate
b. Type of Well OIL WELL <input checked="" type="checkbox"/> GAS WELL <input type="checkbox"/> OTHER <input type="checkbox"/> SINGLE ZONE <input type="checkbox"/> MULTIPLE ZONE <input type="checkbox"/>		8. Farm or Lease Name Cresate "VM" State
2. Name of Operator Yates Petroleum Corporation		9. Well No. 1
3. Address of Operator 207 S. 4th, Artesia, New Mexico 88210		10. Field and Pool, or Wildcat Arkansas Junction
4. Location of Well UNIT LETTER H LOCATED 1650 FEET FROM THE North LINE AND 330 FEET FROM THE East LINE OF SEC. 19 TWP. 18S RGE. 36E NMPM		11. County Lea
19. Proposed Depth 5700'		19A. Formation San Andres
20. Rotary or C.T. Rotary		
21. Elevations (Show whether DF, RT, etc.) 3847.1' GL	21A. Kind & Status Plug. Bond Blanket	21B. Drilling Contractor not designated
22. Approx. Date Work will start ASAP		

23. PROPOSED CASING AND CEMENT PROGRAM

SIZE OF HOLE	SIZE OF CASING	WEIGHT PER FOOT	SETTING DEPTH	SACKS OF CEMENT	EST. TOP
12 1/4"	8 3/8"	24#	1900'	650 sx	circulated
6 1/4"	4 1/2"	9.5#	TD	300 sx	

We propose to drill and test the San Andres formation. Approximately 1900' of surface casing will be set and cement circulated to shut off gravel and caving. If commercial, production casing will be run and cemented with adequate cover, perforated and stimulated as needed for production.

MUD PROGRAM: Salt water gel with starch & LCM from surface to TD.

BOP PROGRAM: BOP's will be installed at the offset and tested daily.

APPROVAL VALID FOR 180 DAYS
PERMIT EXPIRES 6/3/83
UNLESS DRILLING UNDERWAY.

IN ABOVE SPACE DESCRIBE PROPOSED PROGRAM; IF PROPOSAL IS TO DEEPEN OR PLUG BACK, GIVE DATA ON PRESENT PRODUCTIVE ZONE AND PROPOSED NEW PRODUCTIVE ZONE. GIVE BLOWOUT PREVENTER PROGRAM, IF ANY.

I hereby certify that the information above is true and complete to the best of my knowledge and belief.

Signed [Signature] Title Regulatory Manager Date 12/2/82

(This space for State Use)
ORIGINAL SIGNED BY
JERRY SEXTON
APPROVED BY _____ TITLE _____ DATE _____
CONDITIONS OF APPROVAL, IF ANY: DISTRICT 1 SUPR.

DEC 3 1982

**NEW MEXICO OIL CONSERVATION COMMISSION
WELL LOCATION AND ACREAGE DEDICATION PLAT**

Form C-102
Supersedes C-128
Effective 1-1-65

All distances must be from the outer boundaries of the Section.

Operator YATES PETROLEUM CORPORATION			Lease <u>Cresate</u> Cresate "VM" State		Well No. 1
Unit Letter H	Section 19	Township 18 South	Range 36 East	County Lea	
Actual Footage Location of Well: 1650 feet from the North line and 330 feet from the East line					
Ground Level Elev. 3847.1'	Producing Formation San Andres		Pool Arkansas Junction West	Dedicated Acreage: 40 Acres	

1. Outline the acreage dedicated to the subject well by colored pencil or hachure marks on the plat below.
2. If more than one lease is dedicated to the well, outline each and identify the ownership thereof (both as to working interest and royalty).
3. If more than one lease of different ownership is dedicated to the well, have the interests of all owners been consolidated by communitization, unitization, force-pooling, etc?

☐ Yes ☐ No If answer is "yes," type of consolidation _____

If answer is "no," list the owners and tract descriptions which have actually been consolidated. (Use reverse side of this form if necessary.) _____

No allowable will be assigned to the well until all interests have been consolidated (by communitization, unitization, forced-pooling, or otherwise) or until a non-standard unit, eliminating such interests, has been approved by the Commission.

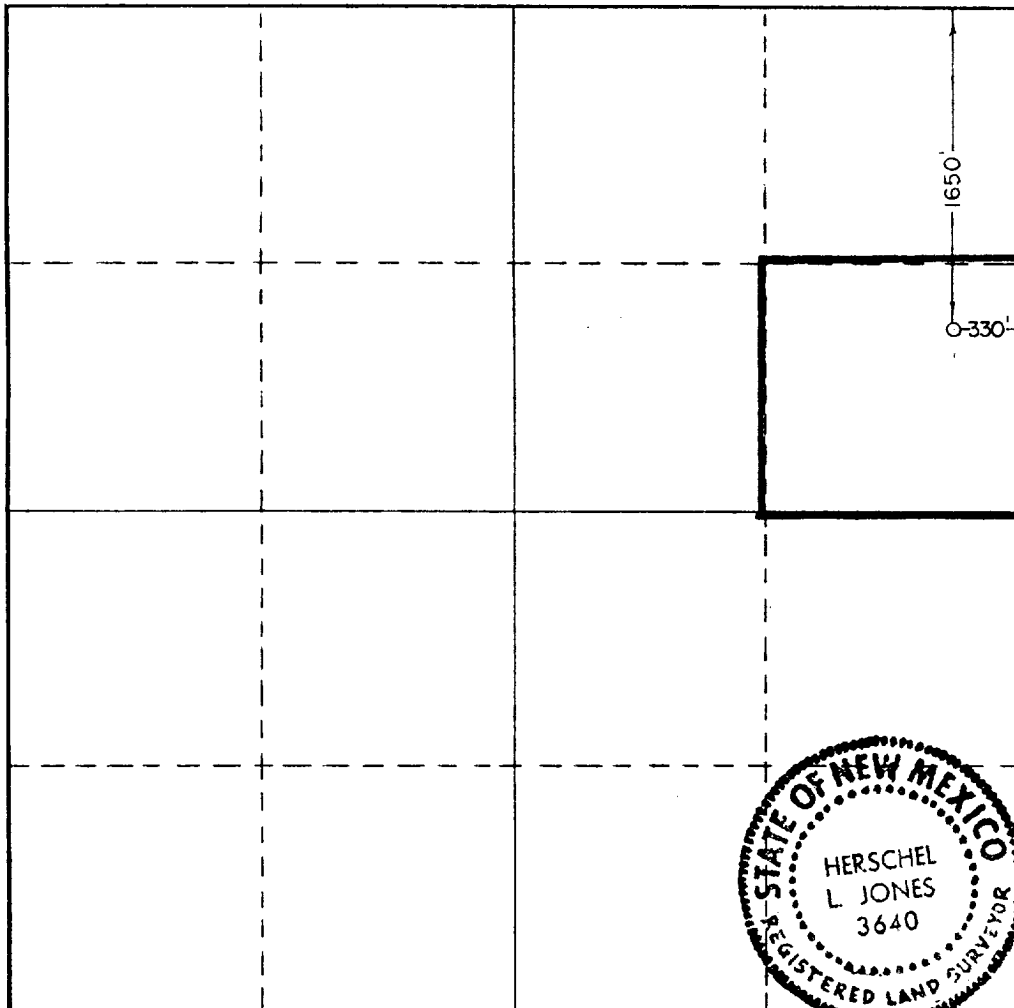

CERTIFICATION

I hereby certify that the information contained herein is true and complete to the best of my knowledge and belief.

Gliserio Rodriguez

Name
Gliserio Rodriguez
Position
Regulatory Manager
Company
Yates Petroleum Corp.

Date
12/2/82

I hereby certify that the well location shown on this plat was plotted from field notes of actual surveys made by me or under my supervision, and that the same is true and correct to the best of my knowledge and belief.

Date Surveyed
November 22, 1982

Registered Professional Engineer and/or Land Surveyor

Herschel L. Jones

Certificate No.

3640

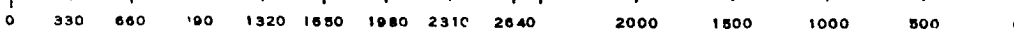

RECEIVED

DEC 3 1982

C-22
HOBBS OFFICE

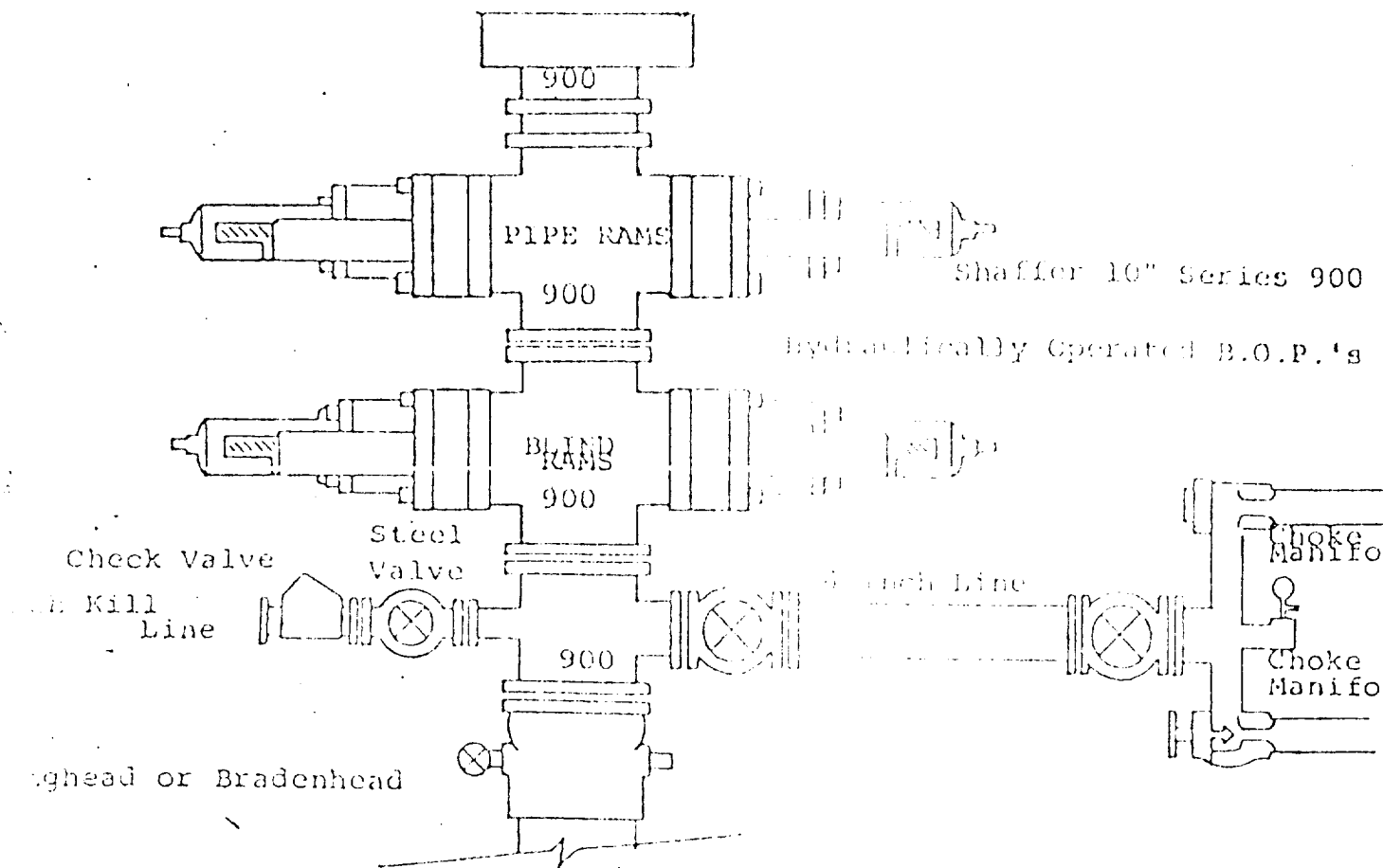

FOLLOWING CONSTITUTE MINIMUM BLOWOUT PREVENTER REQUIREMENTS

- All preventers to be hydraulically operated with secondary manual controls installed prior to drilling out from under casing.
- Choke outlet to be a minimum of 4" diameter.
- Kill line to be of all steel construction of 2" minimum diameter.
- All connections from operating manifolds to preventers to be all steel.
- Hole or tube a minimum of one inch in diameter.
- The available closing pressure shall be at least 15% in excess of that required with sufficient volume to operate the B.O.P.'s.
- All connections to and from preventer to have a pressure rating equivalent to that of the B.O.P.'s.
- Inside blowout preventer to be available on rig floor.
- Operating controls located a safe distance from the rig floor.
- Hole must be kept filled on trips below intermediate casing.

B.O.P. float must be installed and used below zone of first gas intrusion

173

RECEIVED

DEC 3 1982

LIBRARY