

District I  
PO Box 1980, Hobbs, NM 88241-1980  
District II  
PO Drawer DD, Artesia, NM 88211-0719  
District III  
1000 Rio Brazos Rd., Aztec, NM 87410  
District IV  
PO Box 2088, Santa Fe, NM 87504-2088

State of New Mexico  
Energy, Minerals & Natural Resources Department

OIL CONSERVATION DIVISION  
PO Box 2088  
Santa Fe, NM 87504-2088

Form C-101  
Revised February 10, 1994  
Instructions on back  
Submit to Appropriate District Office  
State Lease - 6 Copies  
Fee Lease - 5 Copies

☐ AMENDED REPORT

APPLICATION FOR PERMIT TO DRILL, RE-ENTER, DEEPEN, PLUGBACK, OR ADD A ZONE

Operator Name and Address. Echo Production, Inc. PO Box 1210 Graham, TX 76450		' OGRID Number 06742
		' API Number 30 - 0 25-28118
' Property Code 31992	' Property Name State '18'	' Well No. 1

7 Surface Location

UL or lot no.	Section	Township	Range	Lot Ida	Feet from the	North/South line	Feet from the	East/West line	County
F	18	18S	35E		1915	north	1915	west	Lea

8 Proposed Bottom Hole Location If Different From Surface

UL or lot no.	Section	Township	Range	Lot Ida	Feet from the	North/South line	Feet from the	East/West line	County
' Proposed Pool 1 Vacuum; Grayburg-San Andres					' Proposed Pool 2				

' Work Type Code E	' Well Type Code O	' Cable/Rotary R	' Lease Type Code S	' Ground Level Elevation 3965
' Multiple N	' Proposed Depth 4946	' Formation Grayburg	' Contractor not determined	' Spud Date 3/6/03

21 Proposed Casing and Cement Program

Hole Size	Casing Size	Casing weight/foot	Setting Depth	Sacks of Cement	Estimated TOC
12 1/2	8 5/8	24#	1761	955	circulated
7 7/8	5 1/2"	17#	4900	400	3360

22 Describe the proposed program. If this application is to DEEPEN or PLUG BACK give the data on the present productive zone and proposed new productive zone. Describe the blowout prevention program, if any. Use additional sheets if necessary.  
Well was drilled by Alps Oil Co to a TD of 4946 in 3/83 with 8 5/8" casing being set at 1761' and cemented to surface. Well was plugged w/10 sk plug at surface, 45 sx 1848-1694', 30 sx 3148-3043' and 30 sx 4800-4695'. Echo Production proposes to re-enter the well, drill out the cement plugs, set 5 1/2" casing at +4900' and complete the well in the Grayburg at approximately 4700'. Echo will utilize the pad previously built for the re-entry operation and a reverse unit to clean out so a reserve pit will not be needed. No well control problems were encountered during the drilling operations so a 3000 psi BOP will be utilized.

23 I hereby certify that the information given above is true and complete to the best of my knowledge and belief.

Signature:

Printed name:

Tom Golden

Title:

Operations Manager

Date:

2/11/03

Phone:

940-549-3292

OIL CONSERVATION DIVISION

Approved by:

ORIGINAL SIGNED BY

Title:

PAUL F. KAUTZ  
PETROLEUM ENGINEER

Approval Date:

FEB 21 2003

Expiration Date:

Conditions of Approval:

Attached ☐

Permit Expires 1 Year From Approval  
Date Unless Drilling Underway  
Re-Entry

District I  
PO Box 1988, Hobbs, NM 88241-1988  
District II  
PO Drawer DD, Artesia, NM 88211-0719  
District III  
1000 Rio Brazos Rd., Aztec, NM 87410  
District IV  
PO Box 2088, Santa Fe, NM 87504-2088

State of New Mexico  
Energy, Minerals & Natural Resources Department

OIL CONSERVATION DIVISION  
PO Box 2088  
Santa Fe, NM 87504-2088

Form C-102  
Revised February 10, 1994  
Instructions on back  
Submit to Appropriate District Office  
State Lease - 4 Copies  
Fee Lease - 3 Copies

☐ AMENDED REPORT

WELL LOCATION AND ACREAGE DEDICATION PLAT

API Number 30-025-30475		Pool Code 62180	Pool Name Vacuum; Grayburg-San Andres	
Property Code 31992	Property Name State "18"		Well Number 1	
OGRID No. 06742	Operator Name Echo Production, Inc.		Elevation 3965	

<sup>10</sup> Surface Location

UL or lot no.	Section	Township	Range	Lot Ida	Feet from the	North/South line	Feet from the	East/West line	County
F	18	18S	35E		1915	north	1915	west	Lea

<sup>11</sup> Bottom Hole Location If Different From Surface

UL or lot no.	Section	Township	Range	Lot Ida	Feet from the	North/South line	Feet from the	East/West line	County

<sup>12</sup> Dedication Acres 40	<sup>13</sup> Joint or Infill	<sup>14</sup> Consolidation Code	<sup>15</sup> Order No.
--------------------------------------	-------------------------------	----------------------------------	-------------------------

NO ALLOWABLE WILL BE ASSIGNED TO THIS COMPLETION UNTIL ALL INTERESTS HAVE BEEN CONSOLIDATED  
OR A NON-STANDARD UNIT HAS BEEN APPROVED BY THE DIVISION

<sup>16</sup> 	<sup>17</sup> OPERATOR CERTIFICATION I hereby certify that the information contained herein is true and complete to the best of my knowledge and belief.  Signature Tom Golden Printed Name Operations Manager Title 2/11/03 Date	
	<sup>18</sup> SURVEYOR CERTIFICATION I hereby certify that the well location shown on this plat was plotted from field notes of actual surveys made by me or under my supervision, and that the same is true and correct to the best of my belief.  Date of Survey Signature and Seal of Professional Surveyer:  Certificate Number	

LEASE IS 1/2 OF SEC 18

NEW CO OIL CONSERVATION COMMISSION  
WELL LOCATION AND ACREAGE DEDICATION PLAT

Form C-102  
Supersedes C-128  
Effective 1-1-65

All distances must be from the outer boundaries of the Section

Operator <b>ALPS OIL CO.</b>			Lease <b>STATE</b>		Well No. <b>1</b>
Unit Letter <b>F</b>	Section <b>18</b>	Township <b>18S</b>	Range <b>35E</b>	County <b>LEA</b>	
Actual Footage Location of Well: <b>1915</b> feet from the <b>NORTH</b> line and <b>1915</b> feet from the <b>WEST</b> line					
Ground Level Elev. <b>3965.3</b>	Producing Formation <b>San Andres</b>		Foot <b>UNDESIGNATED</b>		Dedicated Acreage: <b>40</b> Acres

1. Outline the acreage dedicated to the subject well by colored pencil or hachure marks on the plat below.
2. If more than one lease is dedicated to the well, outline each and identify the ownership thereof (both as to working interest and royalty).
3. If more than one lease of different ownership is dedicated to the well, have the interests of all owners been consolidated by communitization, unitization, force-pooling, etc?

☐ Yes ☐ No If answer is "yes," type of consolidation \_\_\_\_\_

If answer is "no," list the owners and tract descriptions which have actually been consolidated (Use reverse side of this form if necessary.) \_\_\_\_\_

No allowable will be assigned to the well until all interests have been consolidated (by communitization, unitization, forced-pooling, or otherwise) or until a non-standard unit, eliminating such interests, has been approved by the Commission.

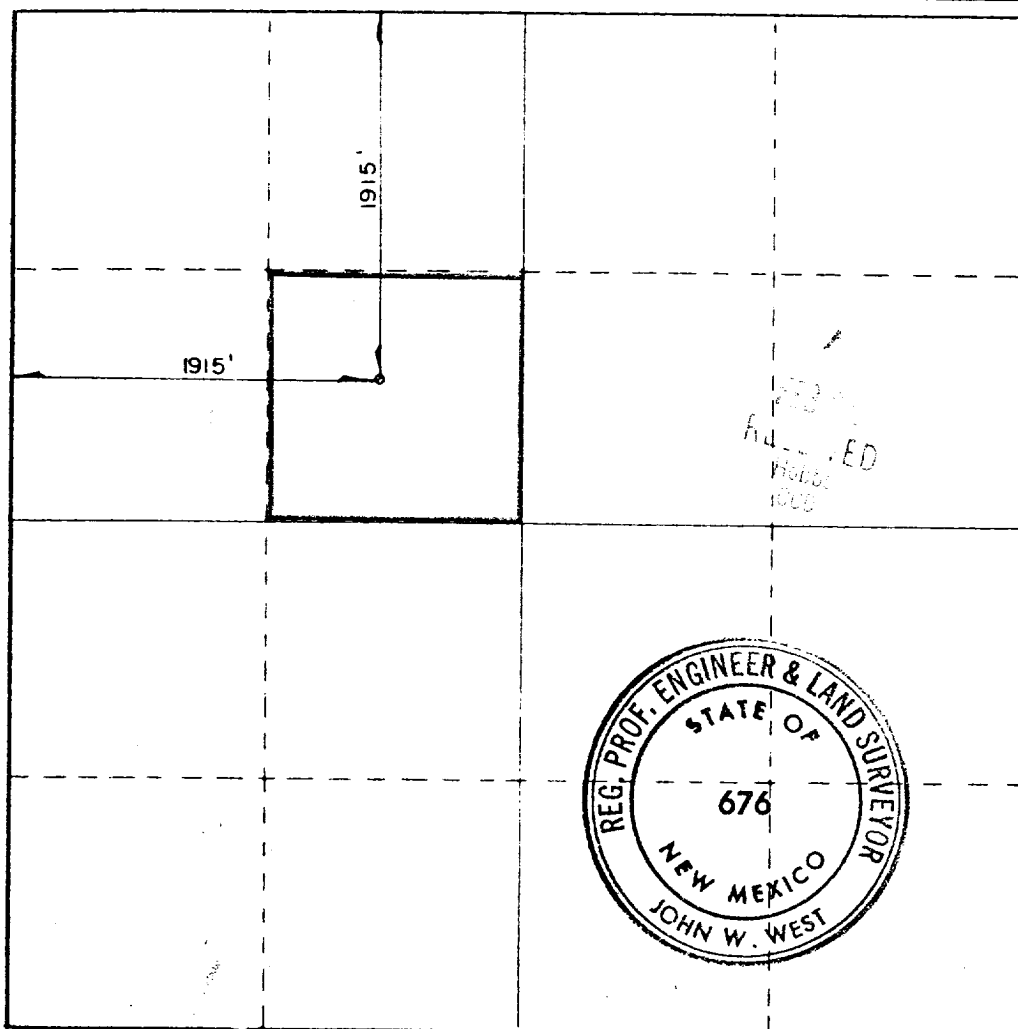

CERTIFICATION

I hereby certify that the information contained herein is true and complete to the best of my knowledge and belief.

*R. A. Coleman*

Name **R. A. Coleman**  
Position **Manager**

Company **Alps Oil Company**

Date **12-30-82**

Date

I hereby certify that the well location shown on this plat was plotted from field notes of actual surveys made by me or under my supervision, and that the same is true and correct to the best of my knowledge and belief.

Date Surveyed

**12/4/82**

Registered Professional Engineer and/or Land Surveyor

*John W. West*

Certificate No  
**JOHN W. WEST N.M. #676**