

District I
1625 N. French Dr., Hobbs, NM 88240
District II
811 South First, Artesia, NM 88210
District III
1000 Rio Brazos Road, Aztec, NM 87410
District IV
2040 South Pacheco, Santa Fe, NM 87505

State of New Mexico
Energy Minerals and Natural Resources

Form C-101
Revised March 17, 1999

Oil Conservation Division
2040 South Pacheco
Santa Fe, NM 87505

Submit to appropriate District Office
State Lease - 6 Copies
Fee Lease - 5 Copies

☐ AMENDED REPORT

APPLICATION FOR PERMIT TO DRILL, RE-ENTER, DEEPEN, PLUGBACK, OR ADD A ZONE

¹ Operator Name and Address Western Oil Producers, Inc. P.O. Box 2055 Roswell, NM 88202-2055		² OGRID Number 024961
³ Property Code 27050	³ Property Name Yeso State	³ API Number 30-025-35315 28125
		³ Well No. 1

⁷ Surface Location

UL or lot no.	Section	Township	Range	Lot Idn	Feet from the	North/South line	Feet from the	East/West line	County
F	13	18S	34E		1980	North	1980	West	Lea

⁸ Proposed Bottom Hole Location If Different From Surface

UL or lot no.	Section	Township	Range	Lot Idn	Feet from the	North/South line	Feet from the	East/West line	County

⁹ Proposed Pool 1 Vacuum, GB-SA Wildcat	⁹ Proposed Pool 2
---	------------------------------

¹¹ Work Type Code E	¹² Well Type Code O	¹³ Cable/Rotary R	¹⁴ Lease Type Code S	¹⁵ Ground Level Elevation 3980.4' GL
¹⁶ Multiple No	¹⁷ Proposed Depth 5200'	¹⁸ Formation Grayburg Jackson	¹⁹ Contractor Western Oil Prod.	²⁰ Spud Date 12/27/00

²¹ Proposed Casing and Cement Program





Hole Size	Casing Size	Casing weight/foot	Setting Depth	Sacks of Cement	Estimated TOC
17-1/2"	13-3/8"	48#	400'	420 C1 C	Circ1
12"	8-5/8"	24 & 28#	3,650'	1595 Lt/250 C	Circ1
7-7/8"	5-1/2"	15.5 & 17#	9,898'	1065 H/780 Poz	Est @ 7000'

²² Describe the proposed program. If this application is to DEEPEN or PLUG BACK, give the data on the present productive zone and proposed new productive zone.

Describe the blowout prevention program, if any. Use additional sheets if necessary.

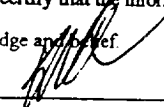
Reenter well. Drill out cement plug @ 4520-4745'. Clean out to 5200'. Test Grayburg Jackson. If commercial, put to pump.

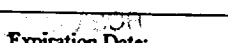
Permit Expires 1 Year From Approval
Date Unless Drilling Underway

²³ I hereby certify that the information given above is true and complete to the best of my knowledge and belief.		OIL CONSERVATION DIVISION	
Signature: 		Approved by:	
Printed name: Kenneth D. Reynolds		Title:	
Title: President		Approval Date:  Expiration Date: 	
Date: 12/19/00	Phone: (505) 623-5070	Conditions of Approval: 	
		Attached <input type="checkbox"/>	

C-101 Instructions

Measurements and dimensions are to be in feet and inches. Well locations will refer to the New Mexico Principal Meridian.

IF THIS IS AN AMENDED REPORT CHECK THE BOX LABELED "AMENDED REPORT" AT THE TOP OF THIS DOCUMENT.

- 1 Operator's name and address.
- 2 Operator's OGRID number. If you do not have one, it will be assigned and filled in by the District office.
- 3 API number of this well. If this is a new drill the OCD will assign the number and fill this in.
- 4 Property code. If this is a new property the OCD will assign the number and fill it in.
- 5 Property name that used to be called 'well name'.
- 6 The number of this well on the property.
- 7 The surveyed location of this well New Mexico Principal Meridian. NOTE: If the United States government survey designates a Lot Number for this location use that number in the 'UL or lot no.' box. Otherwise use the OCD Unit Letter.
- 8 The proposed bottom hole location of this well at TD.
- 9 and 10 The proposed pool(s) to which this well is being drilled.
- 11 Work type code from the following table:

N	New well
E	Re-entry
D	Drill deeper
P	Plugback
A	Add a zone
- 12 Well type code from the following table:

O	Single oil completion
G	Single gas completion
M	Miscellaneous
I	Injection well
S	SWD well
W	Water supply well
C	Carbon dioxide well
- 13 Cable or rotary drilling code

C	Propose to cable tool drill
R	Propose to rotary drill
- 14 Lease type code from the following table:

S	State
P	Private
- 15 Ground level elevation above sea level.
- 16 Intend to multiple complete? Yes or No. Attach intended well bore diagram.
- 17 Proposed total depth of this well.
- 18 Geologic formation at TD.
- 19 Name of the intended drilling company if known.
- 20 Anticipated spud date.
- 21 Proposed hole size ID inches, proposed casing OD inches, casing weight in pounds per foot, setting depth of the casing or depth and top of liner, proposed cementing volume, and estimated top of cement.
- 22 Brief description of the proposed drilling program and BOP program. Attach additional sheets if necessary.
- 23 The signature, printed name, and title of the person authorized to make this report. The date this report was signed and the telephone number to call for questions about this report.

MESA - YESO STATE #1
 1980' FNL + 1980' FWL
 SECTION 13 - TIRN. R34W
 LEA COUNTY, NEW MEXICO
 SPUD: 2-1-83
 PFA: 5-18-83

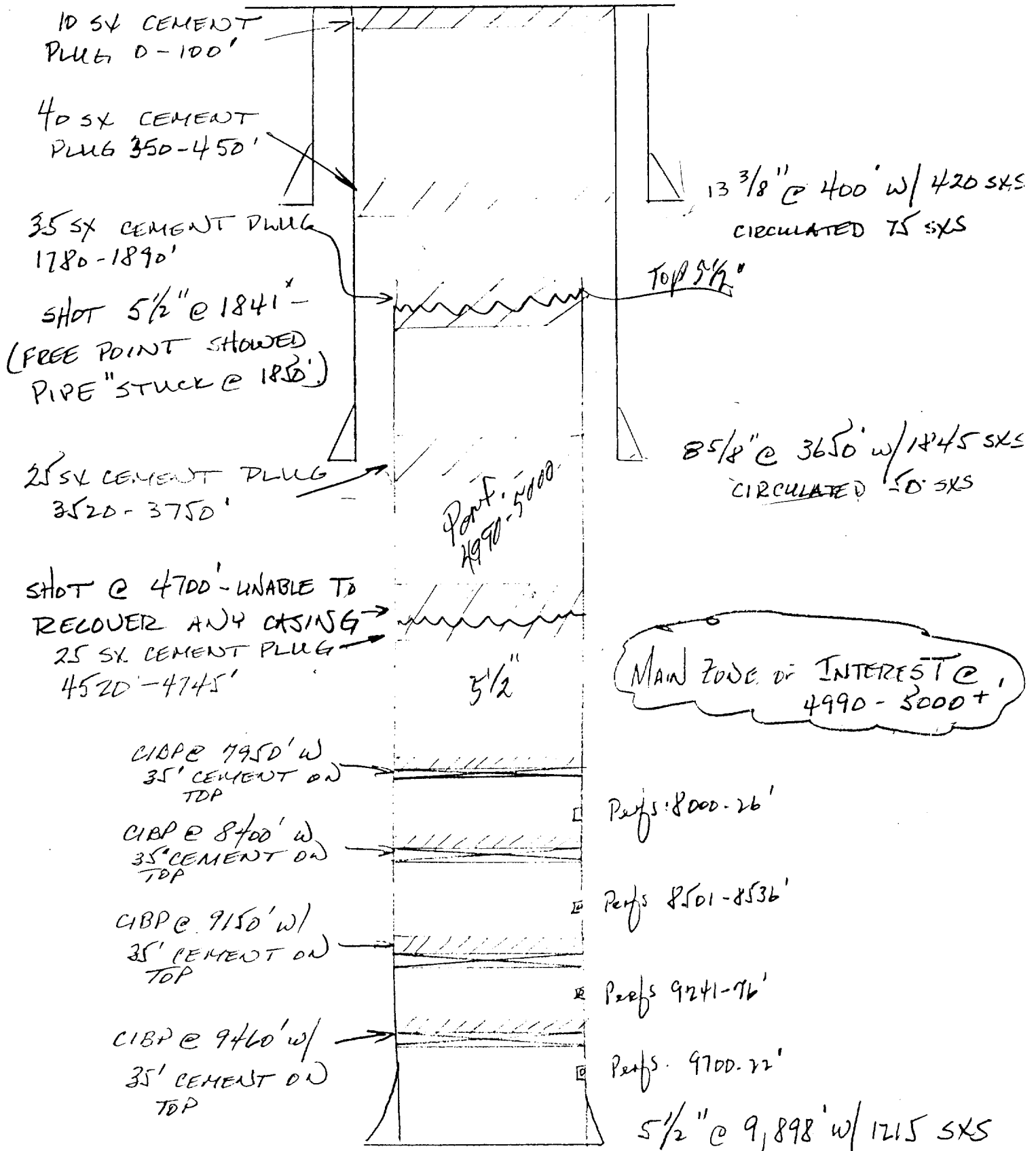

NEW MEXICO OIL CONSERVATION COMMISSION
WELL LOCATION AND ACREAGE DEDICATION PLAT

Form C-102
Supersedes C-128
Effective 1-1-65

OGRID-2496 | All distances must be from the outer boundaries of the Section. ^{APR} 30-025-35315-28125

Operator Western Oil Producers, Inc.		Lease Yeso State (27050)		Well No. 1
First Letter F	Section 13	Township 18 South	Range 34 East	County Lea County

Actual Footage Location of Well:

1980 feet from the North line and		1980 feet from the West line	
Ground Level Elev. 3980.4	Producing Formation Grayburg Jackson	Pool VACUUM: GB-SA Wildcat (62180)	Dedicated Acreage: SW 1/4 NW 1/4 40 Acres

1. Outline the acreage dedicated to the subject well by colored pencil or hachure marks on the plat below.
2. If more than one lease is dedicated to the well, outline each and identify the ownership thereof (both as to working interest and royalty).
3. If more than one lease of different ownership is dedicated to the well, have the interests of all owners been consolidated by communization, unitization, force-pooling, etc?

☒ Yes ☐ No If answer is "yes," type of consolidation _____

If answer is "no," list the owners and tract descriptions which have actually been consolidated. (Use reverse side of this form if necessary.) _____

No allowable will be assigned to the well until all interests have been consolidated (by communization, unitization, forced-pooling, or otherwise) or until a non-standard unit, eliminating such interests, has been approved by the Commission.

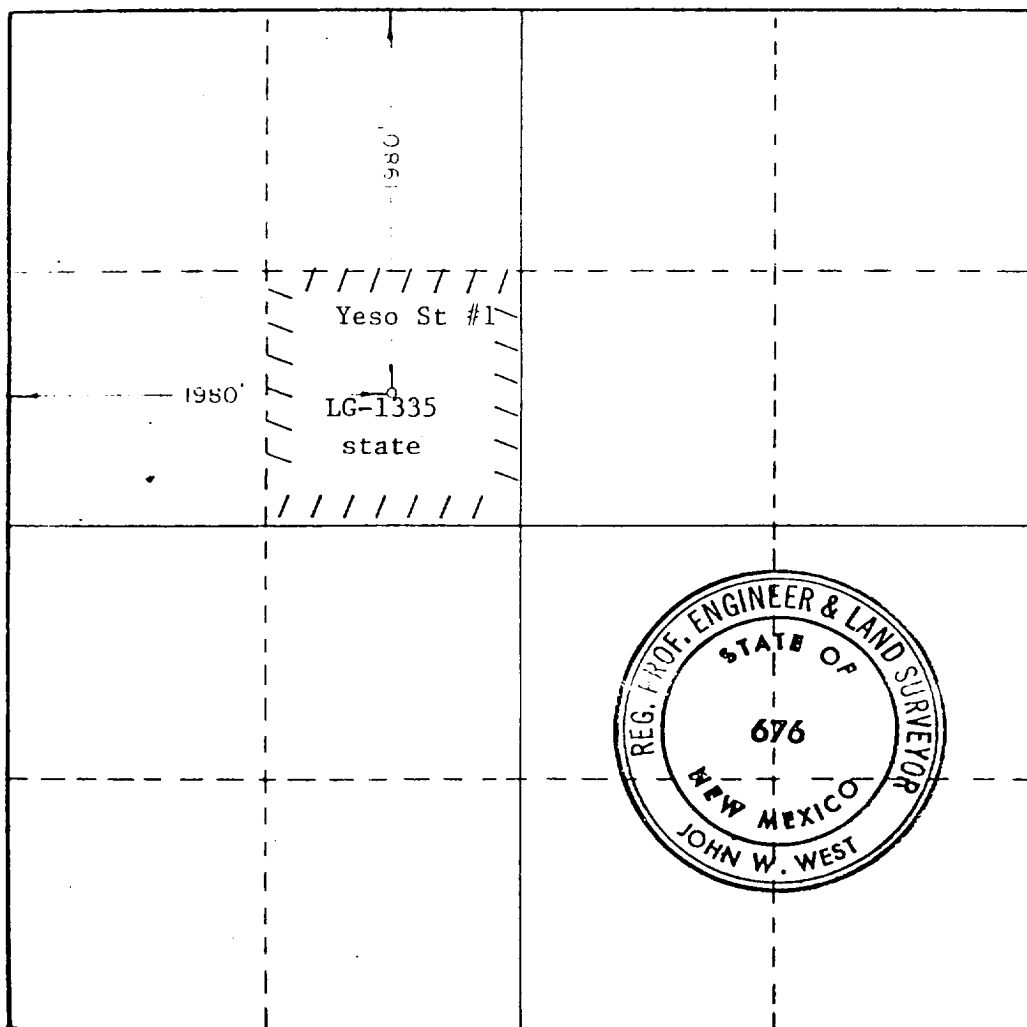

CERTIFICATION

I hereby certify that the information contained herein is true and complete to the best of my knowledge and belief.

Name
Kenneth D. Reynolds
Position
President
Company
Western Oil Producers, Inc.
Date
12/19/00

I hereby certify that the well location shown on this plat was plotted from field notes of actual surveys made by me or under my supervision, and that the same is true and correct to the best of my knowledge and belief.

Date Surveyed
January 6, 1983
Registered Professional Engineer and/or Land Surveyor
John W. West
Certificate No.
JOHN W. WEST NO. 676

NO. OF COPIES RECEIVED	
DISTRIBUTION	
SANTA FE	
FILE	
U.S.D.E.	
LAND OFFICE	
OPERATOR	

CIL CONSERVATION DIVISION
P. O. BOX 2088
SANTA FE, NEW MEXICO 87501

Form C-103
Revised 10-1-73

5a. Indicate Type of Lease	
State <input checked="" type="checkbox"/>	For <input type="checkbox"/>
5. State Oil & Gas Lease No.	
LG-1335	

SUNDRY NOTICES AND REPORTS ON WELLS

DO NOT USE THIS FORM FOR PROPOSALS TO DRILL OR TO DEEPEN OR PLUG BACK TO A DIFFERENT RESERVOIR.
USE "APPLICATION FOR PERMIT -" IF FROM C-101 FOR SUCH PROPOSALS.

1. OIL <input type="checkbox"/> GAS <input type="checkbox"/> OTHER <input type="checkbox"/> P&A		7. Unit Agreement Name
2. Name of Operator Mesa Petroleum Co.		8. Firm or Lease Name Yeso State
3. Address of Operator P.O. Box 2009 / Amarillo, Texas 79189		9. Well No. 1
4. Location of Well UNIT LETTER <u>F</u> <u>1980</u> FEET FROM THE <u>North</u> LINE AND <u>1980</u> FEET FROM <u>West</u> LINE, SECTION <u>13</u> TOWNSHIP <u>18S</u> RANGE <u>34E</u> N.M.P.M.		10. Field and Pool, or Wildcat Wildcat
15. Elevation (Show whether DF, RT, GR, etc.) 3980.4' GR		12. County Lea

Check Appropriate Box To Indicate Nature of Notice, Report or Other Data

NOTICE OF INTENTION TO:		SUBSEQUENT REPORT OF:	
PERFORM REMEDIAL WORK <input type="checkbox"/>	PLUG AND ABANDON <input type="checkbox"/>	REMEDIAL WORK <input type="checkbox"/>	ALTERING CASING <input type="checkbox"/>
TEMPORARILY ABANDON <input type="checkbox"/>	CHANGE PLANS <input type="checkbox"/>	COMMENCE DRILLING OPERATIONS <input type="checkbox"/>	PLUG AND ABANDONMENT <input checked="" type="checkbox"/>
PULL OR ALTER CASING <input type="checkbox"/>	OTHER <input type="checkbox"/>	CASING TEST AND CEMENT JOBS <input type="checkbox"/>	OTHER <input type="checkbox"/>

17. Describe Proposed or Completed Operations (Clearly state all pertinent details, and give pertinent dates, including estimated date of starting any proposed work) SEE RULE 1103.

Commenced P&A operations on 5-13-83 as follows:

Set CIBP at 7900' plus 35' cement.
Shot 5 1/2" casing at 4700' - unable to recover casing - ran free point - casing stuck at 1850'. Shot 5 1/2" casing at 1841' and recovered 45 jts. Displaced hole with 9.5 + ppg mud and set 25 sx "C" + 2% CaCl from 4745' to 4520'; 25 sx "C" + 2% CaCl from 3750' to 3520'; 35 sx "C" + 2% CaCl from 1890' to 1780'; 40 sx "C" + 2% CaCl from 450' to 350' and 10 sx "C" + 2% CaCl from 100' to surface. Installed Dry Hole Marker. Well P&A 5-18-83.

XC: NMOCD-H (O+2), CEN RCDS, ACCTG, MAT CONT, OPS(FILE), MIDLAND, HOBBS, PARTNERS

18. I hereby certify that the information above is true and complete to the best of my knowledge and belief.

SIGNED <u>R. E. Martin</u>	TITLE <u>REGULATORY COORDINATOR</u>	DATE <u>MAY 20, 1983</u>
APPROVED BY <u>Ronald M. Caruthers</u>	TITLE <u>OIL & GAS INSPECTOR</u>	DATE <u>MAY 21 1983</u>
CONDITIONS OF APPROVAL, IF ANY:		

RECEIVED
MAY 23 1983
C.C.D.
HOBBS OFFICE