

STATE OF NEW MEXICO
ENERGY AND MINERALS DEPARTMENT

OIL CONSERVATION DIVISION
P. O. BOX 2088
SANTA FE, NEW MEXICO 87501

30-025-28380
Form C-101
Revised 10-1-78

NO. OF COPIES RECEIVED	
DISTRIBUTION	
SANTA FE	
FILE	
U.S.G.S.	
LAND OFFICE	
OPERATOR	

API No. 30-025-

5A. Indicate Type of Lease
STATE <input checked="" type="checkbox"/> REC <input type="checkbox"/>
5. State Oil & Gas Lease No.
LG-365

APPLICATION FOR PERMIT TO DRILL, DEEPEN, OR PLUG BACK

1a. Type of Work		7. Unit Agreement Name	
b. Type of Well DRILL <input checked="" type="checkbox"/> DEEPEN <input type="checkbox"/> PLUG BACK <input type="checkbox"/> OIL WELL <input checked="" type="checkbox"/> GAS WELL <input type="checkbox"/> OTHER <input type="checkbox"/> SINGLE ZONE <input checked="" type="checkbox"/> MULTIPLE ZONE <input type="checkbox"/>		8. Farm or Lease Name	
2. Name of Operator		9. Well No.	
Phillips Petroleum Company		2	
3. Address of Operator		10. Field and Pool, or Wildcat	
Room 401, 4001 Penbrook Street, Odessa, Texas 79762		Maljamar Gb/SA	
4. Location of Well UNIT LETTER <u>G</u> LOCATED <u>1980</u> FEET FROM THE <u>north</u> LINE AND <u>1900</u> FEET FROM THE <u>east</u> LINE OF SEC. <u>22</u> TWP. <u>17-S</u> REC. <u>33-E</u> NMPM		12. County	
		Lea	
19. Proposed Depth		19A. Formation	
4800'		Grayburg/San Andres Rotary	
21A. Kind & Status Plug. Bond		22. Approx. Date Work will start	
Blanket		Upon approval	
21B. Drilling Contractor			
Advise later			

22. PROPOSED CASING AND CEMENT PROGRAM					
SIZE OF HOLE	SIZE OF CASING	WEIGHT PER FOOT	SETTING DEPTH	SACKS OF CEMENT	EST. TOP
12-1/4"	8-5/8"	24#, K-55	350'	400 sx Class "C" w/2% CaCl	Surface
7-7/8"	4-1/2"	11.6#, N-80	4800'	Tie back to	Surface
surface casing w/sufficient volume plus 30% excess TLW w/10% Diacel D, 12#/sx salt, 1/4#/sx cellophane flakes, and 3#/sx Gilsonite followed by 250 sx Class "H".					

Use mud additives as required for control.

BOP Equipment: Series 900, 3000# WP, per PPCo Standards, Figure 7 Schematic attached.

IN ABOVE SPACE DESCRIBE PROPOSED PROGRAM: IF PROPOSAL IS TO DEEPEN OR PLUG BACK, GIVE DATA ON PRESENT PRODUCTIVE ZONE AND PROPOSED NEW PRODUCTIVE ZONE. GIVE BLOWOUT PREVENTER PROGRAM, IF ANY.

I hereby certify that the information above is true and complete to the best of my knowledge and belief.

Signed J. J. Roper W. J. Mueller Title Sr. Engineering Specialist Date September 6, 1983

(This space for State Use)
ORIGINAL SIGNED BY JERRY SEXTON
DISTRICT I SUPERVISOR

APPROVED BY _____ TITLE _____ DATE _____

CONDITIONS OF APPROVAL, IF ANY:

SEP 8 1983

APPROVAL VALID FOR 180 DAYS
PERMIT EXPIRES 3/19/84

FIELD PRACTICES AND STANDARDS

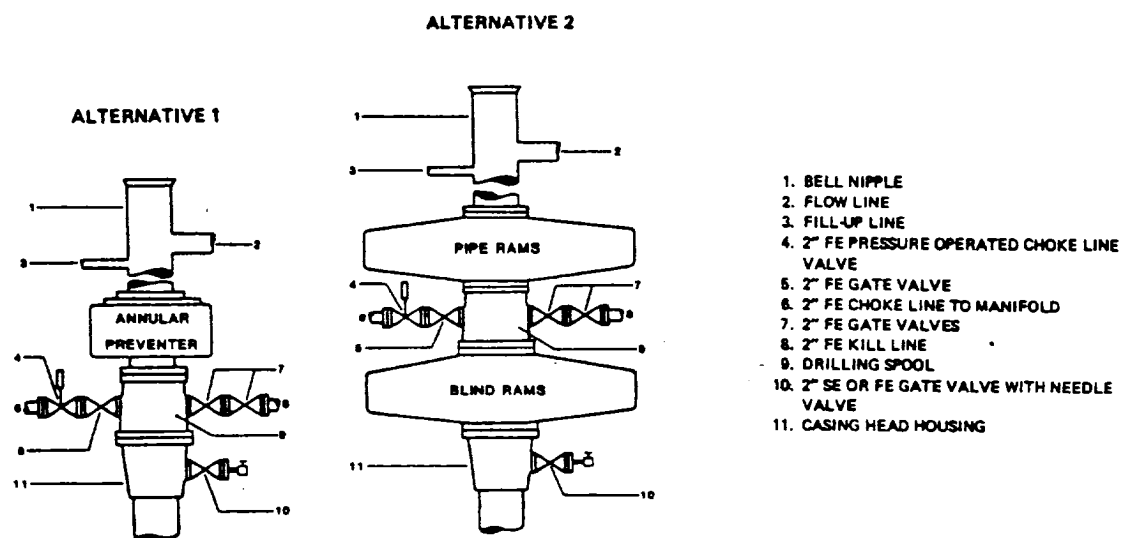

NOTE: THE DRILLING SPOOL MAY BE LOCATED BELOW BOTH SETS OF RAMS IF A DOUBLE PREVENTER IS USED AND IT DOES NOT HAVE SUITABLE OUTLETS BETWEEN RAMS

Figure 7-9. Standard Hydraulic Blowout Preventer Assembly
(2 M or 3 M Working Pressure) Alternative 1

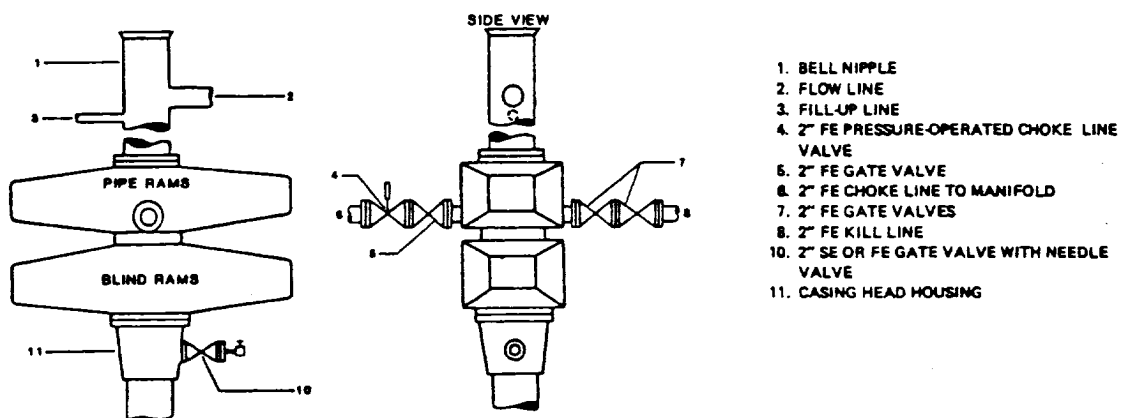

Figure 7-10. Standard Hydraulic Blowout Preventer Assembly
(2 M or 3 M Working Pressure) Alternative 3 (without Drilling Spool)

**NEW MEXICO OIL CONSERVATION COMMISSION
WELL LOCATION AND ACREAGE DEDICATION PLAT**

Form C-102
Supersedes C-128
Effective 1-1-65

All distances must be from the outer boundaries of the Section.

Operator PHILLIPS PETROLEUM CO.			Lease NEW MEX "B"		Well No. 2
Unit Letter G	Section 22	Township 17 SOUTH	Range 33 EAST	County LEA	
Actual Footage Location of Well:					
1980	feet from the	NORTH	line and	1900	feet from the EAST line
Ground Level Elev. 4153.0	Producing Formation Grayburg/San Andres		Pool Maljamar Grayburg/San Andres	Dedicated Acreage: 40 Acres	

1. Outline the acreage dedicated to the subject well by colored pencil or hachure marks on the plat below.
2. If more than one lease is dedicated to the well, outline each and identify the ownership thereof (both as to working interest and royalty).
3. If more than one lease of different ownership is dedicated to the well, have the interests of all owners been consolidated by communitization, unitization, force-pooling, etc?

☐ Yes ☒ No If answer is "yes," type of consolidation _____

If answer is "no," list the owners and tract descriptions which have actually been consolidated. (Use reverse side of this form if necessary.) _____

No allowable will be assigned to the well until all interests have been consolidated (by communitization, unitization, forced-pooling, or otherwise) or until a non-standard unit, eliminating such interests, has been approved by the Commission.

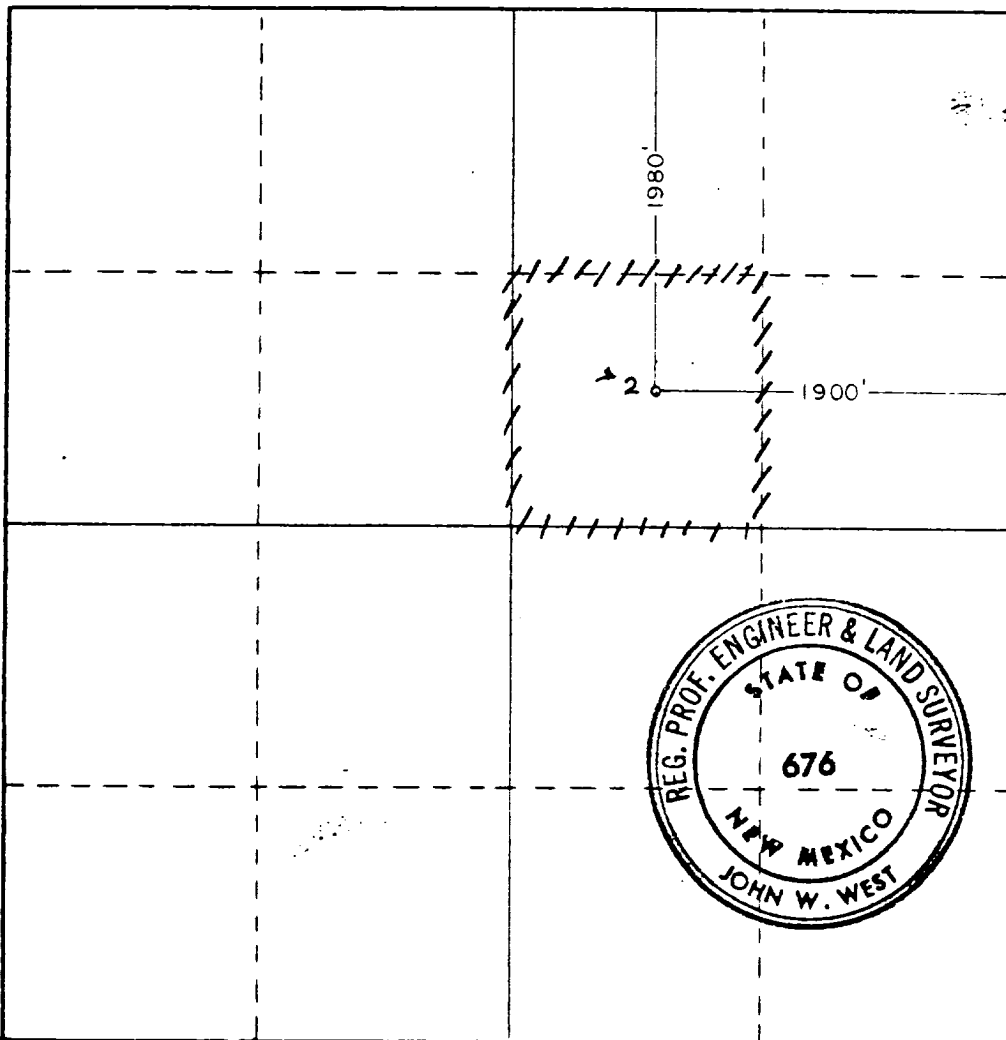

CERTIFICATION

I hereby certify that the information contained herein is true and complete to the best of my knowledge and belief.

Ralph J. Roper
Name **W. J. Mueller**
Senior Engineering Specialist

Position
Phillips Petroleum Company

Company
September 6, 1983

Date

I hereby certify that the well location shown on this plat was plotted from field notes of actual surveys made by me or under my supervision, and that the same is true and correct to the best of my knowledge and belief.

Date Surveyed
AUGUST 29, 1983

Registered Professional Engineer
and/or Land Surveyor

John W. West

RECEIVED
SEP 7 1983
FED.
TREASURY OFFICE