

30-025-28635

Form C-101
Revised 10-1-78

NO. OF COPIES RECEIVED	
DISTRIBUTION	
SANTA FE	
FILE	
U.S.G.S.	
LAND OFFICE	
OPERATOR	

5A. Indicate Type of Lease	
STATE <input checked="" type="checkbox"/>	FEE <input type="checkbox"/>
5. State Oil & Gas Lease No.	
E-5014	

APPLICATION FOR PERMIT TO DRILL, DEEPEN, OR PLUG BACK

1a. Type of Work				7. Unit Agreement Name	
b. Type of Well DRILL <input checked="" type="checkbox"/> DEEPEN <input type="checkbox"/> PLUG BACK <input type="checkbox"/>				8. Farm or Lease Name	
OIL WELL <input checked="" type="checkbox"/> GAS WELL <input type="checkbox"/> OTHER <input type="checkbox"/> SINGLE ZONE <input checked="" type="checkbox"/> MULTIPLE ZONE <input type="checkbox"/>				State NM	
2. Name of Operator				9. Well No.	
AMOCO PRODUCTION COMPANY				1	
3. Address of Operator				10. Field and Pool, or Wildcat	
P. O. Box 68, Hobbs, NM 88240				Airstrip Wolfcamp	
4. Location of Well				12. County	
UNIT LETTER B LOCATED 672 FEET FROM THE North LINE				Lea	
AND 1980 FEET FROM THE East LINE OF SEC. 35 TWP. 18-S RGE. 34-E NMPM					
19. Proposed Depth				19A. Formation	
11,100'				Wolfcamp	
20. Rotary or C.T.				Rotary	
21. Elevations (Show whether DT, KI, etc.)		21A. Kind & Status Plug. Bond		21B. Drilling Contractor	
3977.5		Blanket-on-bond		N/A	
22. Approx. Date Work will start				Mid April	

PROPOSED CASING AND CEMENT PROGRAM

SIZE OF HOLE	SIZE OF CASING	WEIGHT PER FOOT	SETTING DEPTH	SACKS OF CEMENT	EST. TOP
17-1/2"	13-3/8"	48#	300'	Circulate	surface
11" or 12-1/4"	8-5/8"	24#, 32#	4000'	tieback to 13-3/8"	300'
7-7/8"	5-1/2"	17, 15.5, 17#	11,100'	Tieback to 500'	
				Bone Springs	7350'

Propose to drill and equip well in the Bone Springs or Wolfcamp formation. After reaching TD, logs will be run and evaluated. Perforate and/or stimulate as necessary in attempting commercial production.

APPROVAL VALID FOR 180 DAYS
PERMIT EXPIRES 9/5/84
UNLESS DRILLING UNDERWAY

Mud Program: 0 - 300' Native
300 - 4000' Brine
4000 - TD Cut Brine

BOP Diagram attached.

O+6-NMOCD, H 1-R. E. Ogden, HOU Rm. 21.150 1-F. J. Nash, HOU Rm. 4.206 1-GCC 1-Pacific Lighting

IN ABOVE SPACE DESCRIBE PROPOSED PROGRAM; IF PROPOSAL IS TO DEEPEN OR PLUG BACK, GIVE DATA ON PRESENT PRODUCTIVE ZONE AND PROPOSED NEW PRODUCTIVE ZONE. GIVE BLOWOUT PREVENTER PROGRAM, IF ANY.

I hereby certify that the information above is true and complete to the best of my knowledge and belief.

Signed Mary C. Clark Title Assist. Admin. Analyst Date 3-1-84

(This space for State Use)
ORIGINAL SIGNED BY JERRY SEXTON
DISTRICT SUPERVISOR

APPROVED BY _____ TITLE _____ DATE MAR 5 1984

CONDITIONS OF APPROVAL, IF ANY:

RECEIVED
MAR 2 1984
O.C.D.
HOMES OFFICE

**NEW MEXICO OIL CONSERVATION COMMISSION
WELL LOCATION AND ACREAGE DEDICATION PLAT**

Form O-10,
Supersedes O-12R
Effective 1-1-65

Lease: AMOCO PRODUCTION CO.				State: NM		Acreage: 1
Section: 35	Township: 18S		Range: 34E	County: LEA		
Well Location (Well): 672						
feet from the NORTH		line and 1980		feet from the EAST		
Ground Level Elev.: 3977.5	Producing Formation: Wolfcamp		Pool: Airstrip Wolfcamp		Dedicated Acreage: 40	

1. Outline the acreage dedicated to the subject well by colored pencil or hachure marks on the plat below.
2. If more than one lease is dedicated to the well, outline each and identify the ownership thereof (both as to working interest and royalty).
3. If more than one lease of different ownership is dedicated to the well, have the interests of all owners been consolidated by communitization, unitization, force-pooling, etc?

☐ Yes ☐ No If answer is "yes," type of consolidation _____

If answer is "no," list the owners and tract descriptions which have actually been consolidated (Use reverse side of this form if necessary.) _____

No allowable will be assigned to the well until all interests have been consolidated (by communitization, unitization, forced-pooling, or otherwise) or until a non-standard unit, eliminating such interests, has been approved by the Commission.

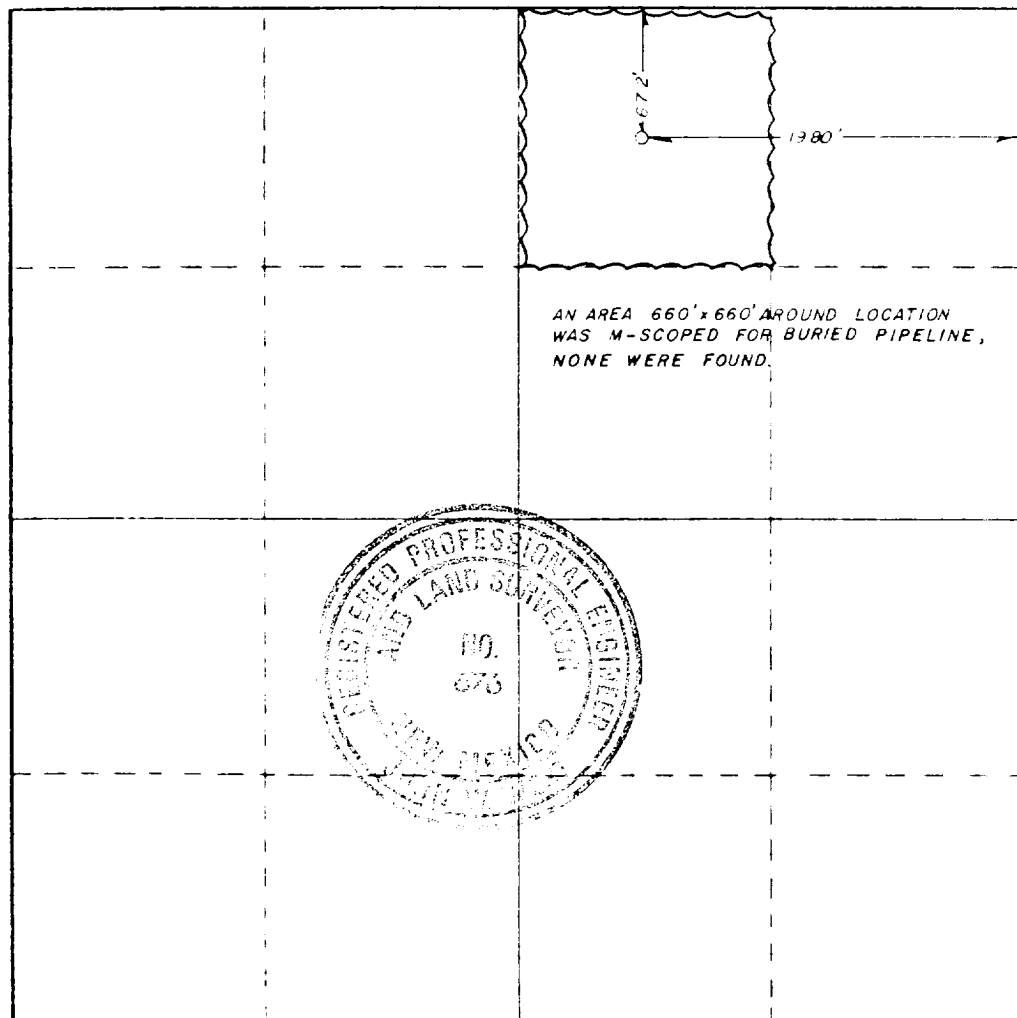

CERTIFICATION

I hereby certify that the information contained herein is true and complete to the best of my knowledge and belief.

Mary C. Clark
Assist. Admin. Analyst

AMOCO PRODUCTION COMPANY

3-1-84

I hereby certify that the well location shown on this plat was plotted from field notes of actual surveys made by me or under my supervision, and that the same is true and correct to the best of my knowledge and belief.

Date Surveyed:
2/25/84

Registered Professional Engineer
and Land Surveyor

John W. West
Certificate No. **JOHN W. WEST, 676**
RONALD J. EIDSON, 3239

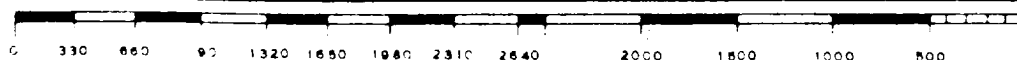

RECEIVED
MAR 2 1984
O.C.C.
HOBBS OFFICE

1. BOP's to be fluid operated. BOP's and all fittings must be in good condition and rated at 3000 psi w.p. minimum.
2. Equipment through which bit must pass shall be at least as large as casing size being drilled through.
3. Upper kelly cock is required and shall be 3000 psi w.p. minimum. Lower kelly cock is (required)(not required).
4. Hydril or comparable safety valve shall be available on rig floor with connection or subs to fit any tool joint in the string. Valve to be full bore 5000 psi w.p. minimum.
5. Hydril or equivalent drill pipe back pressure valve is (required)(not required).
6. All equipment upstream of chokes, including kill line equipment shall be flanged or clamped and of a test pressure no less than that of the blowout preventer. All valves upstream of choke shall be (3") (4") gate valves Cameron Type "F" or equivalent. All equipment downstream of chokes may be flanged or screw end gate or plug. Line from spool to manifold cross to be a minimum of 3", straight and short as possible with minimum bends. Other lines may be 2", 3" or 4". Choke manifold, beyond second valve from cross, must be positioned outside of substructure. Manifold, header and all lines must be adequately supported and properly anchored. Two inch (2") lines and valves are permitted on the kill line. All valves designated for H₂S service are (required) (not required).
7. Blowout preventer closing unit equipment to include accumulator capable of closing, opening and closing the bag and pipe rams with a minimum remaining pressure of 1200 psi. After closure, the remaining fluid volume will be at least 50 percent of original volume. Two independent sources of pump power are required on each closing unit installation and shall meet all IADC specifications. Operating time for closing unit shall not be greater than one minute with charging pump shut down. Time test must be witnessed by Amoco representative while nipping up and test results reported on IADC report. Failure to meet these conditions will necessitate corrective action by contractor and retesting all at contractor's expense.
8. The accumulator must be located at least 50 feet from the well. Blowout preventer controls must be properly labeled and located as close to drillers position as feasible. Floor control valves are (required)(not required).
9. Fluid lines from accumulator to BOP's and all remote control fluid lines shall be steel, and rated at or above maximum accumulator pressure. Lines shall be routed in bundles and adequately protected from damage.
10. Use rams in following positions:

	<u>Drilling</u>	<u>Running Casing</u>
Upper ram	Drill pipe	Casing
Lower Ram	Blind	Blind

*Amoco District Superintendent may reverse location of rams.
11. Extensions and hand wheels to be installed and braced at all times.

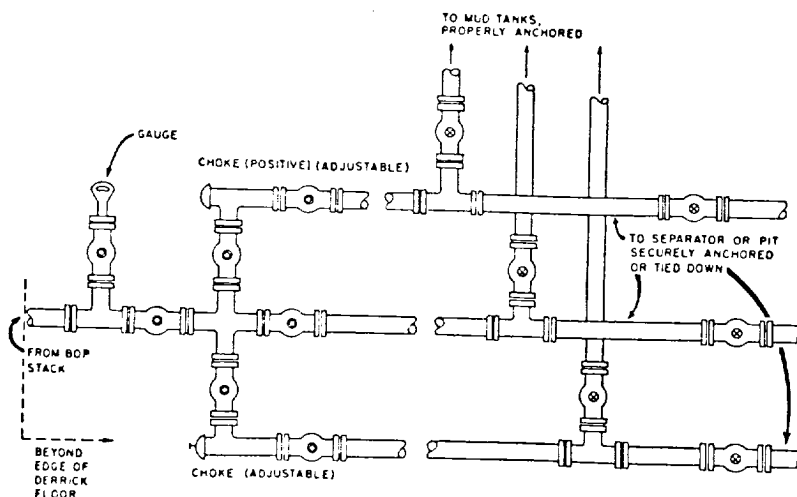
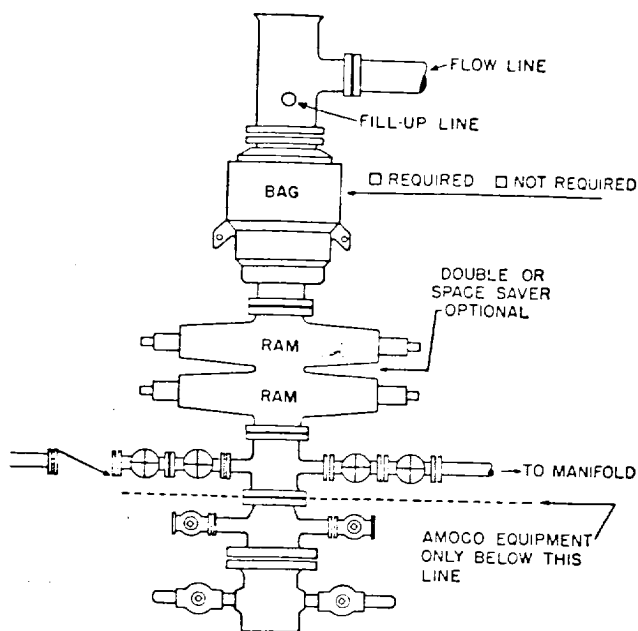

RECEIVED
MAR 2 1984
G.C.P.
HOBBS COUNCIL

114