

STATE OF NEW MEXICO
ENERGY AND MINERALS DEPARTMENT

OIL CONSERVATION DIVISION

P. O. BOX 2088

SANTA FE, NEW MEXICO 87501

30-025-28737

Form C-101
Revised 10-1-78

NO. OF COPIES RECEIVED	
DISTRIBUTION	
SANTA FE	
FILE	
U.S.G.S.	
LAND OFFICE	
OPERATOR	

5A. Indicate Type of Lease
STATE ☒ FEE ☐

5. State Oil & Gas Lease No.
B-1520-1

APPLICATION FOR PERMIT TO DRILL, DEEPEN, OR PLUG BACK

1a. Type of Work b. Type of Well OIL WELL <input checked="" type="checkbox"/> GAS WELL <input type="checkbox"/> OTHER <input type="checkbox"/> SINGLE ZONE <input checked="" type="checkbox"/> MULTIPLE ZONE <input type="checkbox"/>		7. Unit Agreement Name North Vacuum Abo Unit	
2. Name of Operator MOBIL PRODUCING TX. & N.M. INC.		8. Farm or Lease Name	
3. Address of Operator Nine Greenway Plaza, Suite 2700, Houston, TX 77046		9. Well No. 255	
4. Location of Well UNIT LETTER <u>K</u> LOCATED <u>1980</u> FEET FROM THE <u>South</u> LINE AND <u>2099</u> FEET FROM THE <u>West</u> LINE OF SEC. <u>13</u> TWP. <u>17S</u> RGE. <u>34E</u> NMPM		10. Field and Pool, or Wildcat North Vacuum Abo	
		12. County Lea	
		19. Proposed Depth 9100'	
		19A. Formation Abo	
		20. Rotary or C.T. Rotary	
21. Elevations (Show whether DF, RT, etc.) 4011'		21A. Kind & Status Plug. Bond On File	
		21B. Drilling Contractor Unknown	
		22. Approx. Date Work will start As Soon As Possible	

23.

PROPOSED CASING AND CEMENT PROGRAM

SIZE OF HOLE	SIZE OF CASING	WEIGHT PER FOOT	SETTING DEPTH	SACKS OF CEMENT	EST. TOP
17 1/2"	13-3/8"	48.0# H-40	0-400'	Circulate	Surface
12 1/4"	8-5/8"	28.0# S-80	0-5000'	Circulate	Surface
7-7/8"	5 1/2" Liner	15.5# K-55 17.0# N-80	4800-7300' 7300- TD	Circulate	4800'

BLOWOUT PREVENTOR PROGRAM

Casing String	Equipment Size & API Series	No. & Type	Test Pressure PSI
Surface	13-5/8" x 3000#	1 MG & 1 PR 1 MG 2PR & Rotary Head	3000 5000

APPROVAL VALID FOR 180 DAYS
PERMIT EXPIRES 11/21/84
UNLESS DRILLING UNDERWAY

IN ABOVE SPACE DESCRIBE PROPOSED PROGRAM: IF PROPOSAL IS TO DEEPEN OR PLUG BACK, GIVE DATA ON PRESENT PRODUCTIVE ZONE AND PROPOSED NEW PRODUCTIVE ZONE. GIVE BLOWOUT PREVENTOR PROGRAM, IF ANY.

I hereby certify that the information above is true and complete to the best of my knowledge and belief.

Signed A. D. Bond A. D. Bond Title Regulatory Technician Supervisor Date May 14, 1984

(This space for State Use)

ORIGINAL SIGNED BY JERRY SEXTON

MAY 21 1984

APPROVED BY DISTRICT 1 SUPERVISOR TITLE DATE

CONDITIONS OF APPROVAL, IF ANY:

All distances must be from the outer boundaries of the Section.

Operator MOBIL PRODUCING TX. & N.M. INC.			Lease North Vacuum Abo Unit			Well No. 255		
Unit Letter K	Section 13	Township 17S	Range 34E	County Lea				
Actual Footage Location of Well: 1980 feet from the South line and 2099 feet from the West line								
Ground Level Elev. 4011'	Producing Formation Abo		Pool Vacuum, North Abo			Dedicated Acreage: (2 wells) 80 Acres		

1. Outline the acreage dedicated to the subject well by colored pencil or hatchure marks on the plat below.
2. If more than one lease is dedicated to the well, outline each and identify the ownership thereof (both as to working interest and royalty).
3. If more than one lease of different ownership is dedicated to the well, have the interests of all owners been consolidated by communitization, unitization, force-pooling, etc?

☒ Yes ☐ No If answer is "yes," type of consolidation Unitized

If answer is "no," list the owners and tract descriptions which have actually been consolidated. (Use reverse side of this form if necessary.)

No allowable will be assigned to the well until all interests have been consolidated (by communitization, unitization, forced-pooling, or otherwise) or until a non-standard unit, eliminating such interests, has been approved by the Division.

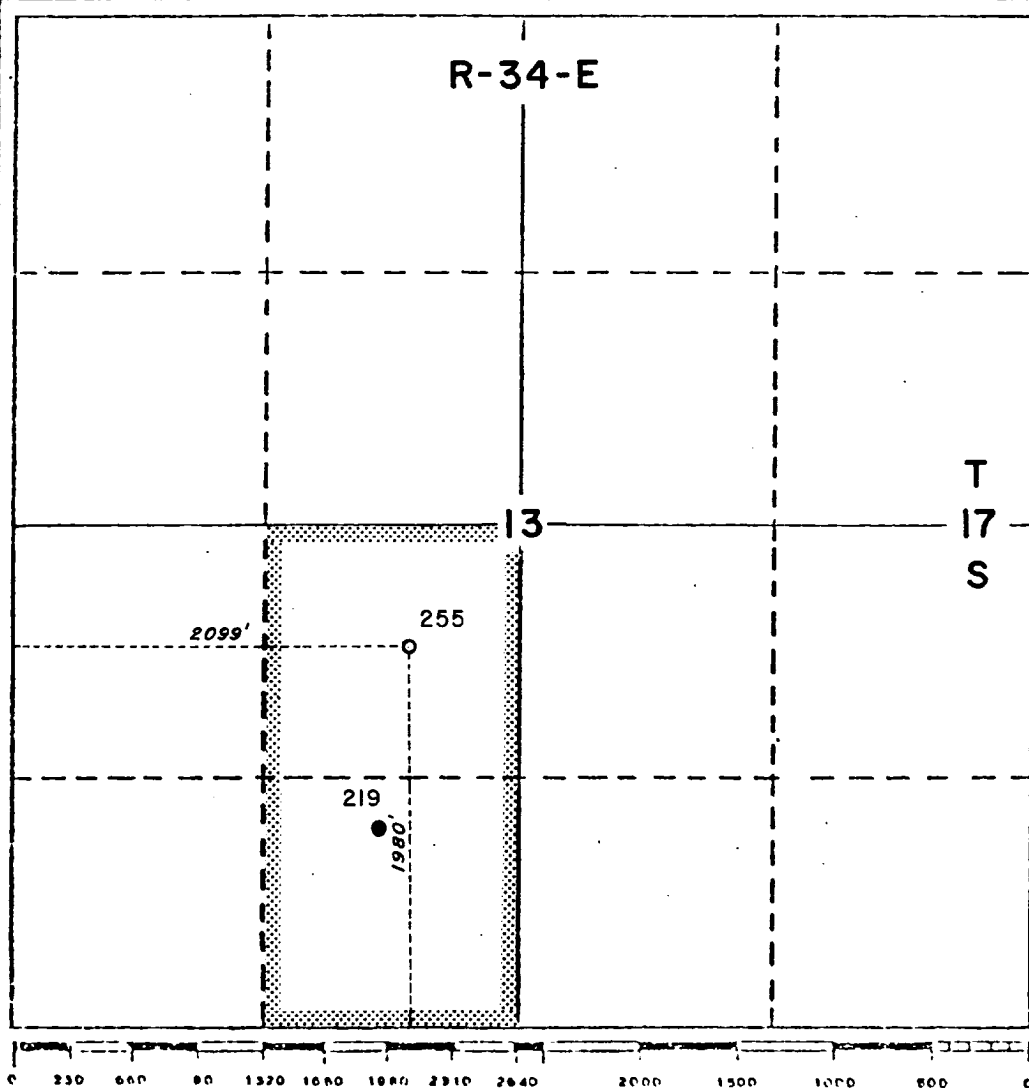

CERTIFICATION

I hereby certify that the information contained herein is true and complete to the best of my knowledge and belief.

Name A. D. Bond

Position Regulatory Technician Supervisor

Company MOBIL PRODUCING TX. & N.M. INC.

Date May 14, 1984

I hereby certify that the well location shown on this plat was plotted from field notes of actual surveys made by me or under my supervision and that the same is true and correct to the best of my knowledge and belief.

Date Surveyed 4-18-84
Registered Professional Engineer and/or Land Surveyor

H. A. Carson, Jr.
Certificate No.

5063

RECEIVED
MAY 18 1984
O.C.D.
HIGERS OFFICE

