

STATE OF NEW MEXICO  
ENERGY AND MINERALS DEPARTMENT

OIL CONSERVATION DIVISION

P. O. BOX 2088  
SANTA FE, NEW MEXICO 87501

Form C-101  
Revised 10-1-78

NO. OF COPIES RECEIVED	
DISTRIBUTION	
SANTA FE	
FILE	
U.S.G.S.	
LAND OFFICE	
OPERATOR	

5A. Indicate Type of Lease  
STATE ☒ FEE ☐  
5. State Oil & Gas Lease No.  
B-1520-1

APPLICATION FOR PERMIT TO DRILL, DEEPEN, OR PLUG BACK

1a. Type of Work b. Type of Well OIL WELL <input type="checkbox"/> GAS WELL <input type="checkbox"/> OTHER <input type="checkbox"/> 2. Name of Operator MOBIL PRODUCING TX. & N.M. INC. 3. Address of Operator Nine Greenway Plaza, Suite 2700 Houston, TX 77046 4. Location of Well UNIT LETTER C LOCATED 660 FEET FROM THE North LINE AND 2080 FEET FROM THE West LINE OF SEC. 13 TWP. 17S RGE. 34E NMPM 19. Proposed Depth 9100' 19A. Formation Abo 20. Rotary or C.T. Rotary 21. Elevations (show whether Dr, KI, etc.) 4027 GL 21A. Kind & Status Plug. Bond on file 21B. Drilling Contractor Unknown 22. Approx. Date Work will start As soon as possible		7. Unit Agreement Name North Vacuum Abo Unit 8. Farm or Lease Name  9. Well No. 260 10. Field and Pool, or Wildcat North Vacuum Abo 11. County Lea	
--	--	---	--

PROPOSED CASING AND CEMENT PROGRAM

SIZE OF HOLE	SIZE OF CASING	WEIGHT PER FOOT	SETTING DEPTH	SACKS OF CEMENT	EST. TOP
17-1/2"	13-3/8"	48.0# H-40	0-400'	circulate	surface
12-1/4"	8-5/8"	28.0# S-80	0-5000'	circulate	surface
7-7/8"	5-1/2"- Liner	15.5# K-55 17.0# N-80	4800-7300'} 7300-TD }	circulate	4800'

Blowout Preventor Program

Casing String	Equipment Size & API Series	No. & Type	PSI
Surface	13-5/8" x 3000#	1 MG & 1 PR	3000
		1 MG 2 PR & Rotary Head	5000

IN ABOVE SPACE DESCRIBE PROPOSED PROGRAM: IF PROPOSAL IS TO DEEPEN OR PLUG BACK, GIVE DATA ON PRESENT PRODUCTIVE ZONE AND PROPOSED NEW PRODUCTIVE ZONE. GIVE BLOWOUT PREVENTER PROGRAM, IF ANY.

I hereby certify that the information above is true and complete to the best of my knowledge and belief.  
Regulatory Technician

Signed [Signature] A. D. Bond Title Supervisor Date July 24, 1984

(This space for State Use)

ORIGINAL SIGNATURE  
DISTRICT

APPROVED BY \_\_\_\_\_ TITLE \_\_\_\_\_ DATE JUL 27 1984

CONDITIONS OF APPROVAL, IF ANY:

APPROVAL VALID FOR 120 DAYS  
PERMIT EXPIRES 10-30-84  
REPEASE DRILLING IMMEDIATELY

All distances must be from the outer boundaries of the Section.

Operator <b>MOBIL PRODUCING TX. &amp; N.M. INC.</b>			Lease <b>North Vacuum Abo Unit</b>		Well No. <b>260</b>
Unit Letter <b>C</b>	Section <b>13</b>	Township <b>17S</b>	Range <b>34E</b>	County <b>Lea</b>	
Actual Portage Location of well: <b>660</b> feet from the <b>North</b> line and <b>2080</b> feet from the <b>West</b> line					
Ground Level Elev. <b>4027</b>	Producing Formation <b>Abo</b>		Foot <b>Vacuum, North Abo</b>		Dedicated Acreage: <b>(2 wells) 80 Acres</b>

1. Outline the acreage dedicated to the subject well by colored pencil or hatchure marks on the plat below.
2. If more than one lease is dedicated to the well, outline each and identify the ownership thereof (both as to working interest and royalty).
3. If more than one lease of different ownership is dedicated to the well, have the interests of all owners been consolidated by communitization, unitization, force-pooling, etc?

☒ Yes ☐ No If answer is "yes," type of consolidation Unitized

If answer is "no," list the owners and tract descriptions which have actually been consolidated. (Use reverse side of this form if necessary.)

No allowable will be assigned to the well until all interests have been consolidated (by communitization, unitization, forced-pooling, or otherwise) or until a non-standard unit, eliminating such interests, has been approved by the Division.

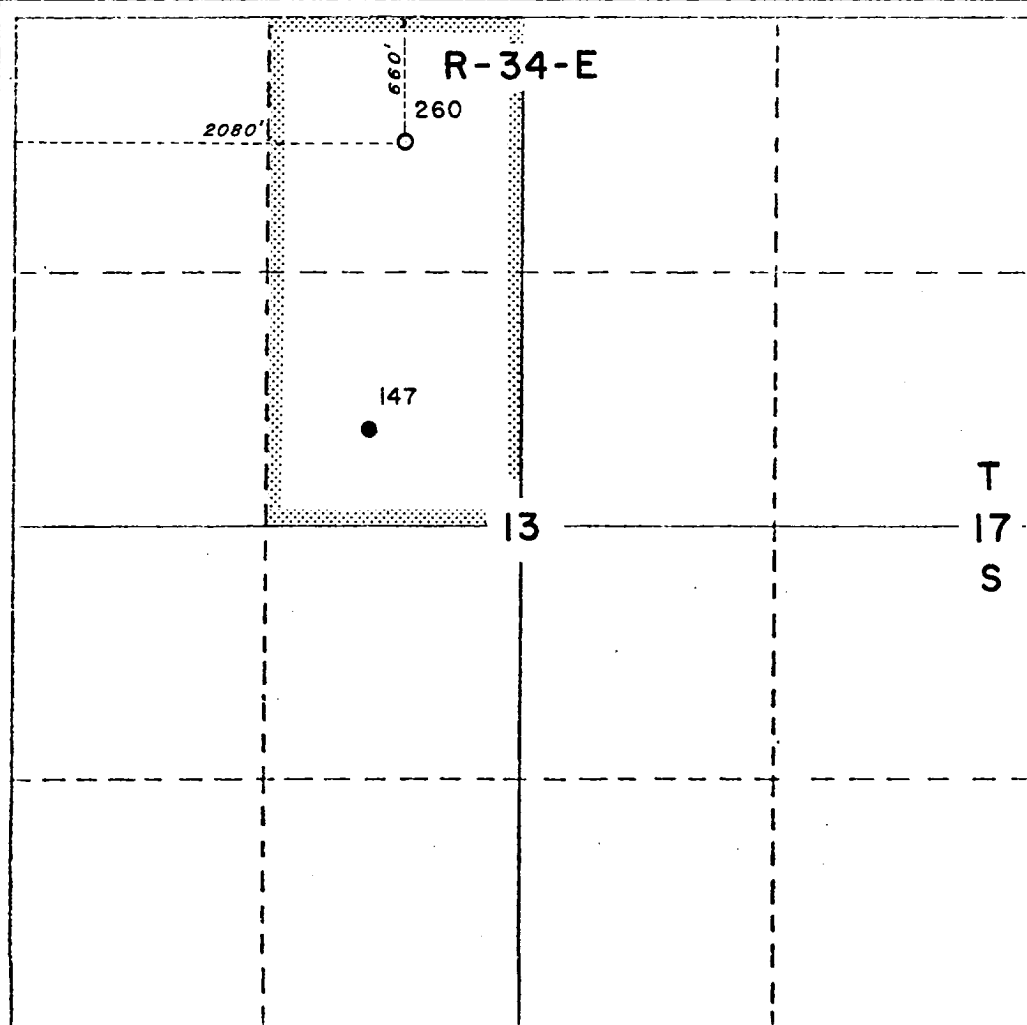

CERTIFICATION

I hereby certify that the information contained herein is true and complete to the best of my knowledge and belief.

A. D. Bond  
Name  
A. D. Bond  
Position Regulatory Technician Supervisor  
Company MOBIL PRODUCING TX. & N.M. INC.  
Date July 24, 1984

I hereby certify that the well location shown on this plat was plotted from field notes of actual surveys made by me or by my assistants and that the same is true and correct to the best of my knowledge and belief.

H. A. Carson, Jr.  
Date Surveyed 7-13-84  
Registered Professional Engineer and/or Land Surveyor  
**H. A. Carson, Jr.**  
Certificate No. **5063**

