

STATE OF NEW MEXICO
ENERGY AND MINERALS DEPARTMENT

C.L. CONSERVATION DIVISION

P. O. BOX 2088

SANTA FE, NEW MEXICO 87501

Form C-101
Revised 10-1-78

NO. OF COPIES RECEIVED	
DISTRIBUTION	
SANTA FE	
FILE	
U.S.G.S.	
LAND OFFICE	
OPERATOR	

5A. Indicate Type of Lease
STATE <input checked="" type="checkbox"/> REC <input type="checkbox"/>
5. State Oil & Gas Lease No.
B-10784

APPLICATION FOR PERMIT TO DRILL, DEEPEN, OR PLUG BACK

14. Type of Work		7. Unit Agreement Name	
a. Type of Well OIL WELL <input checked="" type="checkbox"/> GAS WELL <input type="checkbox"/> OTHER <input type="checkbox"/> DRILL <input checked="" type="checkbox"/> DEEPEN <input type="checkbox"/> PLUG BACK <input type="checkbox"/> SINGLE ZONE <input checked="" type="checkbox"/> MULTIPLE ZONE <input type="checkbox"/>		8. Farm or Lease Name	
2. Name of Operator		9. Well No.	
AMOCO PRODUCTION COMPANY		1	
3. Address of Operator		10. Field and Pool, or Wildcat	
P. O. Box 68, Hobbs, New Mexico 88240		West Vacuum Bone Springs	
4. Location of Well		11. Undesignated	
UNIT LETTER J LOCATED 1980 FEET FROM THE South LINE			
AND 1980 FEET FROM THE East LINE OF SEC. 9 TWP. 18-S RGE. 34-E NMPM			
19. Proposed Depth		19A. Formation	
9200'		Bone Springs	
20. Rotary or C.T.		Rotary	
21. Kind & Status Plug. bond		22. Approx. Date Work will start	
Blanket-On-File		10-15-84	
21A. Kind & Status Plug. bond		21B. Drilling Contractor	
Blanket-On-File		N/A	
21C. Elevations (Show whether LH, H, etc.)		21D. Kind & Status Plug. bond	
4043.0'		Blanket-On-File	

PROPOSED CASING AND CEMENT PROGRAM

SIZE OF HOLE	SIZE OF CASING	WEIGHT PER FOOT	SETTING DEPTH	SACKS OF CEMENT	EST. TOP
17-1/2"	13-3/8"	54.5#	500'	Circulate	surface
11"	8-5/8"	24, 32#	3600'	Tieback to 13-3/8"	500'
7-7/8"	5-1/2"	17, 15.5#	9200'	Tieback to 500'	7740'
				above Bone Springs	

Propose to drill and equip subject well in the Bone Springs formation. After reaching TD, logs will be run and evaluated. Perforate and/or stimulate as necessary in attempting commercial production.

APPROVAL VALID FOR 180 DAYS
PERMIT EXPIRES 2/25/85
UNLESS DRILLING UNDERWAY

BOP Diagram attached

Mud Program : 0 - 500' Fresh Water- Native
500 - 3600' Saturated Brine water
3600 - TD Cut brine/Klafree

0+5-NMOCD,H 1-J. R. Barnett, HOU 21.156 1-F. J. Nash, HOU Rm. 4.206 1-GCC

ABOVE SPACE DESCRIBE PROPOSED PROGRAM: IF PROPOSAL IS TO DEEPEN OR PLUG BACK, GIVE DATA ON PRESENT PRODUCTIVE ZONE AND PROPOSED NEW PRODUCTIVE ZONE. GIVE BLOWOUT PREVENTER PROGRAM, IF ANY.

hereby certify that the information above is true and complete to the best of my knowledge and belief.

Signed Mary C. Clark Title Assist. Admin. Analyst Date 8-21-84

(This space for State Use)

Eddie W. Seay

APPROVED BY Oil & Gas Inspector TITLE DATE AUG 22 1984

CONDITIONS OF APPROVAL, IF ANY:

RECEIVED

AUG 21 1984

O.C.D.
HODGE OFFICE

N MEXICO OIL CONSERVATION COMMISS
WELL LOCATION AND ACREAGE DEDICATION PLAT

Form C-102
 Supersedes C-128
 Effective 1-1-65

All distances must be from the outer boundaries of the Section

Operator Amoco Production Company			Lease State CN		Well No. 1
Unit Letter J	Section 9	Township 18 South	Range 34 East	County Lea	
Actual Footage Location of Well: 1980 feet from the south line and 1980 feet from the east line					
Ground Level Elev. 4043.0'	Producing Formation Bone Springs	Pool West Vacuum Bone Springs		Dedicated Acreage: 40 Acres	

1. Outline the acreage dedicated to the subject well by colored pencil or hatchure marks on the plat below.
2. If more than one lease is dedicated to the well, outline each and identify the ownership thereof (both as to working interest and royalty).
3. If more than one lease of different ownership is dedicated to the well, have the interests of all owners been consolidated by communitization, unitization, force-pooling, etc?

☐ Yes ☐ No If answer is "yes," type of consolidation _____

If answer is "no," list the owners and tract descriptions which have actually been consolidated. (Use reverse side of this form if necessary.) _____

No allowable will be assigned to the well until all interests have been consolidated (by communitization, unitization, forced-pooling, or otherwise) or until a non-standard unit, eliminating such interests, has been approved by the Commission.

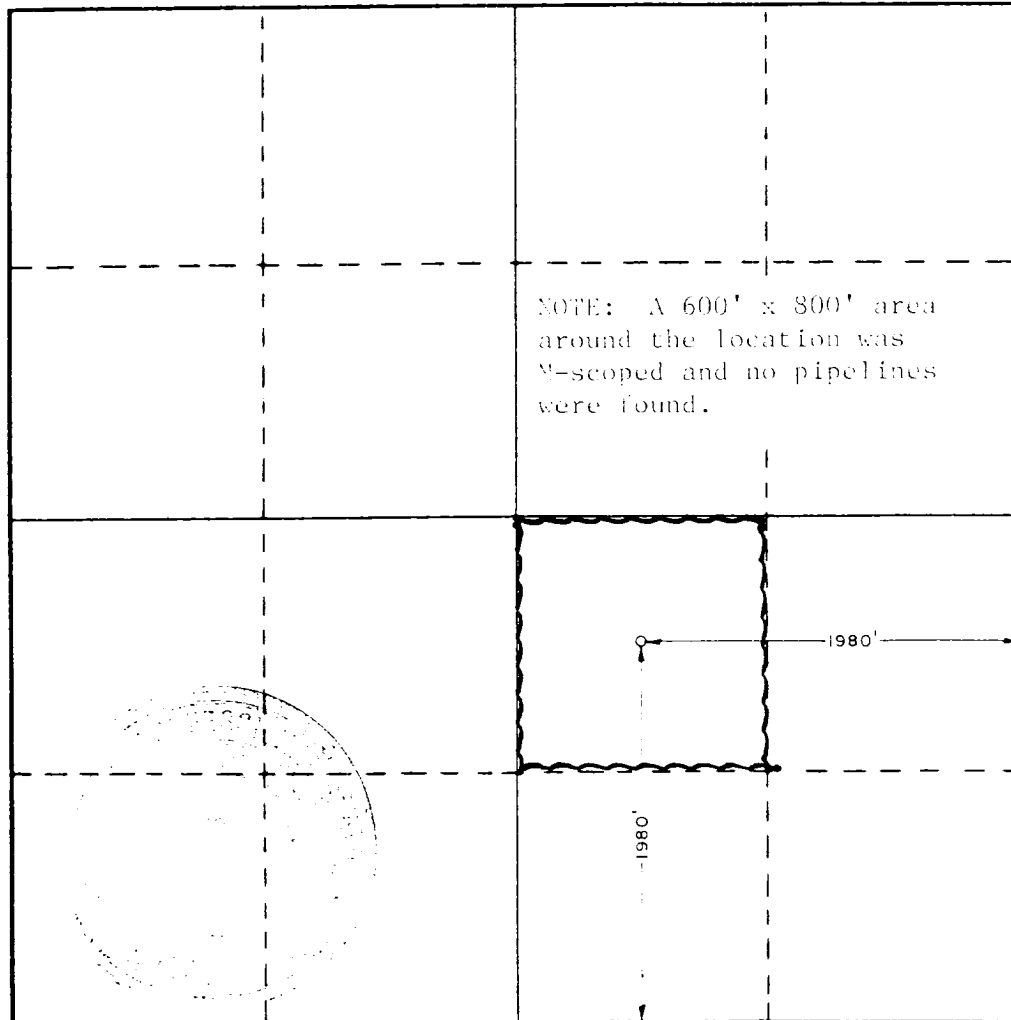

CERTIFICATION

I hereby certify that the information contained herein is true and complete to the best of my knowledge and belief.

Name Mary C. Clark
 Position Assist. Admin. Analyst
 Company AMOCO PRODUCTION COMPANY
 Date 8-21-84

I hereby certify that the well location shown on this plat was plotted from field notes of actual surveys made by me or under my supervision, and that the same is true and correct to the best of my knowledge and belief.

Date Surveyed August 17, 1984
 Registered Professional Engineer and/or Land Surveyor

John W West
 Certificate No. JOHN W WEST, 676
RONALD J. EIDSON, 3239

STANDARD 2000 PSI W.P. BOP STACK

1. Blow-out preventers may be manually operated.
2. All equipment must be in good condition, 2,000 psi W.P. (4,000 psi test) minimum.
3. Bell nipple above blow-out preventer shall be same size as casing being drilled through.
4. Kelly cock to be installed on kelly.
5. Full opening safety valve 2,000 psi w.p. (4,000 psi test) minimum must be available on rig floor at all times with proper connection or subs to fit any tool joint in string.
6. Spool or cross may be eliminated if connections are available in the lower part of the blow-out preventer body.
7. Double or space saver type preventers may be used in lieu of two single preventers.
8. BOP rams to be installed as follows:
 - Top preventer - Drill pipe or casing rams
 - Bottom preventer - Blind rams

*Amoco District Superintendent may reverse location of rams.
9. Extensions and hand wheels to be installed and braced at all times.
10. Manifold valves may be gate or plug metal to metal seal 2" minimum.

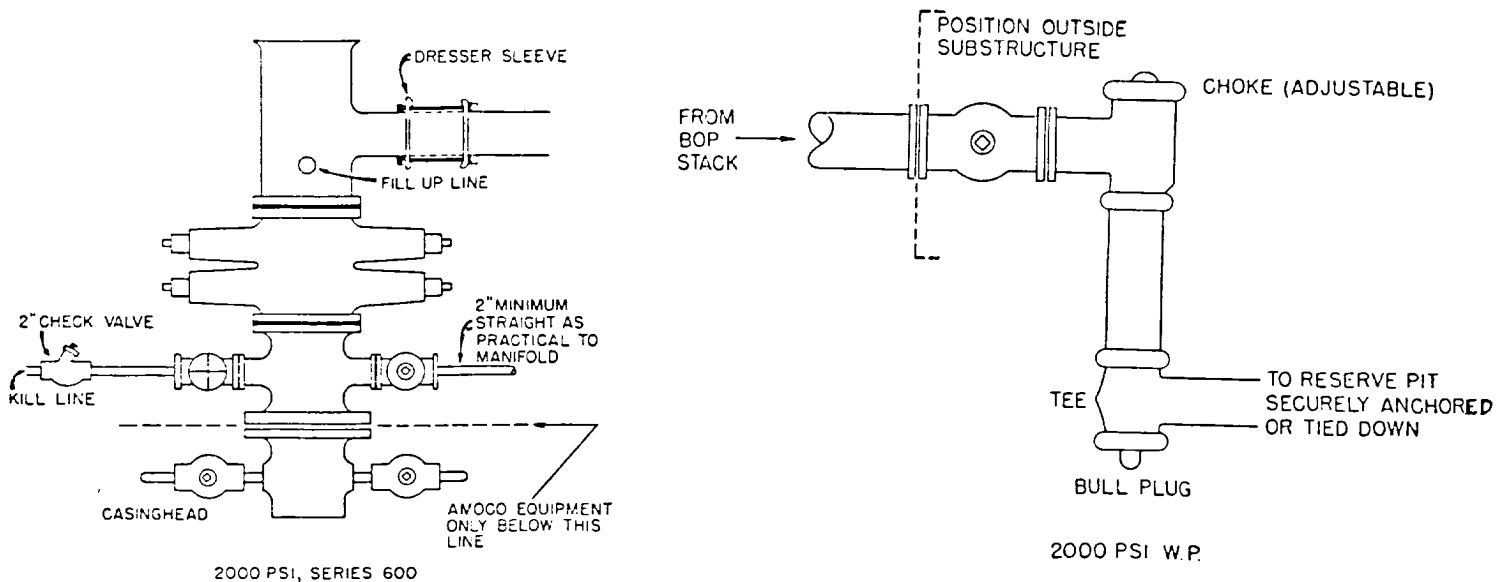

RECEIVED

AUG 21 1984

O.C.D.
HOBBS OFFICE

1-1-84
1-1-84
1-1-84