

**NEW MEXICO OIL CONSERVATION COMMISSION
WELL LOCATION AND ACREAGE DEDICATION PLAT**

Form C-102
Supersedes C-128
Effective 1-1-65

All distances must be from the outer boundaries of the Section

Operator SHELL WESTERN E. & P., INC.			Lease NORTH HOBBS UNIT		Well No. 29 -342
Unit Letter 0	Section 29	Township 18S	Range 38E	County LFA	
Actual Footage Location of Well: 1230 feet from the SOUTH line and 2500 feet from the EAST line					
Ground Level Elev. 3646.5	Producing Formation GRAYBURG/SAN ANDRES		Pool HOBBS (GRAYBURG/SAN ANDRES)		Dedicated Acreage: 40 Acres

1. Outline the acreage dedicated to the subject well by colored pencil or hatchure marks on the plat below.
2. If more than one lease is dedicated to the well, outline each and identify the ownership thereof (both as to working interest and royalty).
3. If more than one lease of different ownership is dedicated to the well, have the interests of all owners been consolidated by communitization, unitization, force-pooling, etc?

☒ Yes ☐ No If answer is "yes," type of consolidation **UNITIZATION**

If answer is "no," list the owners and tract descriptions which have actually been consolidated. (Use reverse side of this form if necessary.) _____

No allowable will be assigned to the well until all interests have been consolidated (by communitization, unitization, forced-pooling, or otherwise) or until a non-standard unit, eliminating such interests, has been approved by the Commission.

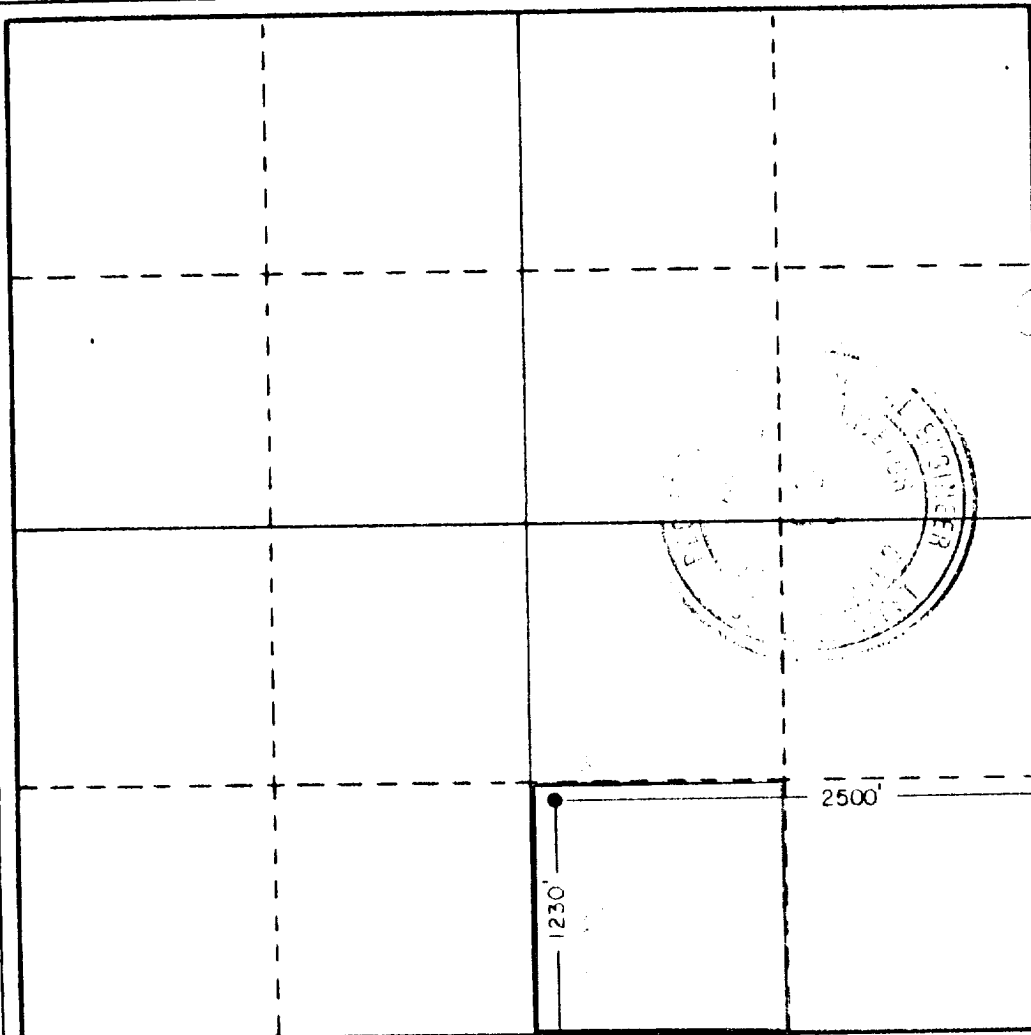

CERTIFICATION

I hereby certify that the information contained herein is true and complete to the best of my knowledge and belief.

Name **A. J. FORE**
Position **SUPERVISOR REG. & PERMITTING**
Company **SHELL WESTERN E&P INC.**
Date **AUGUST 17, 1984**

I hereby certify that the well location shown on this plat was plotted from field notes of actual surveys made by me or under my supervision, and that the same is true and correct to the best of my knowledge and belief.

Date Surveyed **8/25/84**

Registered Professional Engineer and/or Land Surveyor

John W. West
Certificate No. **JOHN W. WEST, 676**
RONALD J. EIDSON, 3239

0 250 500 750 1000 1250 1500 1750 2000 2250 2500

Handwritten notes:
6/2/84
[illegible]

RECEIVED

AUG 22 1984

O.C.D.
HOBBS OFFICE

Handwritten notes:
[illegible]