

NO. OF COPIES RECEIVED	
DISTRIBUTION	
SANTA FE	
FILE	
U.S.G.S.	
LAND OFFICE	
OPERATOR	

# NEW MEXICO OIL CONSERVATION COMMISSION

Form C-101  
Revised 1-1-65

5A. Indicate Type of Lease STATE <input checked="" type="checkbox"/> FEE <input type="checkbox"/>
5. State Oil & Gas Lease No. B-1520--1
7. Unit Agreement Name North Vacuum Abo
8. Farm or Lease Name North Vacuum Abo
9. Well No. 262
10. Field and Pool, or Wildcat North Vacuum Abo
12. County Lea
19. Proposed Depth 9100'
19A. Formation Abo
20. Rotary or C.T. Rotary
21. Elevations (Show whether DF, RT, etc.) 4028
21A. Kind & Status Plug. Bond on file
21B. Drilling Contractor unknown
22. Approx. Date Work will start ASAP

## APPLICATION FOR PERMIT TO DRILL, DEEPEN, OR PLUG BACK

1a. Type of Work DRILL <input checked="" type="checkbox"/> DEEPEN <input type="checkbox"/> PLUG BACK <input type="checkbox"/>
b. Type of Well OIL WELL <input checked="" type="checkbox"/> GAS WELL <input type="checkbox"/> OTHER <input type="checkbox"/> SINGLE ZONE <input checked="" type="checkbox"/> MULTIPLE ZONE <input type="checkbox"/>
2. Name of Operator MOBIL PRODUCING TX. & N.M. INC.
3. Address of Operator Nine Greenway Plaza, Suite 2700 Houston, TX 77046
4. Location of Well UNIT LETTER M LOCATED 580 FEET FROM THE West LINE AND 620 FEET FROM THE South LINE OF SEC. 12 TWP. 17S RGE. 34E NMPM
21. Elevations (Show whether DF, RT, etc.) 4028
21A. Kind & Status Plug. Bond on file
21B. Drilling Contractor unknown
22. Approx. Date Work will start ASAP

23.

### PROPOSED CASING AND CEMENT PROGRAM

SIZE OF HOLE	SIZE OF CASING	WEIGHT PER FOOT	SETTING DEPTH	SACKS OF CEMENT	EST. TOP
17-1/2"	13-3/8"	48.0# H-40	0-400'	circulate	surface
12-1/4"	8-5/8"	28.0# S-80	0-5000'	circulate	surface
7-7/8"	5-1/2"-liner	15.5# K-55 17.0# N-80	4800-7300' 7300-TD	circulate	4800'

### Blowout Preventor Program

Casing String	Equipment Size & API Series	No. & Type	Test Pressure PSI
Surface	13-5/8" x 3000#	IMG & IPR	3000
		IMG 2PR & Rotary Head	5000

180 DAYS  
3/11/85  
UNLESS DRILLING UNDERWAY

IN ABOVE SPACE DESCRIBE PROPOSED PROGRAM: IF PROPOSAL IS TO DEEPEN OR PLUG BACK, GIVE DATA ON PRESENT PRODUCTIVE ZONE AND PROPOSED NEW PRODUCTIVE ZONE. GIVE BLOWOUT PREVENTER PROGRAM, IF ANY.

I hereby certify that the information above is true and complete to the best of my knowledge and belief.

Regulatory Technician

Signed S. Hall for A. D. Bond Title Supervisor Date 09/10/84

(This space for State Use)

ORIGINAL SIGNED BY JERRY DIXON

APPROVED BY DISTRICT SUPERVISOR TITLE DATE SEP 11 1984

CONDITIONS OF APPROVAL, IF ANY:

All distances must be from the outer boundaries of the Section.

Operator <b>MOBIL PRODUCING TX. &amp; N.M. INC.</b>		Lease <b>North Vacuum Abo</b>		Well No. <b>262</b>
Unit Letter <b>M</b>	Section <b>12</b>	Township <b>17S</b>	Range <b>34E</b>	County <b>Lea</b>
Actual Postage Location of Well: <b>580</b> feet from the <b>West</b> line and <b>620'</b> feet from the <b>South</b> line				
Ground Level Elev. <b>4028</b>	Producing Formation <b>Abo</b>	Pool <b>North Vacuum Abo</b>	Dedicated Acreage: <b>(2 wells) 80</b> Acres	

1. Outline the acreage dedicated to the subject well by colored pencil or hatchure marks on the plat below.
2. If more than one lease is dedicated to the well, outline each and identify the ownership thereof (both as to working interest and royalty).
3. If more than one lease of different ownership is dedicated to the well, have the interests of all owners been consolidated by communitization, unitization, force-pooling, etc?

☒ Yes ☐ No If answer is "yes," type of consolidation unitized

If answer is "no," list the owners and tract descriptions which have actually been consolidated. (Use reverse side of this form if necessary.) \_\_\_\_\_

No allowable will be assigned to the well until all interests have been consolidated (by communitization, unitization, forced-pooling, or otherwise) or until a non-standard unit, eliminating such interests, has been approved by the Division.

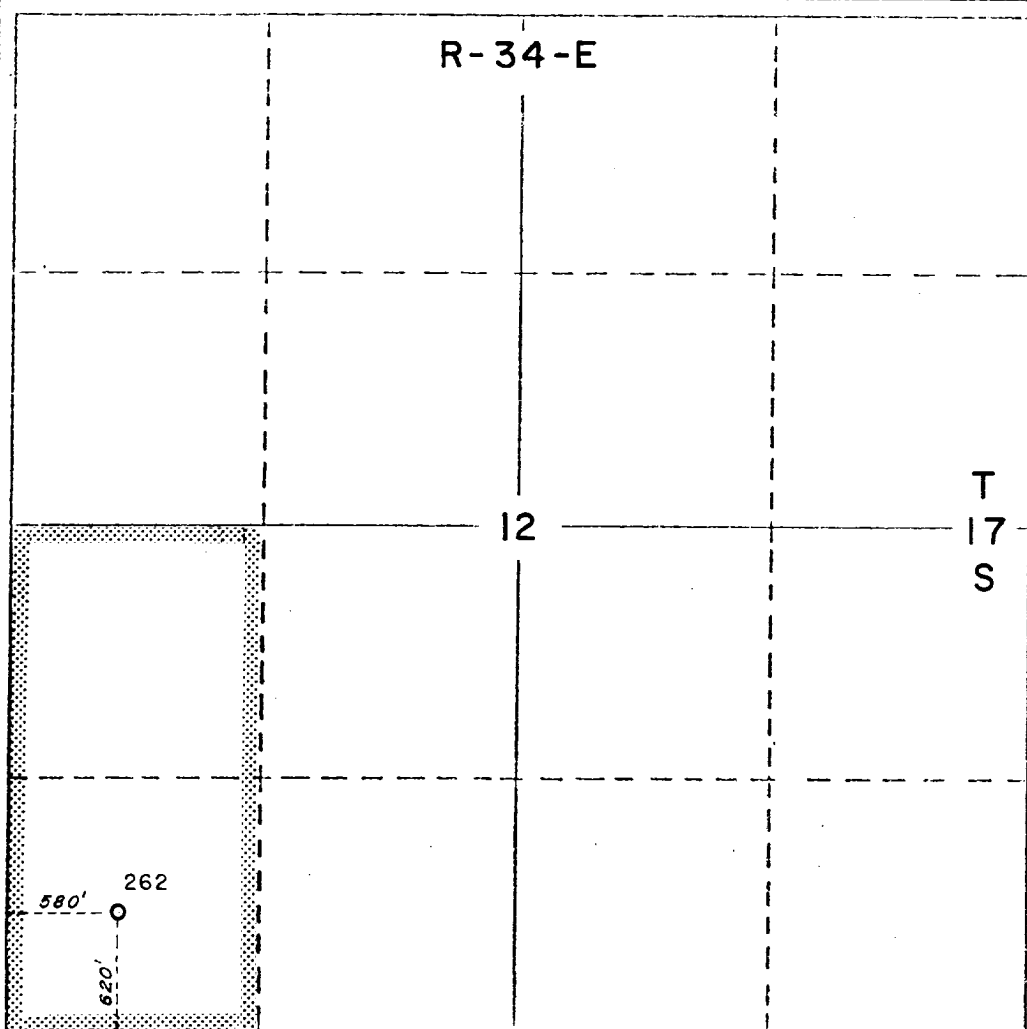

CERTIFICATION

I hereby certify that the information contained herein is true and complete to the best of my knowledge and belief.

S. S. Hall

Name

A. D. Bond

Position Regulatory Technician Supervisor

Company

MOBIL PRODUCING TX. & N.M. INC.

Date

September 10, 1984

I hereby certify that the well location shown on this plat was plotted from field notes of actual surveys made by me or under my supervision, and that the same is true and correct to the best of my knowledge and belief.

Date Surveyed

J. N. Newton  
Registered Professional Engineer  
and/or Land Surveyor

J. N. Newton

Certificate No.

5109

0 330 660 990 1320 1650 1980 2310 2640 2970 3300 3630 3960 4290 4620 4950 5280 5610 5940 6270 6600

RECEIVED

SEP 11 1984

RECEIVED

11