

NO. OF COPIES RECEIVED	
DISTRIBUTION	
SANTA FE	
FILE	
U.S.G.S.	
LAND OFFICE	
OPERATOR	

5A. Indicate Type of Lease
STATE ☒ FEE ☐
5. State Oil & Gas Lease No.
B-1520-1

APPLICATION FOR PERMIT TO DRILL, DEEPEN, OR PLUG BACK

1a. Type of Work DRILL <input checked="" type="checkbox"/> DEEPEN <input type="checkbox"/> PLUG BACK <input type="checkbox"/>		7. Unit Agreement Name North Vacuum Abo
b. Type of Well OIL WELL <input checked="" type="checkbox"/> GAS WELL <input type="checkbox"/> OTHER <input type="checkbox"/> SINGLE ZONE <input checked="" type="checkbox"/> MULTIPLE ZONE <input type="checkbox"/>		8. Farm or Lease Name
2. Name of Operator Mobil Producing TX & N.M. Inc.		9. Well No. 273
3. Address of Operator Nine Greenway Plaza, Suite 2700 Houston, Texas 77046		10. Field and Pool, or Wildcat North Vacuum Abo
4. Location of Well UNIT LETTER C LOCATED 710 FEET FROM THE North LINE AND 1880 FEET FROM THE West LINE OF SEC. 11 TWP. 17 S REC. 34 E NMPM		12. County Lea
19. Proposed Depth 9100'		19A. Formation Abo
20. Rotary or C.T. Rotary		
21. Elevations (Show whether DF, KT, etc.) 4040	21A. Kind & Status Plug. Bond on file	21B. Drilling Contractor unknown
22. Approx. Date Work will start ASAP		

PROPOSED CASING AND CEMENT PROGRAM

SIZE OF HOLE	SIZE OF CASING	WEIGHT PER FOOT	SETTING DEPTH	SACKS OF CEMENT	EST. TOP
17-1/2"	13-3/8"	48.0# H-40	0 - 4400'	Circulate	Surface
12-1/4"	8-5/8"	28.0# S-80	0 - 5000'	Circulate	Surface
7-7/8"	5-1/2" Liner	15.5# K-55 17.0# N-80	4800 - 7300' 7300 - TD	Circulate	4800'

Blowout Preventer Equipment

Casing String	Equipment & Size and API Series	No. & Type	Test Pressure
Surface	13-5/8 X 3000#	IMG & 1PR	3000
		IMG 2PR & Rotary Head	5000

APPROVAL VALID FOR 180 DAYS
PERMIT EXPIRES 5/27/85
UNLESS DRILLING UNDERWAY

ABOVE SPACE DESCRIBE PROPOSED PROGRAM: IF PROPOSAL IS TO DEEPEN OR PLUG BACK, GIVE DATA ON PRESENT PRODUCTIVE ZONE AND PROPOSED NEW PRODUCTIVE ZONE. GIVE BLOWOUT PREVENTER PROGRAM, IF ANY.

I hereby certify that the information above is true and complete to the best of my knowledge and belief.
Regulatory Technician
Signed A. D. Bond Title Supervisor Date September 17, 1984

(This space for State Use)

ORIGINAL SENT BY TELETYPE

APPROVED BY DATE TITLE DATE SEP 27 1984
CONDITIONS OF APPROVAL, IF ANY:

All distances must be from the outer boundaries of the Section.

Operator MOBIL PRODUCING TX. & N.M. INC.		Lease North Vacuum Abo		Well No. 273
Unit Letter C	Section 11	Township 17 S	Range 34E	County Lea
Actual Footage Location of Well: 710 feet from the North line and 1880 feet from the West line				
Ground Level Elev. 4040	Producing Formation Abo	Pool North Vacuum Abo	Dedicated Acreage: (2 wells) 80 Acres	

1. Outline the acreage dedicated to the subject well by colored pencil or hachure marks on the plat below.
2. If more than one lease is dedicated to the well, outline each and identify the ownership thereof (both as to working interest and royalty).
3. If more than one lease of different ownership is dedicated to the well, have the interests of all owners been consolidated by communitization, unitization, force-pooling, etc?

☒ Yes ☐ No If answer is "yes," type of consolidation Unitized

If answer is "no," list the owners and tract descriptions which have actually been consolidated. (Use reverse side of this form if necessary.)

No allowable will be assigned to the well until all interests have been consolidated (by communitization, unitization, forced-pooling, or otherwise) or until a non-standard unit, eliminating such interests, has been approved by the Division.

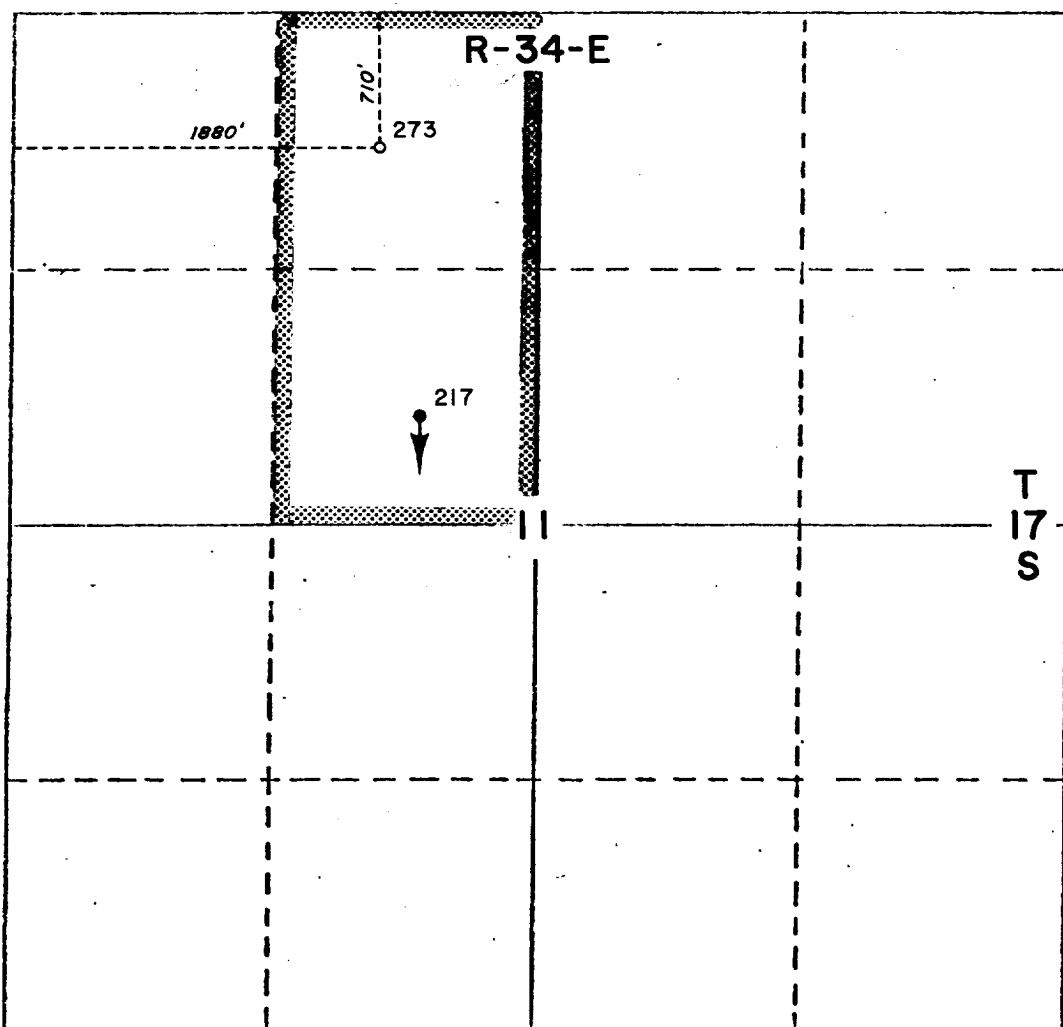

CERTIFICATION

I hereby certify that the information contained herein is true and complete to the best of my knowledge and belief.

Name
A. D. Bond

Position
Regulatory Technician Supervisor

Company
Mobil Producing TX. & N.M. Inc.

Date
September 17, 1984

I hereby certify that the well location shown on this plat was plotted from field notes of **REGISTERED SURVEYOR** made by me or under my supervision, and that the same is true and correct to the best of my knowledge and belief.

Date Surveyed
September 17, 1984

Registered Professional Engineer and/or Land Surveyor
J. N. Newton

Certificate No.
5109