

UNITED STATES  
DEPARTMENT OF THE INTERIOR  
BUREAU OF LAND MANAGEMENT

CONTACT RECEIVING  
OFFICE FOR NUMBER  
OF COPIES REQUIRED  
(Other instructions on  
reverse side)

BLM Roswell District  
Modified Form No.  
NM060-3160-2

APPLICATION FOR PERMIT TO DRILL, DEEPEN, OR PLUG BACK

1a. TYPE OF WORK <b>DRILL</b> <input type="checkbox"/> <b>DEEPEN</b> <input type="checkbox"/> <b>PLUG BACK</b> <input checked="" type="checkbox"/>			5. LEASE DESIGNATION AND SERIAL NO. NM-26692			
b. TYPE OF WELL OIL WELL <input checked="" type="checkbox"/> GAS WELL <input type="checkbox"/> OTHER <input type="checkbox"/> SINGLE ZONE <input checked="" type="checkbox"/> MULTIPLE ZONE <input type="checkbox"/>			6. IF INDIAN, ALLOTTEE OR TRIBE NAME			
2. NAME OF OPERATOR Southland Royalty Co.			7. UNIT AGREEMENT NAME			
3. ADDRESS OF OPERATOR P.O. Box 51810, Midland, TX 79710-1810			8. FARM OR LEASE NAME Huber "17" Federal			
4. LOCATION OF WELL (Report location clearly and in accordance with any State requirements.) At surface K, 1980' FSL & 1930' FWL At proposed prod. zone			9. WELL NO. 2			
14. DISTANCE IN MILES AND DIRECTION FROM NEAREST TOWN OR POST OFFICE* 11 miles SE of Maljamar, New Mexico			10. FIELD AND POOL, OR WILDCAT West Corbin (Delaware)			
15. DISTANCE FROM PROPOSED* LOCATION TO NEAREST PROPERTY OR LEASE LINE, FT. (Also to nearest drlg. unit line, if any) 660'			11. SEC., T., R., M., OR BLK. AND SURVEY OR AREA 17, T-18-S, R-33-E			
16. NO. OF ACRES IN LEASE 120			12. COUNTY OR PARISH Lea			
17. NO. OF ACRES ASSIGNED TO THIS WELL 40			13. STATE NM			
18. DISTANCE FROM PROPOSED LOCATION* TO NEAREST WELL, DRILLING, COMPLETED, OR APPLIED FOR, ON THIS LEASE, FT. 1880'			20. ROTARY OR CABLE TOOLS ---			
19. PROPOSED DEPTH 11,400' TD, 9000' PBTD			22. APPROX. DATE WORK WILL START* Upon Approval			
21. ELEVATIONS (Show Whether DF, RT, GR, ETC.) 3863.8' GR						
23. PROPOSED CASING AND CEMENTING PROGRAM						
HOLE SIZE	CASING SIZE	WEIGHT/FOOT	GRADE	THREAD TYPE	SETTING DEPTH	QUANTITY OF CEMENT
17-1/2"	13-3/8"	54.50#			653'	400 sxs-Surface
12-1/4"	8-5/8"	24#			2925'	1800 sxs -Surface
7-7/8"	5-1/2"	15.5 & 17#			11450'	2500 sxs-TOC10,300'

Plug Back from the South Corbin (Wolfcamp) to the West Corbin (Delaware)

RIH with 5-1/2" CIPB and set at 9000', dump bail 35' of cement on top.  
Run GR/CBL/CCL log from 6000'-4000' with 1500 psi on casing. Perforate Delaware 5080'-5220'. Test tubing to 3800 psi. Place 500 psi on 2-7/8" X 5-1/2" annulus. Monitor throughout job. Pump 1700 gallons of 7-1/2% NEFE HCL acid. Fracture stimulate the Delaware sand perforations 5080'-5220' w/30,000 gallons 35# Borate and 120,000 # 20/40 Ottawa sand. Recover load water. Reverse out sand fill. TIH w/2-7/8" tbgr. TIH w/ 2-1/2" X 1-1/4" X 24' RHBM pump. Put on Production.

IN ABOVE SPACE DESCRIBE PROPOSED PROGRAM: If proposal is to deepen or plug back, give data on present productive zone and proposed new productive zone. If proposal is to drill or deepen directionally, give pertinent data on subsurface locations and measured and true vertical depths. Give blowout preventer program, if any.

24. SIGNED Maria L. Perez TITLE Prod. Asst. DATE 8-16-91  
(This space for Federal or State office use)

PERMIT NO. \_\_\_\_\_ APPROVAL DATE \_\_\_\_\_

APPROVED BY Orig. Signed by Adam Salazar TITLE PRODUCTION MANAGER DATE 9/17/91  
CONDITIONS OF APPROVAL, IF ANY:

\*See Instructions On Reverse Side

Submit to Appropriate  
District Office  
State Lease - 4 copies  
Fee Lease - 3 copies

State of New Mexico  
Energy, Minerals and Natural Resources Department

Form C-102  
Revised 1-1-89

OIL CONSERVATION DIVISION

DISTRICT I  
P.O. Box 1980, Hobbs, NM 88240

P.O. Box 2088  
Santa Fe, New Mexico 87504-2088

DISTRICT II  
P.O. Drawer DD, Artesia, NM 88210

DISTRICT III  
1000 Rio Brazos Rd., Aztec, NM 87410

WELL LOCATION AND ACREAGE DEDICATION PLAT

All Distances must be from the outer boundaries of the section

Operator	Lease	Well No.
Southland Royalty Co.	Huber "17" Federal	2
Unit Letter	Section	Township
K	17	13-South
Range	County	
33-East	NMPM	Lea
Actual Footage Location of Well:		
1980	feet from the South	line and 1980' feet from the West line
Ground level Elev.	Producing Formation	Pool
3863.8' GR	Delaware	West Corbin (Delaware)
		Dedicated Acreage:
		40 Acres

1. Outline the acreage dedicated to the subject well by colored pencil or hatchure marks on the plat below.

2. If more than one lease is dedicated to the well, outline each and identify the ownership thereof (both as to working interest and royalty).

3. If more than one lease of different ownership is dedicated to the well, have the interest of all owners been consolidated by communitization, unitization, force-pooling, etc.?

☐ Yes ☐ No If answer is "yes" type of consolidation

If answer is "no" list the owners and tract descriptions which have actually been consolidated. (Use reverse side of this form if necessary.)

No allowable will be assigned to the well until all interests have been consolidated (by communitization, unitization, forced-pooling, or otherwise) or until a non-standard unit, eliminating such interest, has been approved by the Division.

OPERATOR CERTIFICATION

I hereby certify that the information contained herein is true and complete to the best of my knowledge and belief.

Signature

Printed Name

Maria L. Perez

Position

Prod. Asst.

Company

Southland Royalty Co.

Date

8-16-91

SURVEYOR CERTIFICATION

I hereby certify that the well location shown on this plat was plotted from field notes of actual surveys made by me or under my supervision, and that the same is true and correct to the best of my knowledge and belief.

Date Surveyed

Signature & Seal of  
Professional Surveyor

Certificate No.

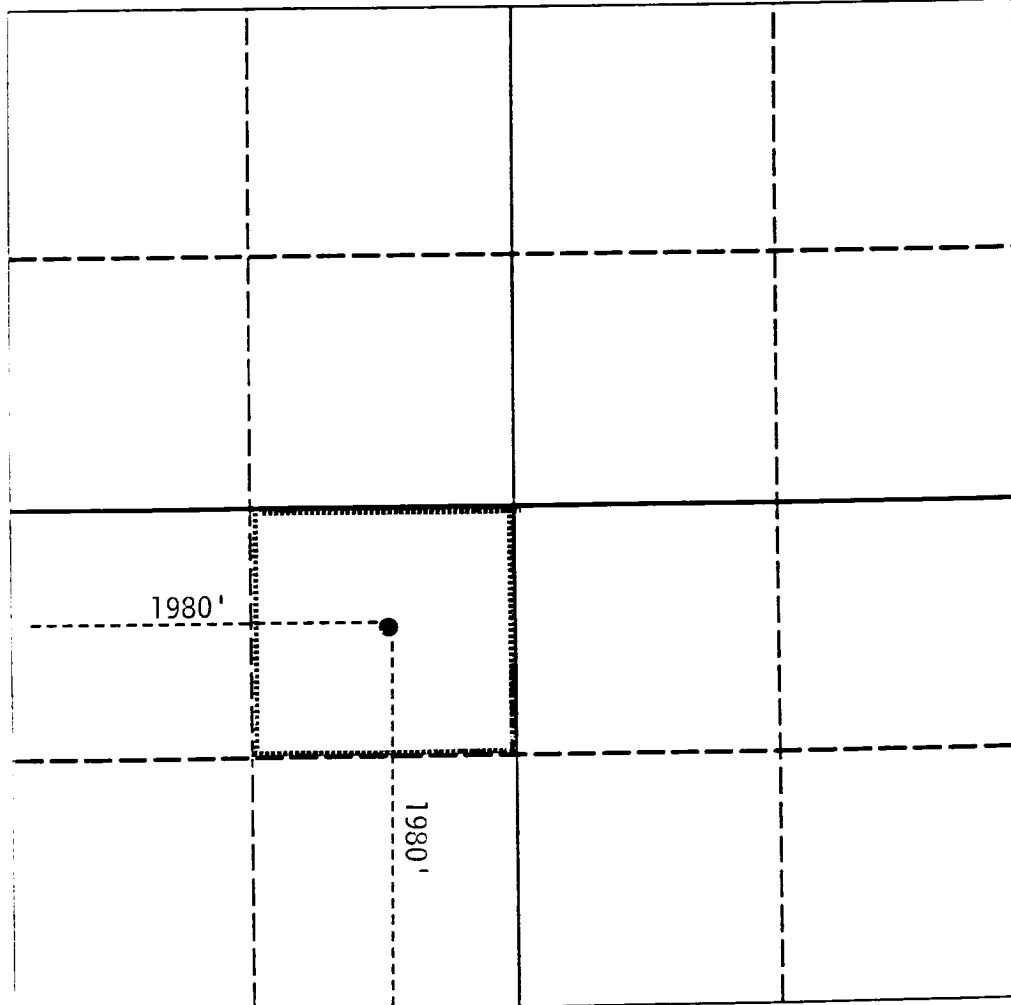

0 330 660 990 1320 1650 1980 2310 2640 2000 1500 1000 500 0