

30-025-29908

NO. OF COPIES RECEIVED	
DISTRIBUTION	
SANTA FE	
FILE	
U.S.G.S.	
LAND OFFICE	
OPERATOR	

NEW MEXICO OIL CONSERVATION COMMISSION

Form C-101
Revised 1-1-85

5A. Indicate Type of Lease	
STATE <input checked="" type="checkbox"/>	FEE <input type="checkbox"/>
5. State Oil & Gas Lease No. LG-2731	

APPLICATION FOR PERMIT TO DRILL, DEEPEN, OR PLUG BACK

1a. Type of Work b. Type of Well DRILL <input checked="" type="checkbox"/> DEEPEN <input type="checkbox"/> PLUG BACK <input type="checkbox"/> OIL WELL <input checked="" type="checkbox"/> GAS WELL <input type="checkbox"/> OTHER <input type="checkbox"/> SINGLE ZONE <input checked="" type="checkbox"/> MULTIPLE ZONE <input type="checkbox"/>		7. Unit Agreement Name	
2. Name of Operator Southland Royalty Company		8. Farm or Lease Name Tonto "15" State	
3. Address of Operator 21 Desta Drive, Midland, Texas 79705		9. Well No. 2	
4. Location of Well UNIT LETTER H LOCATED 1880 FEET FROM THE North LINE AND 550 FEET FROM THE East LINE OF SEC. 15 TWP. 18S RGE. 34E NMPM		10. Field and Pool, or Wildcat N. Airstrip (Bone Spr)	
12. County Lea			
19. Proposed Depth 10,150'		19A. Formation Bone Spring	
20. Rotary or C.T. Rotary			
21. Elevations (Show whether DF, RT, etc.) 4013.5' GR		21A. Kind & Status Plug. Bond	
21B. Drilling Contractor		22. Approx. Date Work will start 5/1/87	

PROPOSED CASING AND CEMENT PROGRAM

SIZE OF HOLE	SIZE OF CASING	WEIGHT PER FOOT	SETTING DEPTH	SACKS OF CEMENT	EST. TOP
17 1/2"	13 3/8"	48#	400'	350 sx.	Circ.
12 1/4"	8 5/8"	28 & 24#	3400'	1888 sx.	Circ.
7 7/8"	5 1/2"	17 & 15.5#	10,150'	700 sx.	TOC @ ± 6800'

Drill 17 1/2" hole to 400'. Set 13 3/8" csg @ 400'. Cmt w/350 sx Cl "C". Circ to surf.
Drill 12 1/4" hole to 3400'. Set 8 5/8" csg @ 3400'. Cmt w/1638 sx Cl "C" Lite + 250 sx.
Cl "C". Circ to surf. Drill to TD. Set 5 1/2" csg @ 10,150'. Cmt w/sufficient volume to
cover all prospective zones. Estimated top of cmt @ ± 6800'. Perforate & stimulate Bone
Spring for production.

MUD PROGRAM: 0-400' spud mud; 400-3400' salt water; 3400-8500' cut brine wtr; 8500-TD
cut brine w/XC polymer & Drispac. MW 8.8-9.2, VIS 33-36, 12-15 cc. BHP @ TD anticipated
to be 4000 psi. No abnormal pressures expected.

BOP PROGRAM: BOP to be tested after each new installation & after setting 8 5/8" & 5 1/2"
csg by Yellow Jacket, Inc.

GAS NOT DEDICATED

IN ABOVE SPACE DESCRIBE PROPOSED PROGRAM; IF PROPOSAL IS TO DEEPEN OR PLUG BACK, GIVE DATA ON PRESENT PRODUCTIVE ZONE AND PROPOSED NEW PRODUCTIVE ZONE. GIVE BLOWOUT PREVENTER PROGRAM, IF ANY.

I hereby certify that the information above is true and complete to the best of my knowledge and belief.

Signed [Signature] Title Engineering Tech III Date 4/24/87

(This space for State Use)

ORIGINAL SIGNED BY JERRY SEXTON

APPROVED BY DISTRICT I SUPERVISOR TITLE DATE APR 27 1987

CONDITIONS OF APPROVAL, IF ANY:

Permit Expires 6 Months From Approval
Date Unless Drilling Underway.

RECEIVED
APR 27 1987
OCD
HOBBS OFFICE

MEXICO OIL CONSERVATION COMMISSION
WELL LOCATION AND ACREAGE DEDICATION PLAT

Form C-102
Supersedes C-128
Effective 1-1-65

All distances must be from the outer boundaries of the Section

Section 15		T. 15 N. R. 10 E.		S. 10 E.	
Bone Spring		N. Airstrip		80	

- Outline the acreage dedicated to the subject well by colored pencil or hatchure marks on the plat below.
- If more than one lease is dedicated to the well, outline each and identify the ownership thereof (both as to working interest and royalty).
- If more than one lease of different ownership is dedicated to the well, have the interests of all owners been consolidated by communitization, unitization, force-pooling, etc?

☐ Yes ☐ No If answer is "yes," type of consolidation _____

If answer is "no," list the owners and tract descriptions which have actually been consolidated (Use reverse side of this form if necessary): _____

No allowable will be assigned to the well until all interests have been consolidated (by communitization, unitization, forced-pooling, or otherwise) or until a non-standard unit, eliminating such interests, has been approved by the Commission.

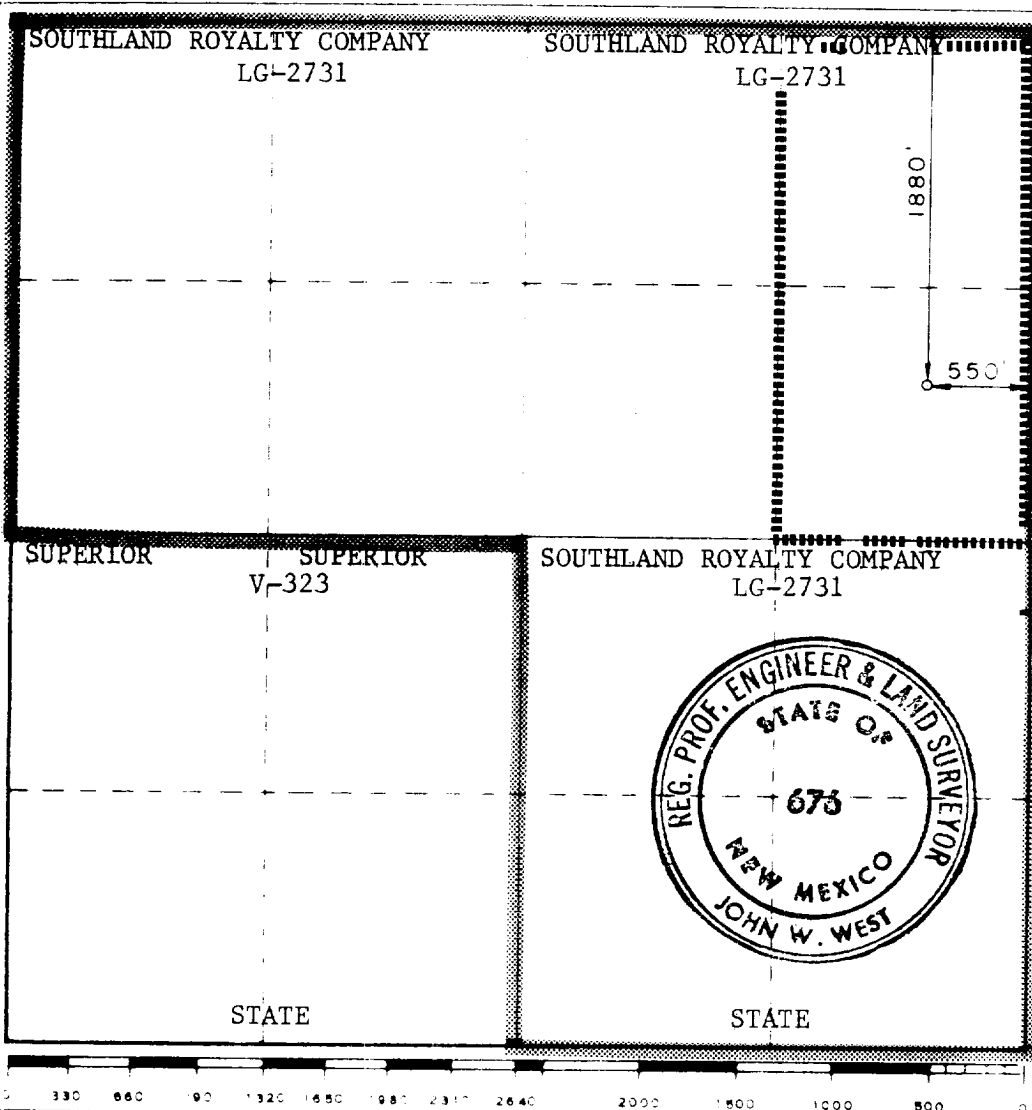

CERTIFICATION

I hereby certify that the information contained herein is true and complete to the best of my knowledge and belief.

Name
Cathy Nokes
Position
Engineering Tech III
Company
Southland Royalty Company
Date
4/24/87

I hereby certify that the well location shown on this plat was plotted from field notes of actual surveys made by me or under my supervision, and that the same is true and correct to the best of my knowledge and belief.

Date Surveyed
April 21, 1987
Registered Professional Engineer
and Land Surveyor

Certificate No. JOHN W. WEST, 676
RONALD J. EIDSON, 3239

RECEIVED
JUN 27 1964
U.S. DEPT. OF JUSTICE

100-107100-100
FBI