

STATE OF NEW MEXICO
ENERGY AND MINERALS DEPARTMENT

OIL CONSERVATION DIVISION
P. O. BOX 2088
SANTA FE, NEW MEXICO 87501

Form C-101
Revised 10-1-78

NO. OF COPIES RECEIVED	
DISTRIBUTION	
SANTA FE	
FILE	
U.S.G.S.	
LAND OFFICE	
OPERATOR	

5A. Indicate Type of Lease	
STATE <input checked="" type="checkbox"/>	FEE <input type="checkbox"/>
5. State Oil & Gas Lease No.	
B-2229	

APPLICATION FOR PERMIT TO DRILL, DEEPEN, OR PLUG BACK

1a. Type of Work				7. Unit Agreement Name	
b. Type of Well DRILL <input checked="" type="checkbox"/> DEEPEN <input type="checkbox"/> PLUG BACK <input type="checkbox"/> OIL WELL <input checked="" type="checkbox"/> GAS WELL <input type="checkbox"/> OTHER <input type="checkbox"/> SINGLE ZONE <input checked="" type="checkbox"/> MULTIPLE ZONE <input type="checkbox"/>				8. Farm or Lease Name Philmex	
2. Name of Operator Phillips Petroleum Company				9. Well No. 20	
3. Address of Operator 4001 Penbrook Street, Odessa, Texas 79762				10. Field and Pool, or Wildcat Vacuum Grayburg/SA	
4. Location of Well UNIT LETTER <u>D</u> LOCATED <u>660</u> FEET FROM THE <u>North</u> LINE AND <u>660</u> FEET FROM THE <u>West</u> LINE OF SEC. <u>36</u> TWP. <u>17-S</u> RGE. <u>33-E</u> NMPM				12. County Lea	
19. Proposed Depth 4900'±				19A. Formation Grayburg/San Andres	
20. Rotary or C.T. Rotary				21. Elevations (show whether DF, KI, etc.) 4120.5'GR (unprepared)	
21A. Kind & Status Plug. Bond Blanket Bond		21B. Drilling Contractor Will advise later		22. Approx. Date Work will start Upon approval	

PROPOSED CASING AND CEMENT PROGRAM

SIZE OF HOLE	SIZE OF CASING	WEIGHT PER FOOT	SETTING DEPTH	SACKS OF CEMENT	EST. TOP
12-1/4"	8-5/8"	24# K-55	1500'	1000 sx Class "C" + 2% CaCl ₂ .	
				Circulate to surface	
7-7/8"	5-1/2"	15.5# K-55	4800'	1000 sx Class "C", 10% Diacel D + 9#/sx. Salt followed by 300 sx Class "C" + 5#/sx salt. Circulate to surface using caliper volume plus 30% excess.	

Mud additives as required for control.

BOP EQUIP: Series 900, 3000#WP (See attached schematic - Fig 7-9 or 7-10).

IN ABOVE SPACE DESCRIBE PROPOSED PROGRAM; IF PROPOSAL IS TO DEEPEN OR PLUG BACK, GIVE DATA ON PRESENT PRODUCTIVE ZONE AND PROPOSED NEW PRODUCTIVE ZONE. GIVE BLOWOUT PREVENTER PROGRAM, IF ANY.

I hereby certify that the information above is true and complete to the best of my knowledge and belief.

Signed W. J. Mueller Title Engineering Supervisor, Reserv. Date June 10, 1987

(This space for State Use)

ORIGINAL SIGNED BY JERRY SEXTON

APPROVED BY DISTRICT 1 SUPERVISOR

TITLE

DATE

JUN 15 1987

CONDITIONS OF APPROVAL, IF ANY:

Permit Expires 6 Months From Approval
Date Unless Drilling Underway.

NEW MEXICO OIL CONSERVATION COMMISSION
WELL LOCATION AND ACREAGE DEDICATION PLAT

Form C-101
Supersedes C-125
Effective 10-65

All distances must be from the outer boundaries of the Section

Operator PHILLIPS PETROLEUM CO.		Lease PHILMEX		Well No. 20
Unit Letter D	Section 36	Township 17 SOUTH	Range 33 EAST	County LEA
Actual Footage Location of Well: 660 feet from the NORTH line and 660 feet from the WEST line				
Ground Level Elev. 4120.5	Producing Formation Grayburg/San Andres	Pool Vacuum Grayburg/San Andres	Dedicated Acreage: 40 Acres	

1. Outline the acreage dedicated to the subject well by colored pencil or hachure marks on the plat below.
2. If more than one lease is dedicated to the well, outline each and identify the ownership thereof (both as to working interest and royalty).
3. If more than one lease of different ownership is dedicated to the well, have the interests of all owners been consolidated by communitization, unitization, force-pooling, etc?

☐ Yes ☐ No If answer is "yes," type of consolidation _____

If answer is "no," list the owners and tract descriptions which have actually been consolidated. (Use reverse side of this form if necessary.) _____

No allowable will be assigned to the well until all interests have been consolidated (by communitization, unitization, forced-pooling, or otherwise) or until a non-standard unit, eliminating such interests, has been approved by the Commission.

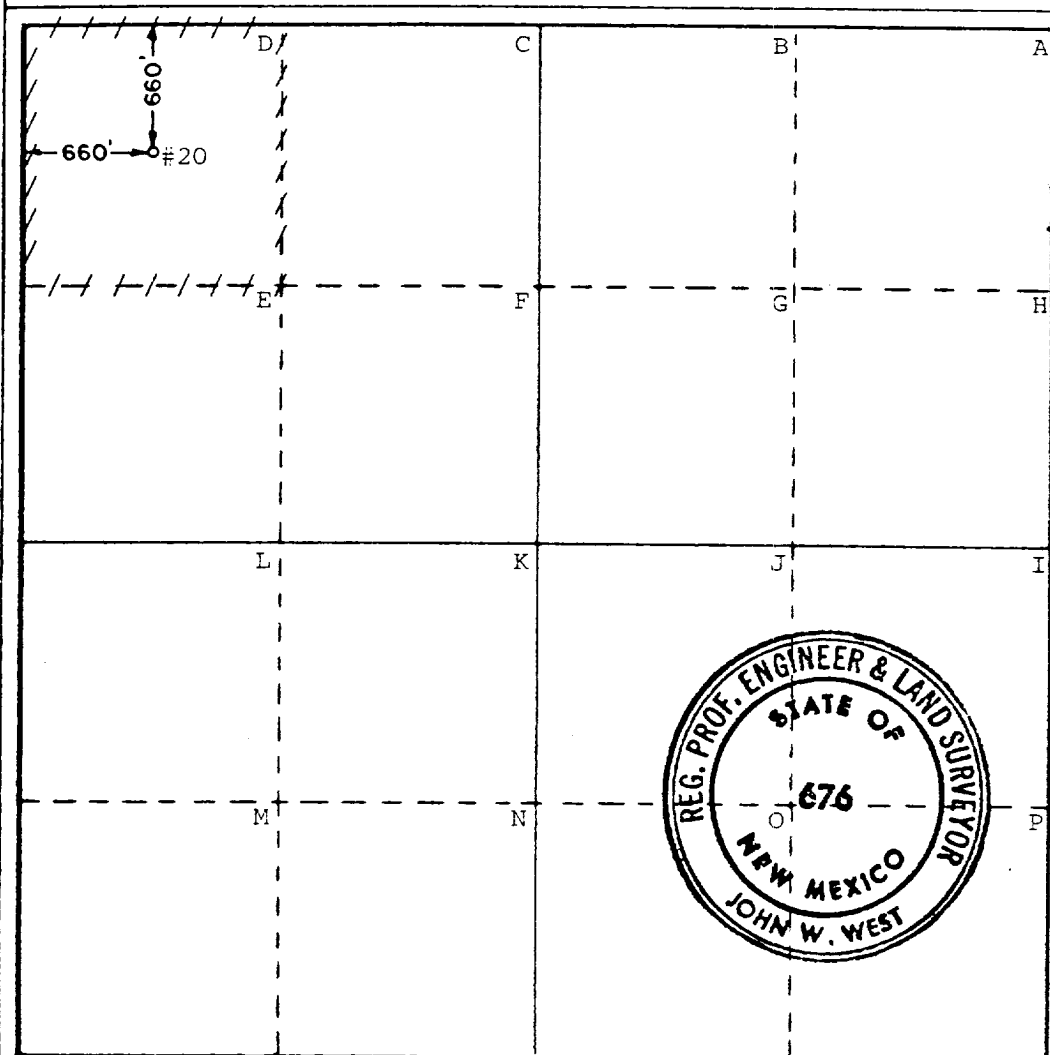

CERTIFICATION

I hereby certify that the information contained herein is true and complete to the best of my knowledge and belief.

Name
W. J. Mueller
Position
Engineering Supervisor,
Company
Reserv.
Phillips Petroleum Company

Date
June 10, 1987

I hereby certify that the well location shown on this plat was plotted from field notes of actual surveys made by me or under my supervision, and that the same is true and correct to the best of my knowledge and belief.

Date Surveyed
June 4, 1987

Registered Professional Engineer and/or Land Surveyor

Certificate No. **JOHN W. WEST, 676**
RONALD J. EIDSON, 3239

RECEIVED
JUN 12 1987
OCD
HOBBS OFFICE

100-1-1 80001
JUN 12 1987