

DISTRICT I
P.O. Box 1980, Hobbs, NM 88241-1980
DISTRICT II
P.O. Box Drawer DD, Artesia, NM 88211-0719
DISTRICT III
1000 Rio Brazos Rd., Aztec, NM 87410
DISTRICT IV
P.O. Box 2088, Santa Fe, NM 87504-2088

State of New Mexico
Energy, Minerals and Natural Resources Department

OIL CONSERVATION DIVISION

P.O. Box 2088
Santa Fe, New Mexico 87504-2088

Form C-101
Revised February 10, 1994
Instructions on back
Submit to Appropriate District Office
State Lease - 6 Copies
Fee Lease - 5 Copies
☐ AMENDED REPORT

APPLICATION FOR PERMIT TO DRILL, RE-ENTER, DEEPEN, PLUGBACK, OR ADD A ZONE

¹ Operator Name and Address TEXACO EXPLORATION & PRODUCTION INC. 205 E. Bender, HOBBS, NM 88240		² OGRID Number 022351
⁴ Property Code 13546	⁵ Property Name NEW MEXICO Z STATE NCT-1	³ API Number 30-025-29988
		⁶ Well No. 1

⁷ Surface Location

UI or lot no.	Section	Township	Range	Lot.Idn	Feet From The	North/South Line	Feet From The	East/West Line	County
C	2	18S	34E	3	660	NORTH	2200	WEST	LEA

⁸ Proposed Bottom Hole Location If Different From Surface

UI or lot no.	Section	Township	Range	Lot.Idn	Feet From The	North/South Line	Feet From The	East/West Line	County
⁹ Proposed Pool 1 VACUUM GLORIETA (WILDCAT)					¹⁰ Proposed Pool 2				

¹¹ Work Type Code P	¹² WellType Code O	¹³ Rotary or C.T. ROTARY	¹⁴ Lease Type Code S	¹⁵ Ground Level Elevation 4017' GR
¹⁶ Multiple No	¹⁷ Proposed Depth 10680'	¹⁸ Formation GLORIETA	¹⁹ Contractor	²⁰ Spud Date 09/01/1999

²¹ Proposed Casing and Cement Program

SIZE OF HOLE	SIZE OF CASING	WEIGHT PER FOOT	SETTING DEPTH	SACKS OF CEMENT	EST. TOP
24"	20"	133#	413'	900 SX	CIRCULATED
18 1/2"	16"	75#	1581'	1250 SX	400' BY T.S.
14 3/4" & 12	9 5/8"	40#	5237'	3500 SX	1300' BY T.S
8 3/4"	5 1/2"	17#	12200'	3150 SX	CIRCULATED

22 Describe the proposed program. If this application is to DEEPEN or PLUG BACK give the data on the present productive zone and proposed new productive zone. Describe the blowout prevention program, if any. Use additional sheets if necessary.

This workover is an OSWC to test the Glorieta formation along the shelf edge. The intended procedure is as follows:

1. MIRU. INSTL BOP. RUN GAUGE RING TO DETERMINE PBTD.
2. TIH W/BIT & SCRAPER TO 7600'.
3. RU WIRELINE CREW. SET CIBP @ 7600'. DUMP 5 SX CL H CMT ON TOP. NEW PBTD-7555'.
4. RUN GR-CCL FR 6500-5000'.
5. PERF THE GLORIETA FR 6030-6110'. (80 FT, 320 HLES)
6. RIH W/PKR & WS TO 5930'. TEST TBG & LINES TO 5000 PSI. ACIDIZE PERFS W/16000 GALS 20% HCL NEFE. DROP 320 1" BALL SEALERS. SURGE BALLS & ALLOW TO FALL. DISPL W/38 BBLs 2% KCL WTR. FLOW ACID.
7. SWAB TEST PERFS. RECORD RATE, FLUID LEVELS AND CUT. RUN 2 7/8" PROD TBG TO 6130'.

Permit Expires 1 Year From Approval Date Unless Drilling Unsuccessful
Plugback

23 I hereby certify that the rules and regulations of the Oil Conservation Division have been complied with and that the information given above is true and complete to the best of my knowledge and belief.

Signature *J. Denise Leake*
Printed Name J. Denise Leake
Title Engineering Assistant
Date 08/24/1999 Telephone 397-0405

OIL CONSERVATION DIVISION

Approved By: ORIGINAL SIGNED BY CHRIS WILLIAMS
DISTRICT I SUPERVISOR

Title:

Approval Date: AUG 26 1999 Expiration Date:

Conditions of Approval:
Attached ☐

DISTRICT I

P.O. Box 1980, Hobbs, NM 88241-1980

DISTRICT II

P.O. Box Drawer DD, Artesia, NM 88211-0719

DISTRICT III

1000 Rio Brazos Rd., Aztec, NM 87410

DISTRICT IV

P.O. Box 2088, Santa Fe, NM 87504-2088

State of New Mexico
Energy, Minerals and Natural Resources Department

OIL CONSERVATION DIVISION

P.O. Box 2088
Santa Fe, New Mexico 87504-2088

Form C-102

Revised February 10, 1994

Instructions on back

Submit to Appropriate District Office

State Lease - 4 Copies

Fee Lease - 3 Copies

☐ AMENDED REPORT

WELL LOCATION AND ACREAGE DEDICATION PLAT

¹ API Number 30-025-29988	² Pool Code 62160	³ Pool Name VACUUM GLORIETA
⁴ Property Code 13546	⁵ Property Name NEW MEXICO Z STATE NCT-1	⁶ Well No. 1
⁷ OGRID Number 022351	⁸ Operator Name TEXACO EXPLORATION & PRODUCTION INC.	⁹ Elevation 4017' GR

¹⁰ Surface Location

Ul or lot no.	Section	Township	Range	Lot.Idn	Feet From The	North/South Line	Feet From The	East/West Line	County
C	2	18S	34E	3	660	NORTH	2200	WEST	LEA

¹¹ Bottom Hole Location If Different From Surface

Ul or lot no.	Section	Township	Range	Lot.Idn	Feet From The	North/South Line	Feet From The	East/West Line	County
---------------	---------	----------	-------	---------	---------------	------------------	---------------	----------------	--------

¹² Dedicated Acres 40	¹³ Joint or Infill No	¹⁴ Consolidation Code	¹⁵ Order No.
-------------------------------------	-------------------------------------	----------------------------------	-------------------------

NO ALLOWABLE WILL BE ASSIGNED TO THIS COMPLETION UNTIL ALL INTERESTS HAVE BEEN CONSOLIDATED
OR A NON-STANDARD UNIT HAS BEEN APPROVED BY THE DIVISION

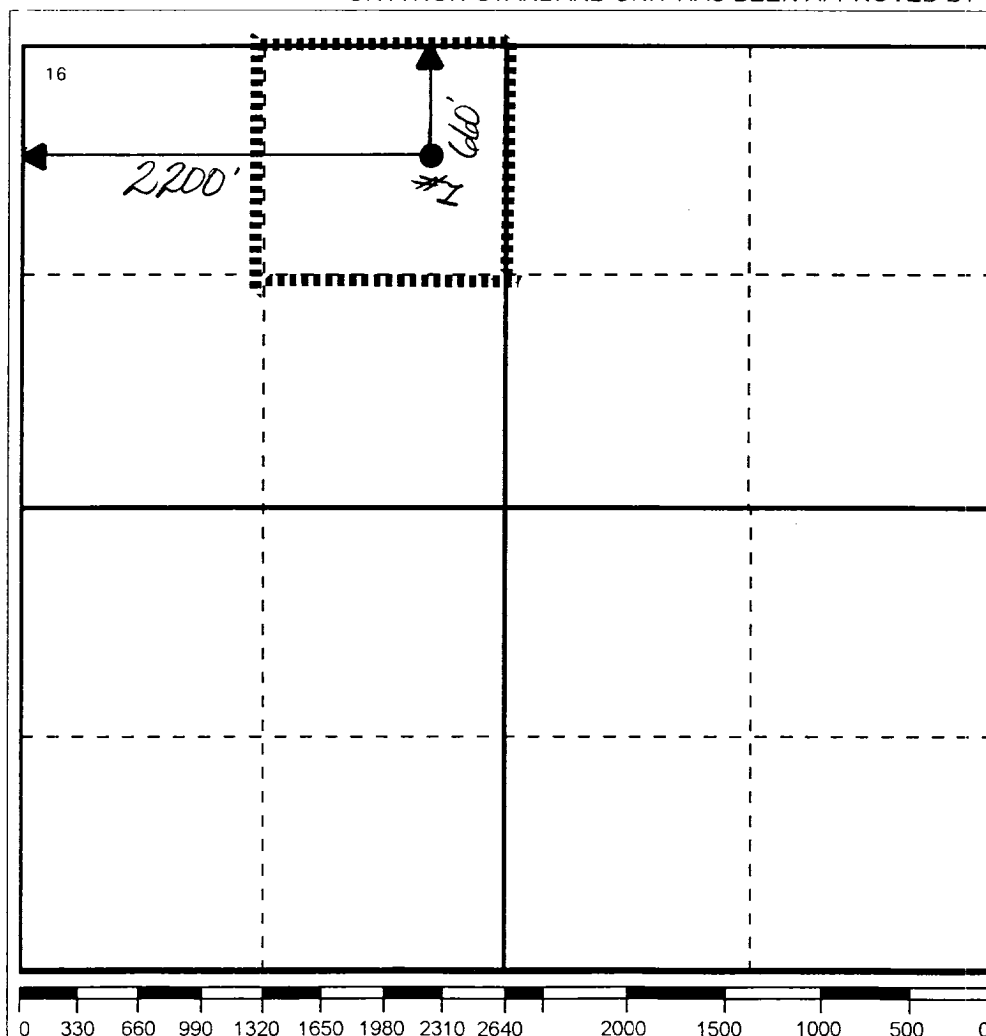
¹⁷ OPERATOR CERTIFICATION

I hereby certify that the information
contained herein is true and complete to the
best of my knowledge and belief

Signature

J. Denise Leake

Printed Name

J. Denise Leake

Position

Engineering Assistant

Date

08/24/1999

¹⁸ SURVEYOR CERTIFICATION

I hereby certify that the well location shown
on this plat was plotted from field notes of
actual surveys made by me or under my
supervision, and that the same is true and
correct to the best of my knowledge and
belief.

Date Surveyed

Signature & Seal of
Professional Surveyor

Certificate No.