

NO. OF COPIES RECEIVED	
DISTRIBUTION	
SANTA FE	
TITLE	
S.O.S.	
LAND OFFICE	
OPERATOR	

NEW MEXICO OIL CONSERVATION COMMISSION

Form C-101
Revised 1-1-85

5A. Indicate Type of Lease
STATE <input checked="" type="checkbox"/> REC <input type="checkbox"/>
5. State Oil & Gas Lease No.
V-1358

APPLICATION FOR PERMIT TO DRILL, DEEPEN, OR PLUG BACK

1a. Type of Work	DRILL <input type="checkbox"/> DEEPEN <input type="checkbox"/> PLUG BACK <input checked="" type="checkbox"/>
b. Type of Well	OIL WELL <input checked="" type="checkbox"/> GAS WELL <input type="checkbox"/> OTHER <input type="checkbox"/> SINGLE ZONE <input checked="" type="checkbox"/> MULTIPLE ZONE <input type="checkbox"/>
2. Name of Operator	Harvey E. Yates Company
3. Address of Operator	P.O. Box 1933, Roswell, New Mexico
4. Location of Well	UNIT LETTER <u>D</u> LOCATED <u>660</u> FEET FROM THE <u>North</u> LINE AND <u>660</u> FEET FROM THE <u>West</u> LINE OF SEC. <u>36</u> TWP. <u>18S</u> RGE. <u>32E</u> NMPM
12. County	Lea
19. Proposed Depth	PB 6900± pay
19A. Formation	Delaware
20. Rotary or C.T.	NA
21. Elevations (Show whether DF, RI, etc.)	3729.0
21A. Kind & Status Plug. Bond	Blanket
21B. Drilling Contractor	none
22. Approx. Date Work will start	30 days

7. Unit Agreement Name
8. Farm or Lease Name
French 36 State #1
9. Well No.
#1
10. Field and Pool, or Wildcat
Querecho Plains Delaware
12. County
Lea
19. Proposed Depth
PB 6900± pay
19A. Formation
Delaware
20. Rotary or C.T.
NA
21. Elevations (Show whether DF, RI, etc.)
3729.0
21A. Kind & Status Plug. Bond
Blanket
21B. Drilling Contractor
none
22. Approx. Date Work will start
30 days

PROPOSED CASING AND CEMENT PROGRAM

SIZE OF HOLE	SIZE OF CASING	WEIGHT PER FOOT	SETTING DEPTH	SACKS OF CEMENT	EST. TOP
17 1/2	13 3/8	48 & 54.5	403	425 circ 60 sx	Surface
11	8 5/8	24 & 32	3115	1300 circ 168 sx	Surface
7 7/8	5 1/2	17	10250'	1575	2350 by CBL

Procedure to plug back:

- 1. Set CIBP @ 7119' (top of Bone Spring) w/30' cmt.
- 2. Perf. Delaware @ approximately 6900± and acidize.
- 3. Frac if necessary.
- 4. Put on pump to test

IN ABOVE SPACE DESCRIBE PROPOSED PROGRAM IF PROPOSAL IS TO DEEPEN OR PLUG BACK, GIVE DATA ON PRESENT PRODUCTIVE ZONE AND PROPOSED NEW PRODUCTIVE ZONE. GIVE BLOWOUT PREVENTER PROGRAM, IF ANY.

I hereby certify that the information above is true and complete to the best of my knowledge and belief.

Signed [Signature] Title Production Manager/Engineer skh Date June 13, 1988

(This space for State Use)
ORIGINAL SIGNED BY JERRY SEXTON
APPROVED BY DISTRICT 1 SUPERVISOR TITLE DATE June 16 1988
CONDITIONS OF APPROVAL, IF ANY:

Permit Expires 6 Months From Approval Date Unless Drilling Underway.

RECEIVED

JUN 14 1938.

HOBBS OFFICE

N MEXICO OIL CONSERVATION COMMISS
WELL LOCATION AND ACREAGE DEDICATION PLAT

Form C-102
 Supersedes C-128
 Effective 1-1-65

All distances must be from the outer boundaries of the Section

Operator Harvey E. Yates Company			Lease French 36 State		Well No. 1
Section Letter D	Section 36	Township 18-S	Range 32-E	County Lea	
Actual Footage Location of Well: 660 feet from the North line and 660 feet from the West line					
Ground Level Elev. 3729.0	Producing Formation Delaware		Pool Querecho Plains Delaware		Dedicated Acreage: 40 Acres

1. Outline the acreage dedicated to the subject well by colored pencil or hachure marks on the plat below.
2. If more than one lease is dedicated to the well, outline each and identify the ownership thereof (both as to working interest and royalty).
3. If more than one lease of different ownership is dedicated to the well, have the interests of all owners been consolidated by communitization, unitization, force-pooling, etc?

☐ Yes ☐ No If answer is "yes," type of consolidation _____

If answer is "no," list the owners and tract descriptions which have actually been consolidated. (Use reverse side of this form if necessary.) _____

No allowable will be assigned to the well until all interests have been consolidated (by communitization, unitization, forced-pooling, or otherwise) or until a non-standard unit, eliminating such interests, has been approved by the Commission.

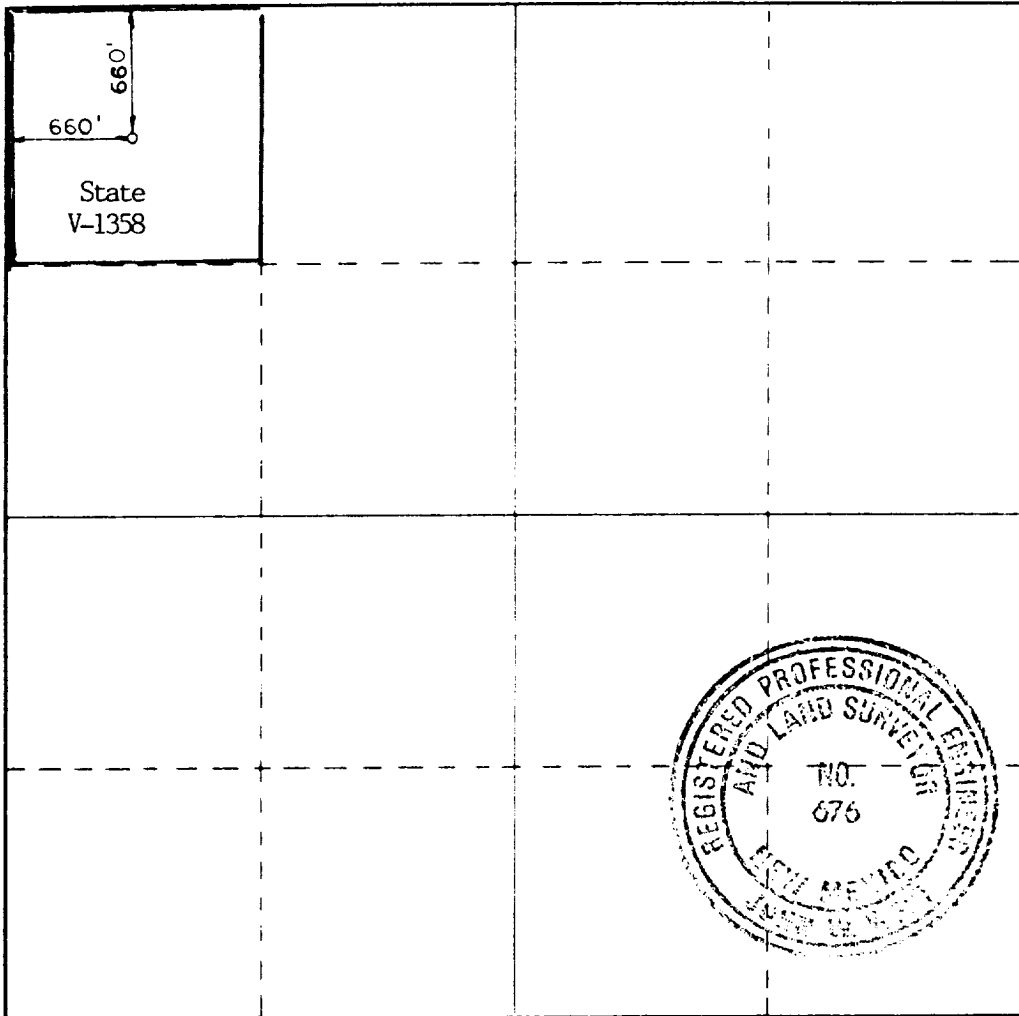

CERTIFICATION

I hereby certify that the information contained herein is true and complete to the best of my knowledge and belief.

Ray F. Nokes

Ray F. Nokes

Production Manager/Engineer

Company
Harvey E. Yates Company

Date
June 13, 1988

I hereby certify that the well location shown on this plat was plotted from field notes of actual surveys made by me or under my supervision, and that the same is true and correct to the best of my knowledge and belief.

Date Surveyed
September 18, 1987

Registered Professional Engineer and Land Surveyor

John W. West

Certificate No. **JOHN W. WEST, 676**
RONALD J. EIDSON, 3239

