

STATE OF NEW MEXICO
ENERGY AND MINERALS DEPARTMENT

OIL CONSERVATION DIVISION

P. O. BOX 2088
SANTA FE, NEW MEXICO 87501

Form C-101
Revised 10-1-78

NO. OF COPIES RECEIVED	
DISTRIBUTION	
SANTA FE	
FILE	
U.S.G.S.	
LAND OFFICE	
OPERATOR	

API No. 30-025-

5a. Indicate Type of Lease
State ☒ Fee ☐

5. State Oil & Gas Lease No.
B-2148

APPLICATION FOR PERMIT TO DRILL, DEEPEN OR PLUG BACK

1a. Type of Work DRILL <input checked="" type="checkbox"/> DEEPEN <input type="checkbox"/> PLUG BACK <input type="checkbox"/>		7. Unit Agreement Name			
b. Type of Well Oil Well <input checked="" type="checkbox"/> Gas Well <input type="checkbox"/> Other <input type="checkbox"/> Single Zone <input checked="" type="checkbox"/> Multiple Zone <input type="checkbox"/>		8. Farm or Lease Name Leamex			
2. Name of Operator Phillips Petroleum Company		9. Well No. 41			
3. Address of Operator 4001 Penbrook Street, Odessa, Texas 79762		10. Field and Pool, or Wildcat Maljamar Gb/SA			
4. Location of Well Unit Letter <u>D</u> Located <u>860 feet</u> From the <u>North</u> Line And <u>660</u> Feet From The <u>West</u> Line of Sec. <u>22</u> TWP. <u>17-S</u> RGE <u>33-E</u> NMPM		12. County Lea			
19. Proposed Depth 4900'		19A. Formation Grayburg/SA	20. Rotary or C.T. Rotary		
21. Elevations (Show whether DF, RT, etc.) 4168.2' GR (Unprepared)	21A. Kind & Status Plug. Bond Blanket	21B. Drilling Contractor Will advise later	22. Approx. Date Work Will Start Upon approval		
23. PROPOSED CASING AND CEMENT PROGRAM					
SIZE OF HOLE	SIZE OF CASING	WEIGHT PER FOOT	SETTING DEPTH	SACKS OF CEMENT	EST. TOP
12-1/4"	8-5/8"	24 # K-55	1500' RKB	1000 Sx Class "C"	Surface
7-7/8"	5-1/2"	15.5 # K-55	4800' RKB	1400 Sx	Surface

(Caliper volume plus 30% excess. Lead: Estimated 1000 sx Class "C" w/5% salt; tail with 400 sx Class "C" w/5% salt.)

Use mud additives as required for control.

BOP EQUIP: Series 900, 3000# WP (See attached schematic - Figure 7-9 or 7-10.

In above space describe proposed program: If proposal is to deepen or plug back, give data on present productive zone and proposed new productive zone. Give blowout preventer program, if any.

I hereby certify that the information above is true and complete to the best of my knowledge and belief.

SIGNED W. J. Mueller TITLE Engineering Supervisor, Resv. DATE September 23, 1987
ORIGINAL SIGNED BY JERRY SEXTON
APPROVED BY DISTRICT I SUPERVISOR TITLE _____ DATE SEP 29 1987

CONDITIONS OF APPROVAL, IF ANY:

Permit Expires 6 Months From Approval
Date Unless Drilling Underway.

C-101/C-101.16

**NEW MEXICO OIL CONSERVATION COMMISSION
WELL LOCATION AND ACREAGE DEDICATION PLAT**

Form C-102
Supersedes C-128
Effective 1-1-65

All distances must be from the outer boundaries of the Section

Operator Phillips Petroleum Co.		Lease Leamex		Well No. 41
Unit Letter D	Section 22	Township 17 South	Range 33 East	County Lea
Actual Footage Location of Well:				
860 feet from the North line and 660 feet from the West line				
Ground Level Elev. 4168.2	Producing Formation Grayburg-San Andres	Pool Maljamar - Grayburg/San Andres	Dedicated Acreage: 40 Acres	

1. Outline the acreage dedicated to the subject well by colored pencil or hatchure marks on the plat below.
2. If more than one lease is dedicated to the well, outline each and identify the ownership thereof (both as to working interest and royalty).
3. If more than one lease of different ownership is dedicated to the well, have the interests of all owners been consolidated by communitization, unitization, force-pooling, etc?

☐ Yes ☐ No If answer is "yes," type of consolidation _____

If answer is "no," list the owners and tract descriptions which have actually been consolidated. (Use reverse side of this form if necessary.) _____

No allowable will be assigned to the well until all interests have been consolidated (by communitization, unitization, forced-pooling, or otherwise) or until a non-standard unit, eliminating such interests, has been approved by the Commission.

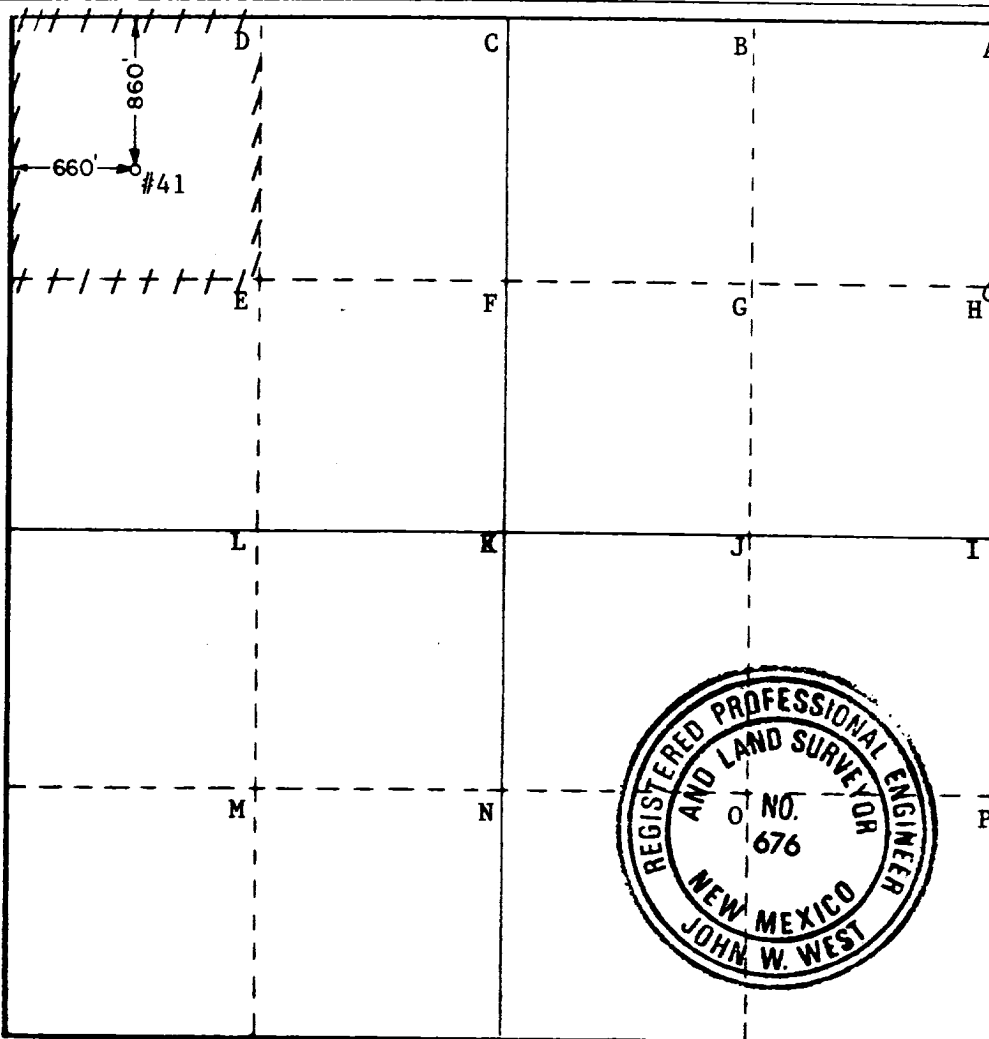

CERTIFICATION

I hereby certify that the information contained herein is true and complete to the best of my knowledge and belief.

Name
W. J. Mueller

Position
Engineering Supervisor, Resv.

Company
Phillips Petroleum Company

Date
September 23, 1987

I hereby certify that the well location shown on this plat was plotted from field notes of actual surveys made by me or under my supervision, and that the same is true and correct to the best of my knowledge and belief.

Date Surveyed
August 28, 1987

Registered Professional Engineer and/or Land Surveyor

[Signature]
Certificate No. **JOHN W. WEST, 676**

FIELD PRACTICES AND STANDARDS

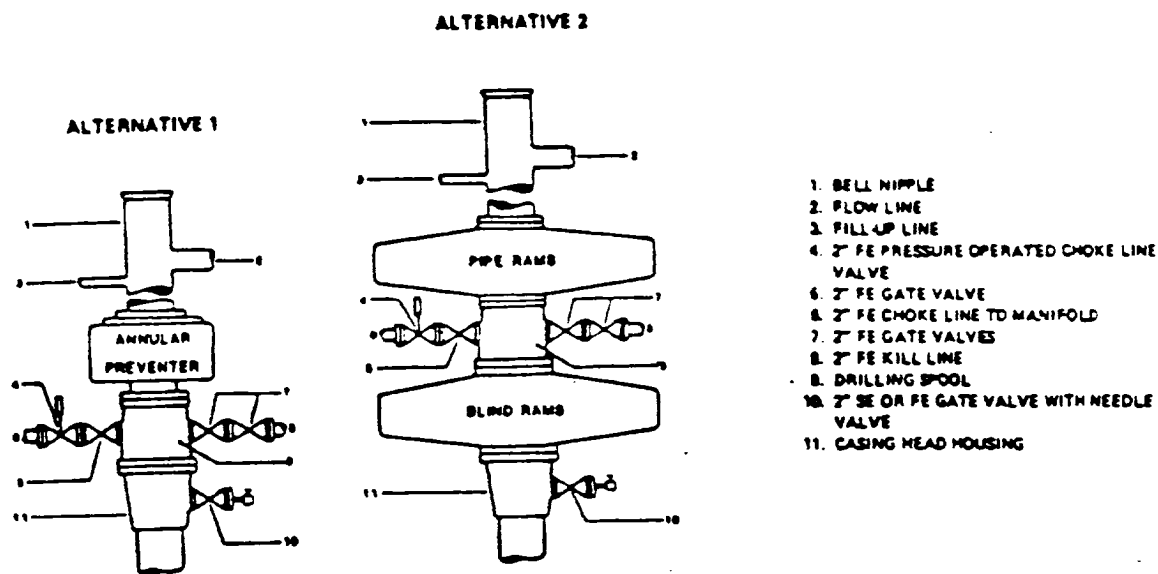

NOTE: THE DRILLING SPOOL MAY BE LOCATED BELOW BOTH SETS OF RAMS IF A DOUBLE PREVENTER IS USED AND IT DOES NOT HAVE SUITABLE OUTLETS BETWEEN RAMS

Figure 7-9. Standard Hydraulic Blowout Preventer Assembly
(2 M or 3 M Working Pressure) Alternative 1

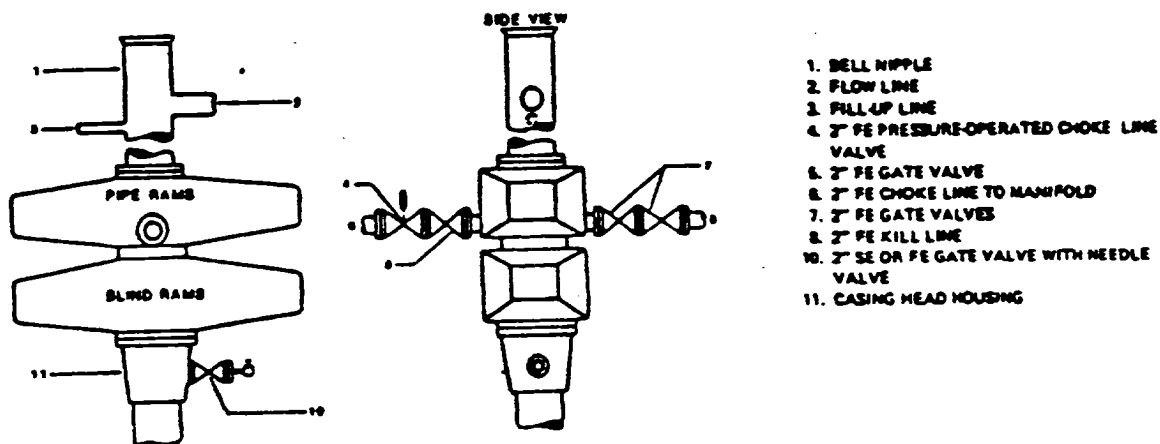

Figure 7-10. Standard Hydraulic Blowout Preventer Assembly
(2 M or 3 M Working Pressure) Alternative 3 (without Drilling Spool)

MS-1021 8774

173